



GG1-type Electric Locomotive

The GG1-type electric locomotive was developed and owned by Pennsylvania Railroad, an American company. It was known throughout the world because of its sleek body by French designer Raymond Loewy and is considered Pennsylvania Railroad's "signature locomotive." A total of 139 locomotives were manufactured from 1934 to 1943 and they remained in service until the beginning of the 80s. Today, although they are no longer in use and many have been scrapped, we can still find some in museums, etc.

This "GG1-type Electric Locomotive" papercraft is approximately 1/56 of the original size.

*This model was designed for Papercraft and may differ from the original in some respects.

■ Parts list (Assembly Instructions) : Seventeen A4 sheets

■ No. of Parts: 562

*Build the model by carefully reading the Assembly Instructions, in the parts sheet page order.

Assembly Instructions



Mountain fold
(Dotted line)



Scissors line
(Solid line)



Valley fold
(Dashed and dotted line)



Cut in Line
(Red solid line)



Completed parts become a cylinder
You may like to use a metal rod as a guide.



Layer wrapping (roll)
Wrap around and glue to the cylinder, to use as a glue tab.



Wrap around and glue to the top of the cylinder.

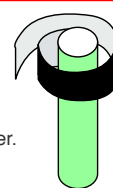

How to make the cylinders

This craft involves making cylinders with diameters of 3 to 7mm, so it may be helpful to have some rods of sizes about 0.5mm thinner handy.

Guide rod

Glue tab notation key

Each glue tab has a symbol and number printed on it. Glue with in the same part.



Glue



Trace along the folds with a ruler and a used pen (no ink) to get a sharper, easier fold.

Glue, scissors and other tools may be dangerous to young children so be sure to keep them out of the reach of young children.

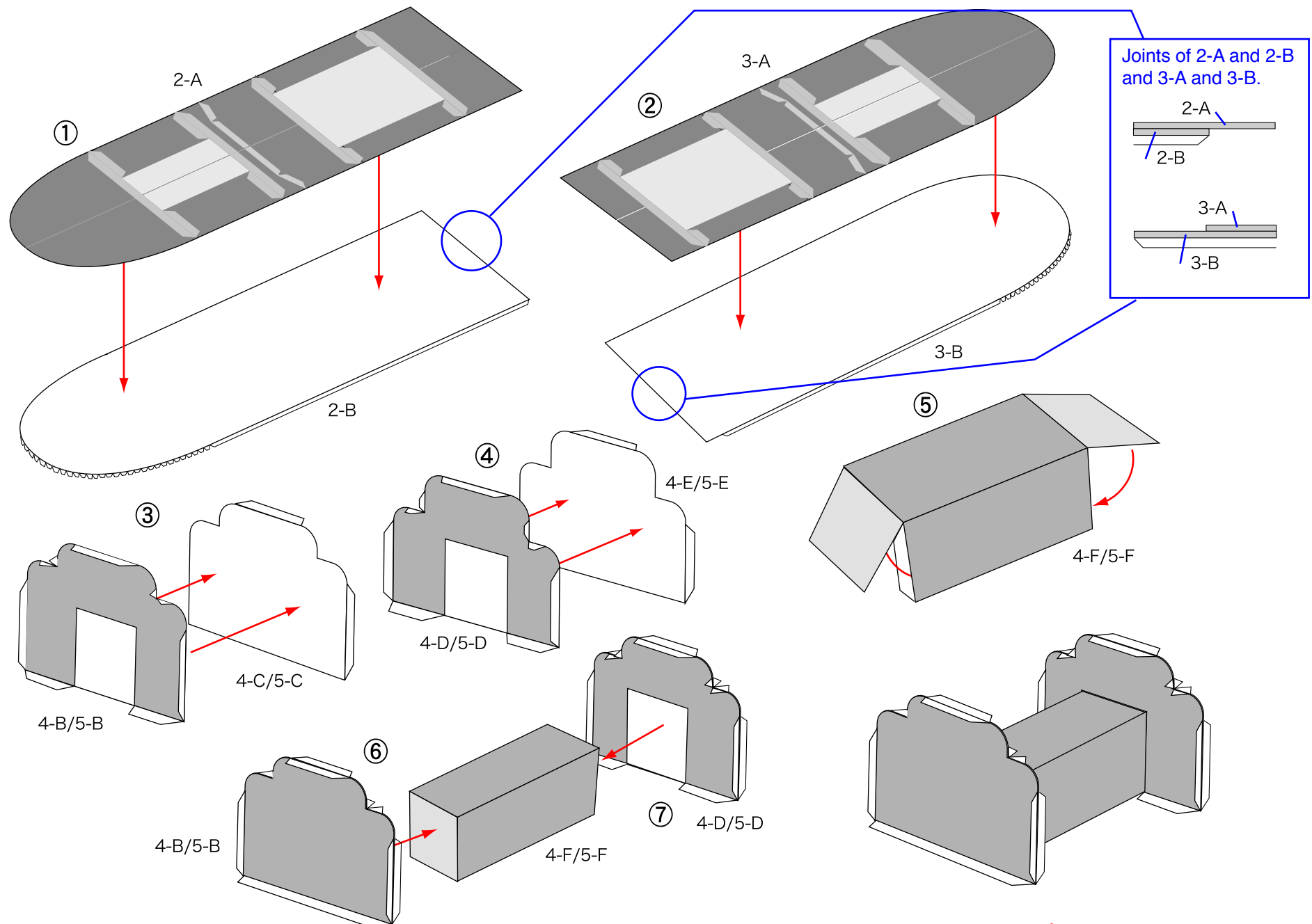

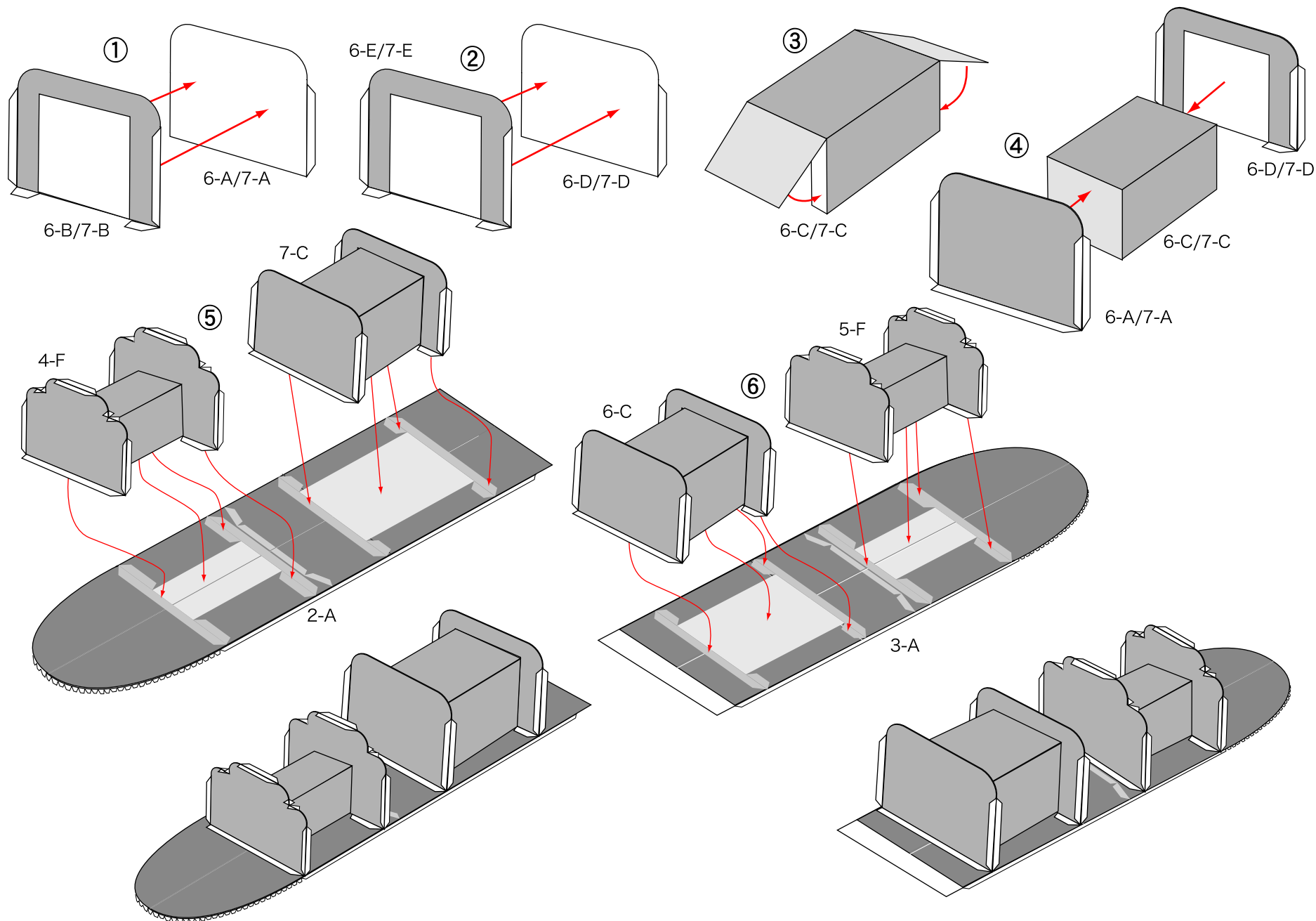

Use the "glue tab" and attach the tip of 8-A and 9-A from the back.

Back sides of 8-A and 9-A

①

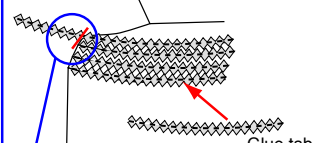

Cut off any unnecessary parts.

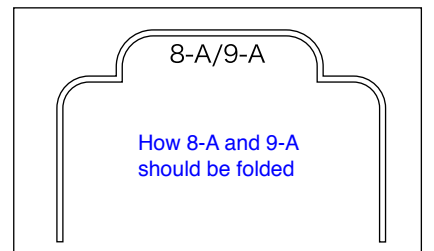

How 8-A and 9-A should be folded

8-A/9-A

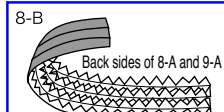

Use the "glue tab" and attach the tip of 8-A and 9-A from the back.

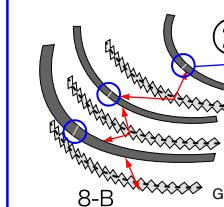

When attaching 8-B, be sure to follow the center line.

*Make two pairs.

Start attaching 8-B by following the center lines of 8-A and 9-A as well as the center line on the 8-B side and put it inside 8-A and 9-A.

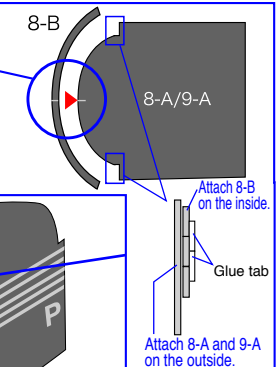

8-B

8-A/9-A

Attach 8-B on the inside.

Glue tab

Attach 8-A and 9-A on the outside.

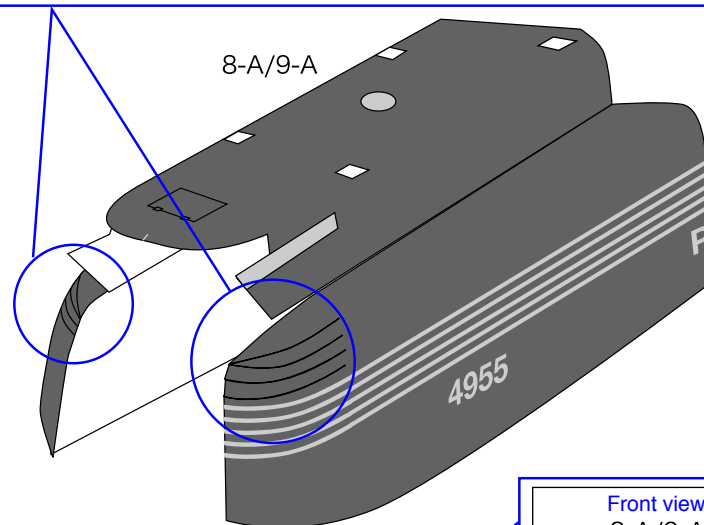

4955

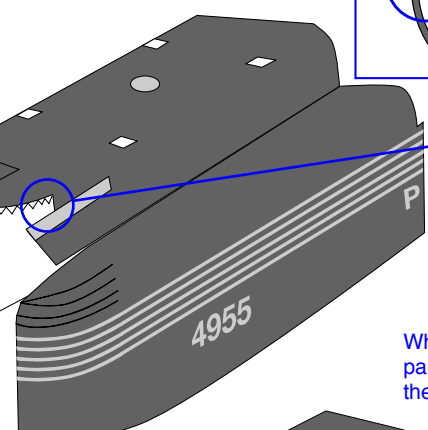

8-A/9-A

When attaching the top part of 8-C, insert it into the slits on 8-A and 9-A.

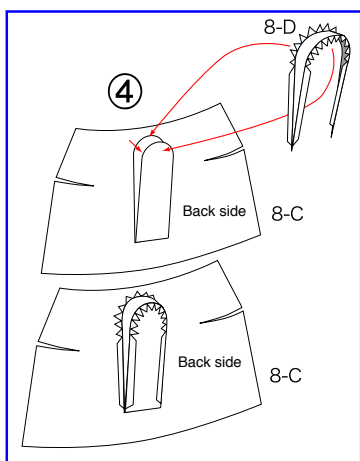
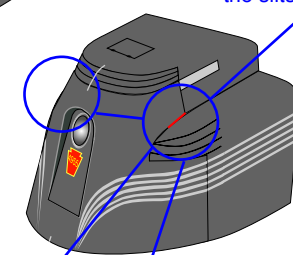

④

Back side

8-D

8-C

Back side

8-C

Place the center lines of 8-C and 8-B together.

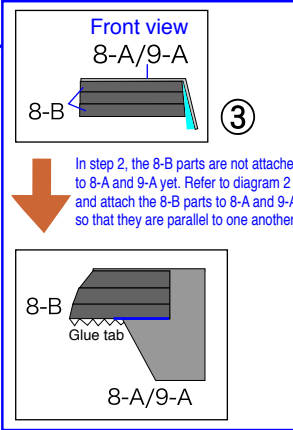

Front view

8-A/9-A

8-B

③

In step 2, the 8-B parts are not attached to 8-A and 9-A yet. Refer to diagram 2 and attach the 8-B parts to 8-A and 9-A so that they are parallel to one another.

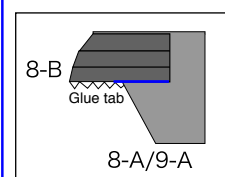

8-B

Glue tab

8-A/9-A

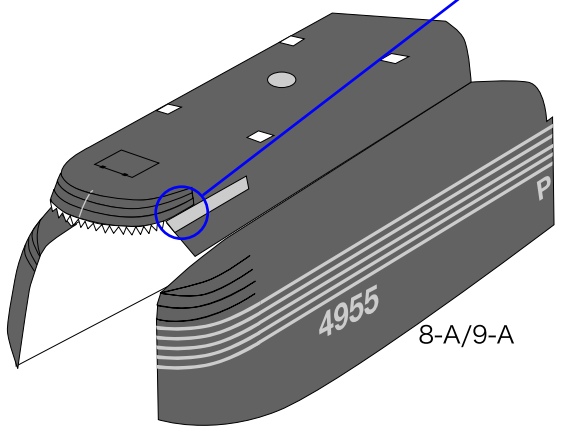

8-A/9-A

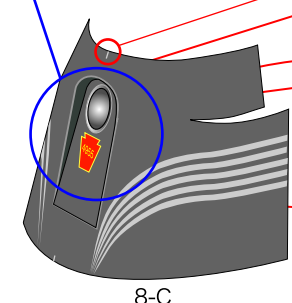

8-C

⑤

8-A/9-A

4955

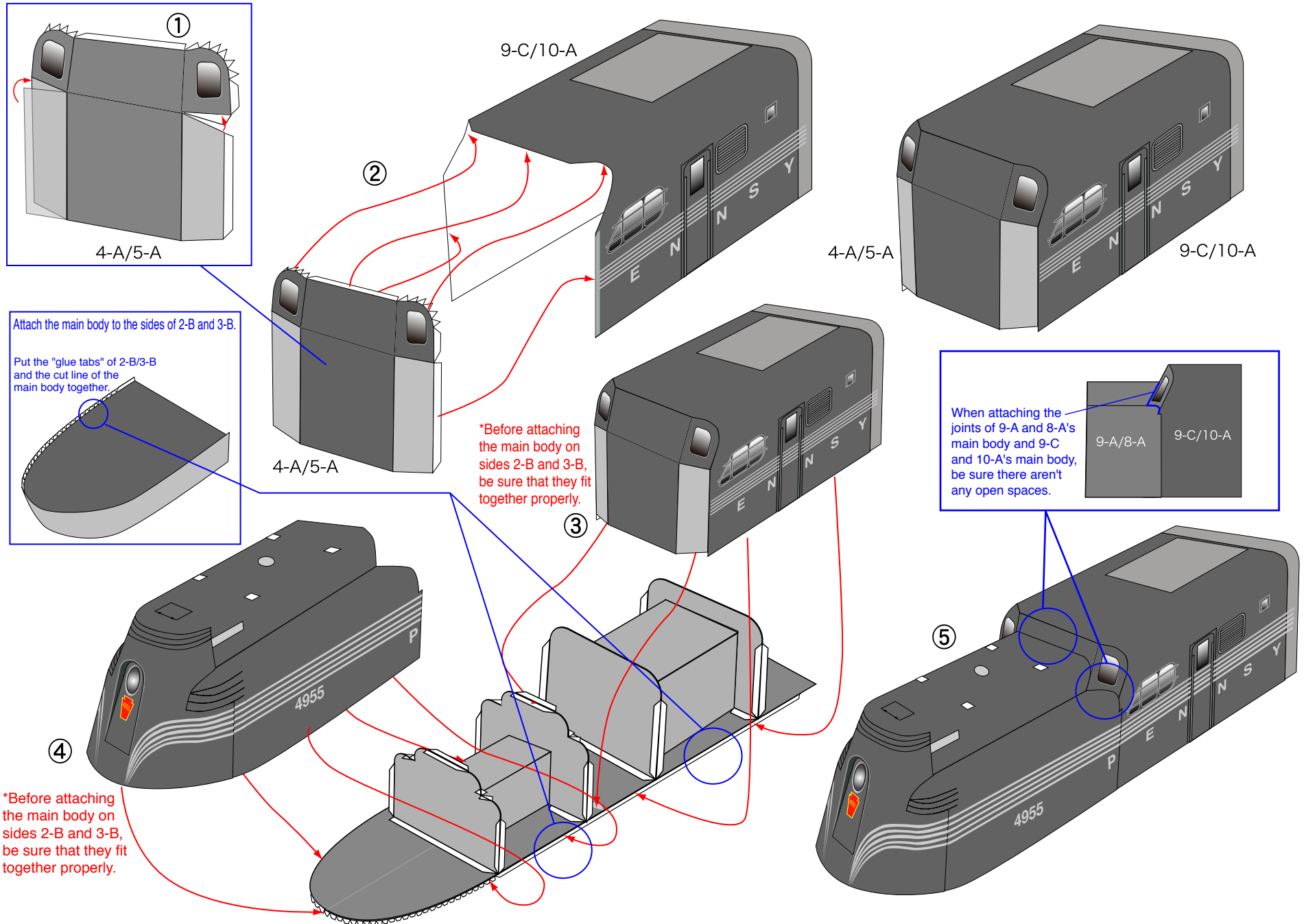

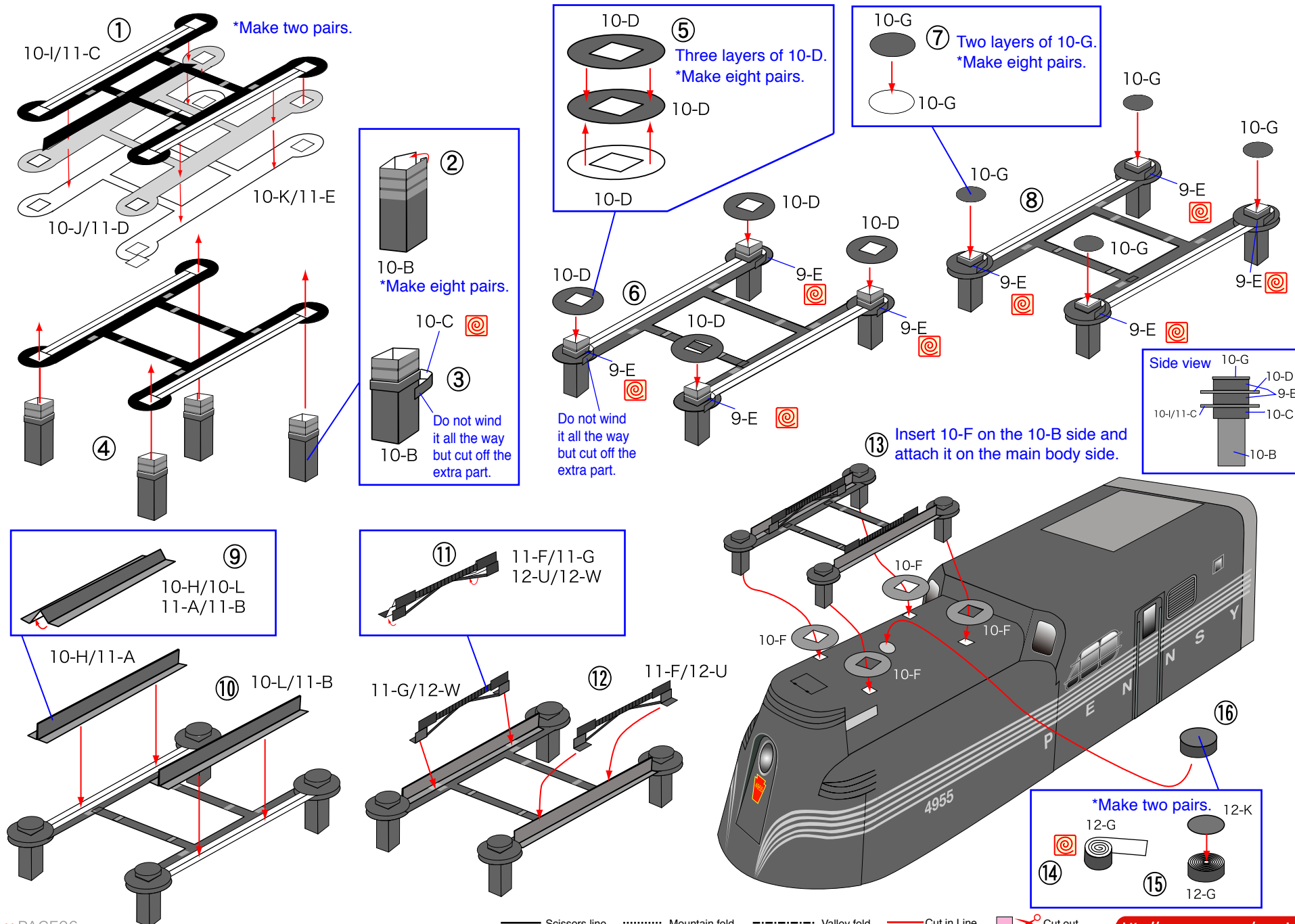

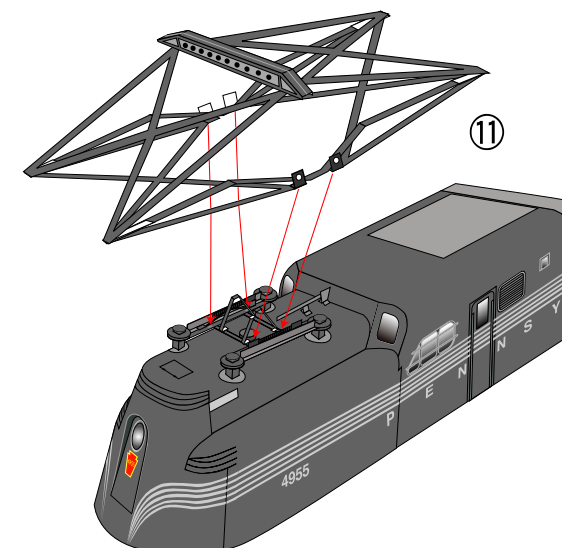
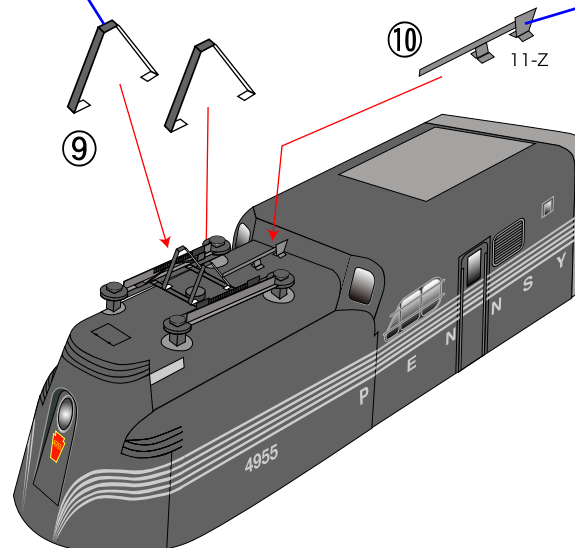
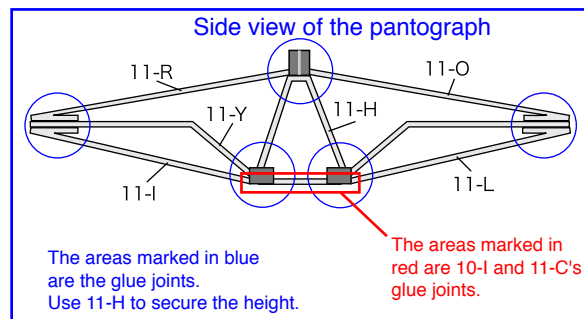
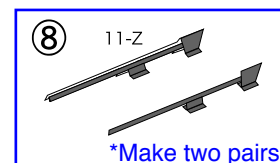
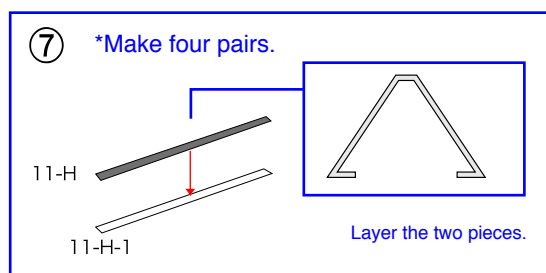
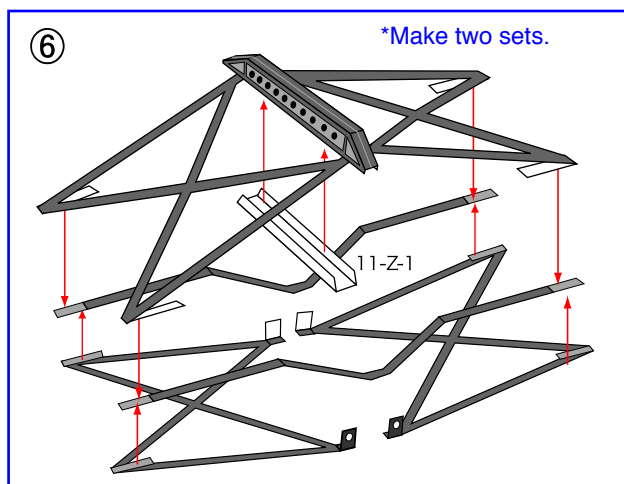
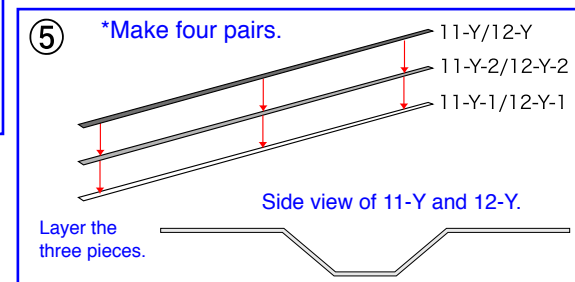
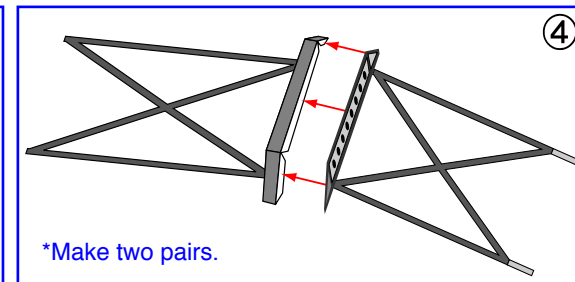
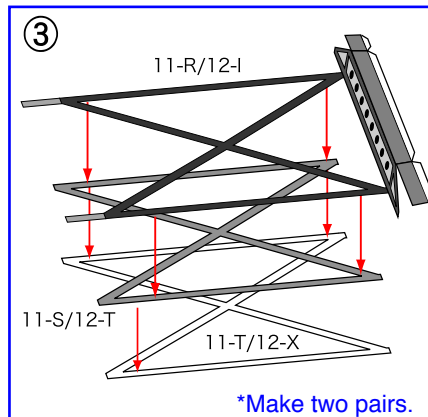
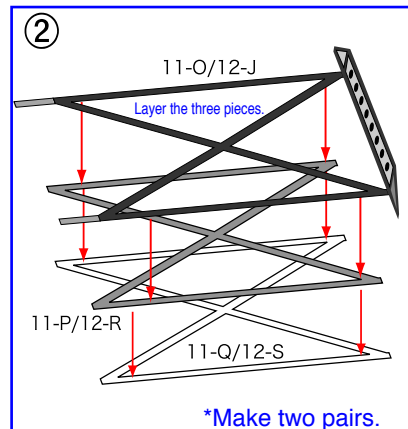
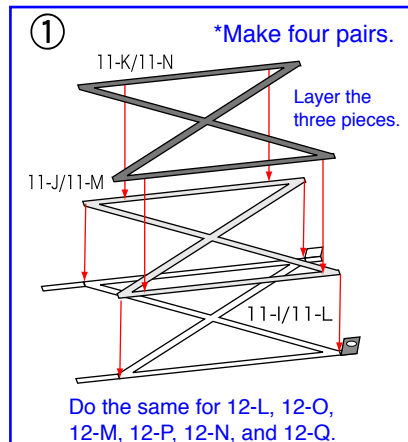

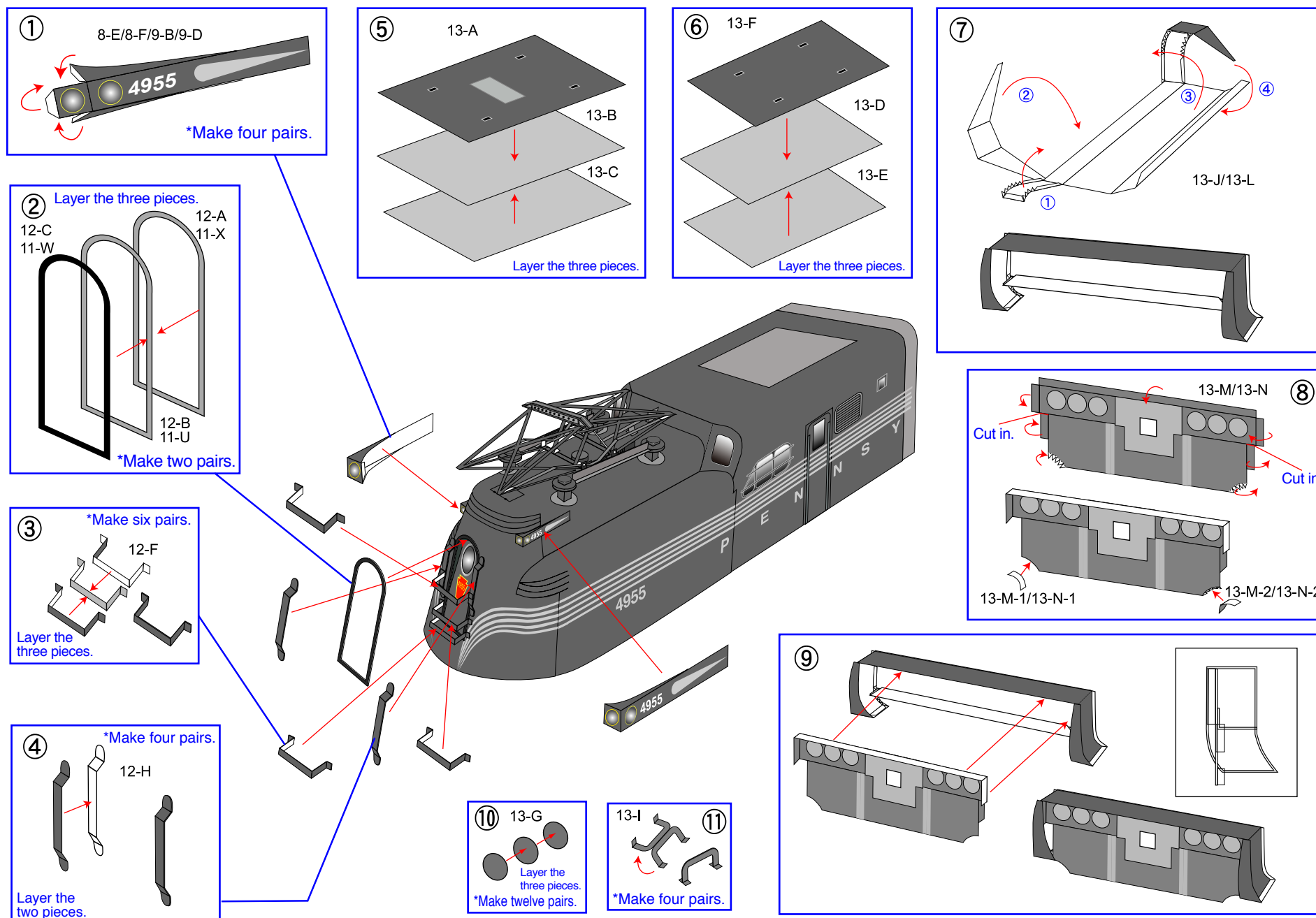

Attaching the main body's joint.

Main body which has "glue tabs".

Glue spot

Attach the glue spot of the main body and the base.

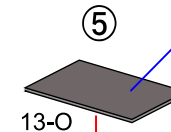
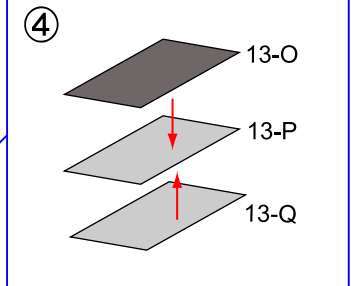

③

②

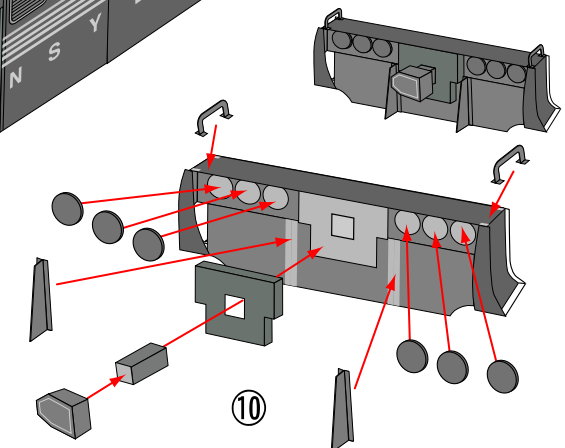
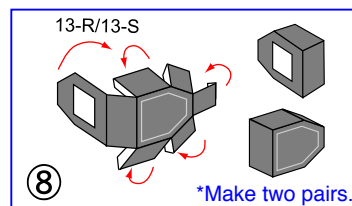
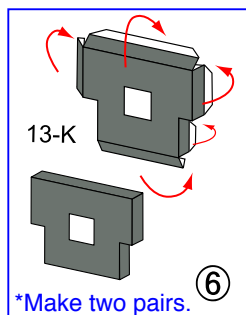
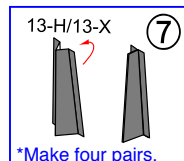
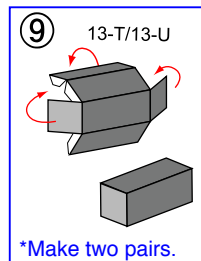

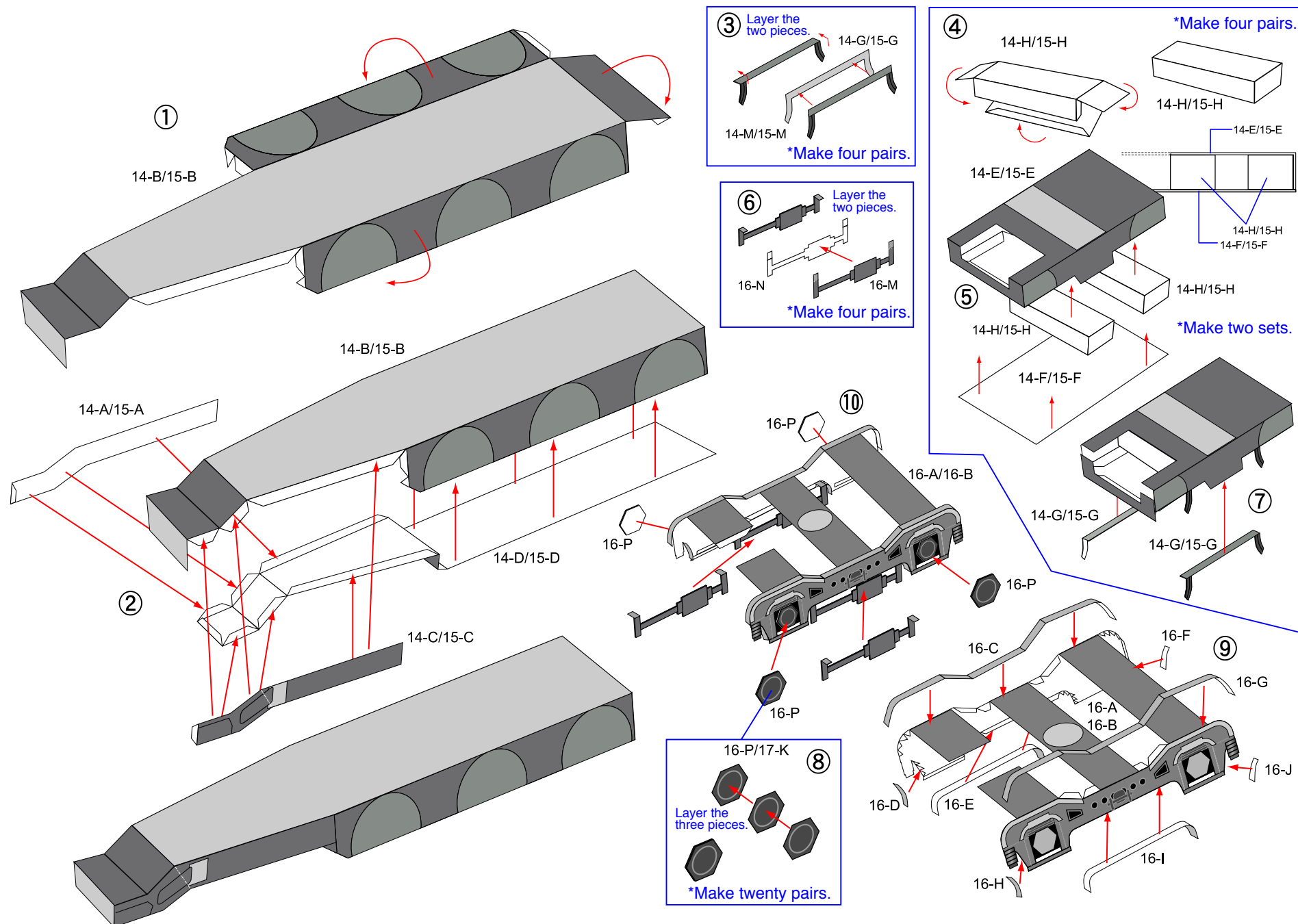

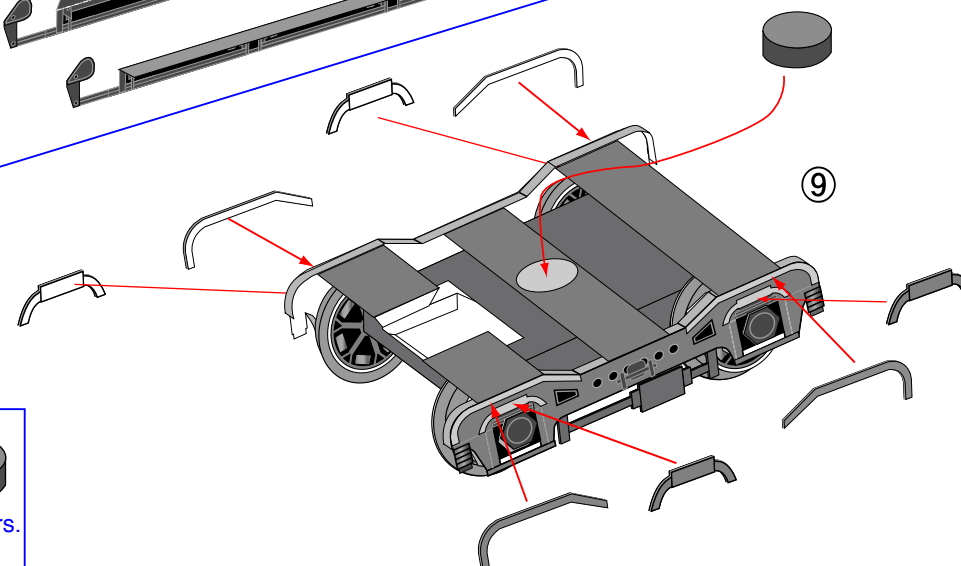
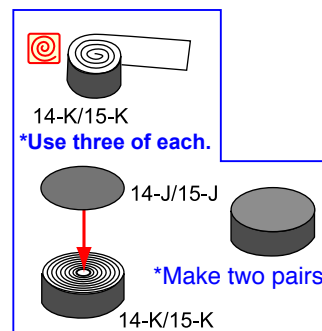
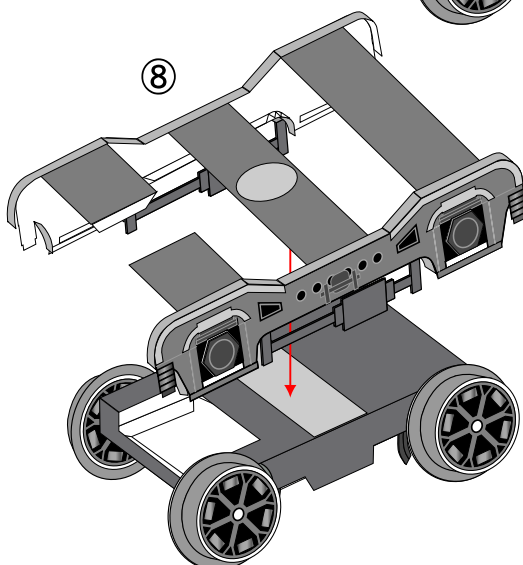
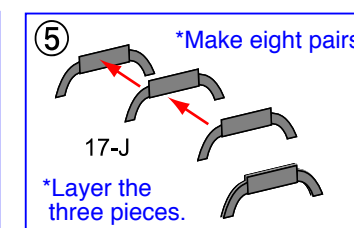
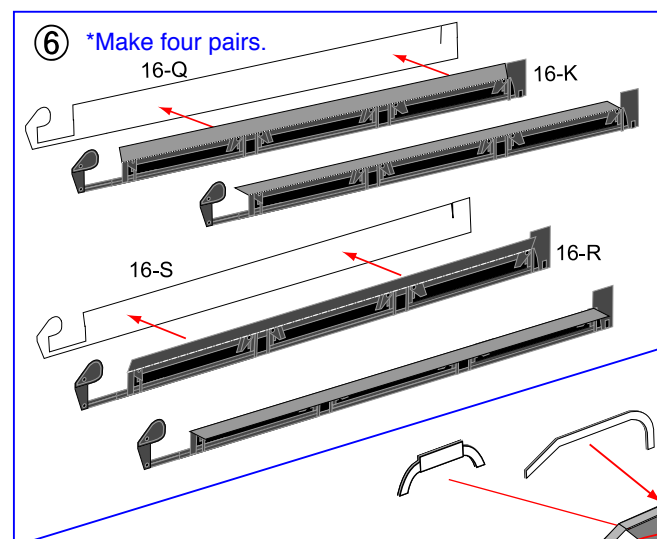
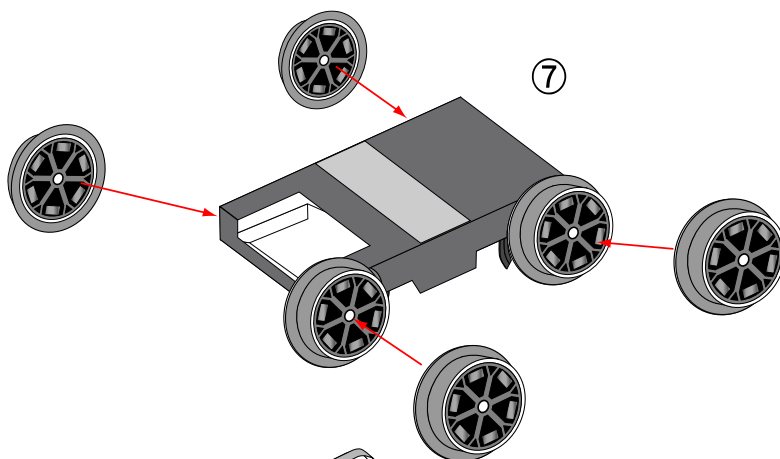
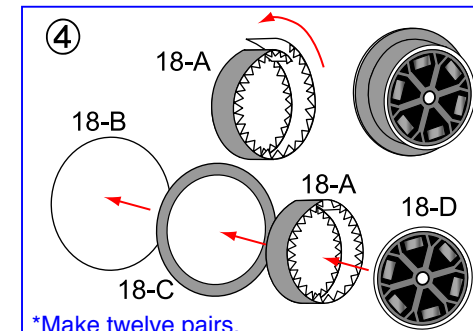
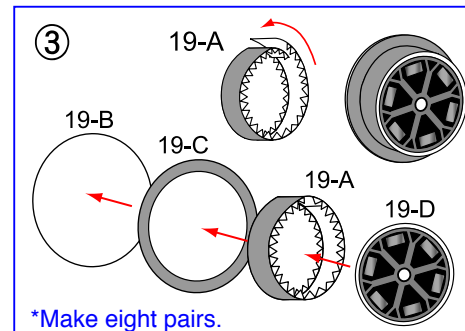
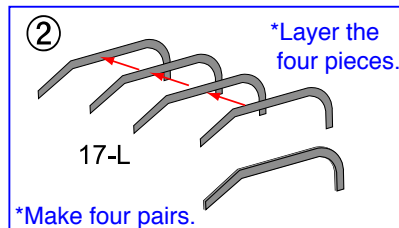
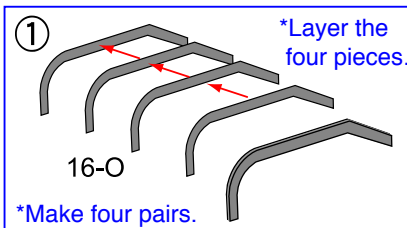

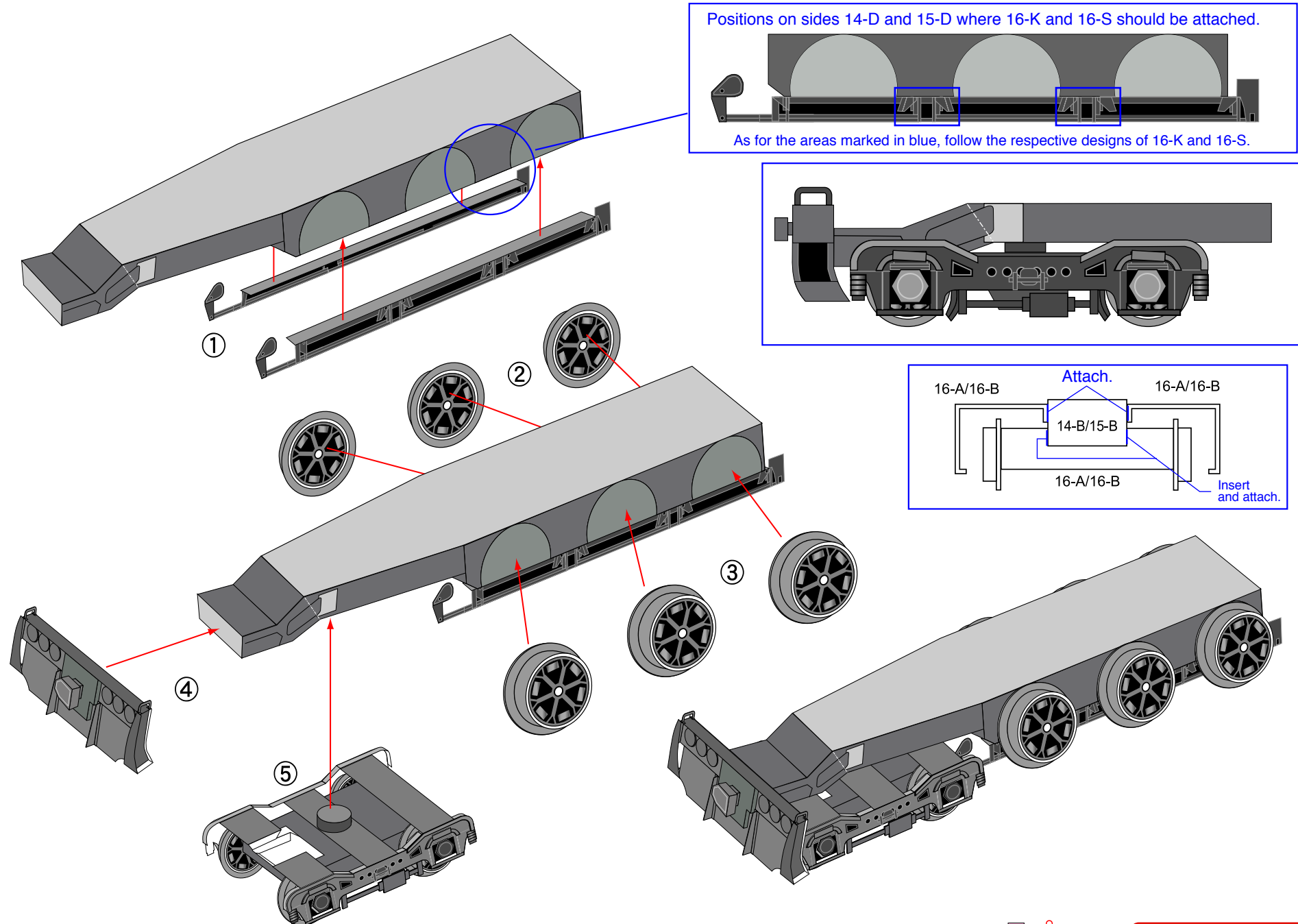

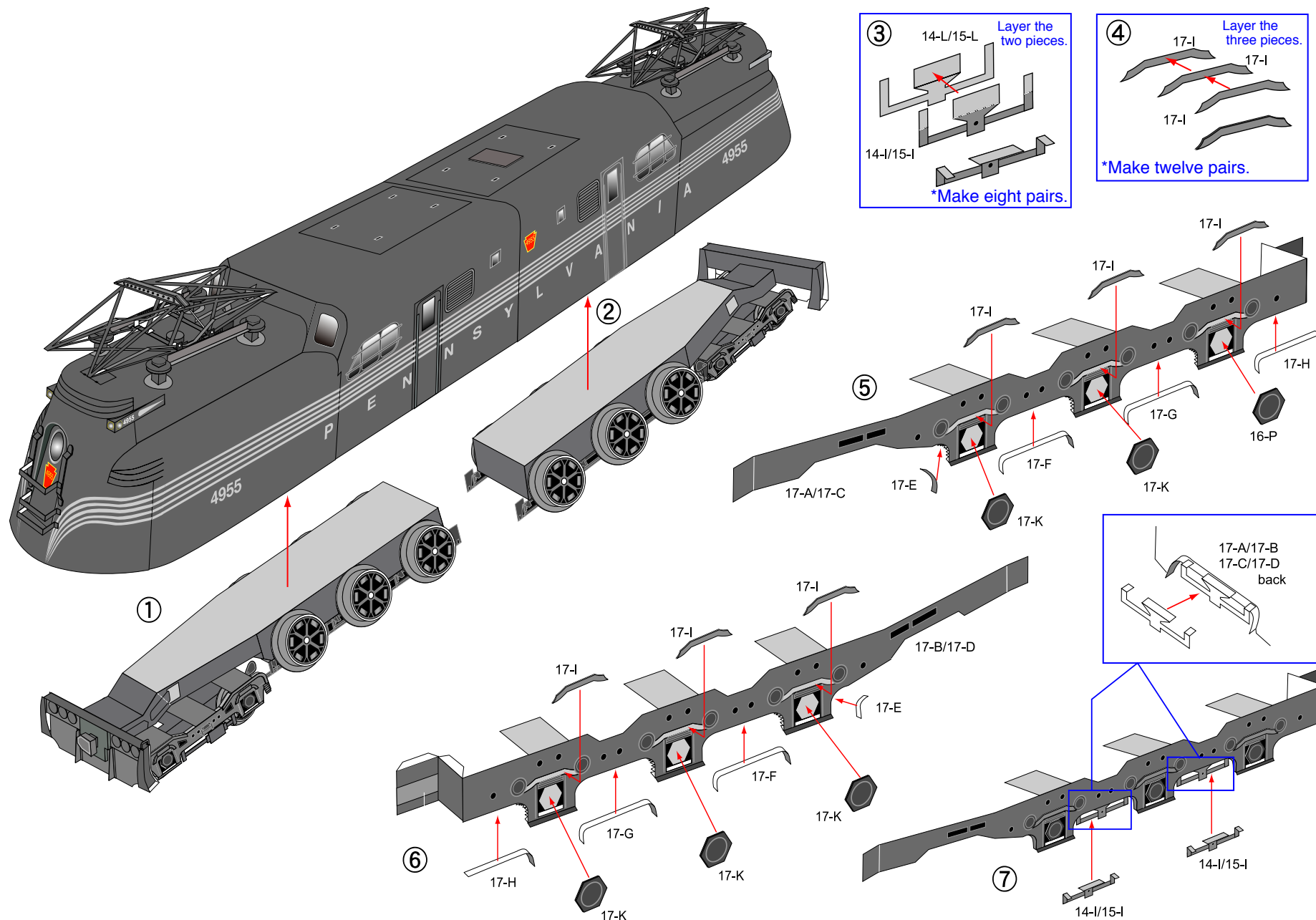

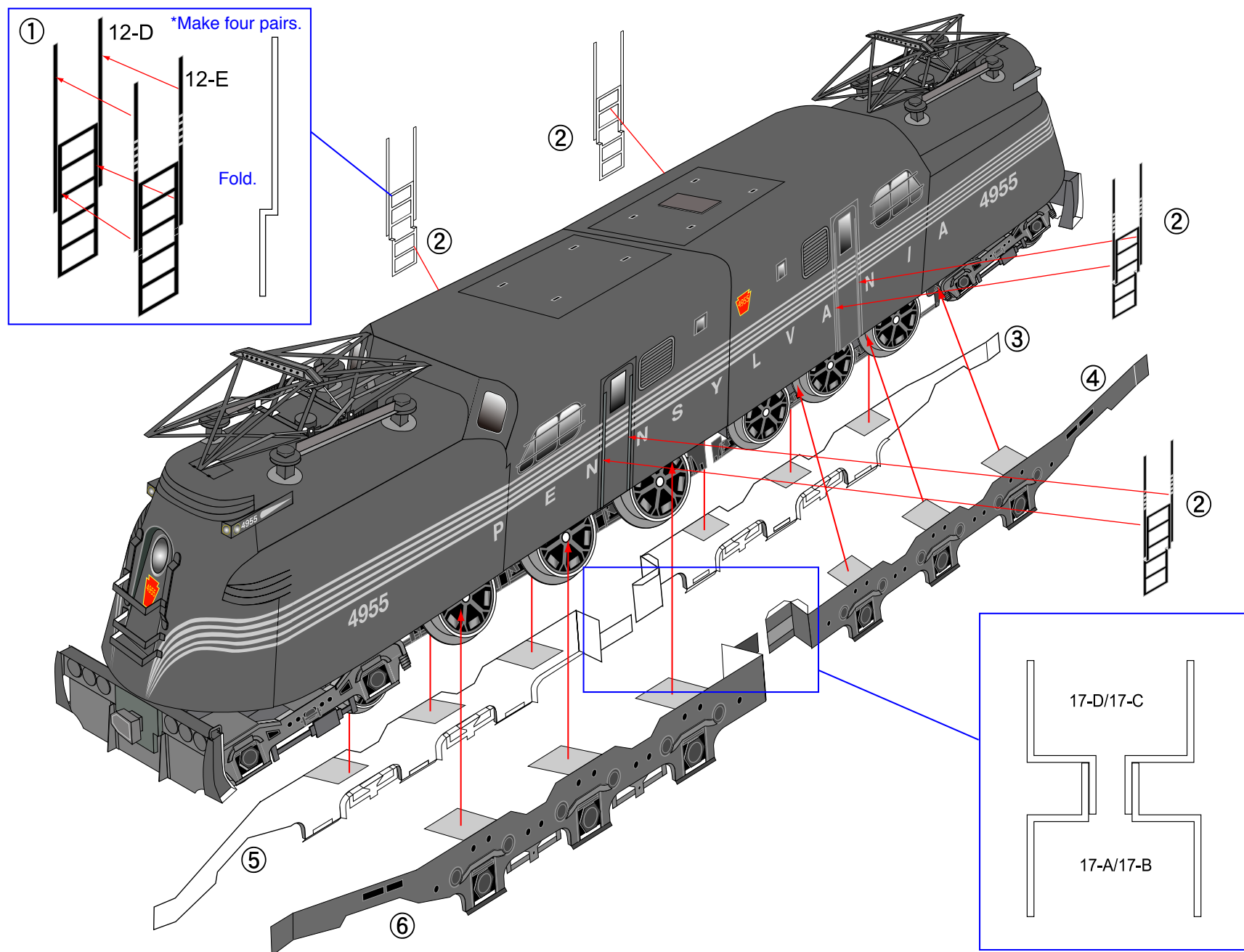

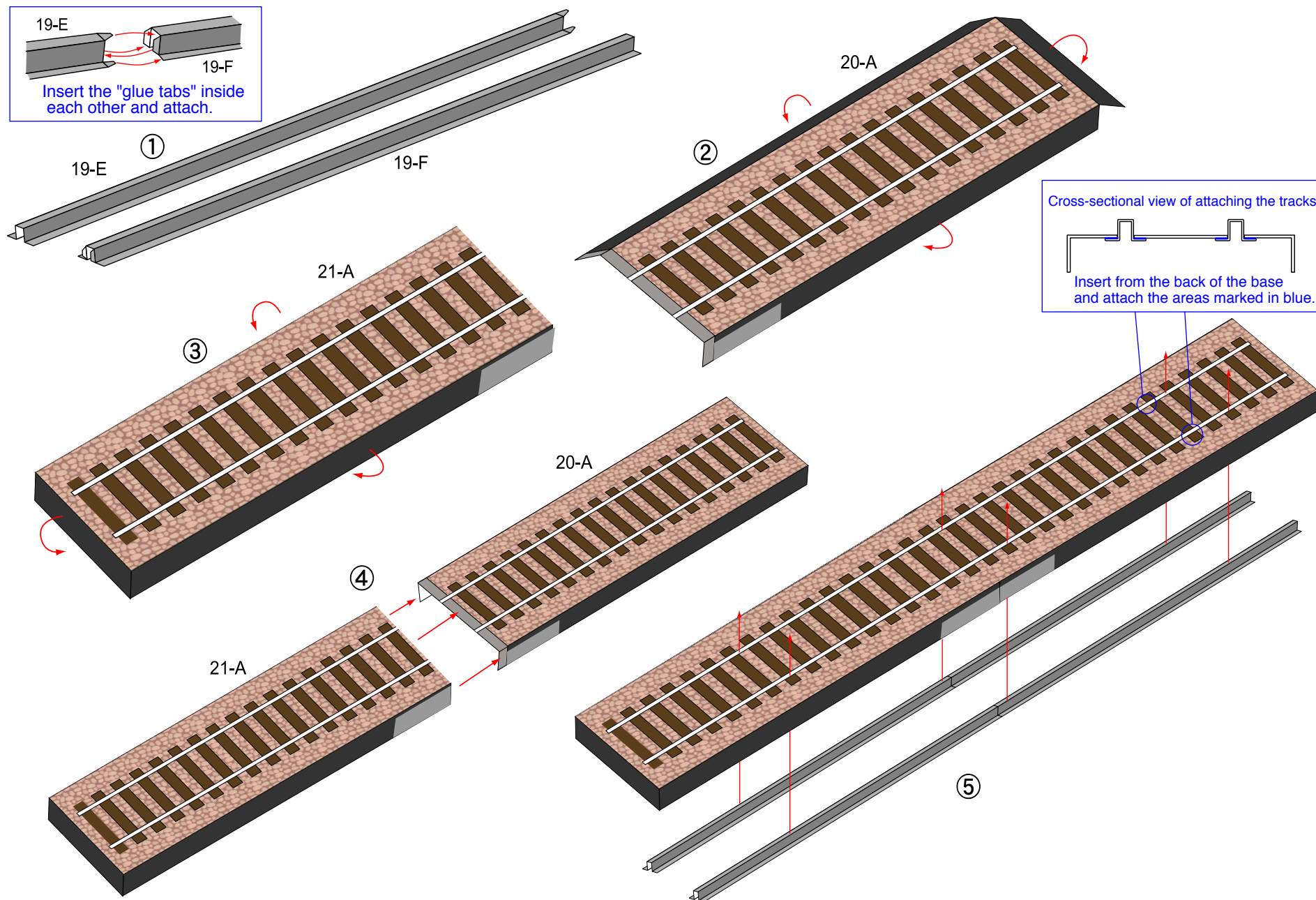

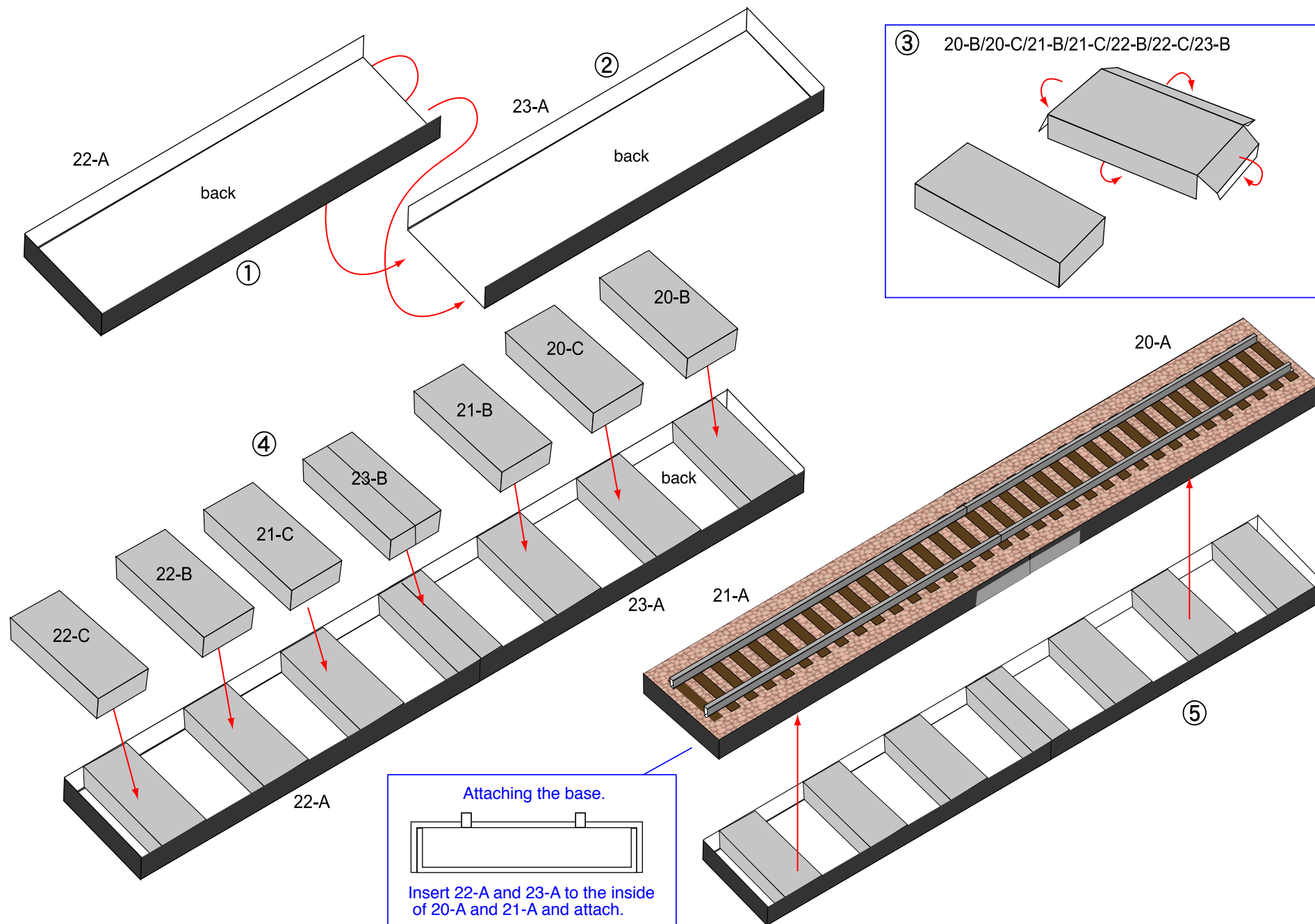

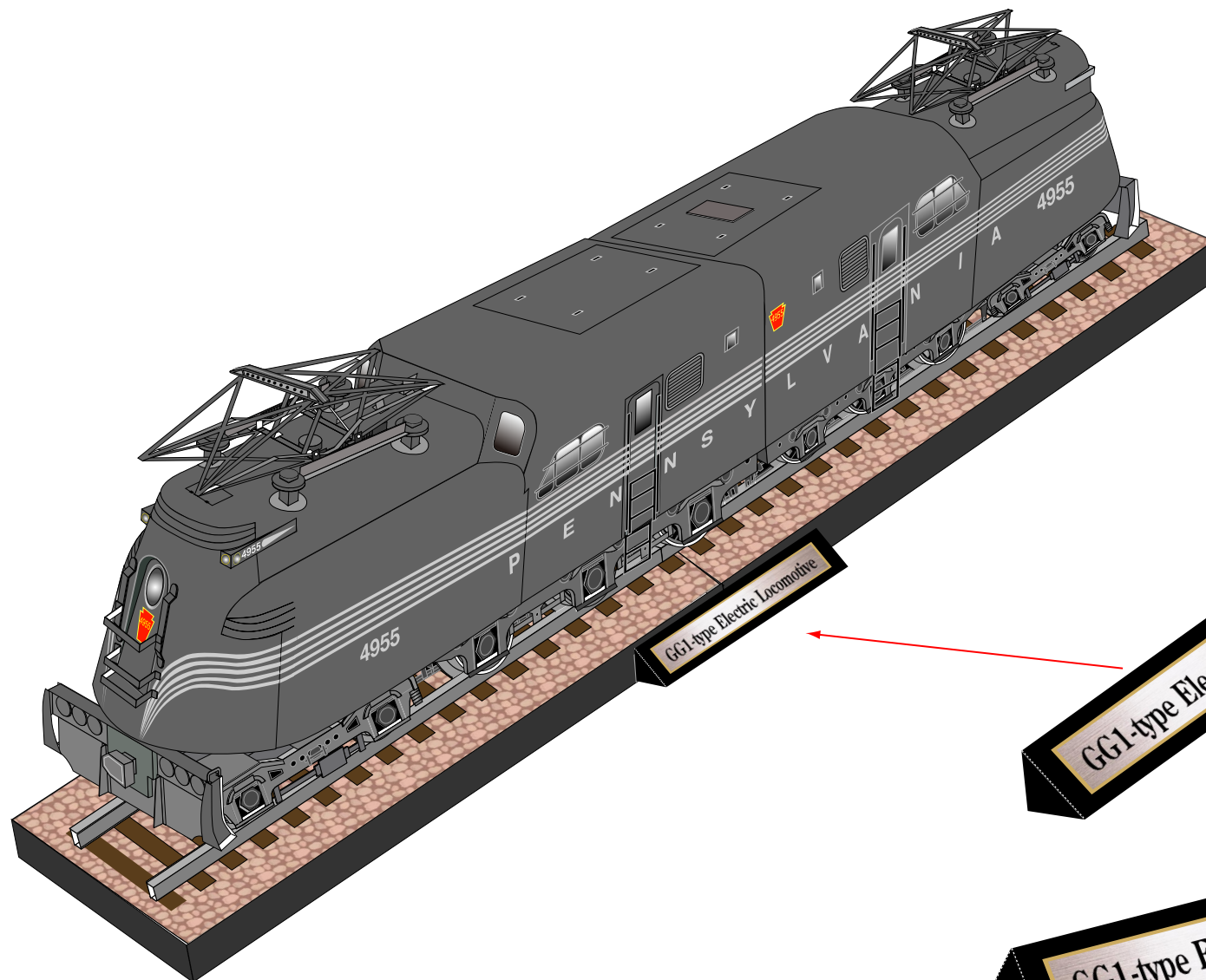

GG1-type Electric Locomotive

GG1-type Electric Locomotive

23-C

GG1-type Electric Locomotive

①