

Completed image



Example arrangement









You will need

- Scissors, glue, ruler, dried-up ballpoint pen, rounded pencil (or similar object)

Assembly tips

- Begin by placing the ruler against the fold lines and drawing the empty ballpoint pen over them so that it is easy to make clean folds.
- Shaping the stem by rounding it using the rounded pencil or similar object will make it easier to roll.

Lines and icons

- Scissors line 
- Mountain fold 
- Valley fold 
- Indicator line 
- Cut out 
- Tips 

Caution

- *Glue, scissors and other tools and materials may be harmful to children.
Please keep your work out of the reach of children.

Cut out the parts

Cut out the parts shown below, along the scissors lines.

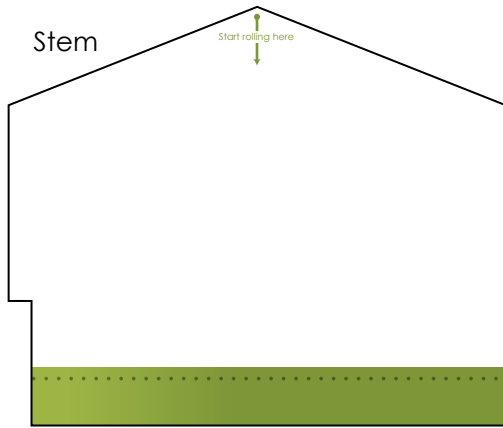

Central part

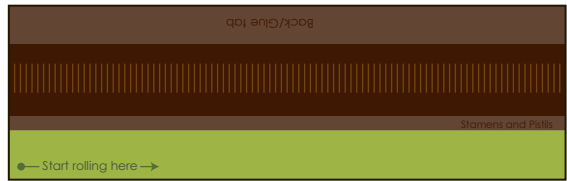

Finishing tape 1



Finishing tape 2



Cut out the parts below, along the lines of the squares around them, fold them in half and glue together. Then, cut out the parts themselves.

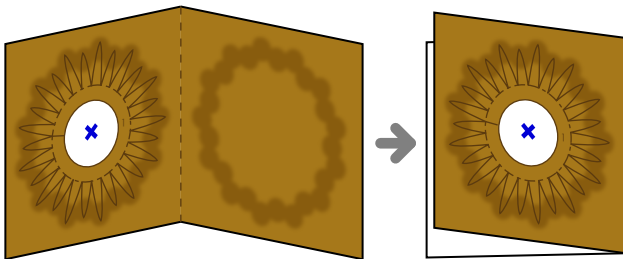

Stamens and Pistils 1,2

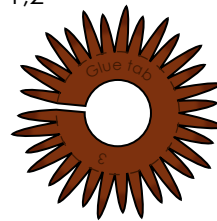
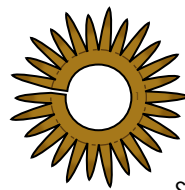

Stamens and Pistils 3,4

Stamens and Pistils 5

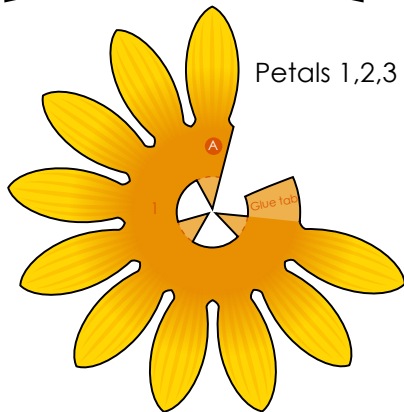
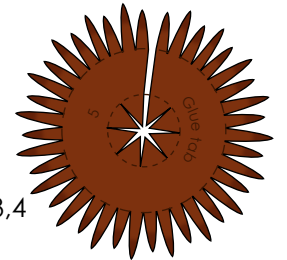

Petals 1,2,3

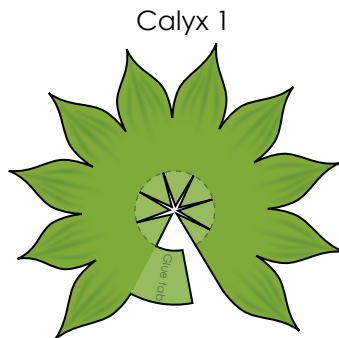

Calyx 1

Calyx 2 (top)



Calyx 2 (bottom)

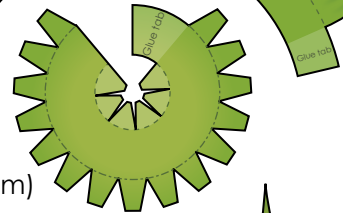

Leaves

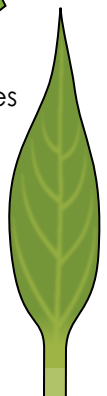

Cut along the square border around the calyx core, and glue it together in order as shown. Then, cut it out along the scissors lines.

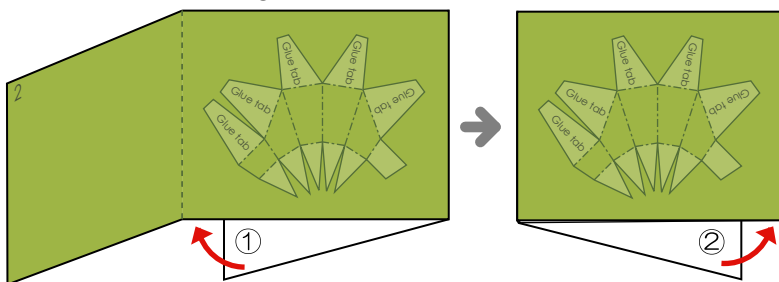

Calyx core

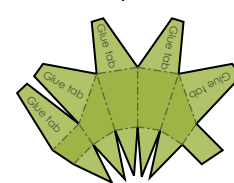

2 Make the stem

Roll tightly, beginning from the end marked "Start rolling here."

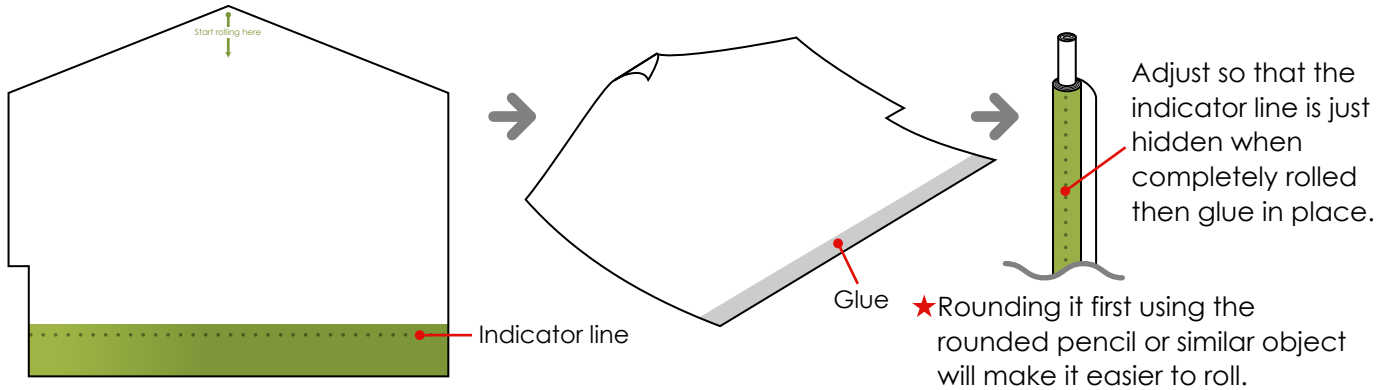

3 Make the stamen and pistils

Put glue on the back of the spot marked "Back/Glue tab" and glue together, without folding a crease down the central part.

Cut slits on the scissors lines along the folded over part, cutting through both layers of paper at once.

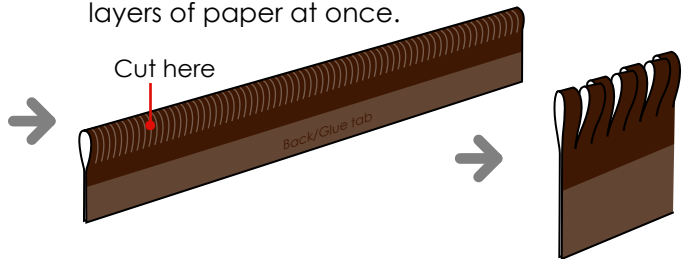
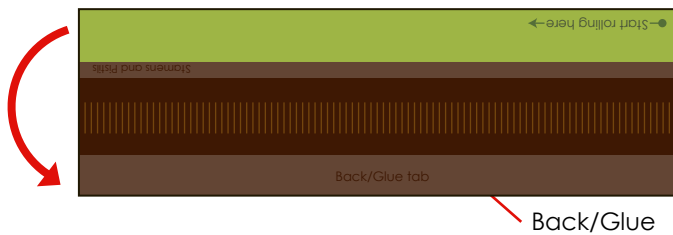

Roll up tightly beginning from "Start rolling here," and keeping the spot marked "Back/Glue tab" on the inside.

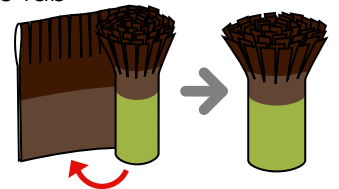

Make valley folds on the stamen and pistils to about 90°, and curve the tips outwards. Attach in order from 5, so that the fronds can be seen between each other, and fold the glue tabs on 5.

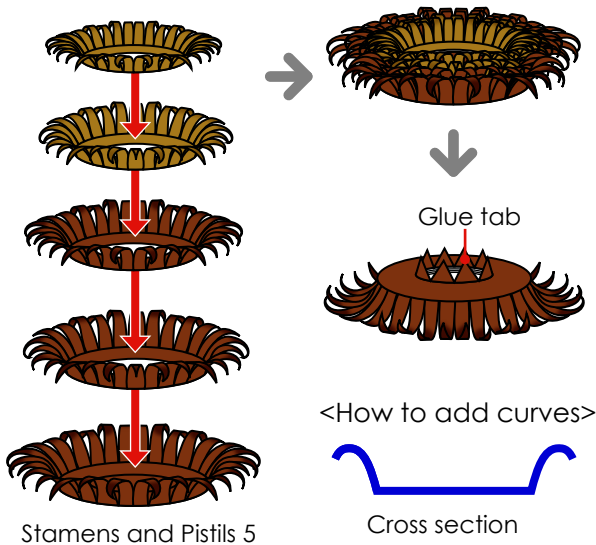

Insert the central part you have rolled up, and attach the stamen and pistils' glue tab to the position marked "Stamen & Pistils."

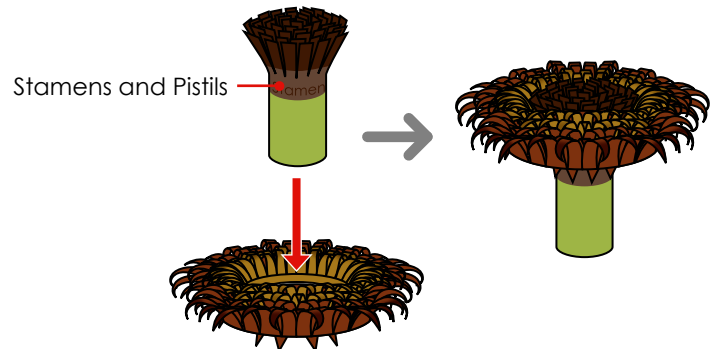

4 Make the petals

Attach the glue tabs on petals 1, 2 and 3 together, and add curves.

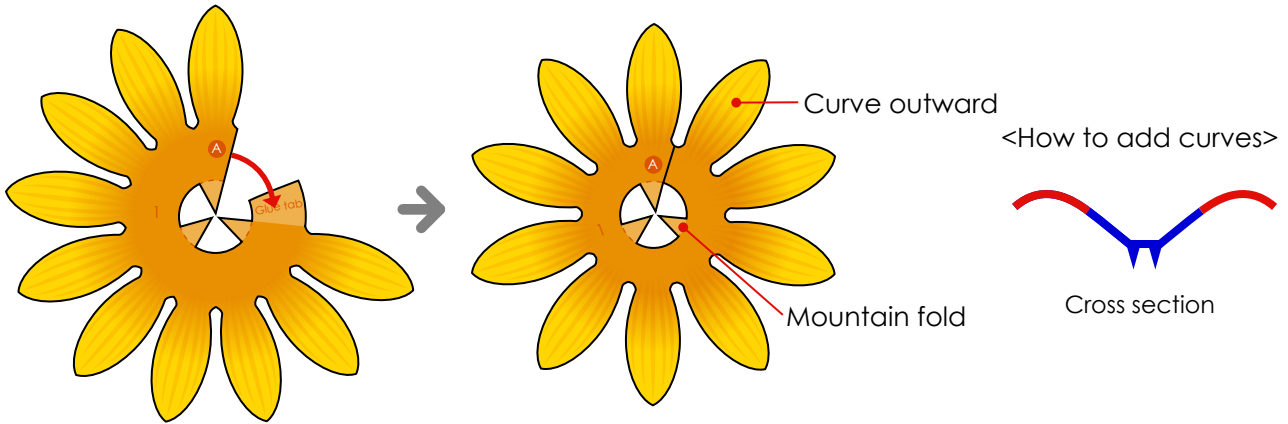

5 Make the calyx

Attach the glue tabs on calyx 1 together, and add curves.

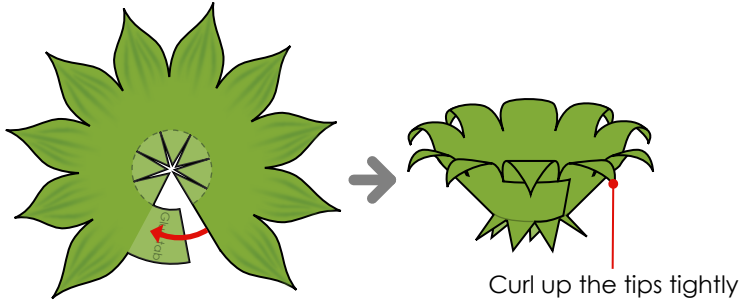

Attach the glue tabs on the calyx core together.

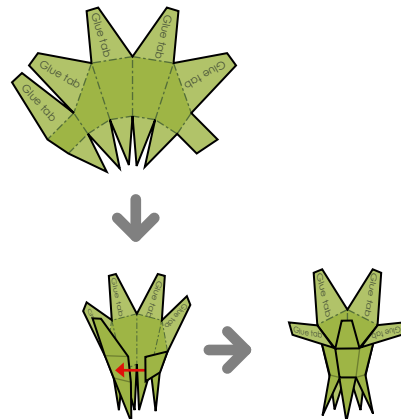

Attach the glue tabs on the top and bottom parts of the calyx together.

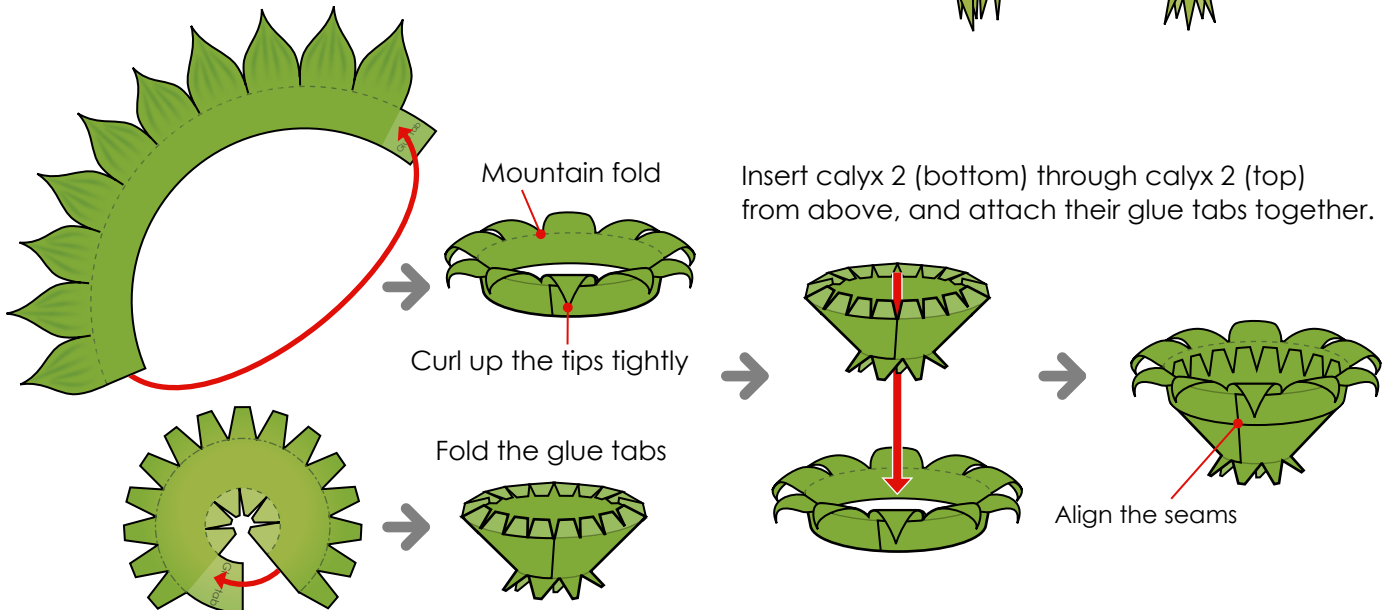

6 Complete the sunflower

Insert the central part you made in step (3) into petal 1, and glue them together. Align the points marked "A" on petals 2 and 3, and attach them in the same way.

Glue the pieces together so that calyx 1 can be seen between the petals on petal 3, and calyx 2 between petal 1.

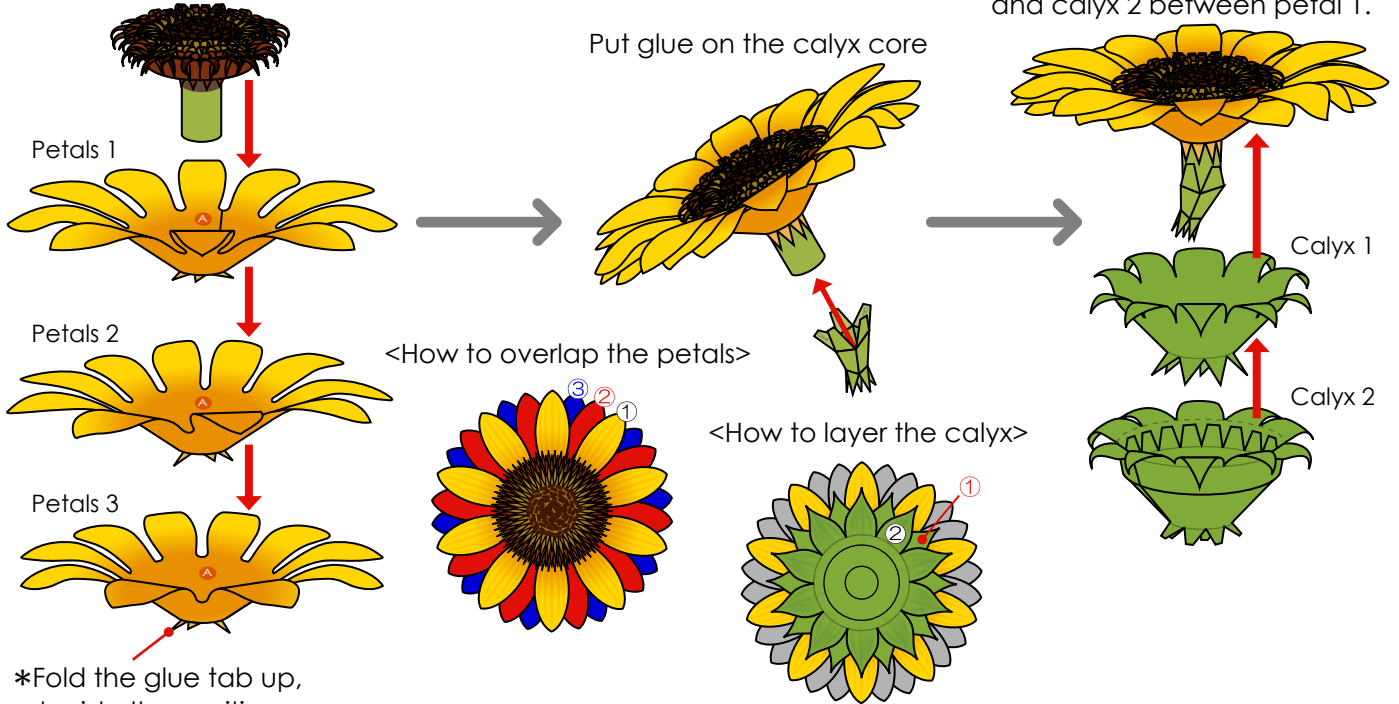

*Fold the glue tab up, decide the position, and then glue it down.

Attach the calyx core to the stem at whatever angle you like.

Put glue on finishing tape 1 and wrap it around, starting from the center.

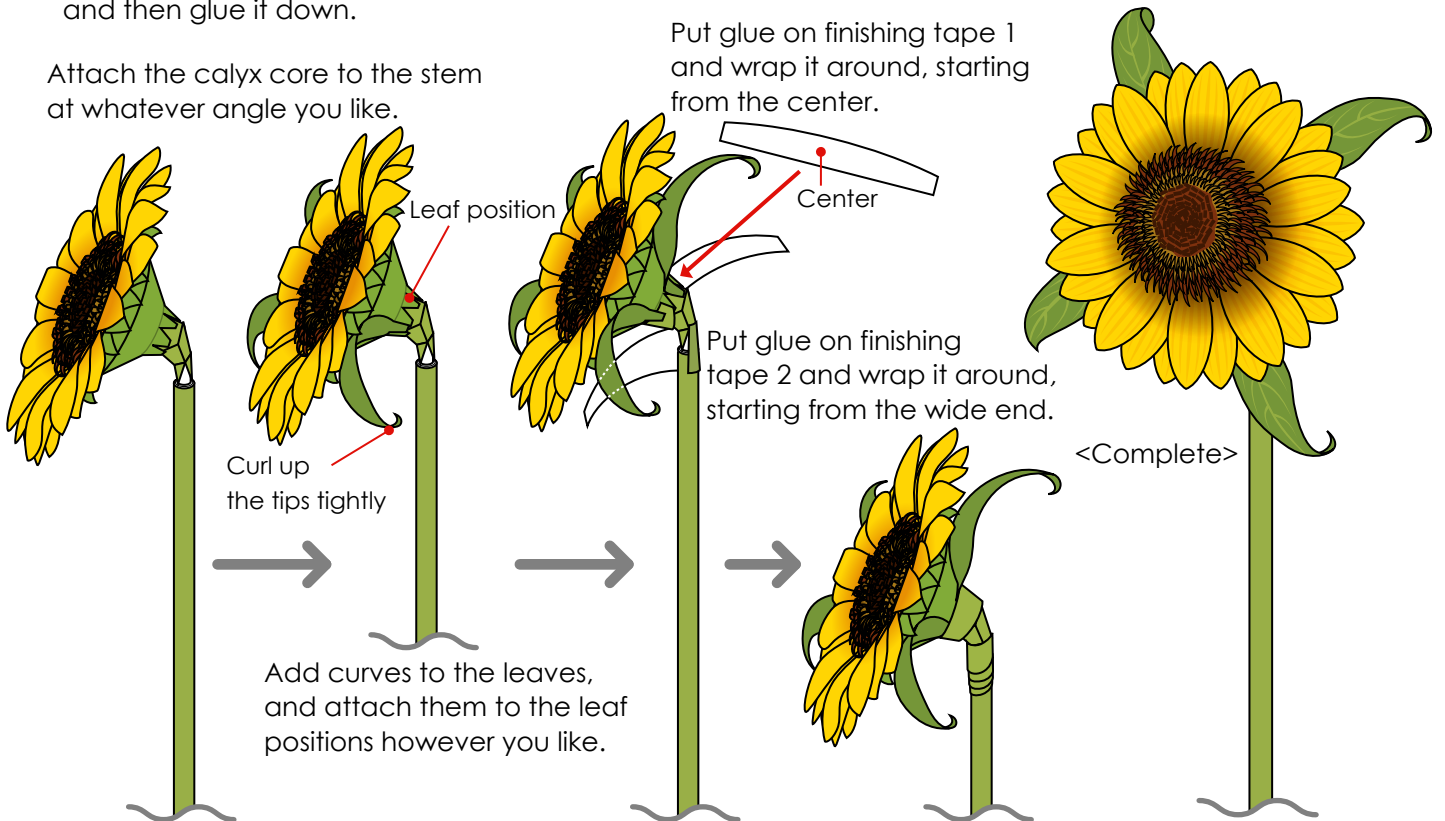

Add curves to the leaves, and attach them to the leaf positions however you like.