

Completed image



Example arrangement



You will need

- Scissors, glue, ruler, dried-up ballpoint pen, rounded pencil (or similar object)

Assembly tips

- Begin by placing the ruler against the fold lines and drawing the empty ballpoint pen over them so that it is easy to make clean folds.
- Shaping the stem by rounding it using the rounded pencil or similar object will make it easier to roll.

Lines and icons

- Scissors line _____
- Mountain fold - - - - -
- Valley fold - - - - -
- Indicator line • • • • •
- Tips ★

Caution

- *Glue, scissors and other tools and materials may be harmful to children.
Please keep your work out of the reach of children.

1 Make the Stem and Leaves

Cut the stem out along the scissors line and roll it tightly starting at "Roll here."

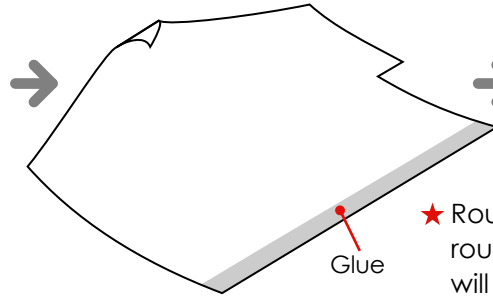
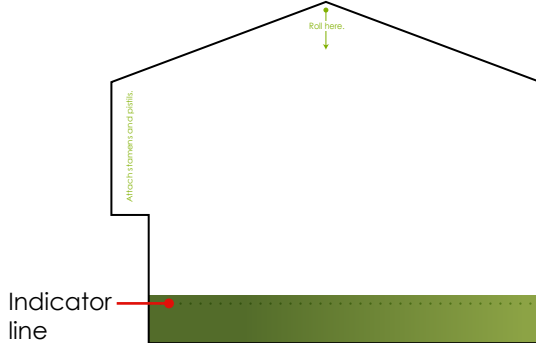

Adjust so that the indicator line is just hidden when completely rolled then glue in place.

★ Rounding it first using the rounded pencil or similar object will make it easier to roll.

Cut along the square border containing the leaves then fold in half, glue in place and cut the leaves out.

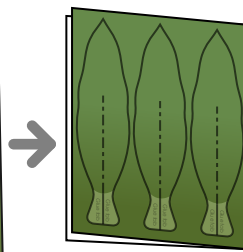
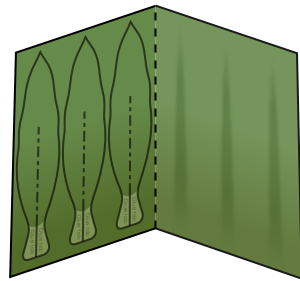

Cut along the scissors line at the bottom center of the leaf.

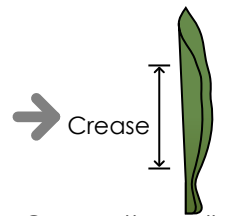
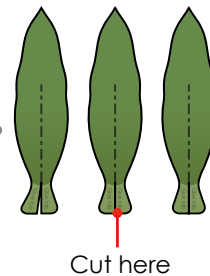

Crease the valley fold down the center.

2 Attach Stamens and Pistils to the Stem

Cut along the square border containing the stamens and pistils then fold in half, glue in place and cut them out.

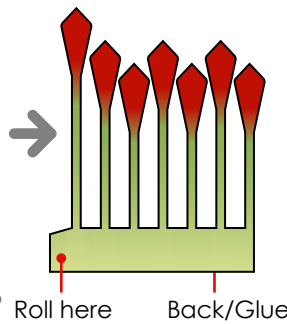
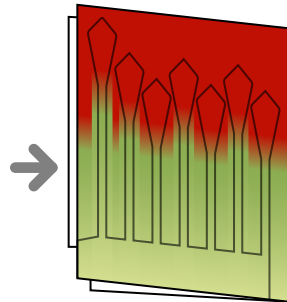
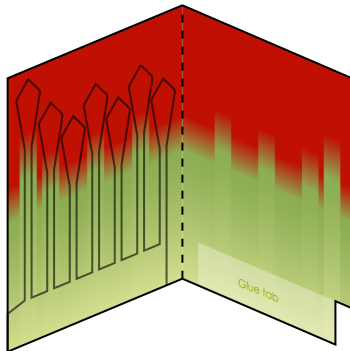

Spread glue on the glue strip at the bottom and, starting at "Roll here," tightly wrap it around the white part of the stem.

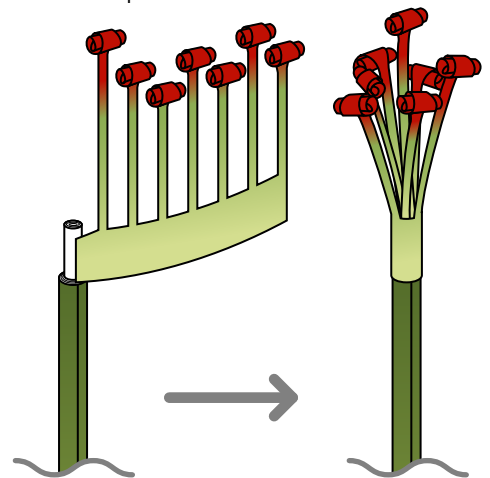

★ Pull on the glue tab as you wrap for a snug fit.

Roll tightly from the tip to the green border.

*Place "Roll here" on the left and roll toward you.

Roll it like a crescent roll.

3 Attach the Petals

Cut along the square border containing the petals then fold in half, glue in place and cut the petals out. Repeat this for each of the 3 large and small petals.

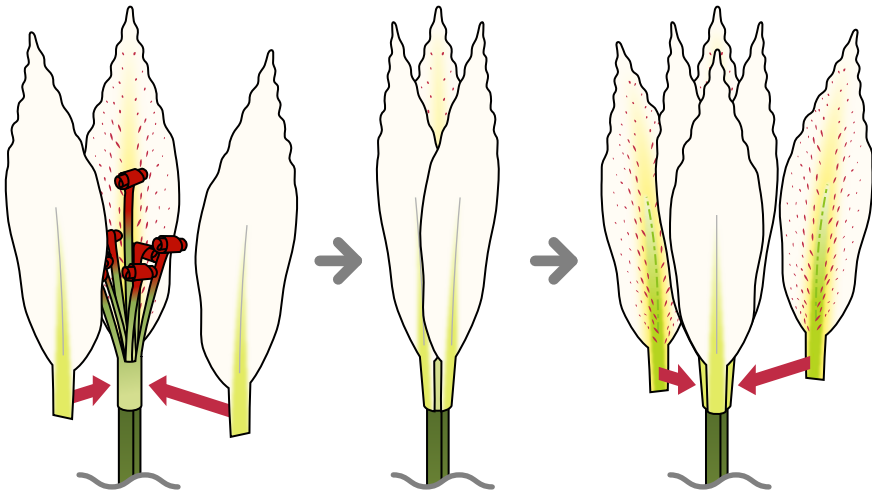
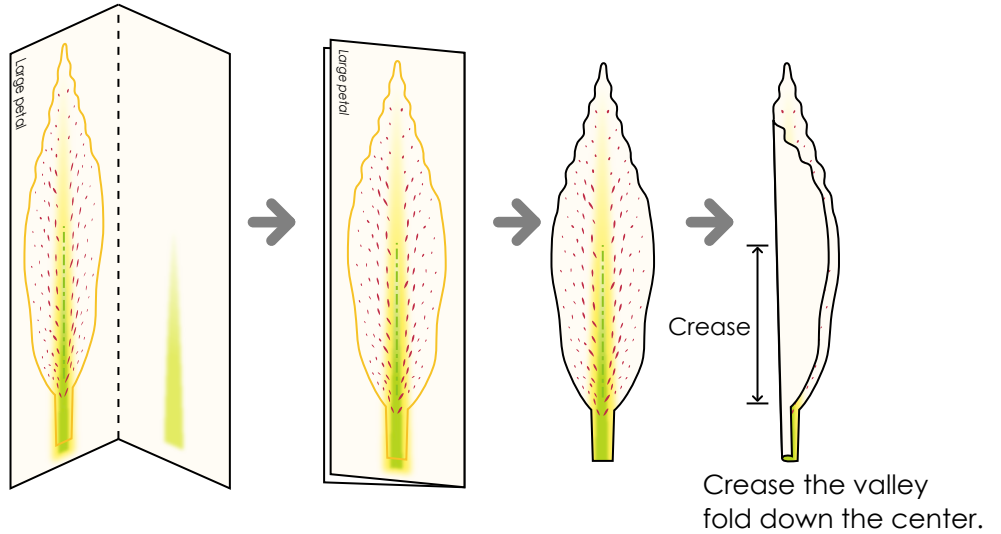

Glue the three large petals, spacing them evenly, onto the bottom strip of the stamens and pistils you made in step 2.

Once the glue has dried, glue the small petals in the spaces between the large petals.

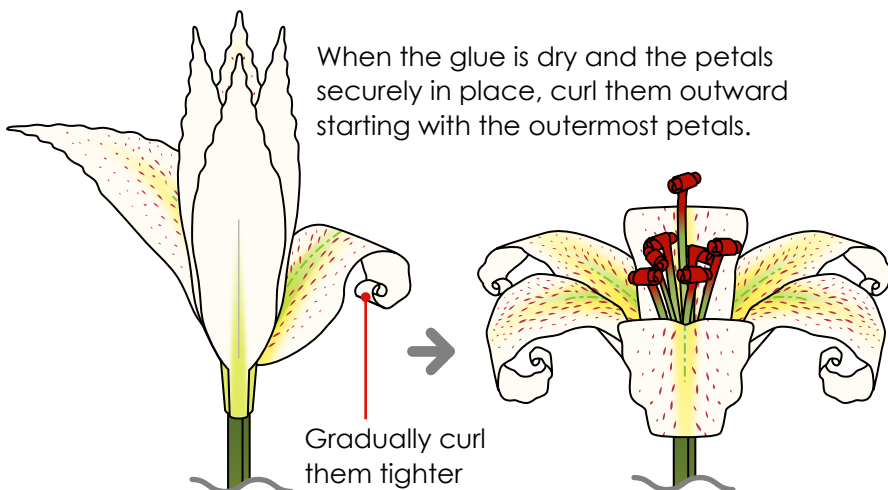

When the glue is dry and the petals securely in place, curl them outward starting with the outermost petals.

<Rounding the petals>

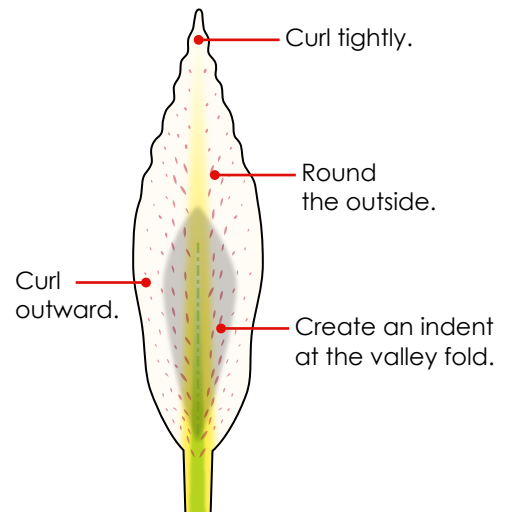

★ The petals sometimes flare out too much but they will settle in place when you attach the calyx.

4 Attach the Calyx and Leaves to Complete the Lily

Cut along the square border containing the calyx then fold in half, glue in place and cut the calyx out.

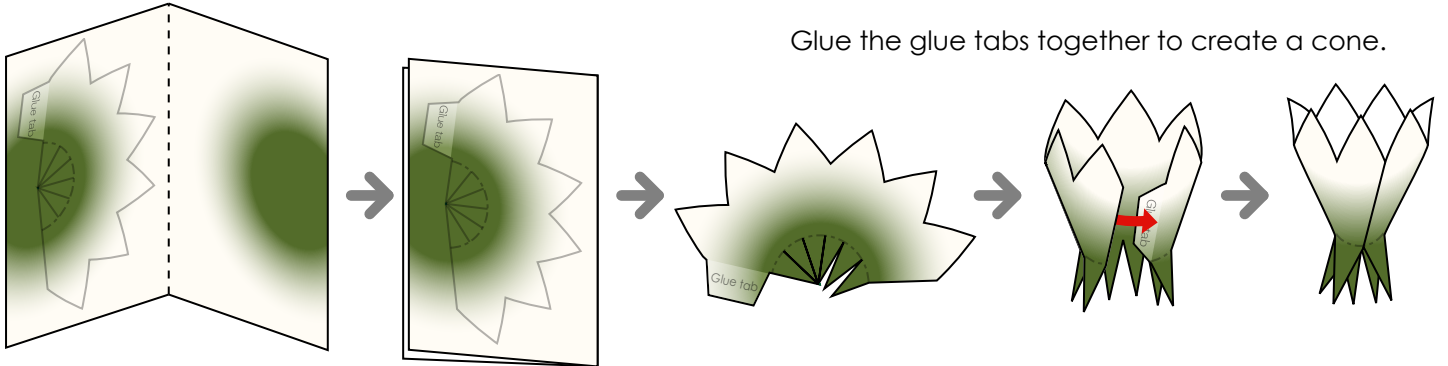

Glue the glue tabs together to create a cone.

Insert the bottom of the stem through the calyx you completed in step 3. Draw the calyx up to the attached portion of the petals and glue in place. Cut out the calyx tape along the scissors line. Spread glue on the inside surface and wrap it so that it hides the triangular parts of the calyx bottom and the attached portion of the petals.

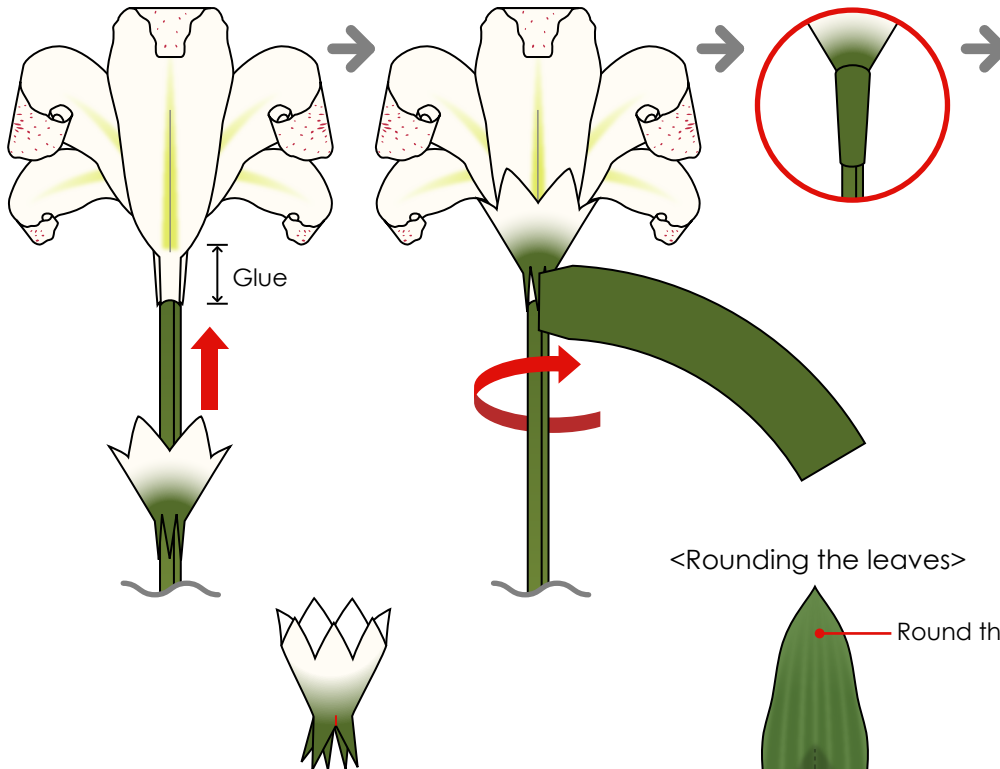

Finish by rounding the leaves and positioning them as desired.

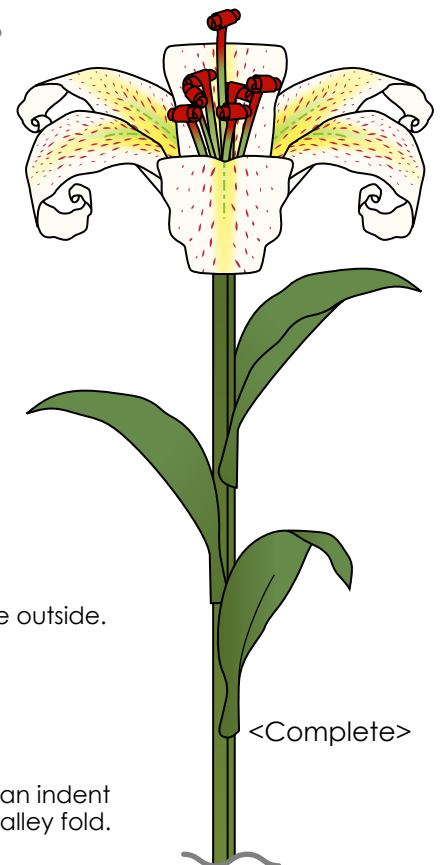

If the stem is too thick for the calyx to fit over, carefully adjust the calyx by cutting along the red lines at the tips of the triangles as shown above.

*Be careful not to cut too much!

If you want to tightly secure the petals, glue them directly to the inside of the calyx.

★ If you plan to arrange them with other flowers or in groups, we recommend deciding on the arrangement first before positioning the leaves.