

Assembly Instructions

- Carefully cut out the parts.
- Fold along the dotted lines, making mountain or valley folds as indicated.
- Attach the glue spots on each part together.
- Glue the parts together, and you're done!

*Please read the Assembly Instructions carefully before you begin.

Tools

- Scissors
- Glue (We recommend quick-drying paper glue)
- 3 rubber bands (preferably brand new ones)

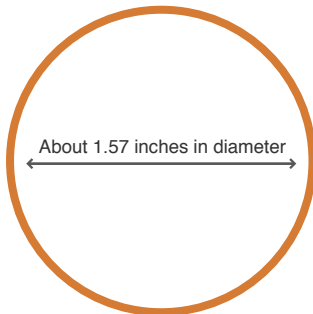

Actual size illustration:
check the size of your rubber bands here.

Notation Key

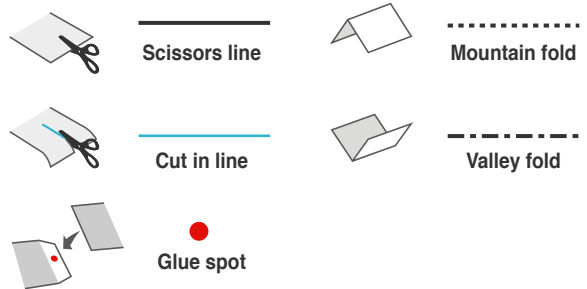

How to assemble your model neatly

Scoring along the fold lines in advance with a dried up pen or a ruler with slightly sharp corners will result in a neater model.

*Be careful not to press too hard as the paper may tear.

Caution

Keep scissors and glue away from small children.
Be careful not to cut your fingers when using scissors.

1 Assemble the tires

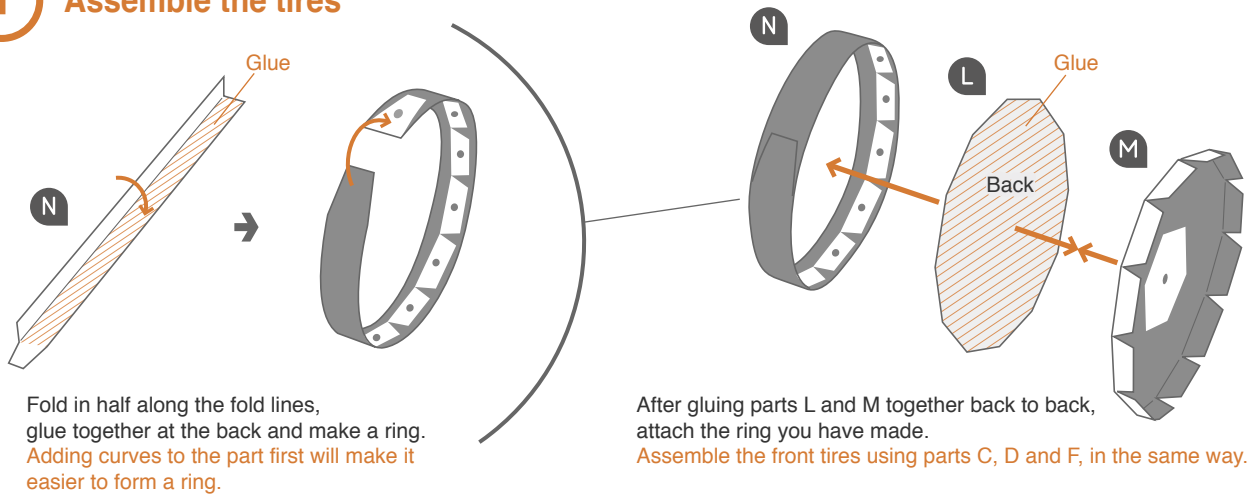

Fold in half along the fold lines, glue together at the back and make a ring. Adding curves to the part first will make it easier to form a ring.

After gluing parts L and M together back to back, attach the ring you have made. Assemble the front tires using parts C, D and F, in the same way.

2 Assemble the axle

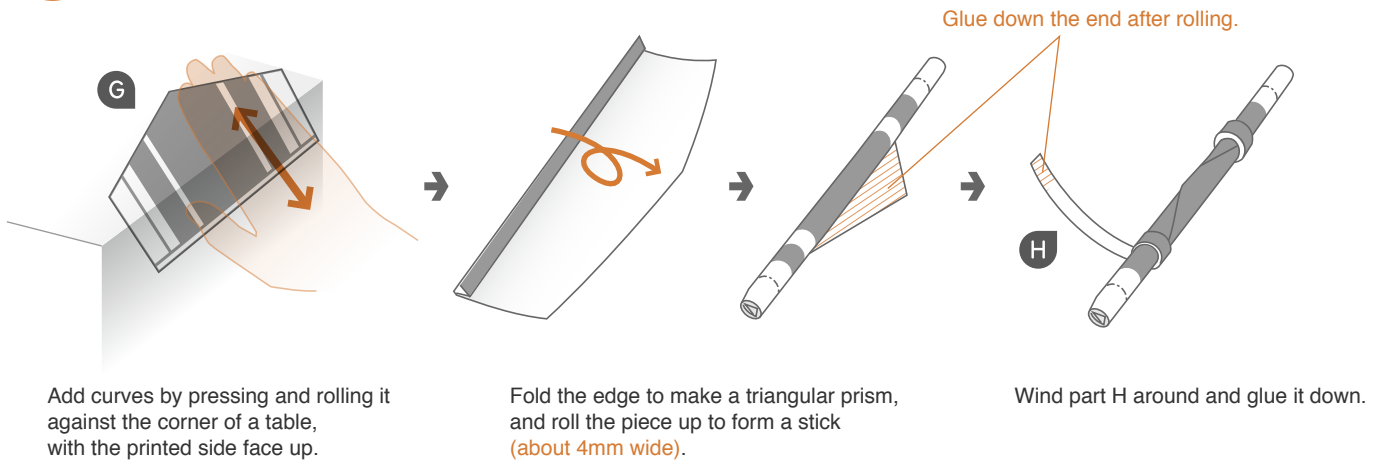

Add curves by pressing and rolling it against the corner of a table, with the printed side face up.

Fold the edge to make a triangular prism, and roll the piece up to form a stick (about 4mm wide).

Wind part H around and glue it down.

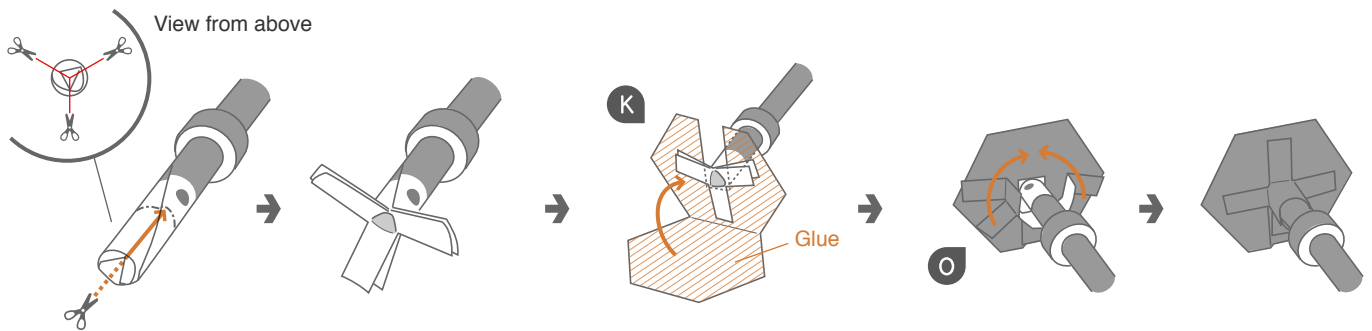

Cut three, equally-spaced slots in both ends of part G, up to the grey valley fold line, and bend them back.
*The fine strips of paper are thick and hard so be careful of paper cuts.

Attach part K, enveloping it around the parts you cut and bent back. Attach the other side too.

Attach part O to both ends. Follow the same process to assemble the other axle.

3 Assemble the front and back wheels

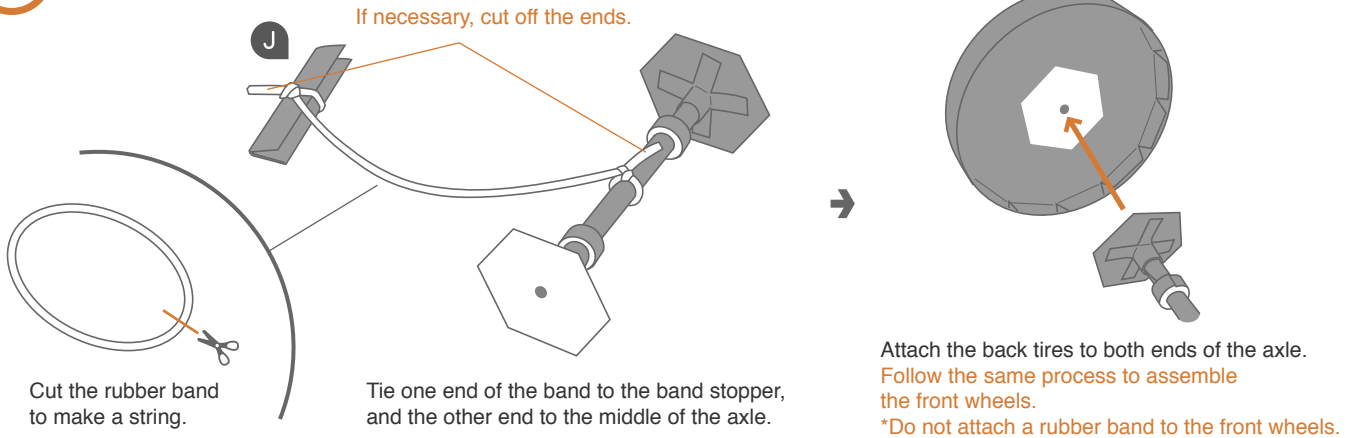

4 Assemble the head and beak

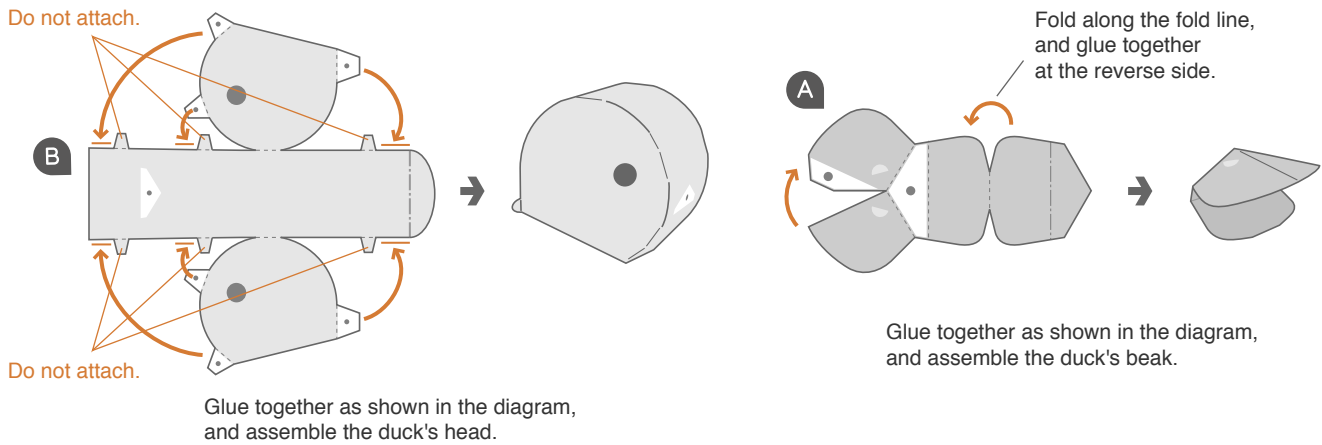

5 Assemble the body

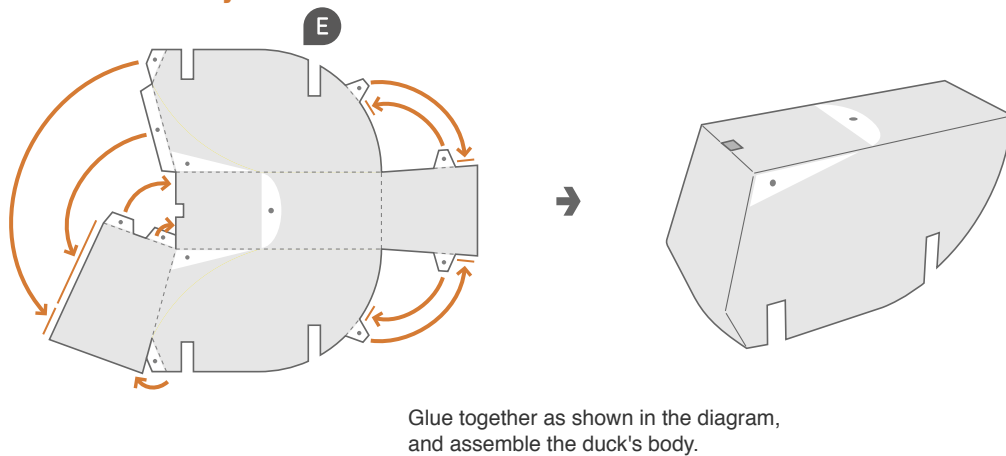

6 Attach the wheels

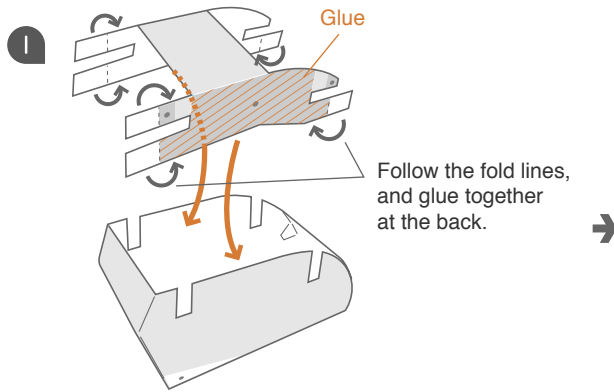

After turning the duck's body over, glue the tummy to it.

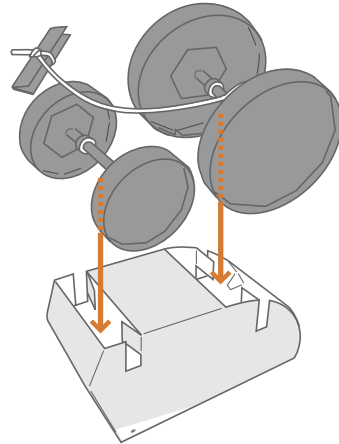

Being careful not to mix up the front and back wheels, put the axles into the grooves on the body.
Check that the wheels spin smoothly.

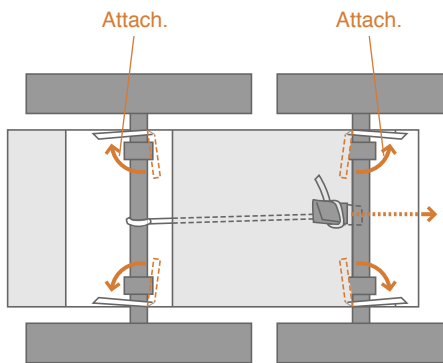

Feed the band stopper through the hole at the front of the body to the outside.
Be careful that the band doesn't come undone.

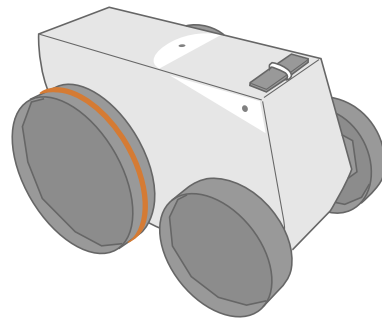

Check that the band stopper doesn't come loose, and wind the rubber band around the back wheels (with the larger tires).

7 Assemble together

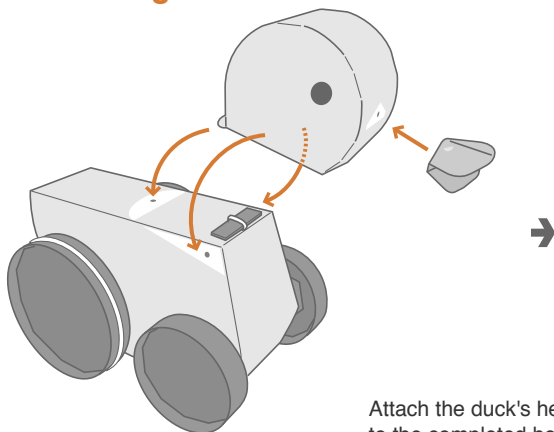

Attach the duck's head and beak to the completed body, and you're done!

How to play

Pull the car backwards along the ground, gently pushing down on the back wheels. Point the car in the direction you want it to run, let it go and watch it take off!

Be careful not to wind the band too tightly as it may snap or come untied. Play with it on a flat surface such as a table or the floor (wooden floorboards work better than carpet).

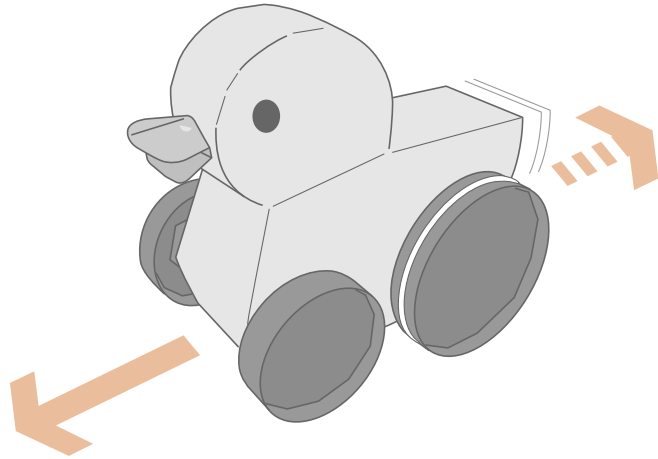

If your car doesn't run well, check the following points to repair it.

- | | |
|---|--|
| <input type="checkbox"/> Are the axles or tires stuck against the body? | <input type="checkbox"/> Are the wheels or tires bent? |
| <input type="checkbox"/> Has the band lost its elasticity? | <input type="checkbox"/> Is the band wound up too tightly? |
| <input type="checkbox"/> Has the band come loose from the tire? | <input type="checkbox"/> Is the band tangled up around the axle? |