



# (Moving) Clowns out of a cannon : Assembly Instructions

© Canon Inc. © Hideharu Naitoh & G&P

Canon

1

## CREATIVE PARK

<http://www.canon.com/c-park/>



View of completed model

\* When you pull the lever on the right, a clown shoots out of the cannon. It is a fun craft.

### ■ Assembly Instructions : Fifteen A4 sheets (No. 1 to No. 15)

\* Build the model by carefully reading the Assembly Instructions, in the parts sheet page order.

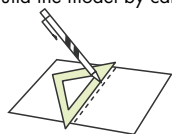

\*Hint: Trace along the folds with a ruler and an exhausted pen (no ink) to get a sharper, easier fold.

### Assembly Instructions



**Mountain fold(dotted line)**  
Make a mountain fold.



**Valley fold(dashed and dotted line)**  
Make a valley fold.



**Scissors line(solid line)**  
Cut along the line.



**Cut in line(solid line)**  
Cut along the line.

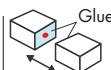

**Glue**  
The glue spot(colored dot) shows where to apply the glue.



**Glue spot(Red dot)**  
Glue parts with the same number together.



**Glue spot(Green dot)**  
Glue within the same part.



**Glue spot(Blue dot)**  
Glue to the rear of the other part.

#### Tools and materials



Scissors, set square, glue(We recommend stick glue), pencil, used ballpoint pen, toothpicks, tweezers, (useful for handling small parts)

#### Assembly tip



Before gluing, crease the paper along mountain fold and valley fold lines and make sure rounded sections are nice and stiff.

#### Caution



Glue, scissors and other tools may be dangerous to young children so be sure to keep them out of the reach of young children.

Before starting assembly : Writing the number of each section on its back side before cutting out the sections is highly recommended.  
(\* This way, you can be sure which section is which even after cutting out the sections.)

→ Indicates where sections should be glued together.  
→ Indicates where to insert sections.  
Do not glue the sections together.  
→ Indicates the order for assembling parts.



Round bar : Use to give parts a curved surface.



Tweezers : Useful in working with fine parts.



Be sure to build this model carefully.

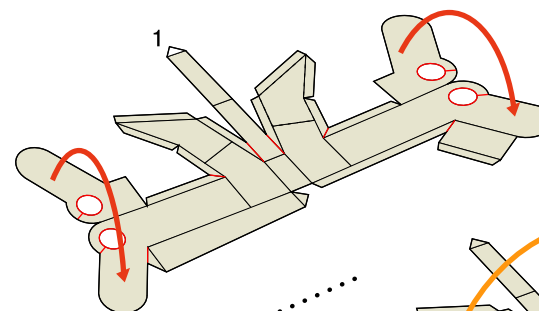

Firmly form the shape as you glue to prevent distortion.

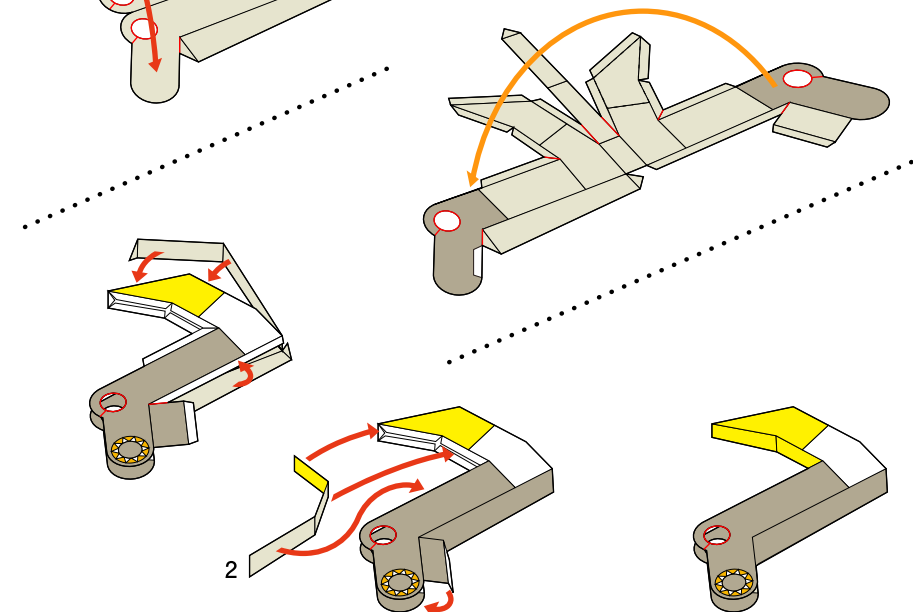

Parts 1 and 2



# (Moving) Clowns out of a cannon : Assembly Instructions

© Canon Inc. © Hideharu Naitoh & G&P

Canon

2

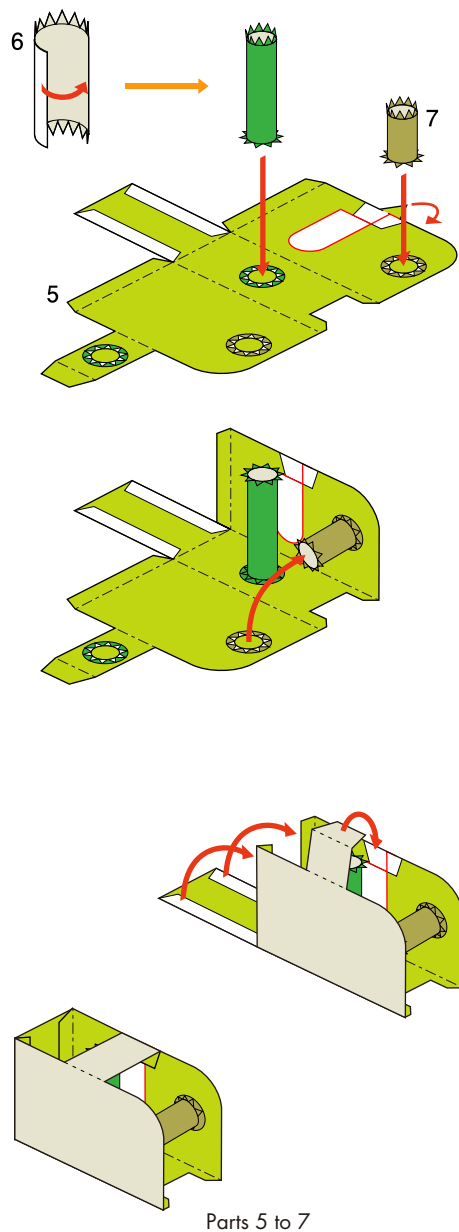

Spread glue in a thin, even layer before gluing surfaces together.

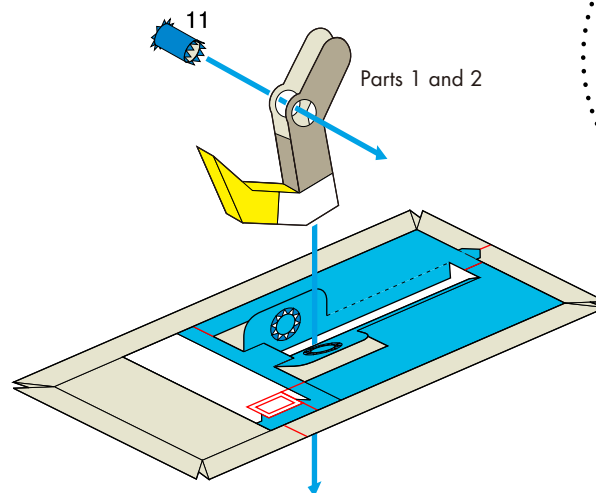
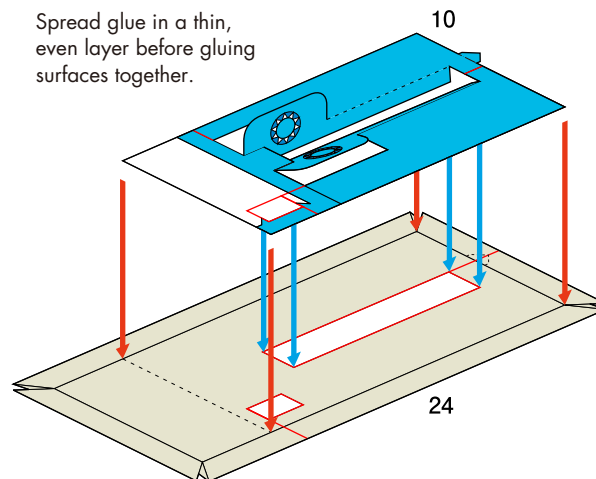

Glue one side of the shaft (Part 11), and then check if the Parts 1 + 2 go through the center of the rectangular hole in Part 10.

Then glue the other side.

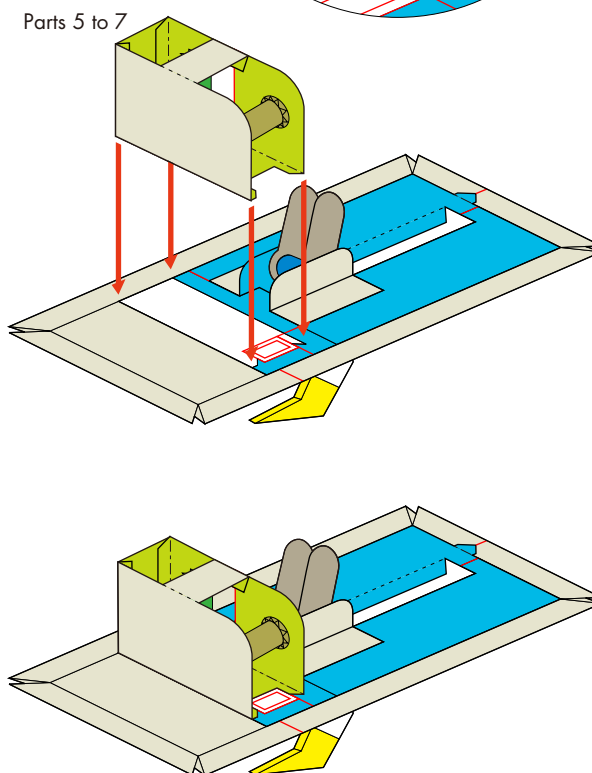
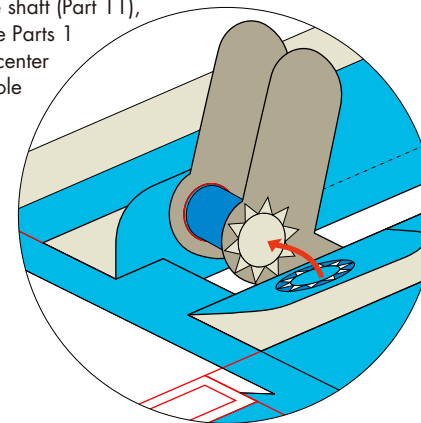



## (Moving) Clowns out of a cannon : Assembly Instructions

© Canon Inc. © Hideharu Naitoh & G&P

Canon

3

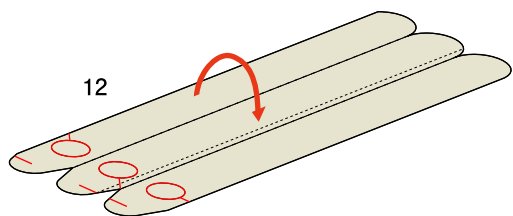

12

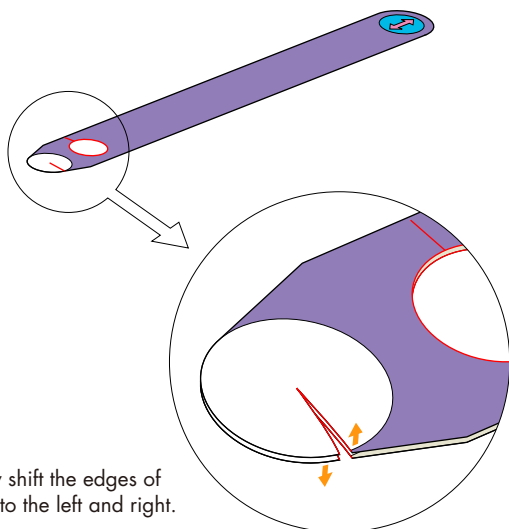
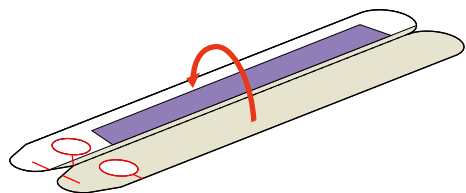

Slightly shift the edges of the slit to the left and right.

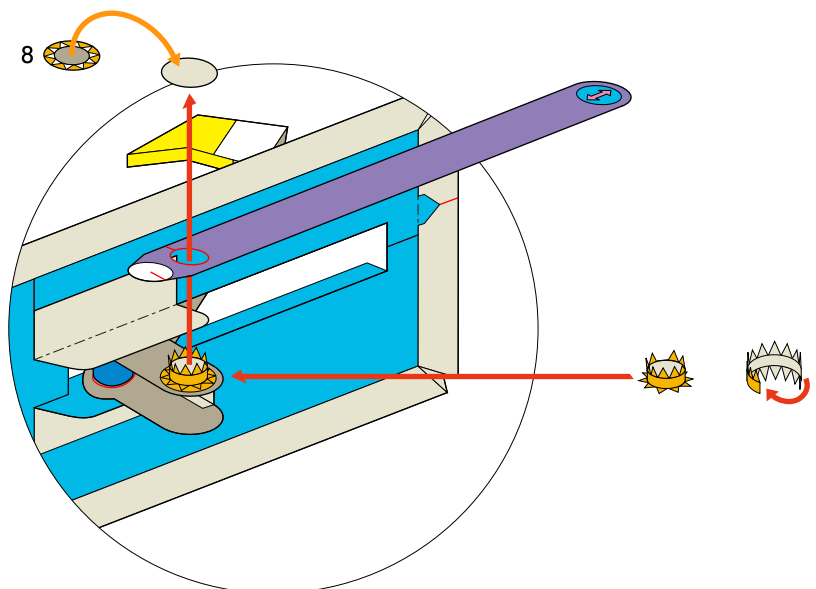

8

9

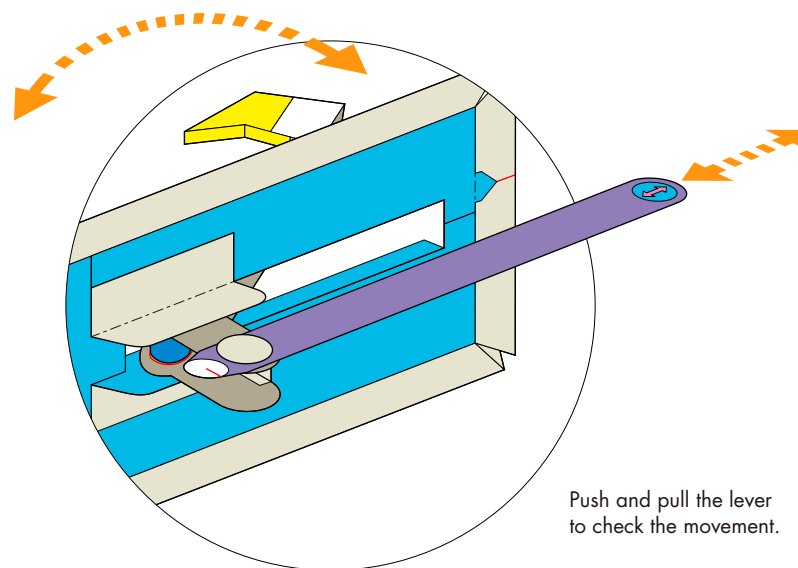

Push and pull the lever to check the movement.



## (Moving) Clowns out of a cannon : Assembly Instructions

© Canon Inc. © Hideharu Naitoh & G&P

Canon

4



Curl the section of Part 14 that will form a cylinder with a round bar.

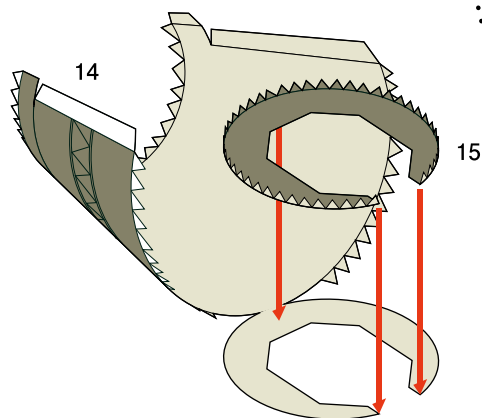

Parts 14 and 15

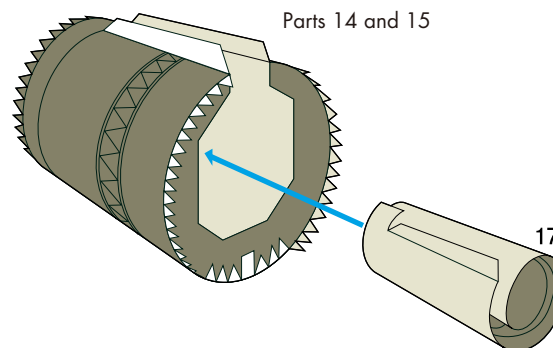

Roll Part 17 tightly, insert into Parts 14 + 15 and then unroll.

Glue together to the pasting margins of Parts 14 and 17.

**Note :** Do not apply glue to parts other than the pasting margins.

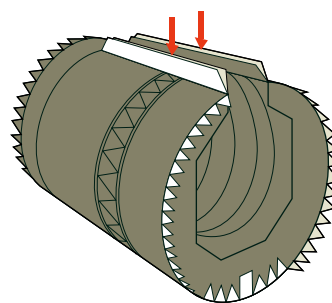

Parts 14, 15 and 17

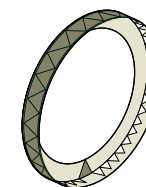
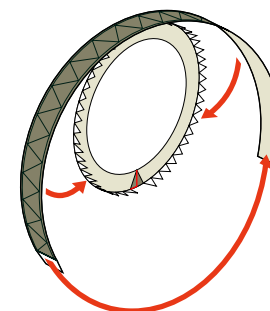
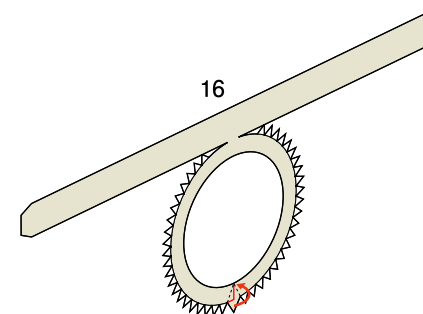



## (Moving) Clowns out of a cannon : Assembly Instructions

© Canon Inc. © Hideharu Naitoh & G&P

Canon

5

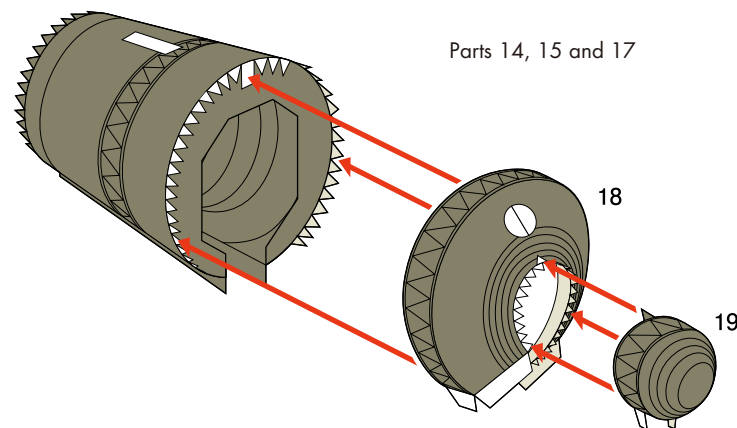
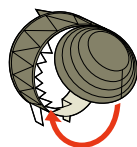
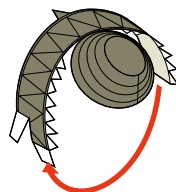
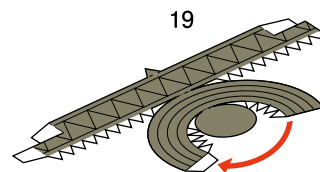
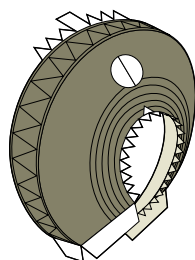
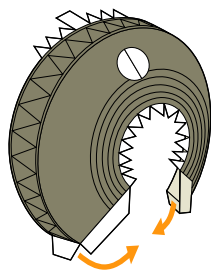
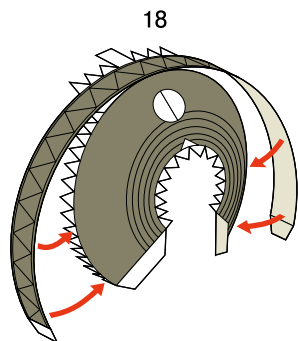

Insert the tip of Part 14 into Part 16 and glue.

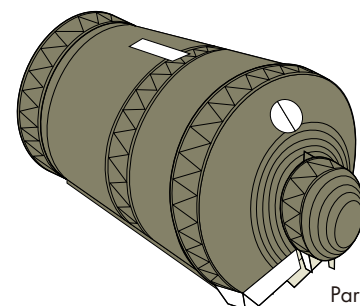
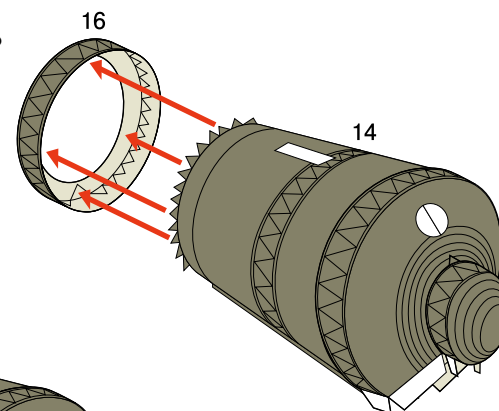

Parts 14 to 19



# (Moving) Clowns out of a cannon : Assembly Instructions

© Canon Inc. © Hideharu Naitoh & G&P

Canon

6

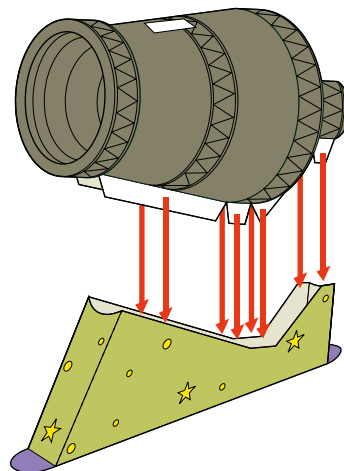
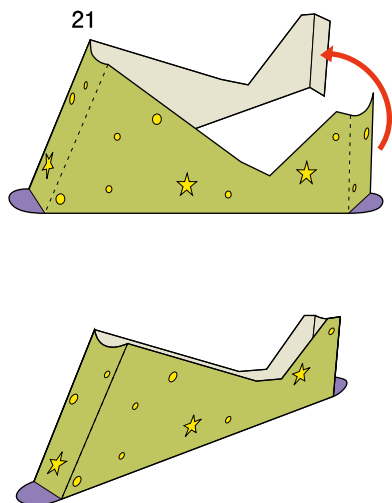

Parts 14 to 19

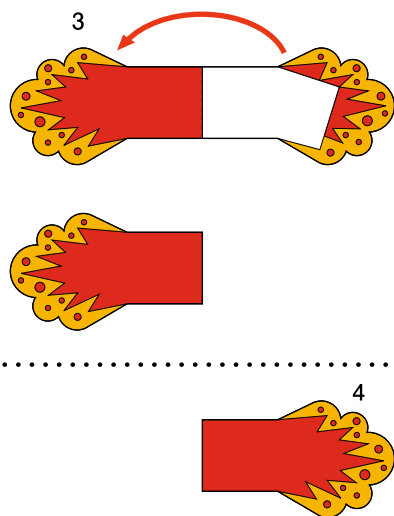
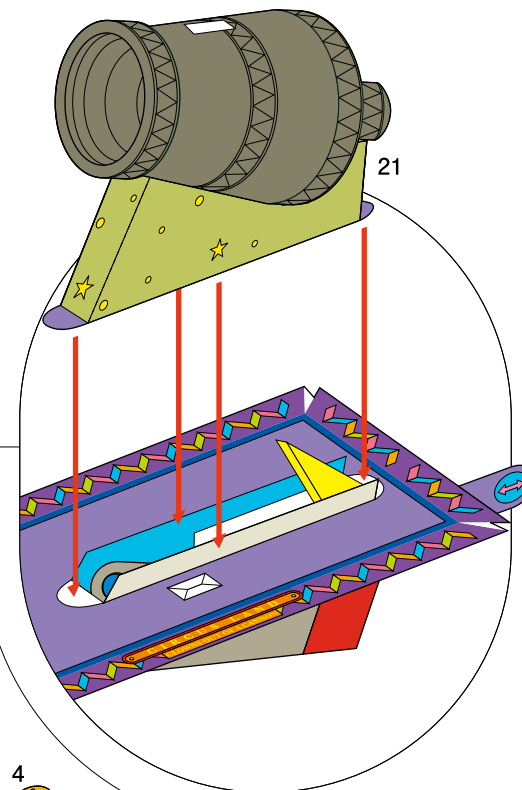

Prepare part 4 in the same way.

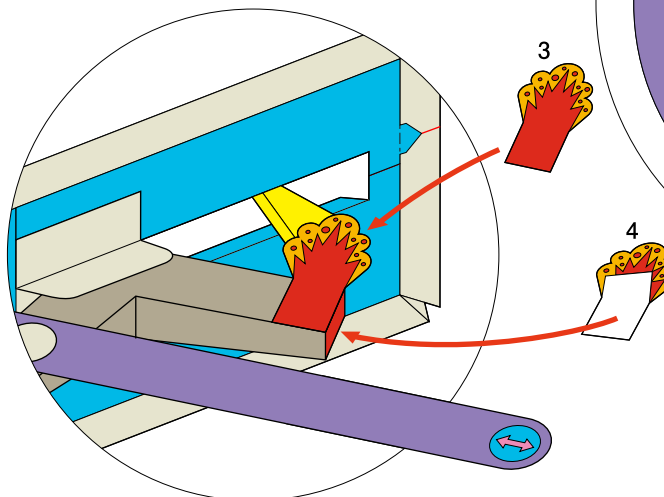

Glue the cannon battery (Part 21) to the pasting margins on both sides of Part 10.

Then, glue the semi-circular pasting margins in the front and rear.



## (Moving) Clowns out of a cannon : Assembly Instructions

© Canon Inc. © Hideharu Naitoh & G&P

Canon

7

Glue the 4 corners of the top board of the base.

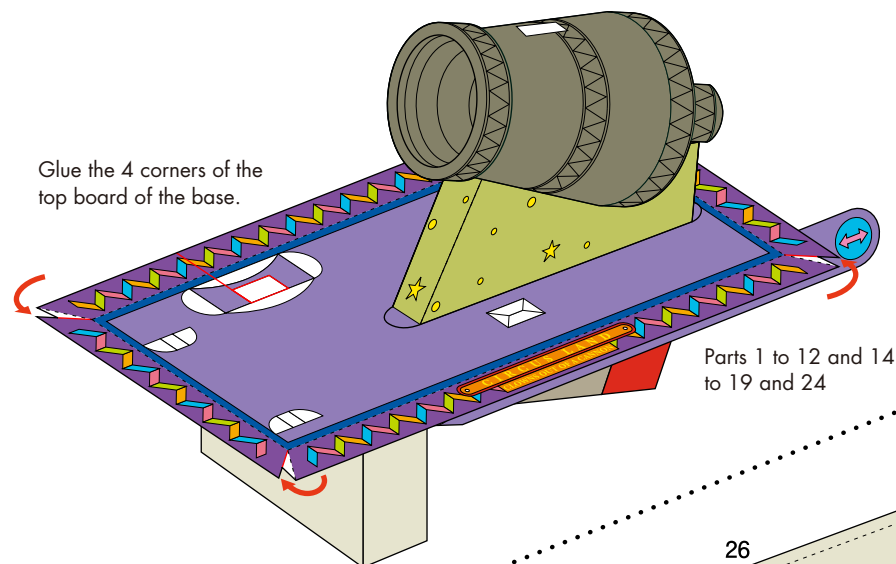

Parts 1 to 12 and 14 to 19 and 24

Work on a flat surface to prevent distortion of the base.

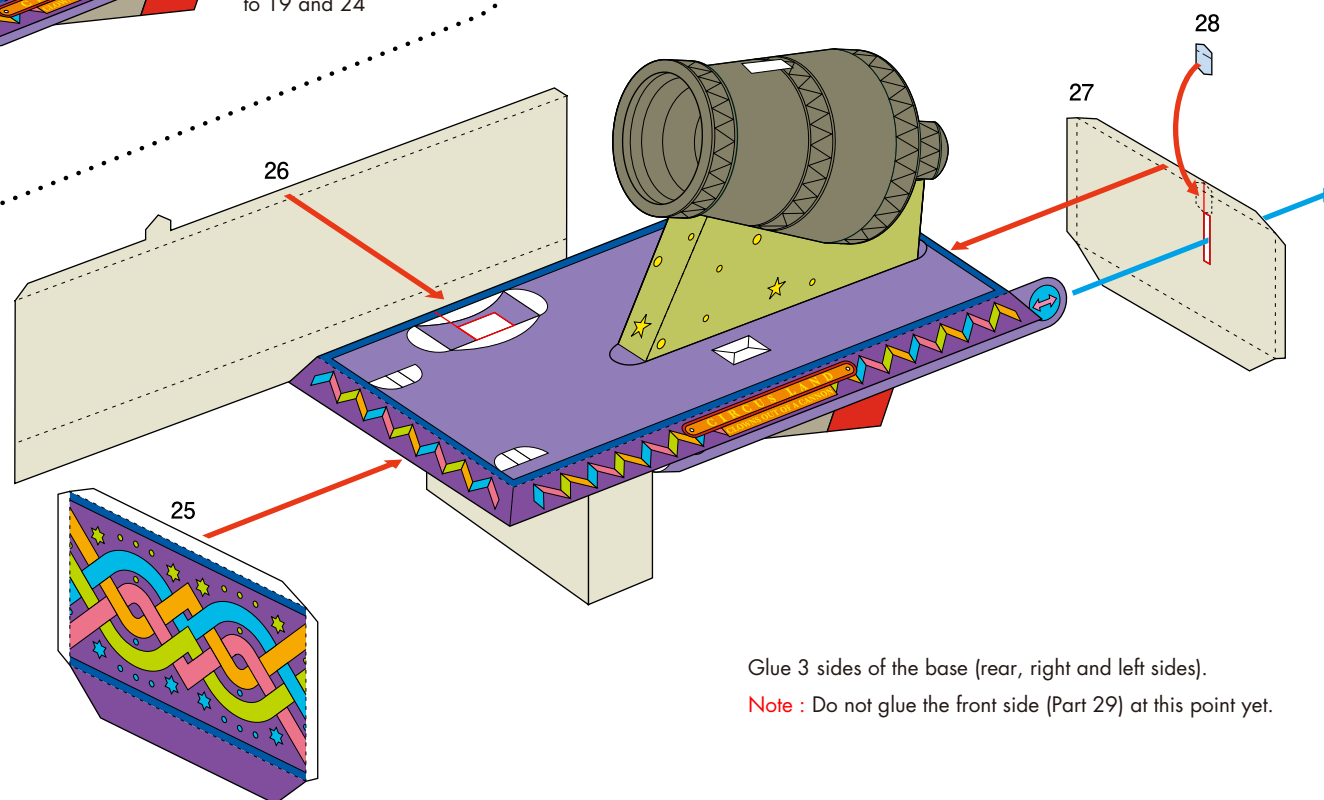

Glue 3 sides of the base (rear, right and left sides).

**Note :** Do not glue the front side (Part 29) at this point yet.





## (Moving) Clowns out of a cannon : Assembly Instructions

© Canon Inc. © Hideharu Naitoh & G&P

Canon

8

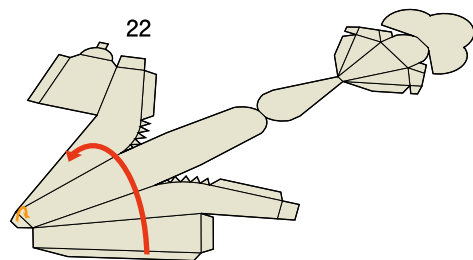

Firmly form the shape as you glue to prevent distortion.

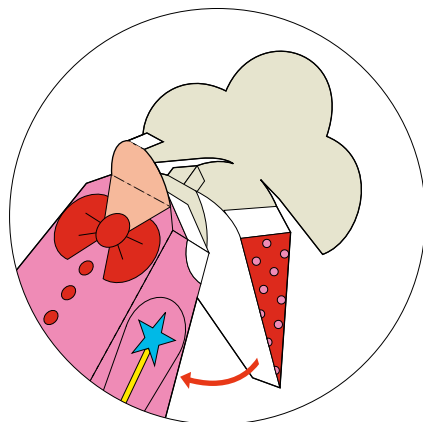
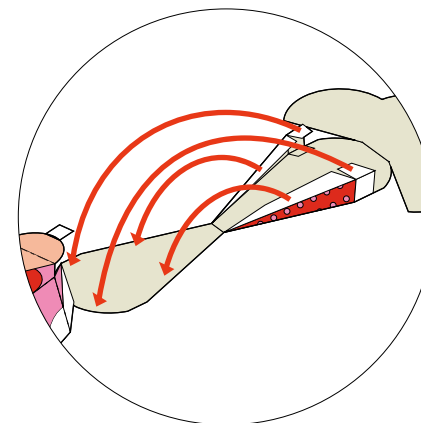
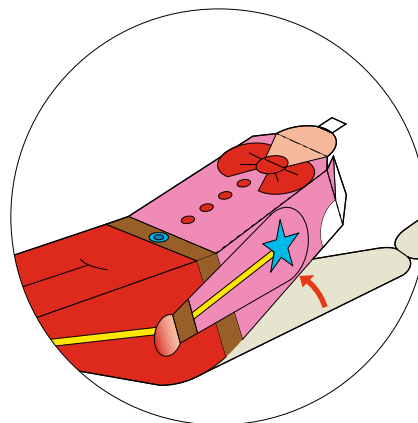
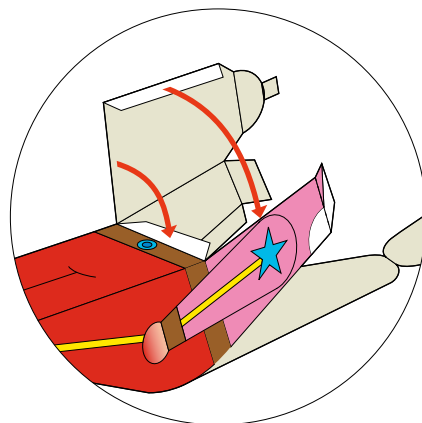

For the clown's head, glue in the order of the hair, hat, chin and nose.

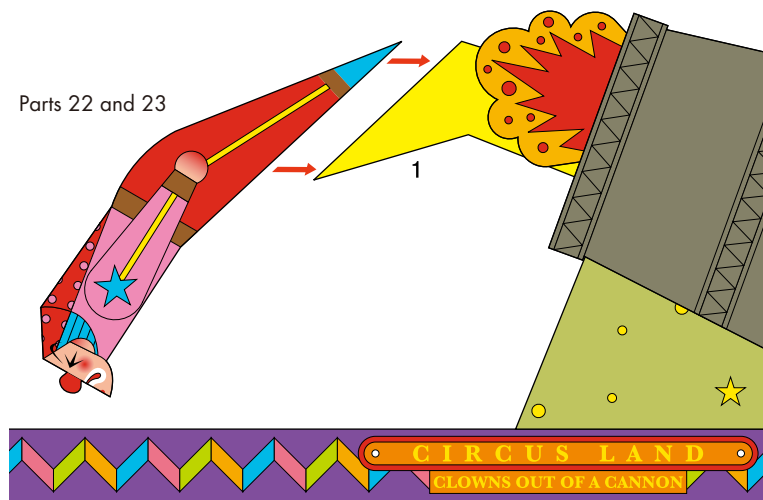
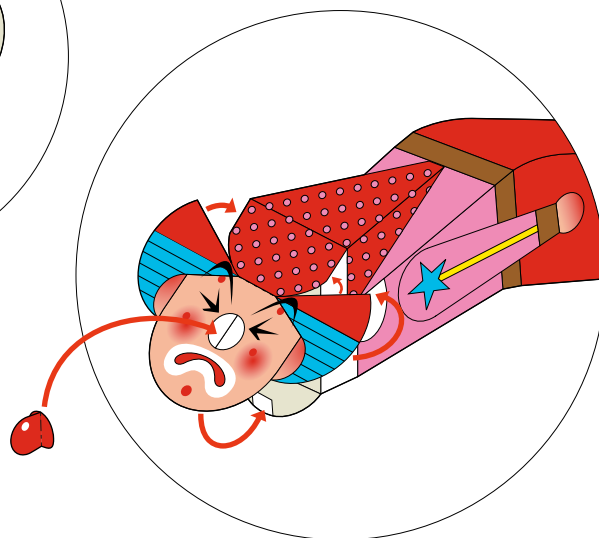

Pull the lever and glue the clown's legs (front) to Part 1.





# (Moving) Clowns out of a cannon : Assembly Instructions

© Canon Inc. © Hideharu Naitoh & G&P

Canon

9

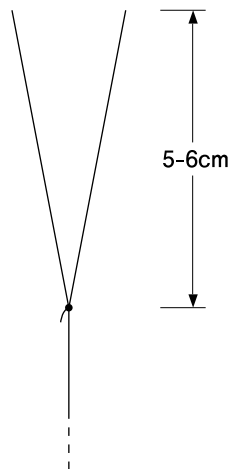

Prepare 2 strings.

Length: 30cm: 1 string  
10cm: 1 string

Tightly knot the 2 strings at around 5 to 6cm from the top.

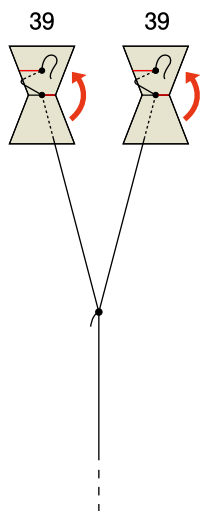

Wind the string on the slit of Part 39 and glue.

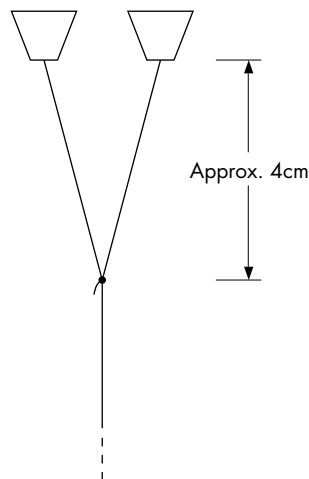

**Note :** Make sure the lengths from the 2 Parts 39 to the knot are the same.

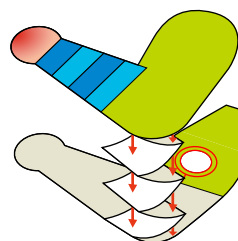
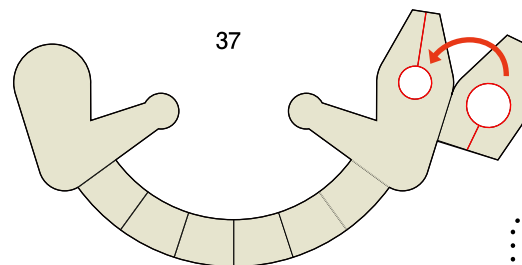

Glue only the bellows section.

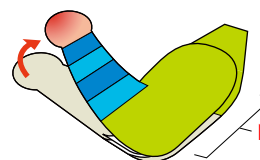

**Note :** Do not glue this part.

Bend the hand and arm slightly toward you and glue.

Prepare part 38 in the same way.

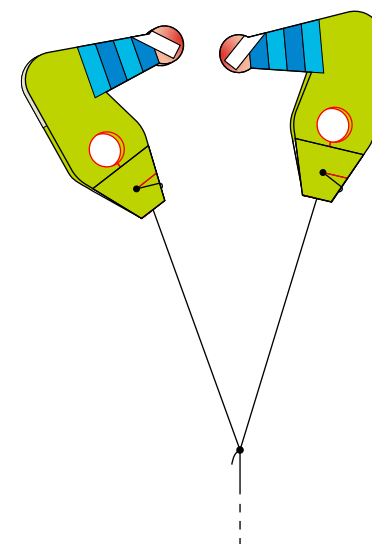
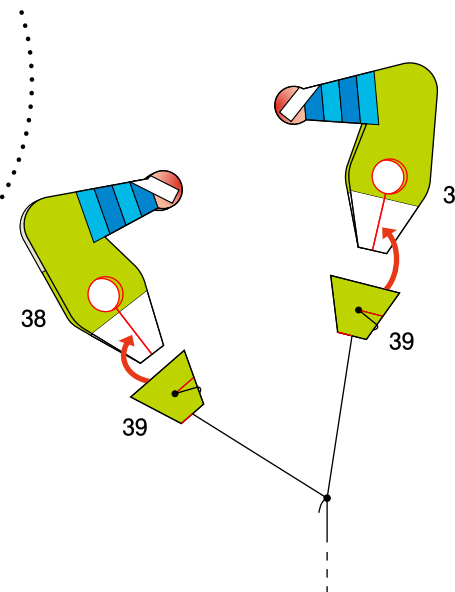



## (Moving) Clowns out of a cannon : Assembly Instructions

© Canon Inc. © Hideharu Naitoh & G&P

Canon

10

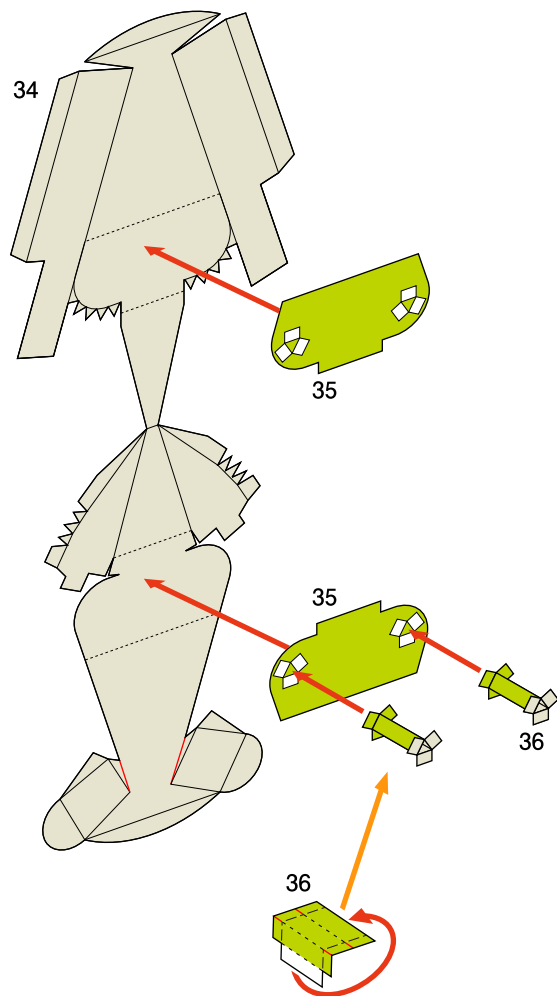

Parts 34 to 36

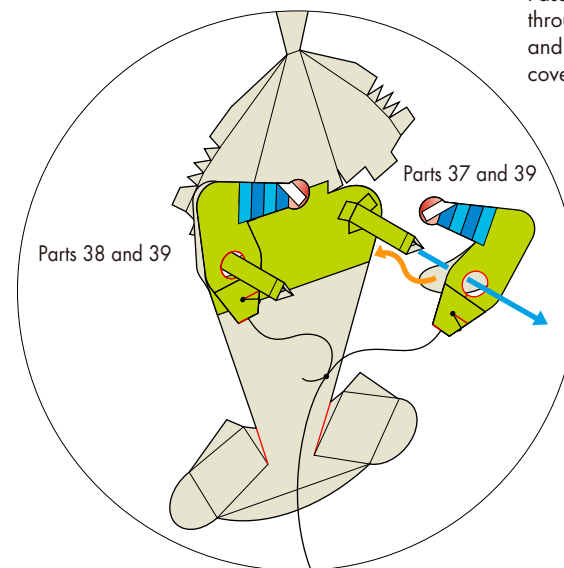
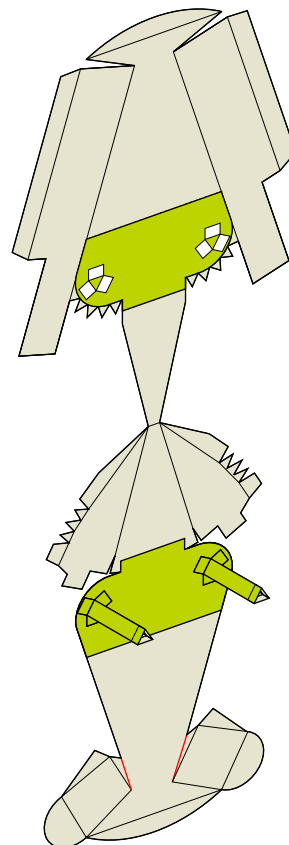

Pass the triangular prism through the hole in the arm and attach so that the arm covers the shoulder.

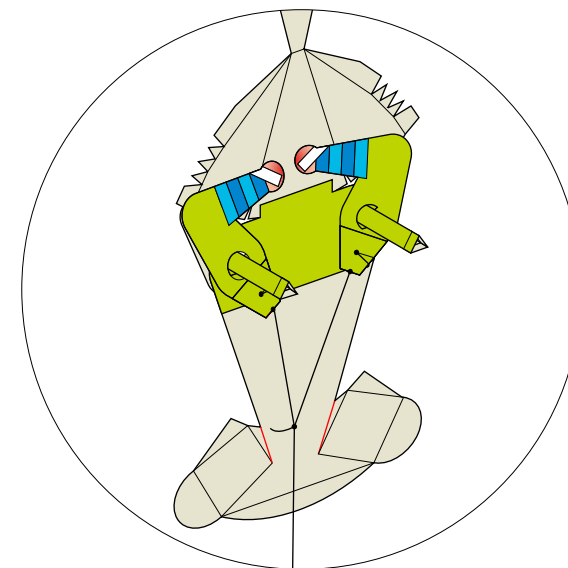



# (Moving) Clowns out of a cannon : Assembly Instructions

© Canon Inc. © Hideharu Naitoh & G&P

Canon

11



Glue both sides of the face.

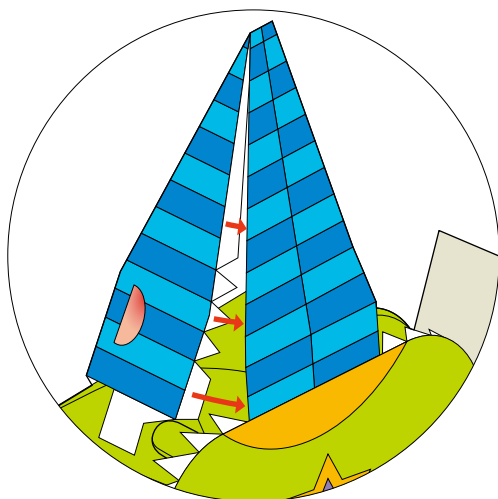

Glue both sides of the hat (on the rear side).  
Then, glue the triangular prism inside to the  
inner side of the back of the clown.

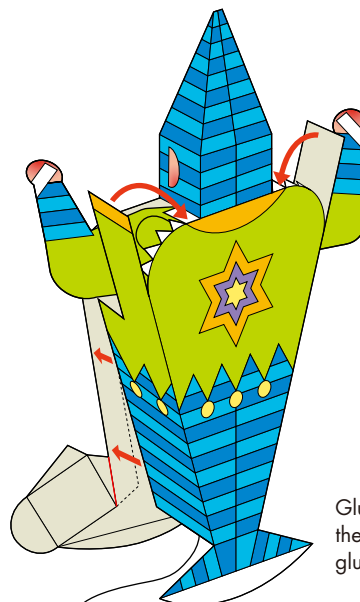

Glue both sides of  
the body and then  
glue the shoulders.

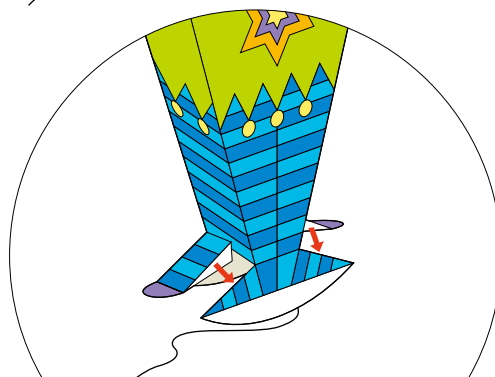

Glue the feet parts.

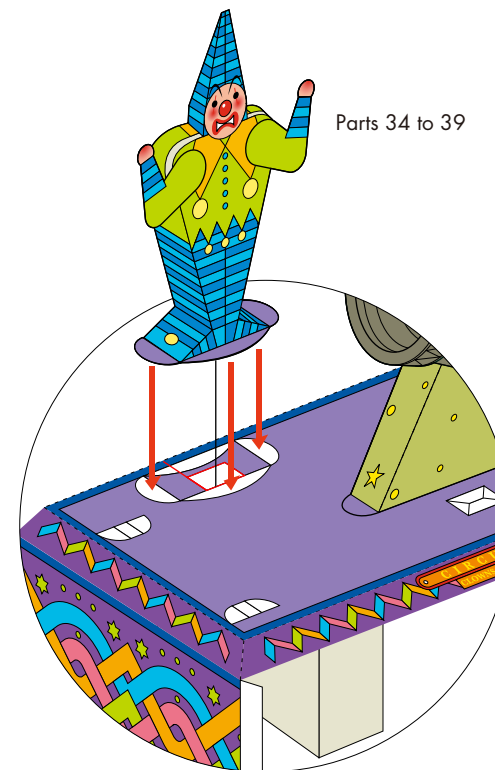

Pass the string coming out of the clown's  
feet through the square hole on the base.  
Then, glue the clown's feet on the base.



## (Moving) Clowns out of a cannon : Assembly Instructions

© Canon Inc. © Hideharu Naitoh & G&P

Canon

12

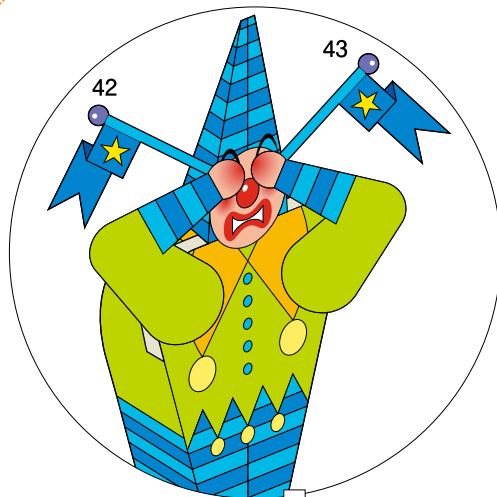

Bend the hands and arms slightly forward so that they are in front of the face.

Attach flags (Parts 42 and 43) to both hands of the clown and move the hands to cover the clown's eyes. (For flags assembling, see P.14)

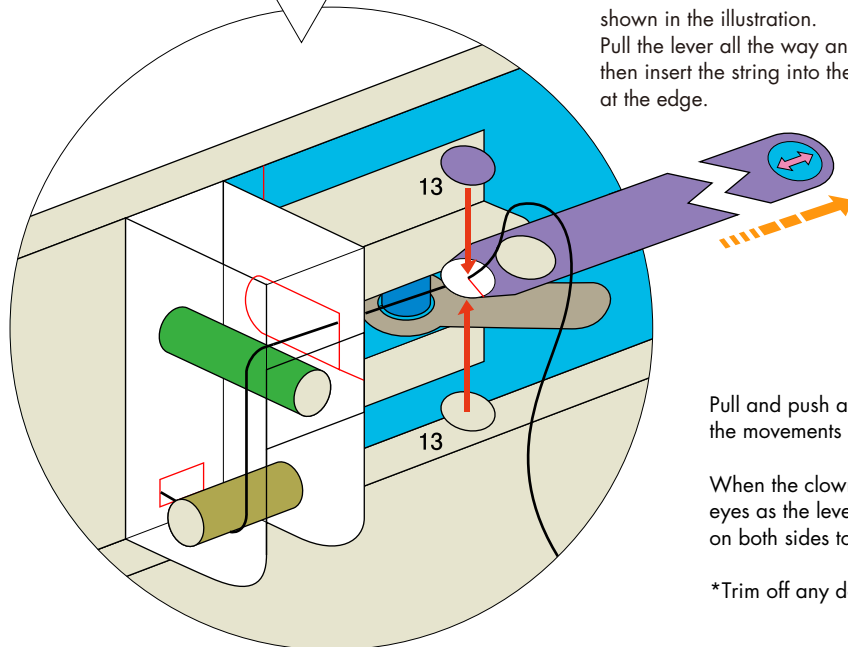

Lead the string passing through the base to the 2 columns as shown in the illustration. Pull the lever all the way and then insert the string into the slit at the edge.

Pull and push a few times to check the movements of the arms and lever.

When the clown's hands cover the eyes as the lever is pulled, glue Part 13 on both sides to lock the strings.

\*Trim off any dangling ends of the string.

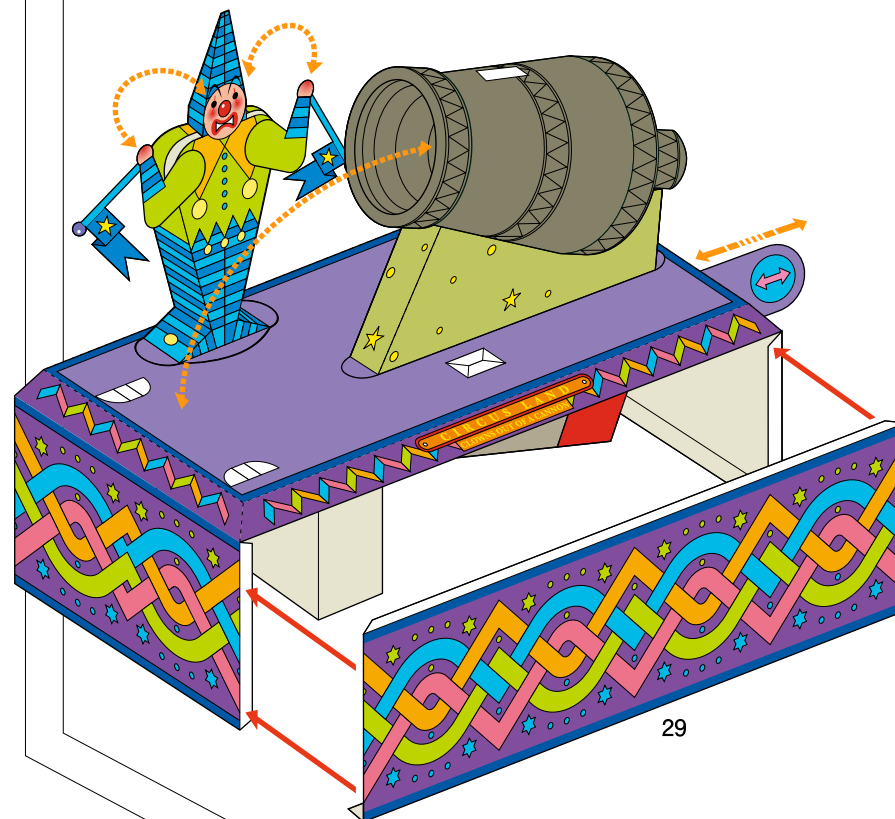

Glue the front (Part 29) to the base. Pull and push the lever to check the overall movement.



# (Moving) Clowns out of a cannon : Assembly Instructions

© Canon Inc. © Hideharu Naitoh & G&P

Canon

13

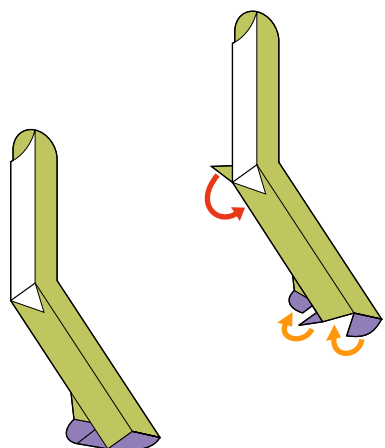
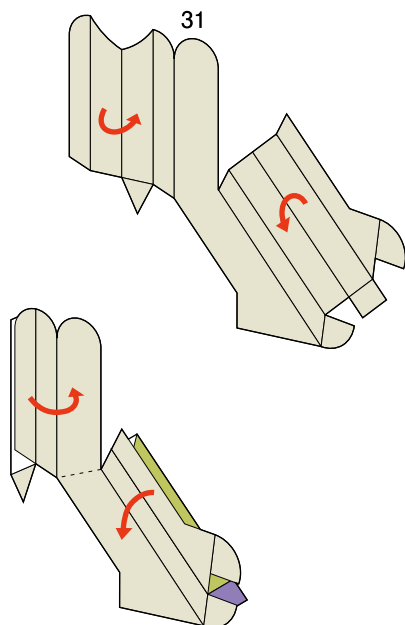

Prepare part 30  
in the same way.

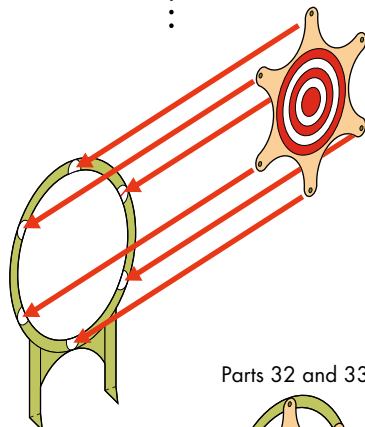
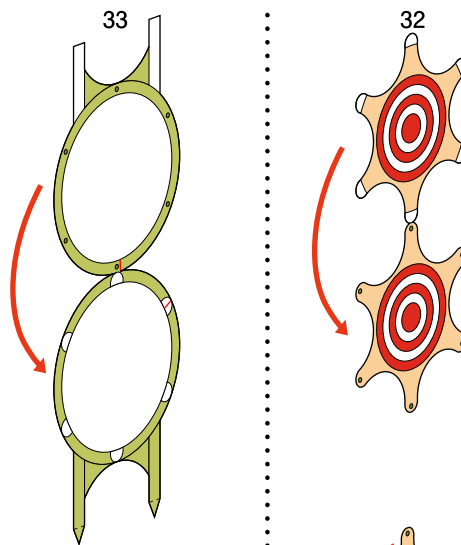

Parts 32 and 33

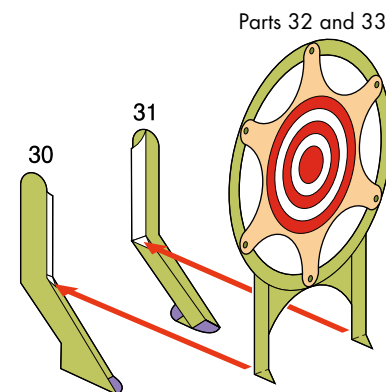

Parts 32 and 33

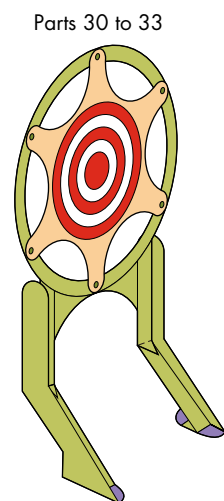

Parts 30 to 33



# (Moving) Clowns out of a cannon : Assembly Instructions

© Canon Inc. © Hideharu Naitoh & G&P

Canon

14

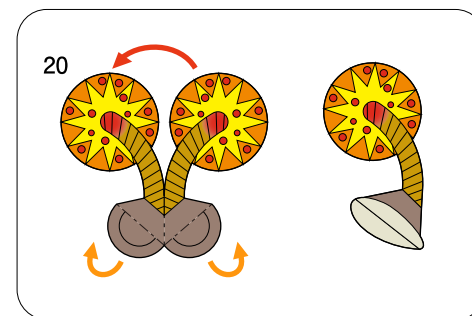
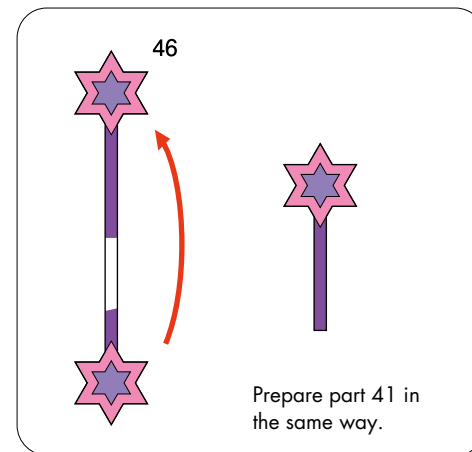
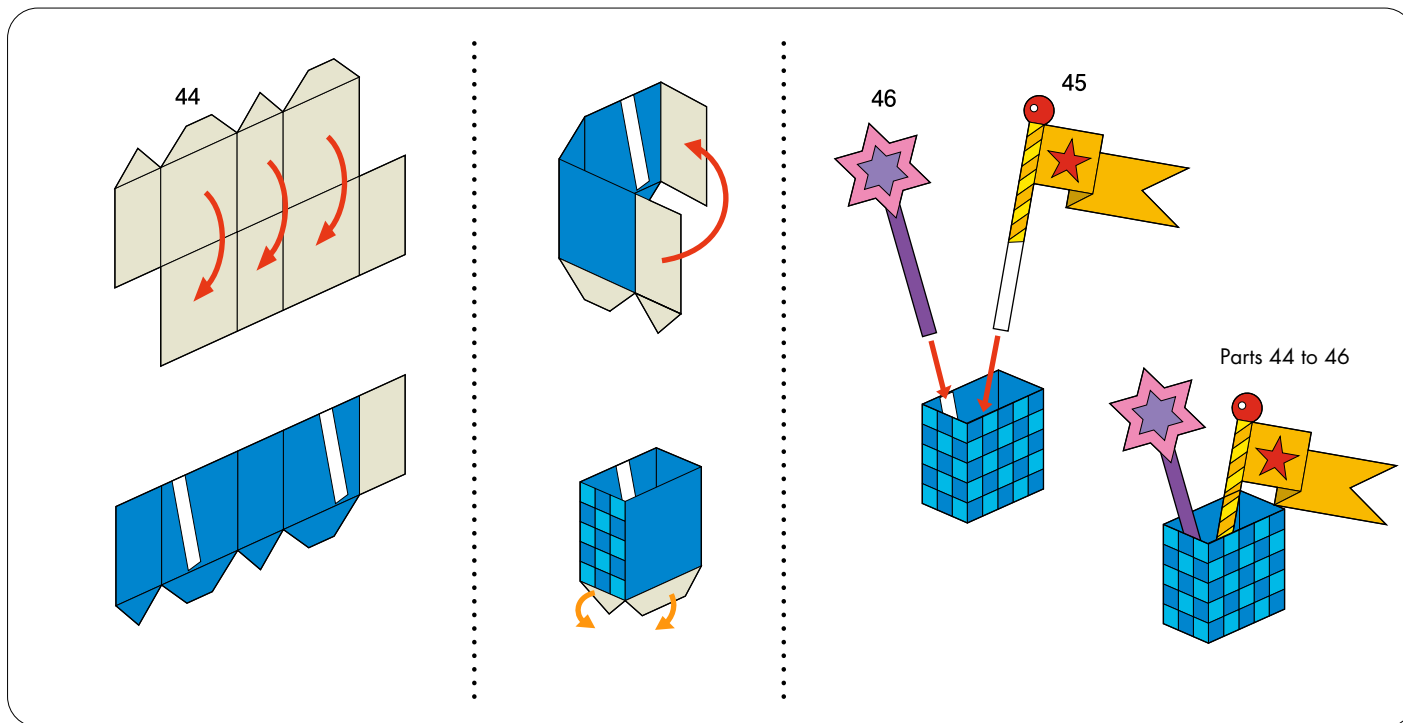
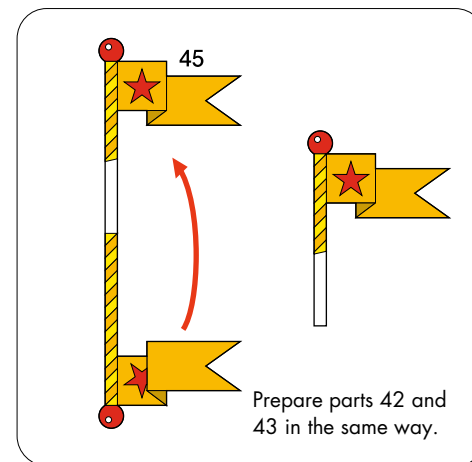
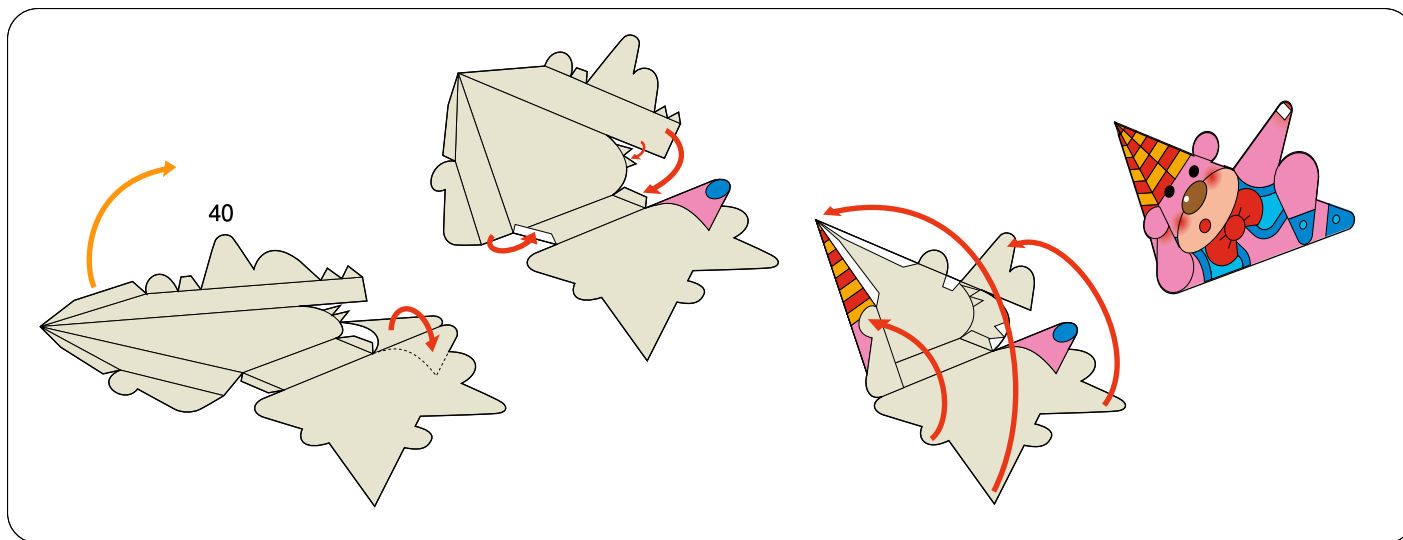





## (Moving) Clowns out of a cannon : Assembly Instructions

© Canon Inc. © Hideharu Naitoh & G&P

Canon

15

Parts 30 to 33

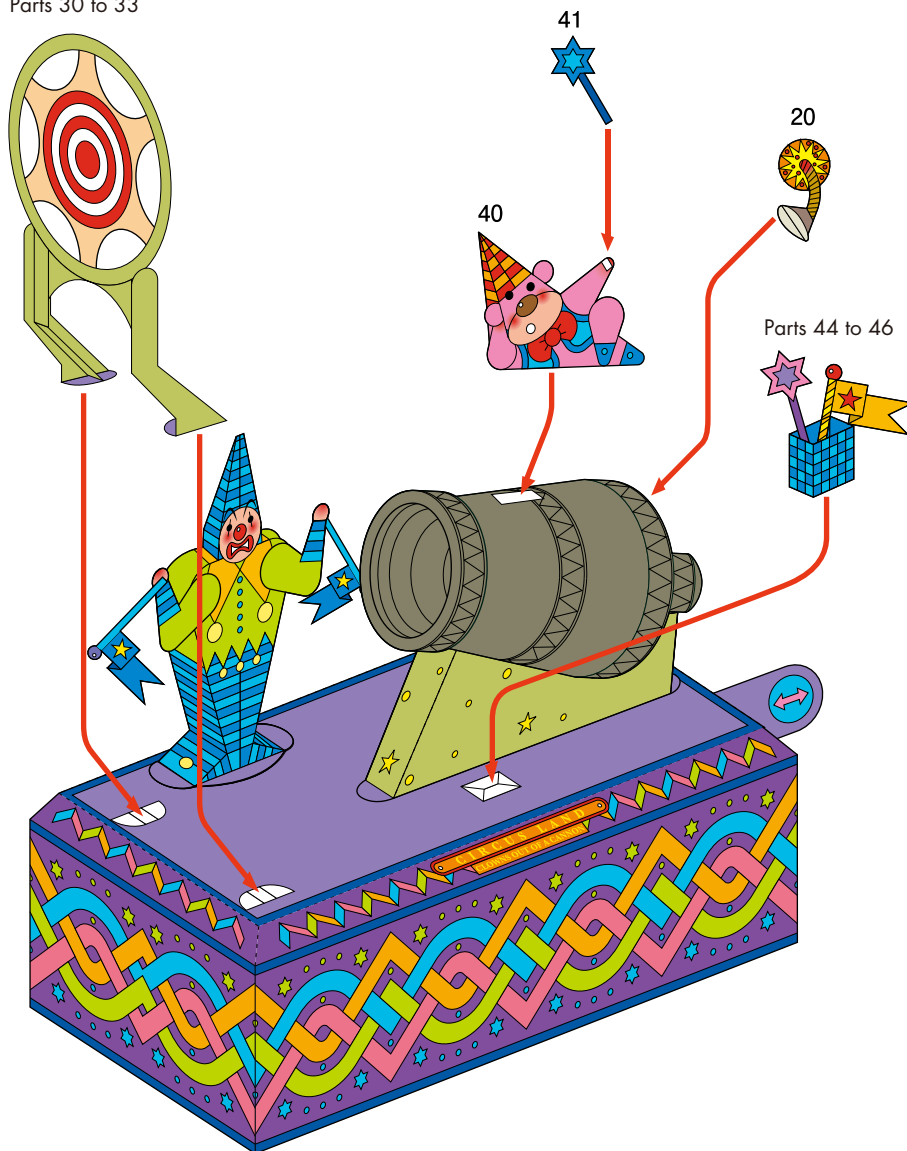

Finished!

