



CREATIVE PARK

<http://www.canon.com/c-park/>



View of completed model

* This model was designed for Papercraft and may differ from the original in some respects.

■ Assembly Instructions : Six A4 sheets (No. 1 to No. 6)

* Build the model by carefully reading the Assembly Instructions , in the parts sheet page order.

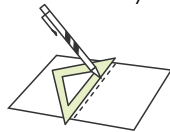

*Hint: Trace along the folds with a ruler and an exhausted pen (no ink) to get a sharper, easier fold.

Assembly Instructions



Mountain fold(dotted line)
Make a mountain fold.



Valley fold(dashed and dotted line)
Make a valley fold.



Scissors line(solid line)
Cut along the line.



Cut in line(solid line)
Cut along the line.

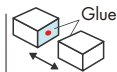

Glue
The glue spot(colored dot) shows where to apply the glue.

● Glue spot(Red dot)
Glue parts with the same number together.

● Glue spot(Green dot)
Glue within the same part.

● Glue spot(Blue dot)
Glue to the rear of the other part.

Tools and materials



Scissors, set square, glue(We recommend stick glue), pencil, used ballpoint pen, toothpicks, tweezers, (useful for handling small parts)

Assembly tip



Before gluing, crease the paper along mountain fold and valley fold lines and make sure rounded sections are nice and stiff.

Caution



Glue, scissors and other tools may be dangerous to young children so be sure to keep them out of the reach of young children.

Before starting assembly:

- Writing the number of each section on its back side before cutting out the sections is highly recommended. (* This way, you can be sure which section is which even after cutting out the sections.)
- The parts used will vary somewhat, depending on whether the completed vessel will be modeled to depict a ship facing wind from the left (with the bow pointed to the right) or from the right (with the bow pointed to the left). First decide where you want to display the completed vessel, then decide whether the bow should point to the left or right.

Bow pointed to the right (A - standard parts)

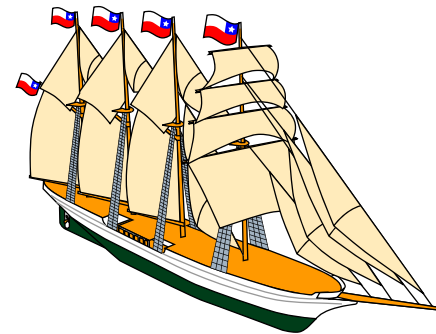

Bow pointed to the left (B - optional parts)

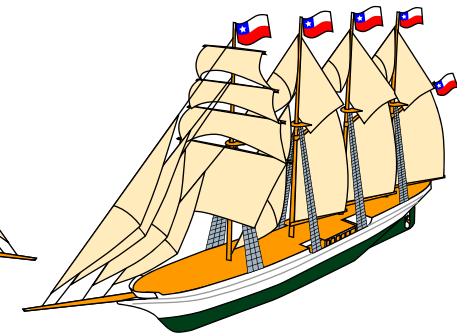

→ Indicates where sections should be glued together.

■ Indicates sections that should be glued first, then cut out.

→ Indicates where to insert sections. Do not glue the sections together.

■ Indicates sections that should be folded once, then unfolded.

1

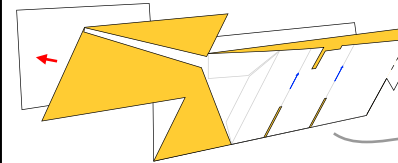

After folding the part once and gluing the two folds together, cut out from the yellow area.

Glue parts 2 and 3 together in the same way.

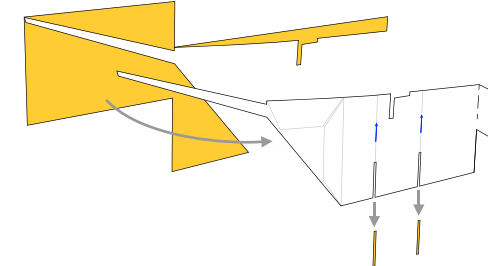

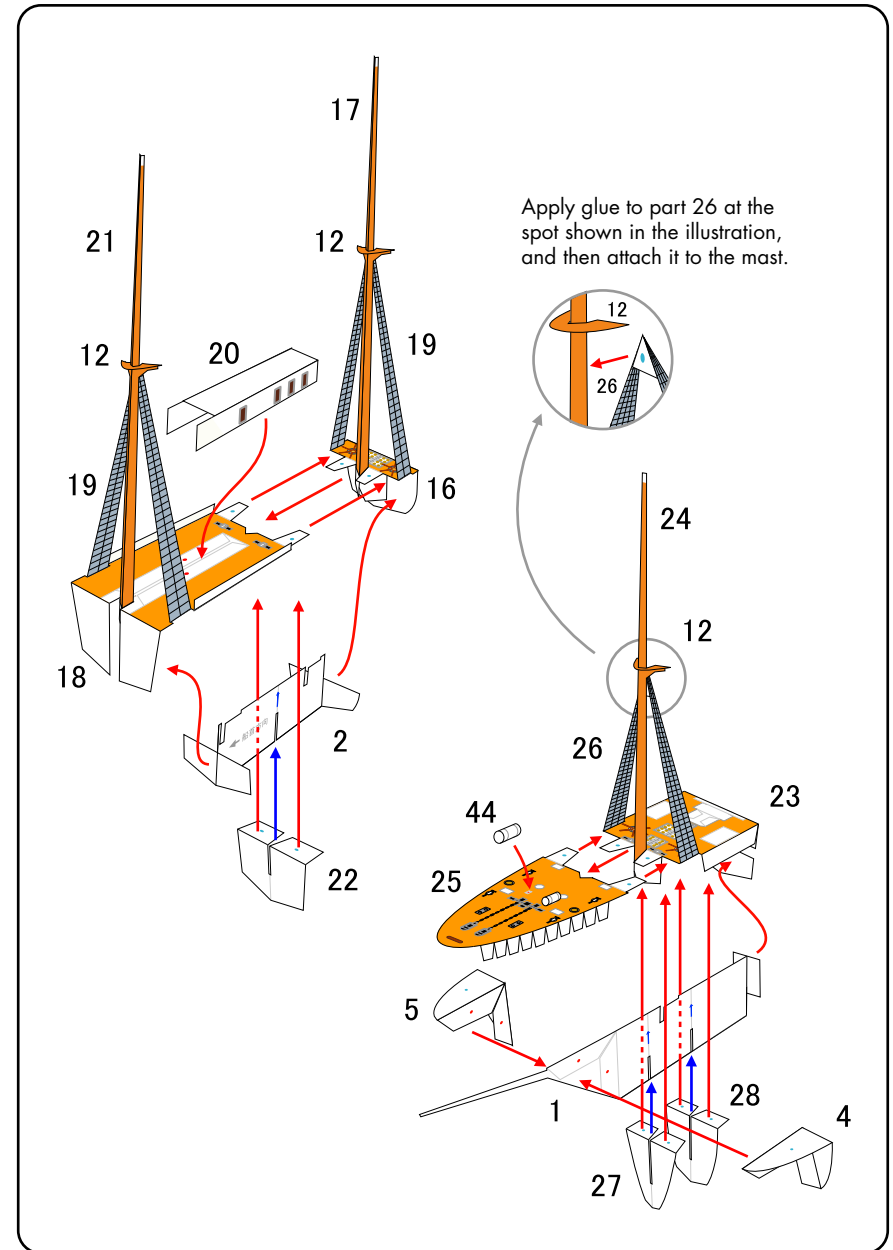
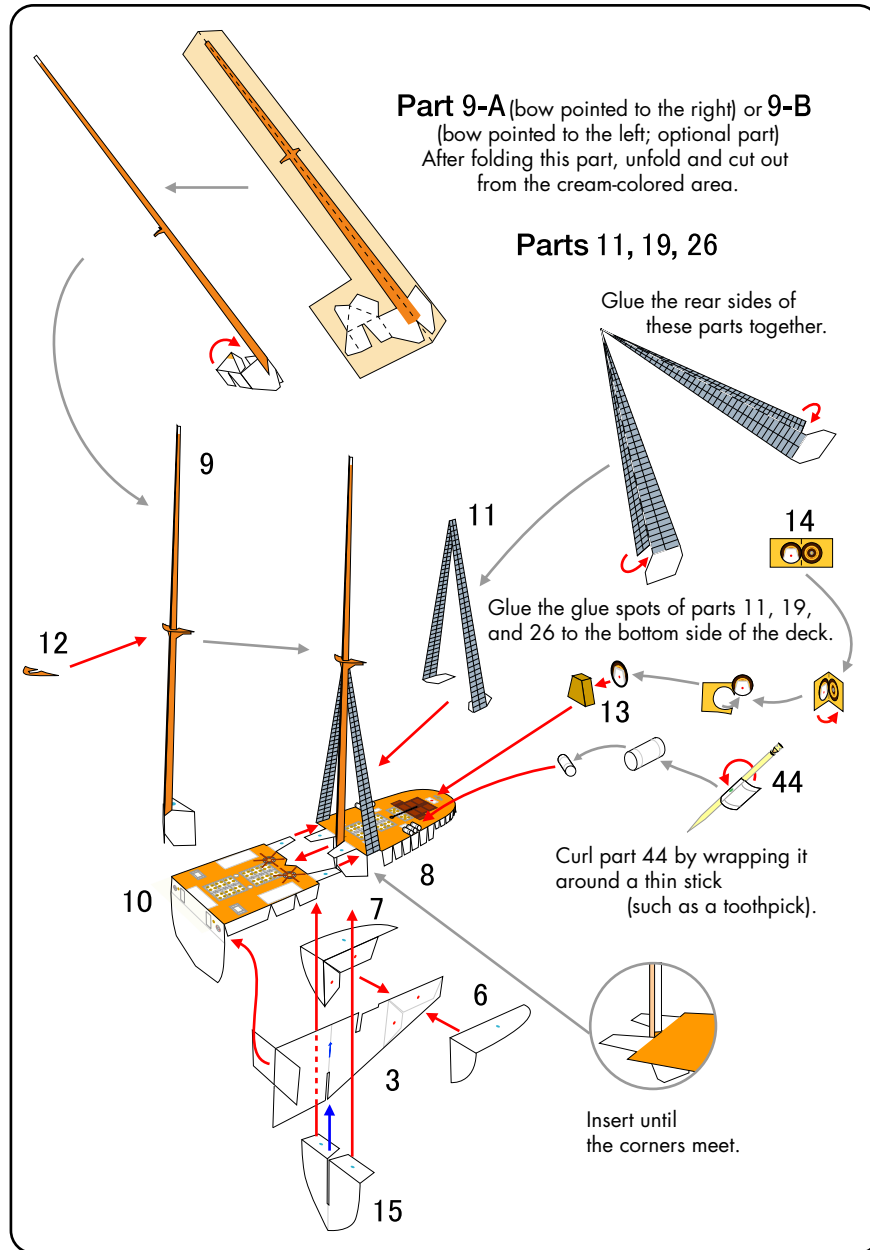

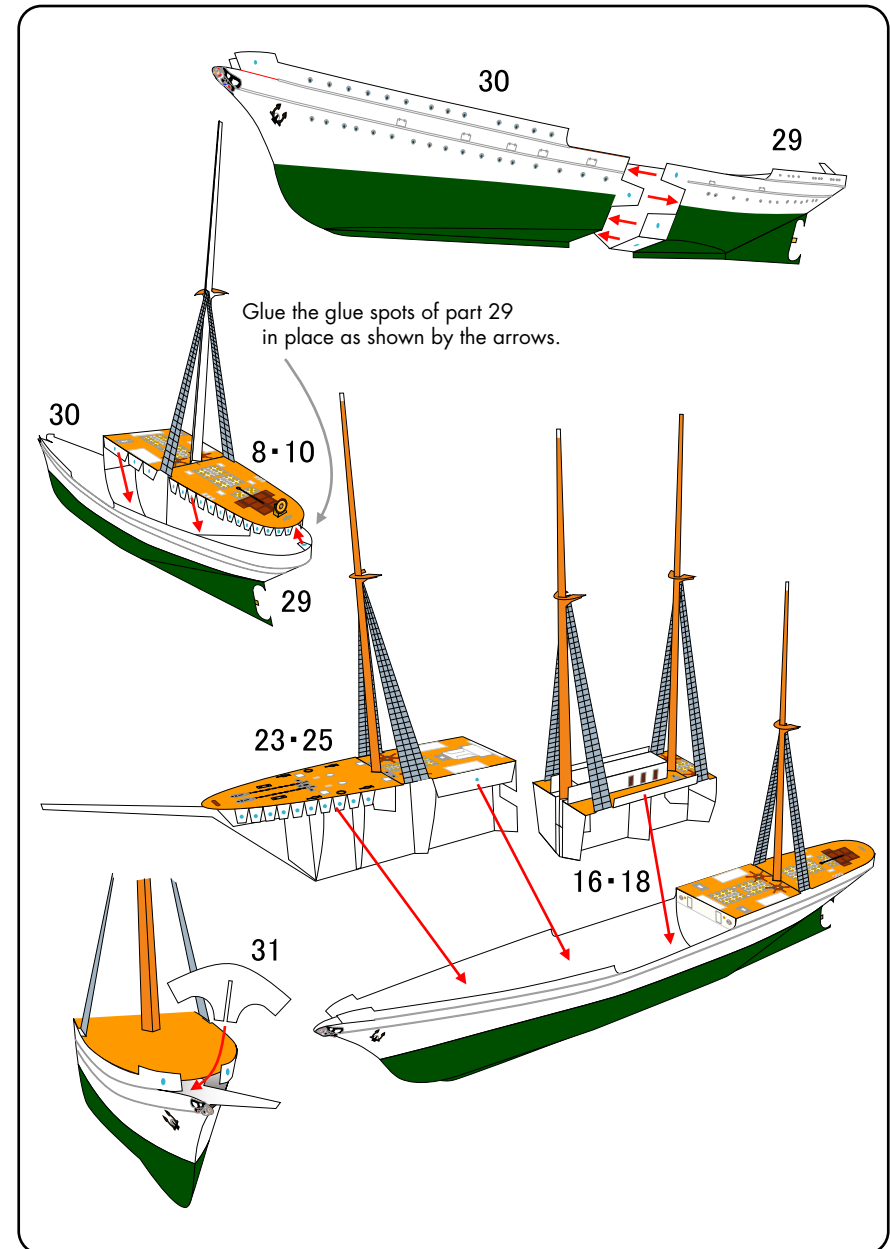
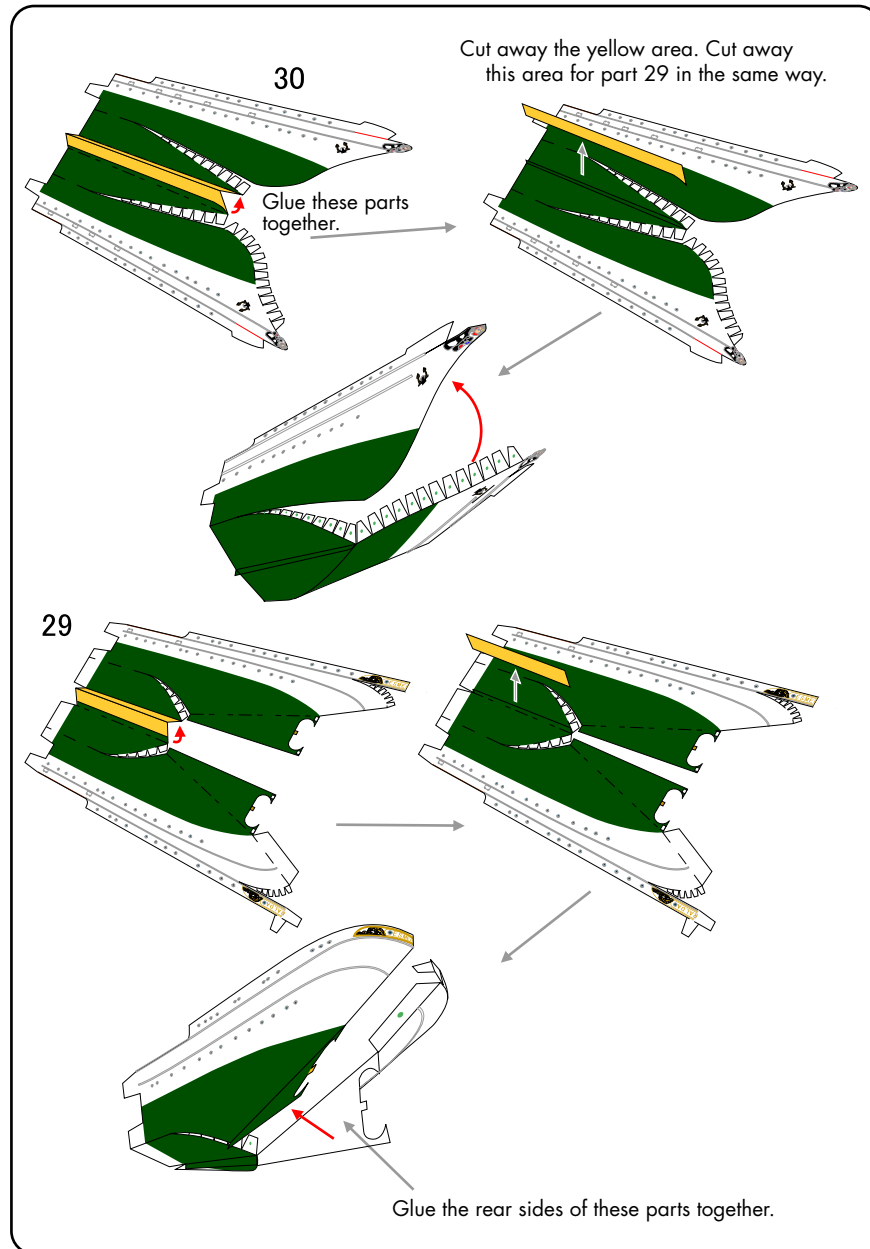



Glue part 36 in place after first attaching part 35 to the hull.

This diagram shows the assembly of the ship's hull and deck. It includes a large central illustration of the hull with various parts being attached. To the left, a sequence of four smaller diagrams shows the step-by-step construction of a superstructure component, labeled 39, 38, and 42. Above the main hull, parts 36, 37, 40, and 41 are shown with red arrows indicating their placement on the deck. Part 35 is shown as a large orange deck plate being attached to the hull. Part 34 is a small rectangular piece. Part 43 is a long orange beam. At the bottom right, two diagrams show the attachment of the hull's bottom edge, labeled 32 and 33, with red arrows indicating the direction of assembly.

This diagram illustrates the assembly of the ship's superstructure and deck details. At the top, part 50 is shown as a yellow and white structure with red arrows indicating its folding or assembly. Below it, part 49 is shown as a white hull section with a green base. To the right, part 44 is a white structure with a red arrow indicating its placement. In the middle, part 51 is shown as a white structure with a red arrow indicating its placement. Below that, part 52 is shown as a white structure with a red arrow indicating its placement. At the bottom, two diagrams show the final assembly of the ship's superstructure, with parts 50, 51, and 52 being attached to the hull. Red arrows indicate the direction of assembly.

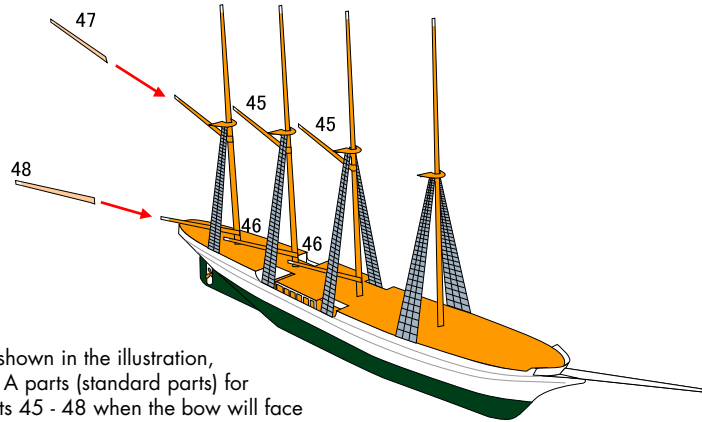

As shown in the illustration, use A parts (standard parts) for parts 45 - 48 when the bow will face to the right and B parts (optional parts) when the bow will face to the left.

Parts 57 - 65

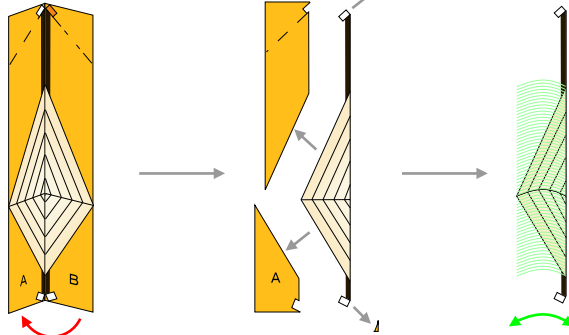

68-69

Fold once and glue the folds together, then give the sails a bulging appearance. If you plan to have the bow face to the right, curl the sails so that surface A will bulge out. If the bow will face to the left, curl the sails so that surface B will bulge out.

66-67

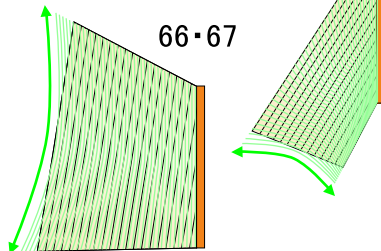

For parts 66 - 69, choose A parts (standard parts) or B parts (optional parts) depending on the direction in which the bow will point.

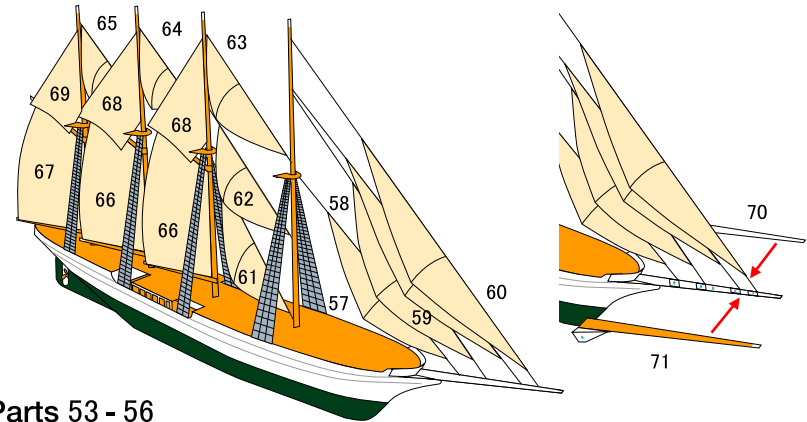

Parts 53 - 56

Attach parts 53 - 56 (the yards) to the vessel masts. If the bow will point to the right, attach the yards so that surface A is on top. If the bow will face to the left, attach so that surface B is on top. Glue the yards in place at an angle, as shown in the illustration, so that the model will resemble a ship sailing in the wind.

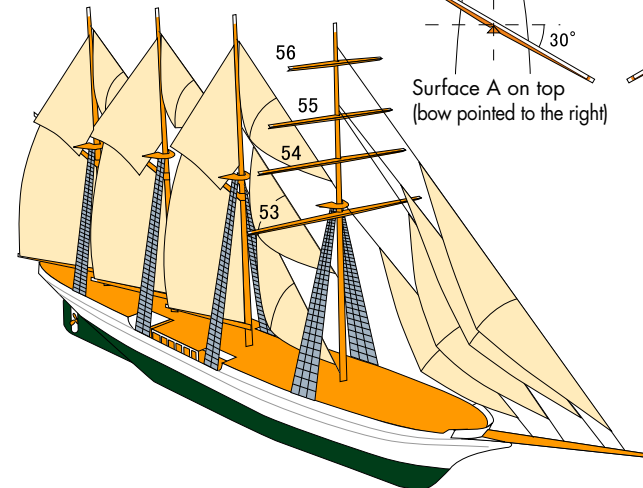
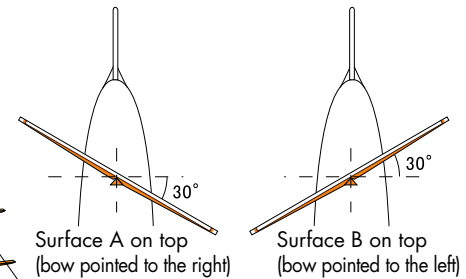
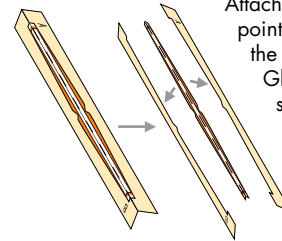



Fold parts 72 - 75 (the square sails) in half and glue both folds together. After curling these from top to bottom as shown in the illustration, make them curl from the center to the outside, to make it appear as if they are catching the wind.

Parts 72 - 75

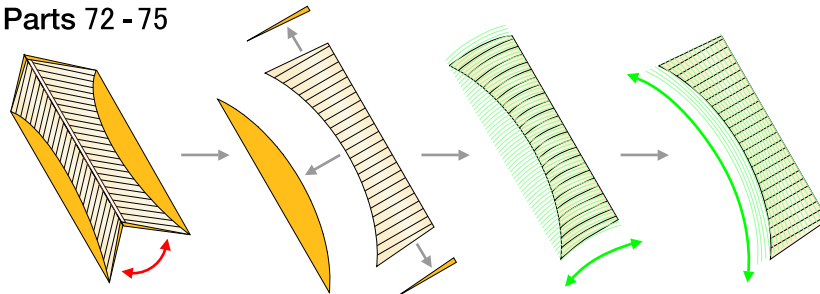

Glue the rear sides of these parts together.

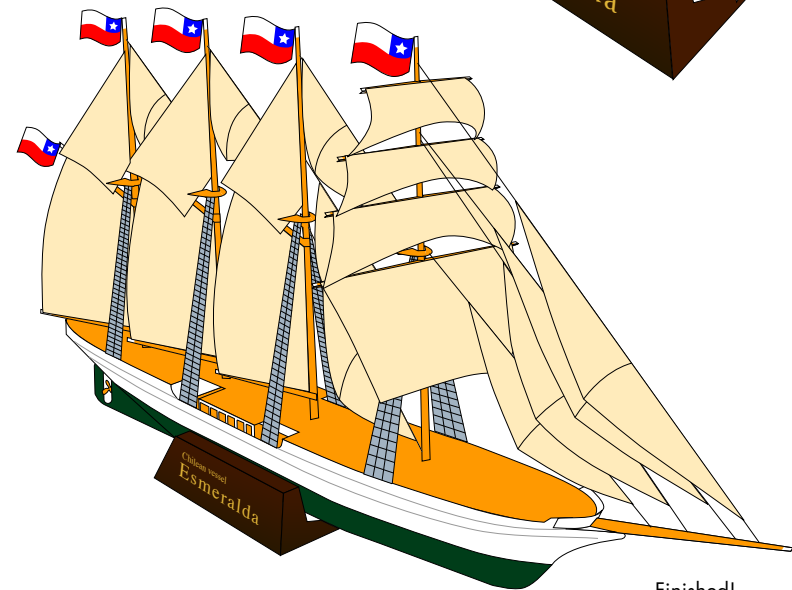
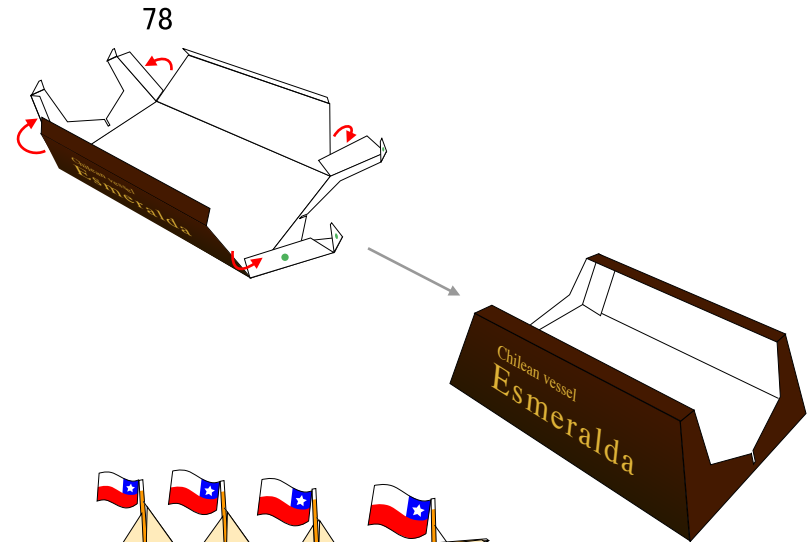
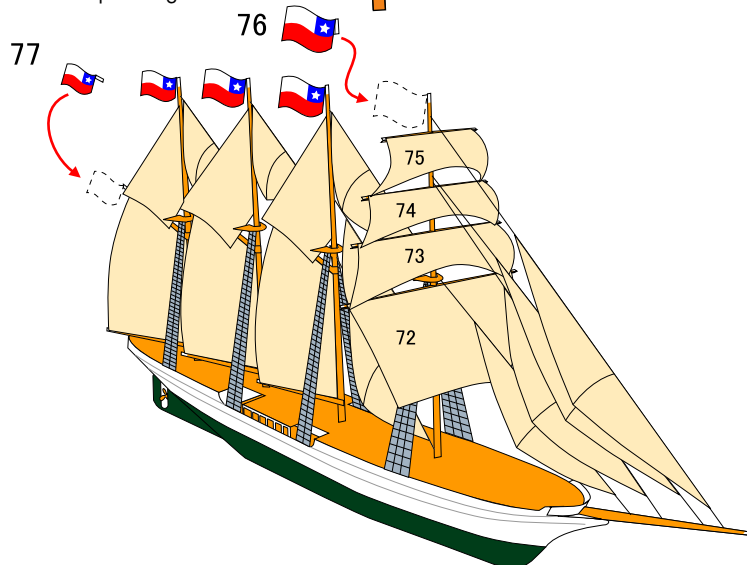

Finished!