



Assembly Instructions

1. Carefully cut out the parts.
2. Fold along the dotted lines, making mountain or valley folds as indicated.
3. Attach the glue spots on each part together.
4. Glue the parts together, and you're done.

\*Please read the Assembly Instructions carefully before you begin.

Tools

Scissors, Glue (We recommend quick-drying paper glue), String (about 70cm)

How to assemble your model neatly

Scoring along the fold lines in advance with a dried up pen or a ruler with slightly sharp corners will result in a neater model.

\*Be careful not to press too hard as the paper may tear.

Notation Key

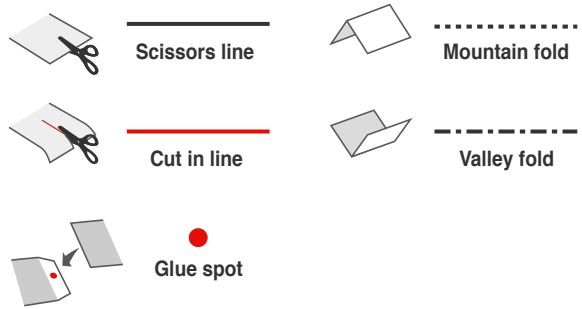

Caution

Keep scissors and glue away from small children. Be careful not to cut your fingers when using scissors.

Cautions for playing

- Never aim it at another person.
- Do not swing it around, or run with it in your hand.
- Play with it in a park or other open area.
- Be careful of the sharp corners when playing.

Assembling the paper copter

1 Cut out the parts

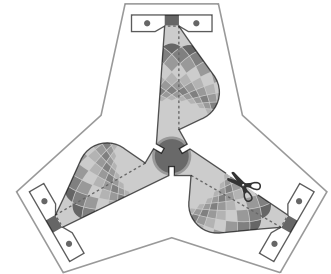
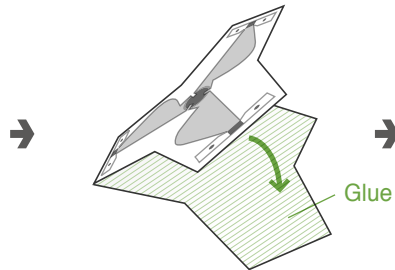
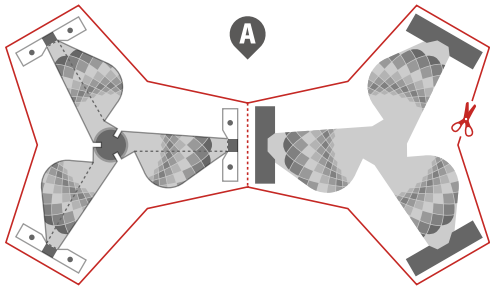

Once the glue is completely dry, cut out the part by following the scissors line on the front. For other parts, simply cut them out along the scissors lines.

2 Assembling the propeller

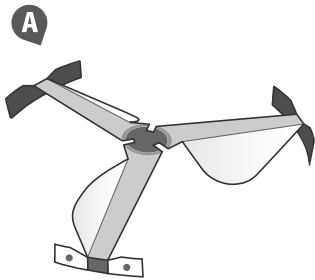

Fold the parts you have cut out.

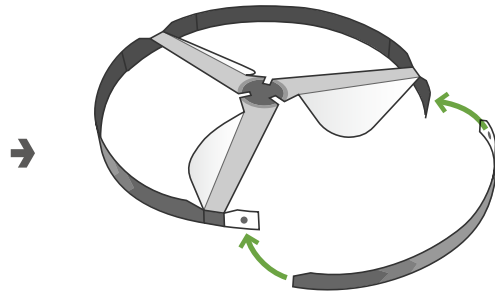

Attach the propeller parts you have curved into a ring shape.

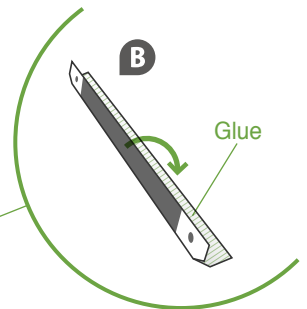

Fold along the fold line and glue together at the back.

3 Assembling the shaft

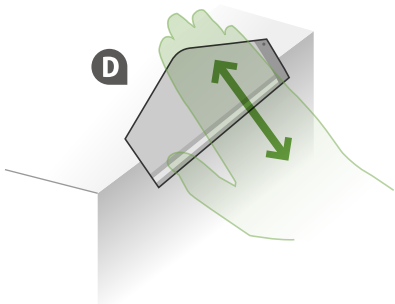

Put the part face up on the edge of a table and roll it while applying pressure, to give the part a curve.



Fold the edge to make a triangular prism, and then roll it up into a stick (about 5mm in diameter).

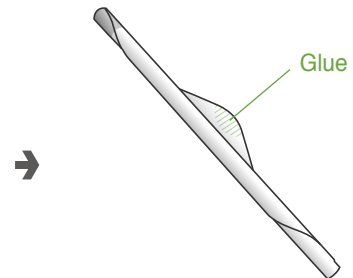

Finally, glue down the end so that it doesn't get unraveled.

**4** Attaching the shaft parts and string

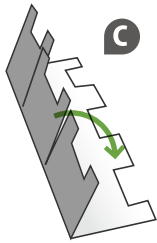

Cut out the shaft parts and glue the halves together at the back.

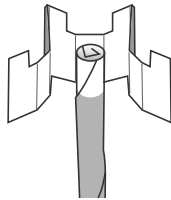

Attach the shaft parts to the tip of the shaft.



View from above

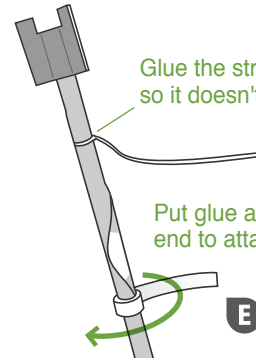

Attach the string (about 70cm) and stopper to the shaft.

Glue the string firmly so it doesn't come off.

Put glue at the start and end to attach the piece.



**5** Assemble the shaft holder, and insert the shaft

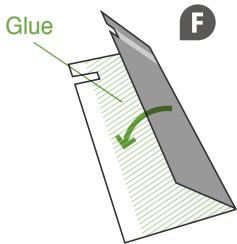

Cut out the shaft holder parts and glue the halves together at the back.

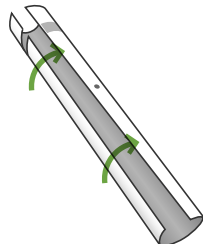

Attach the shaft holder into a cylinder shape.

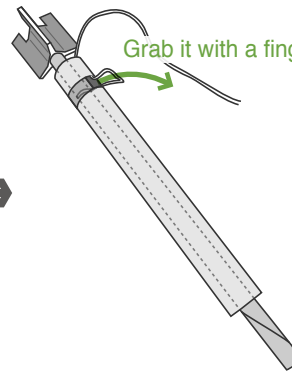

Insert the shaft into the shaft holder, and pull the string out through the hole.

Grab it with a finger, and pull it out.

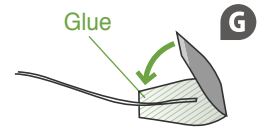

Finally, attach the tag to the end of the string.

Glue



How to fly your paper copter

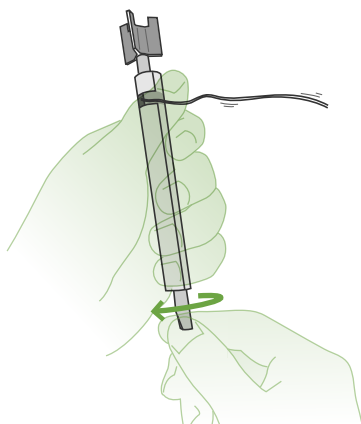

Gently hold down the string with your thumb so that it doesn't get tangled up inside, and rotate the shaft clockwise to wrap the string around it.

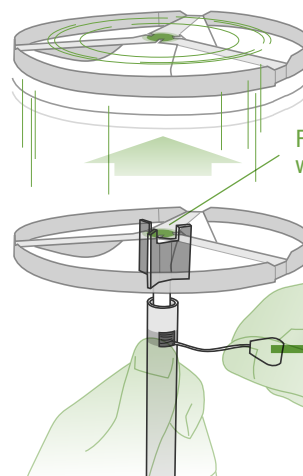

Face the side with the circle up.

Rather than holding just the tag, hold the string as well and pull.

Set the propeller on the shaft, and swiftly pull the string. If it doesn't fly well, try adjusting the speed you pull the string with or the amount of strength you use.

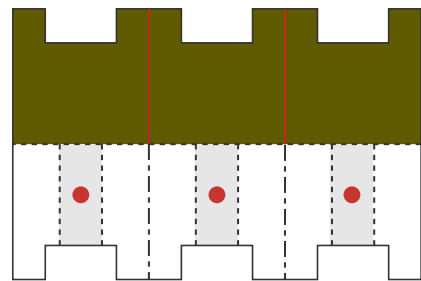
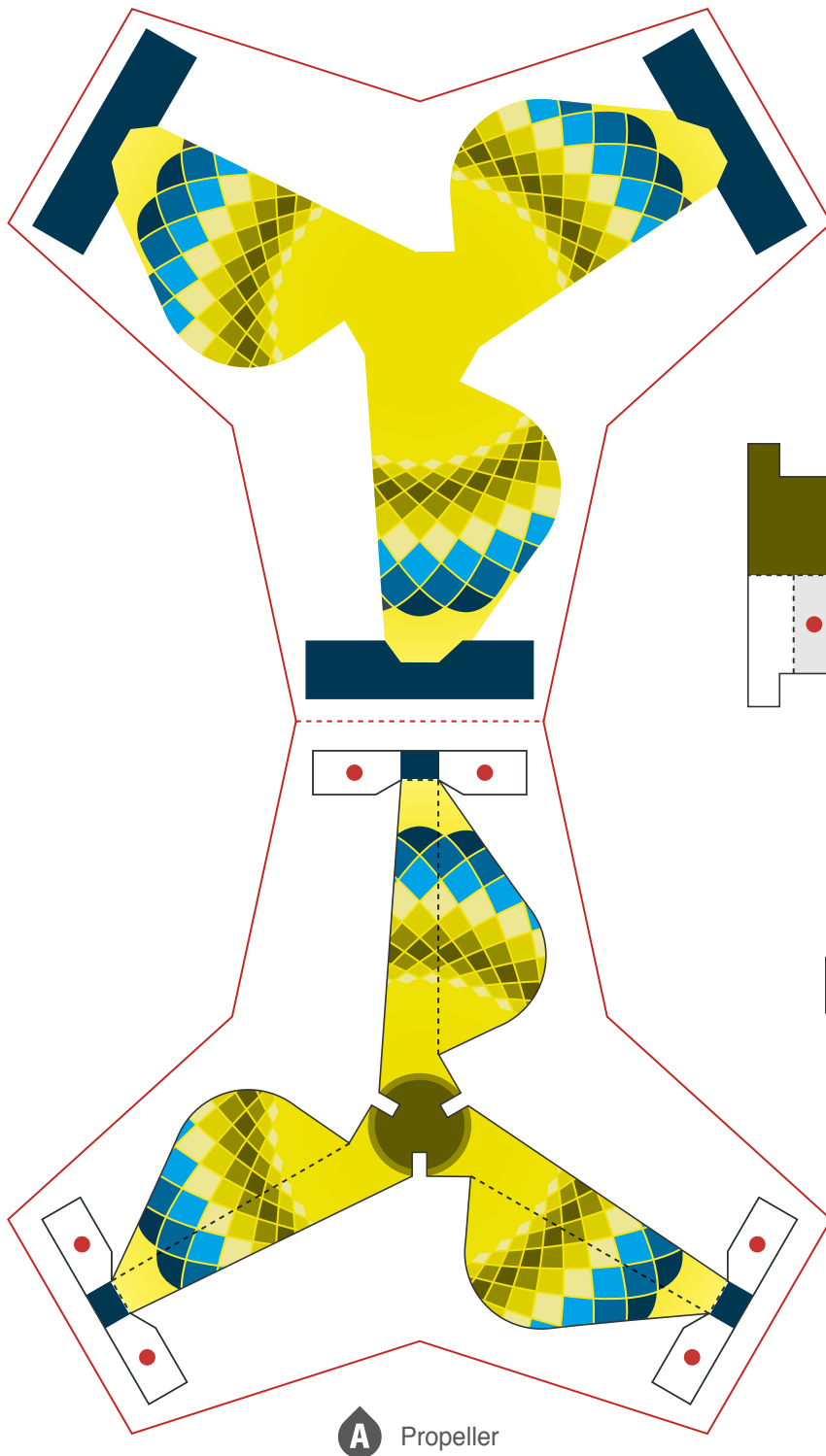

**C**  
Shaft parts

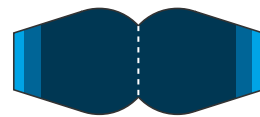

**G**  
Tag



**B** Propeller parts

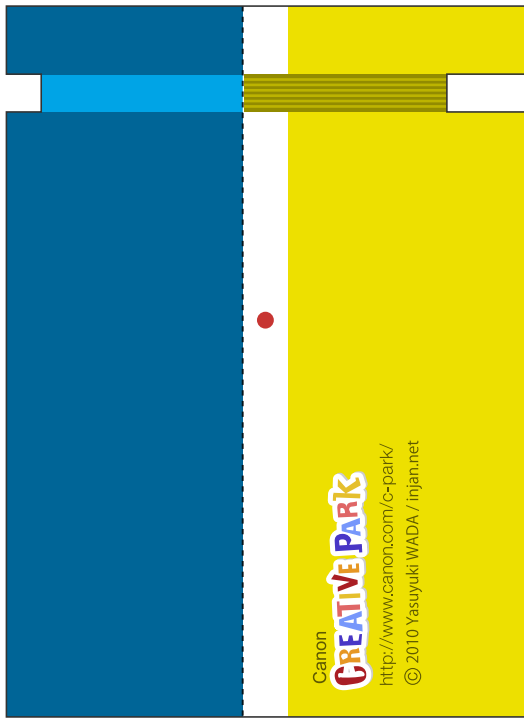

**F** Shaft holder

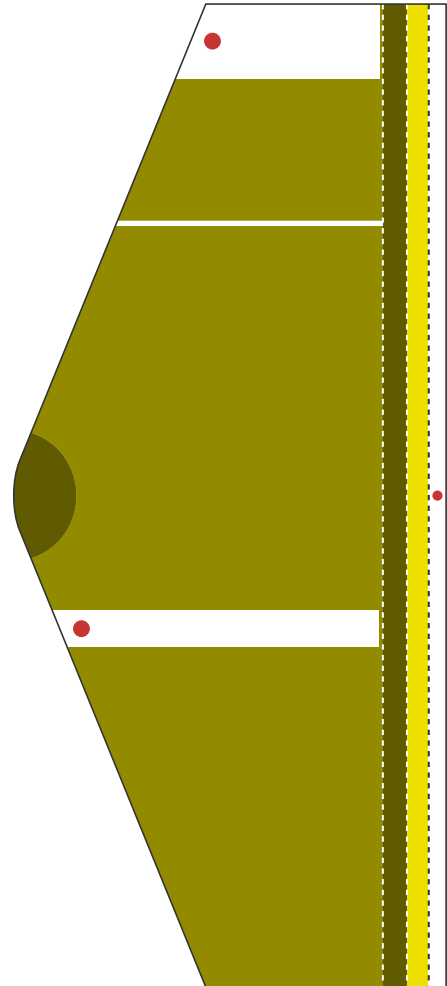

**D** Shaft



**E** Stopper