



# (Moving) Tiger through a ring of fire : Assembly Instructions

© Canon Inc. © Hideharu Naitoh & F design

Canon

1

## PAPER CRAFT

<http://www.canon.com/c-park/en/>



View of completed model

\*Pull on the lever at right to make the tiger jump through a ring of fire and to make the clowns lift their flags.

### ■ Assembly Instructions : Six A4 sheets (No. 1 to No. 6)

\* Build the model by carefully reading the Assembly Instructions , in the parts sheet page order.

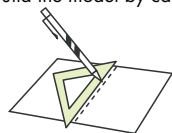

\*Hint: Trace along the folds with a ruler and an exhausted pen (no ink) to get a sharper, easier fold.

### Assembly Instructions



**Mountain fold(dotted line)**  
Make a mountain fold.

**Valley fold(dashed and dotted line)**  
Make a valley fold.

**Scissors line(solid line)**  
Cut along the line.

**Cut in line(solid line)**  
Cut along the line.

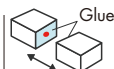

Glue  
The glue spot(colored dot) shows where to apply the glue.

**Glue spot(Red dot)**  
Glue parts with the same number together.

**Glue spot(Green dot)**  
Glue within the same part.

**Glue spot(Blue dot)**  
Glue to the rear of the other part.

#### Tools and materials



Scissors, set square, glue(We recommend stick glue), pencil, used ballpoint pen, toothpicks, tweezers, (useful for handling small parts)

#### Assembly tip



Before gluing, crease the paper along mountain fold and valley fold lines and make sure rounded sections are nice and stiff.

#### Caution



Glue, scissors and other tools may be dangerous to young children so be sure to keep them out of the reach of young children.

Before starting assembly: Writing the number of each section on its back side before cutting out the sections is highly recommended.  
(\* This way, you can be sure which section is which even after cutting out the sections.)

→ Indicates where sections should be glued together.  
→ Indicates where to insert sections. Do not glue the sections together.

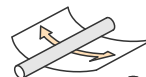

Round bar: Use to give parts a curved surface.



Tweezers: Useful in working with fine parts.



Cut along the line.



Use care here.

**Note:** The tiger uses about 20 centimeters of string to jump through the ring of fire. Be sure to use strong string made of silk or similar material.

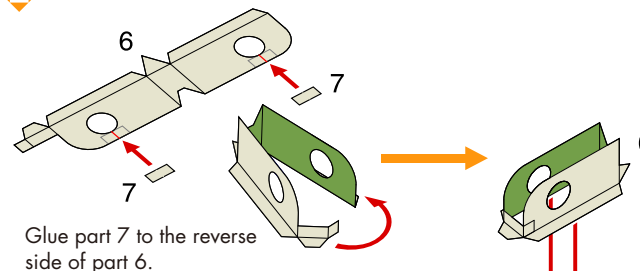

Glue part 7 to the reverse side of part 6.

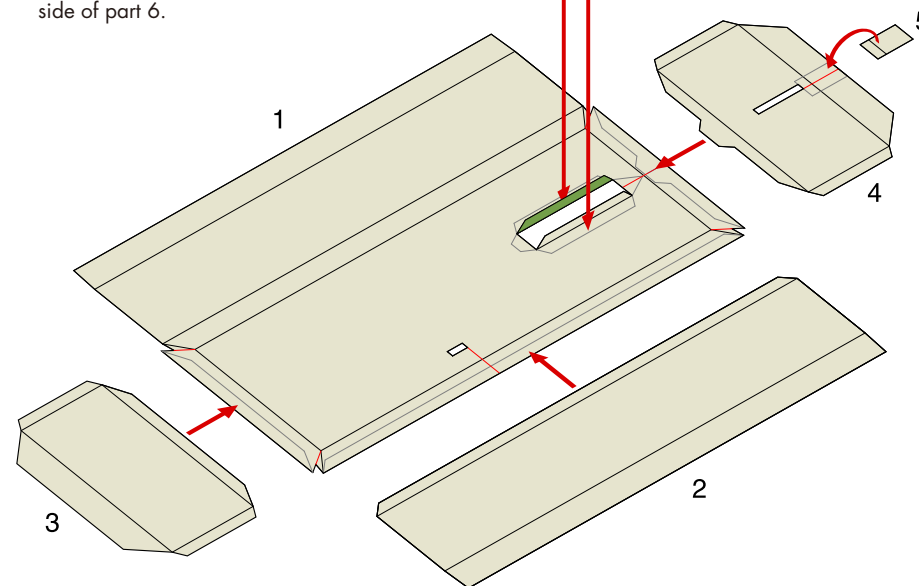



# (Moving) Tiger through a ring of fire : Assembly Instructions

© Canon Inc. © Hideharu Naitoh & F design

Canon

2

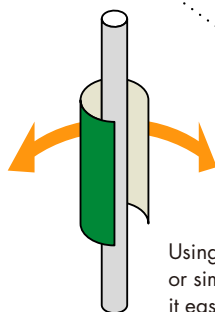
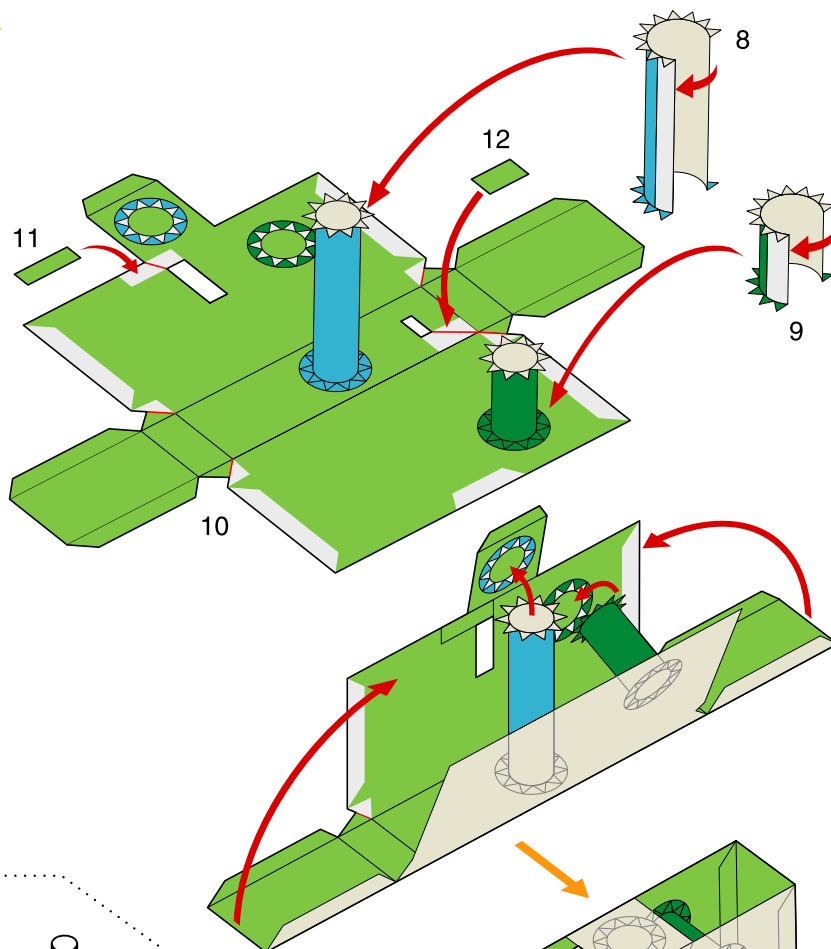

Using a round bar  
or similar item makes  
it easier to assemble  
the round pillars.

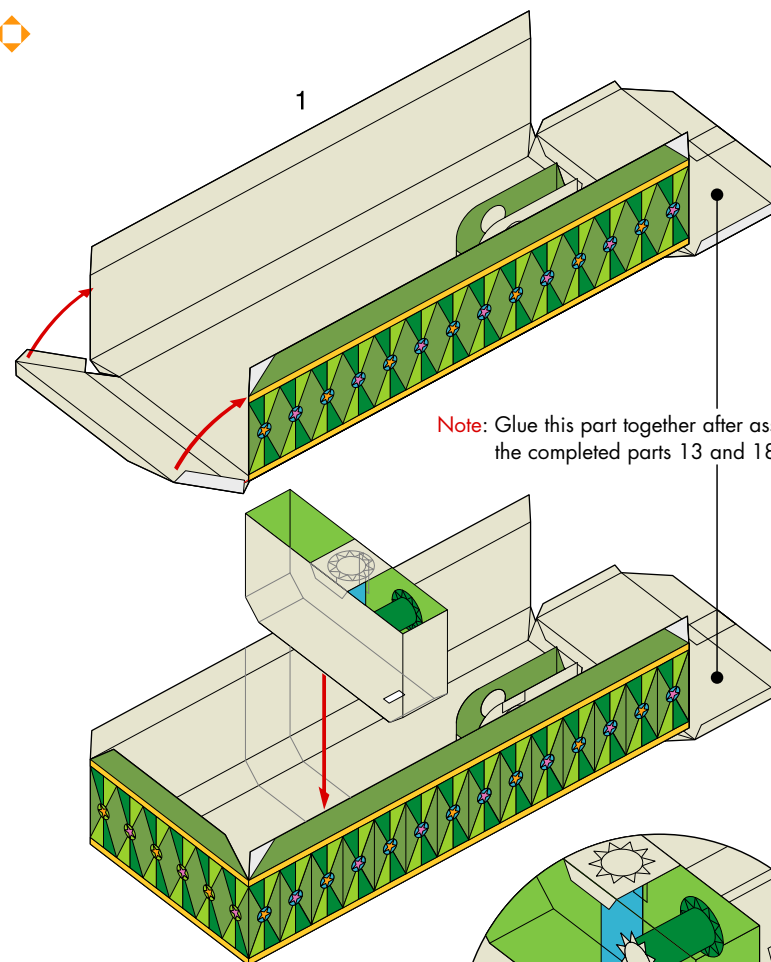

Note: Glue this part together after assembling  
the completed parts 13 and 18.

Glue this piece in place so that it fits precisely  
into the windows cut in parts 1 and 10.  
\*Use glue on the window surface only.  
Do not glue the sides.

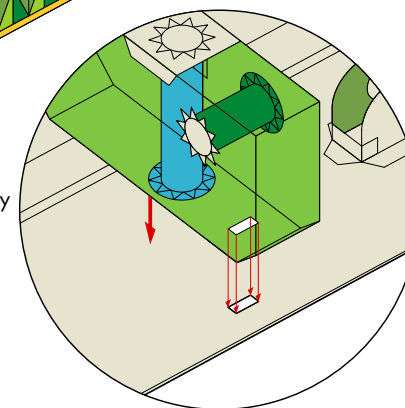



# (Moving) Tiger through a ring of fire : Assembly Instructions

© Canon Inc. © Hideharu Naitoh & F design

Canon

3

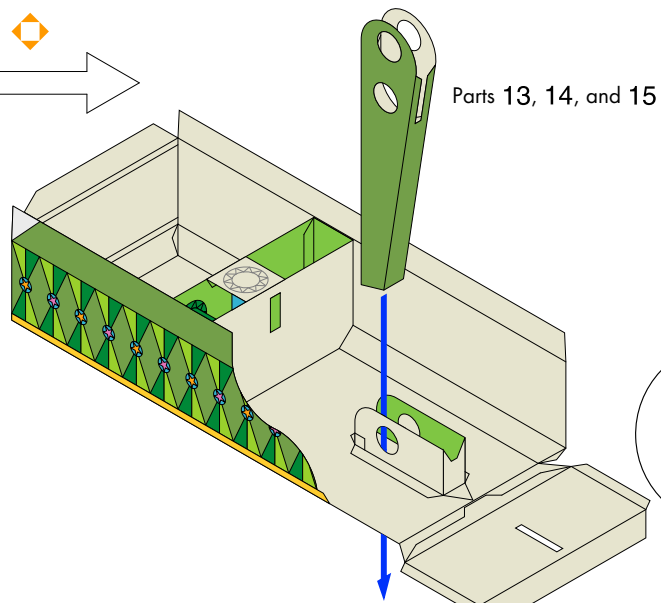
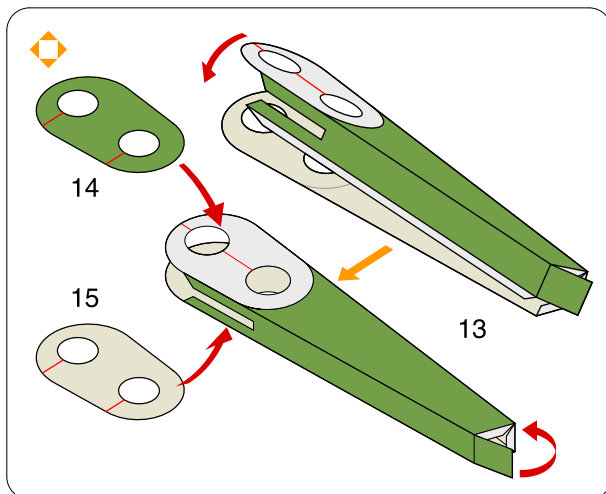

Parts 13, 14, and 15

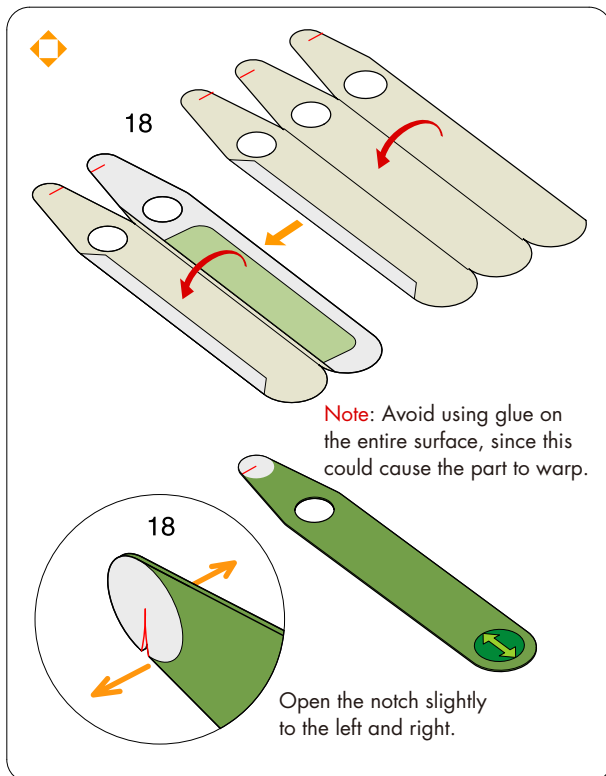

Note: Avoid using glue on the entire surface, since this could cause the part to warp.

Open the notch slightly to the left and right.

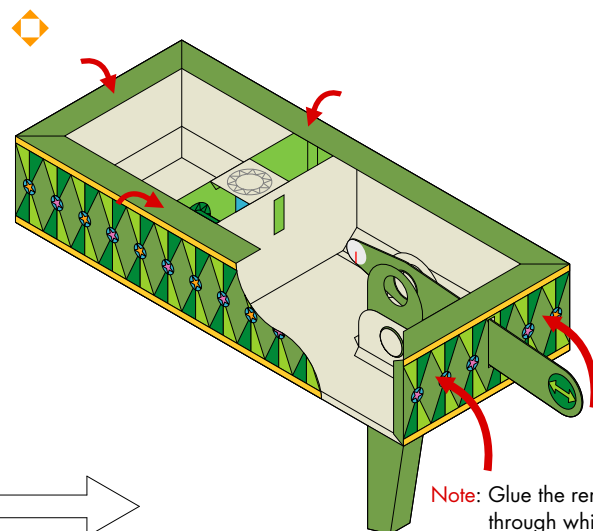

Note: Glue the remaining surface through which the lever runs here.

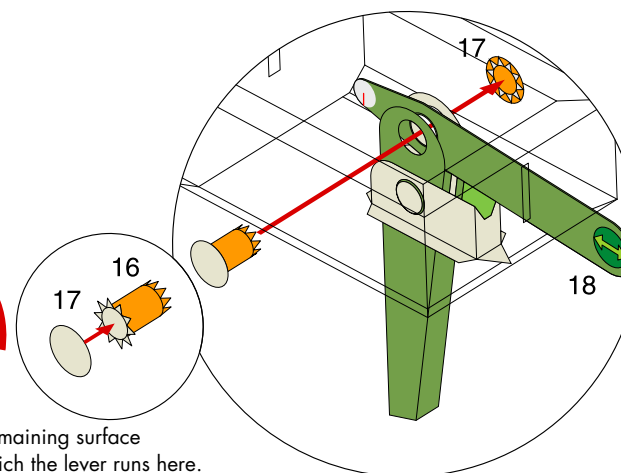



**Canon**

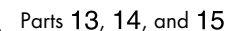
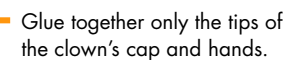
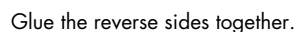
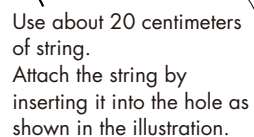

With the parts in positions A, B, and C as shown in the illustration, run the string through part 10 and pull it out. Next, run the string through the hole in part 18. Now pull and push part A to check how it moves. Next, fix the string in position by gluing part 19 in place on both sides.



# (Moving) Tiger through a ring of fire : Assembly Instructions

© Canon Inc. © Hideharu Naitoh & F design

Canon

5

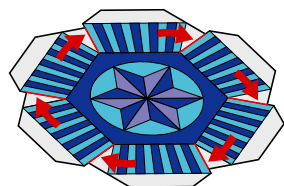

29

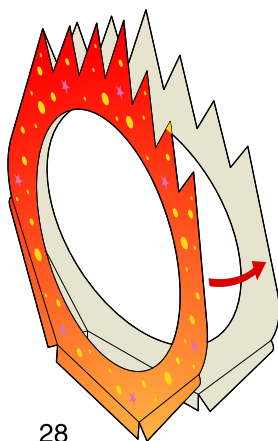
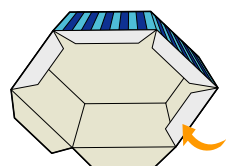
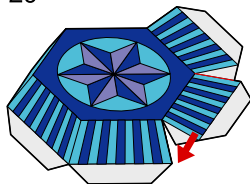

28

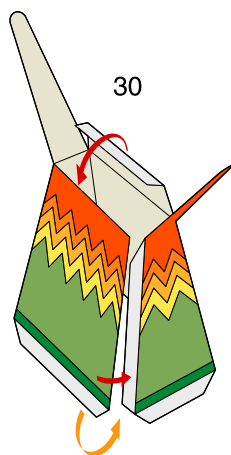
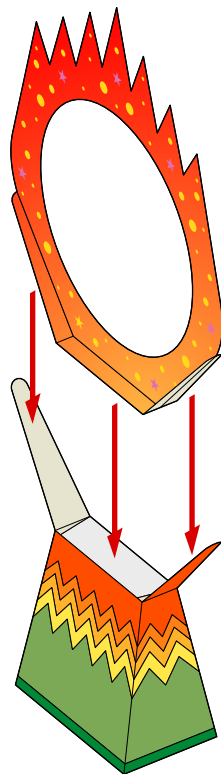

30

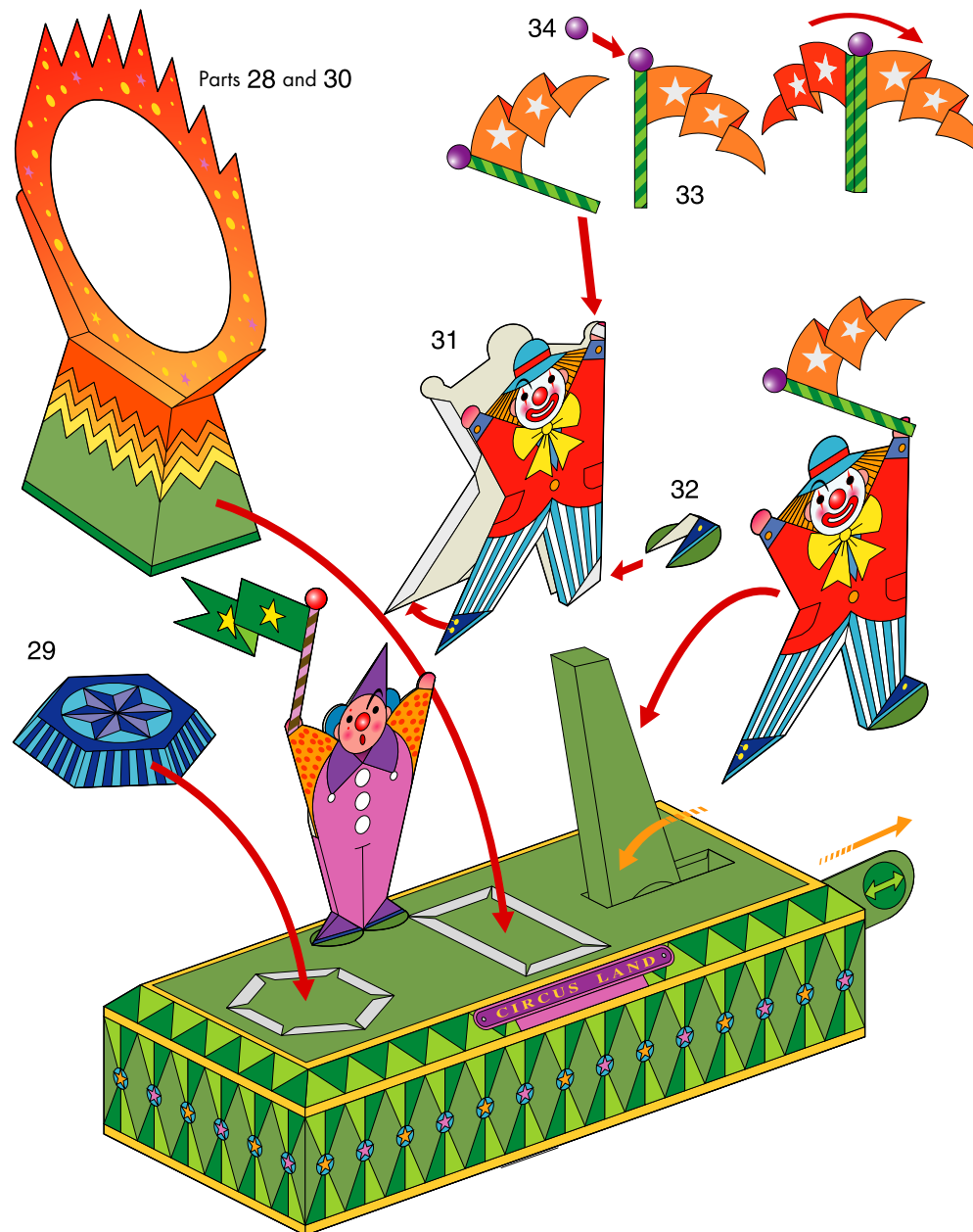

Parts 28 and 30

31

32

33

34

29





# (Moving) Tiger through a ring of fire : Assembly Instructions

© Canon Inc. © Hideharu Naitoh & F design

Canon

6

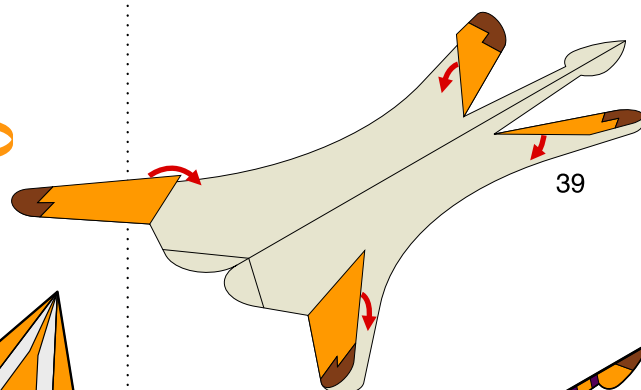
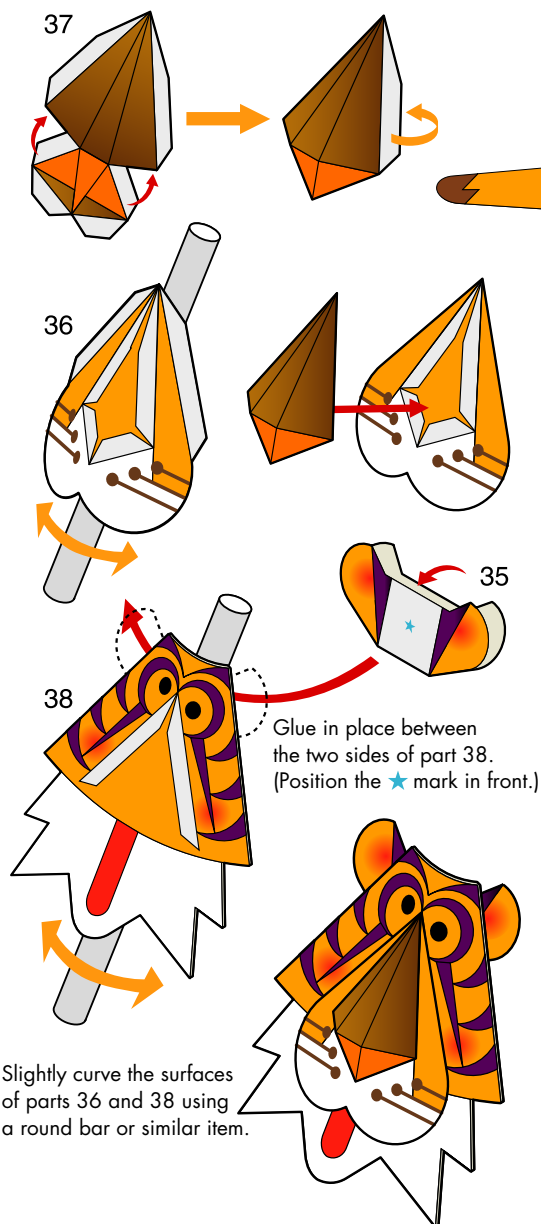

39

Glue to the reverse side of part 38.



Place the tiger's front paws at the center of the hexagonal stand, as shown in the illustration. Attach the rear legs to this part in this position.

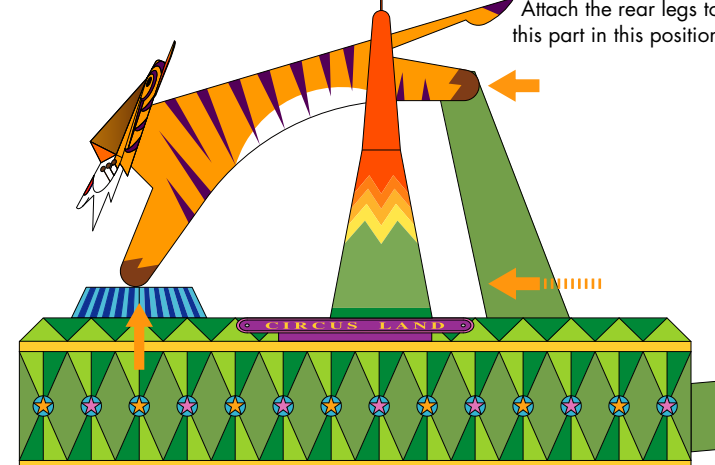

Finished!

