



(Moving) Clowns spinning dishes : Assembly Instructions

© Canon Inc. © Hideharu Naitoh & F design

Canon

CREATIVE PARK

<http://www.canon.com/c-park/en/>



View of completed model

* This model changes appearance in a number of ways when you move the lever beneath the model's frame to the left and right : the eyes on the giant clown face blink, open wide, and move in circles.

■ Assembly Instructions : Six A4 sheets (No. 1 to No. 6)

* Build the model by carefully reading the Assembly Instructions , in the parts sheet page order.

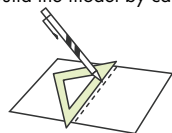

*Hint: Trace along the folds with a ruler and an exhausted pen (no ink) to get a sharper, easier fold.

Assembly Instructions

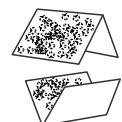

Mountain fold(dotted line)
Make a mountain fold.

Valley fold(dashed and dotted line)
Make a valley fold.

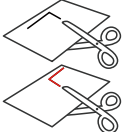

Scissors line(solid line)
Cut along the line.

Cut in line(solid line)
Cut along the line.

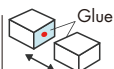

The glue spot(colored dot) shows where to apply the glue.

Glue spot(Red dot)
Glue parts with the same number together.

Glue spot(Green dot)
Glue within the same part.

Glue spot(Blue dot)
Glue to the rear of the other part.

Tools and materials



Scissors, set square, glue(We recommend stick glue), pencil, used ballpoint pen, toothpicks, tweezers, (useful for handling small parts)

Assembly tip



Before gluing, crease the paper along mountain fold and valley fold lines and make sure rounded sections are nice and stiff.

Caution



Glue, scissors and other tools may be dangerous to young children so be sure to keep them out of the reach of young children.

Before starting assembly : Writing the number of each section on its back side before cutting out the sections is highly recommended.
(* This way, you can be sure which section is which even after cutting out the sections.)

→ Indicates where sections should be glued together.
→ Indicates where to insert sections. Do not glue the sections together.

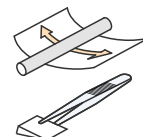

Round bar : Use to give parts a curved surface.

Tweezers : Useful in working with fine parts.



Cut along the line.



Use care here.



Glue the entire reverse sides of part 1 and part 4 to each other, as shown in this illustration. Take care in positioning and direction of the parts when gluing them.

Caution : Spread the glue in a thin layer, to prevent these parts from warping after you glue them together.

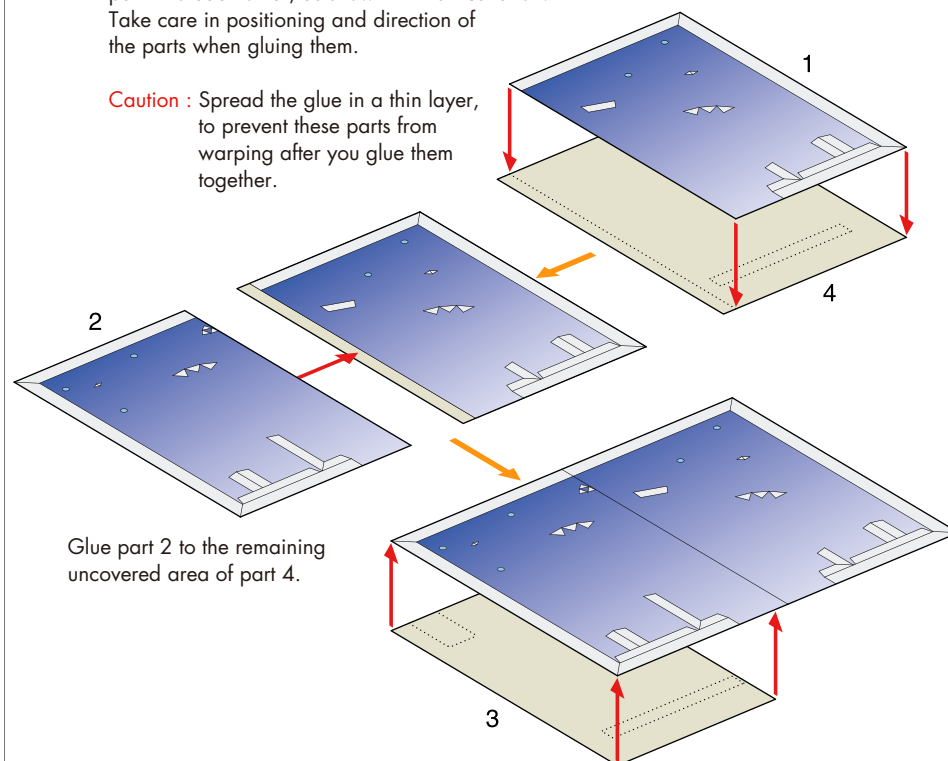

Glue part 2 to the remaining uncovered area of part 4.

Glue the rear sides of part 2 and part 3 to each other, lining these parts up.



(Moving) Clowns spinning dishes : Assembly Instructions

© Canon Inc. © Hideharu Naitoh & F design

Canon

2

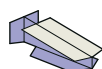
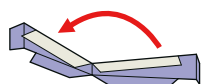
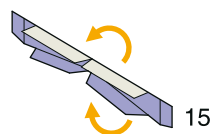
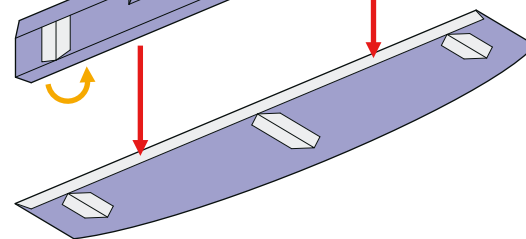
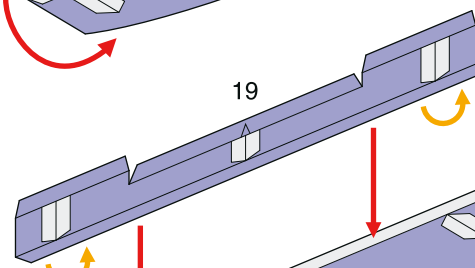
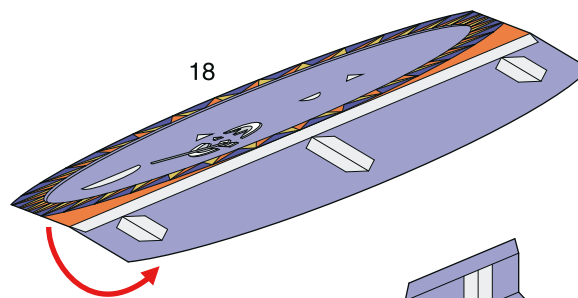
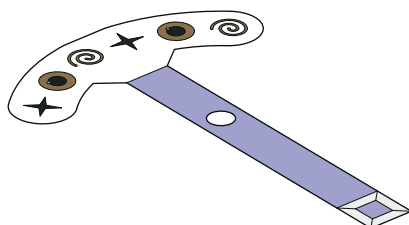
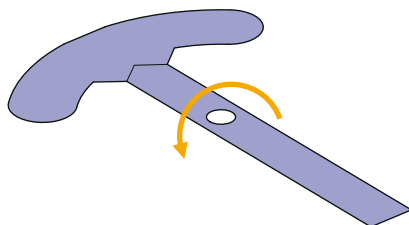
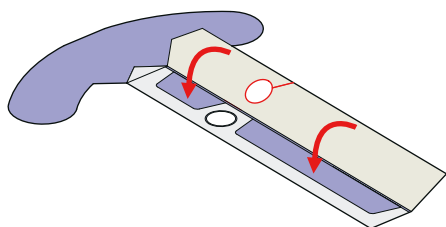
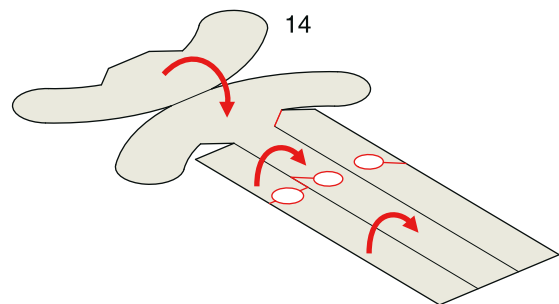

Build two identical parts.

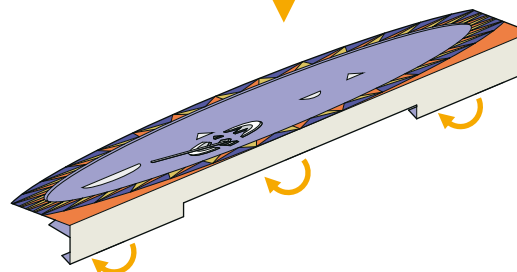
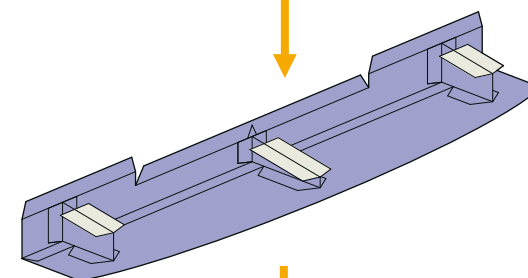
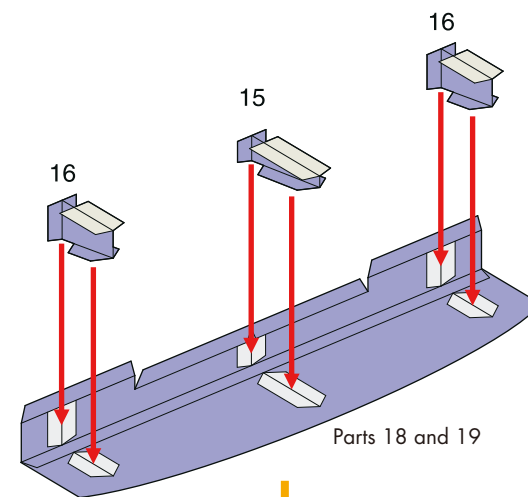
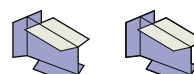
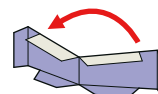
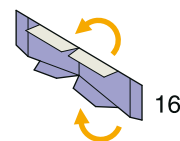



(Moving) Clowns spinning dishes : Assembly Instructions

© Canon Inc. © Hideharu Naitoh & F design

Canon

3

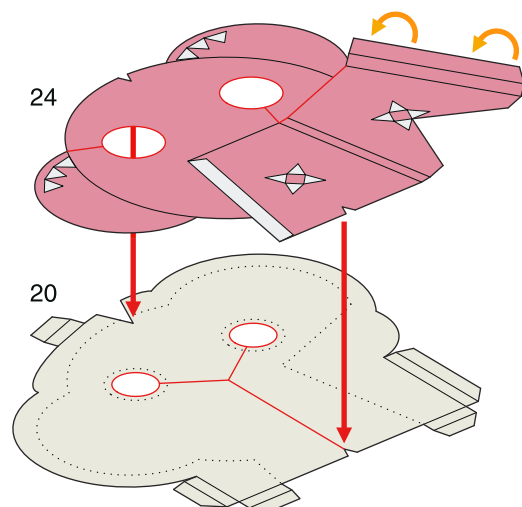

Glue the reverse sides of parts 20 and 24 together, by aligning the V-Shaped cutouts at either end.

Caution : spread a thin layer of glue on the surface to ensure it does not warp after gluing these parts together.

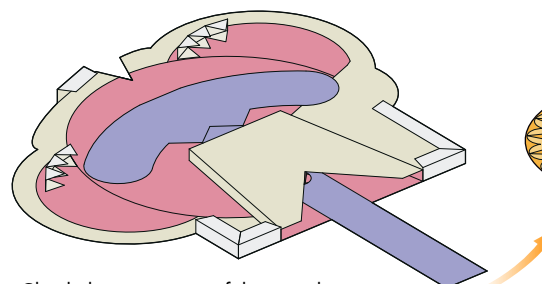
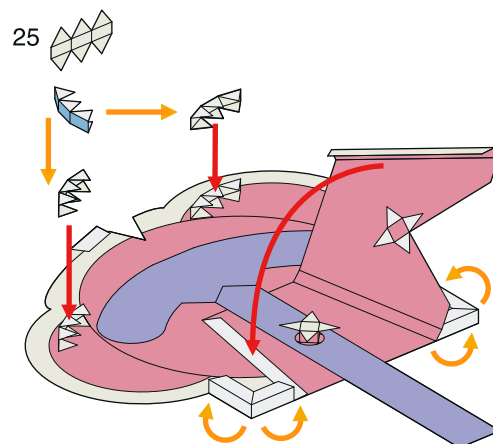
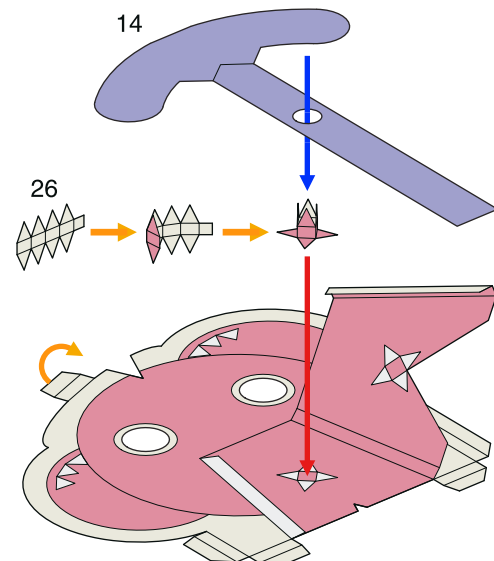

Check the movement of the eyes by moving the lever to the left and right.

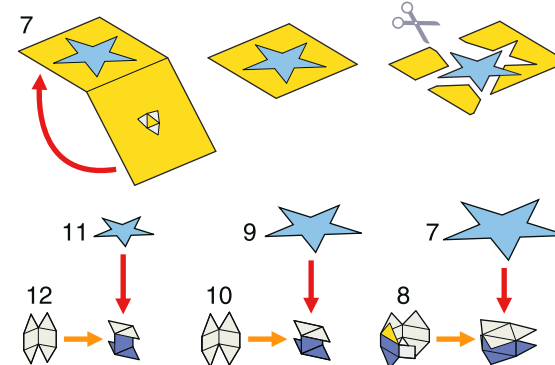
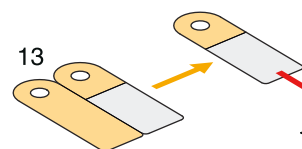

Parts 14, 20, and 24 to 26

Parts 1 to 4



(Moving) Clowns spinning dishes : Assembly Instructions

© Canon Inc. © Hideharu Naitoh & F design

Canon

4

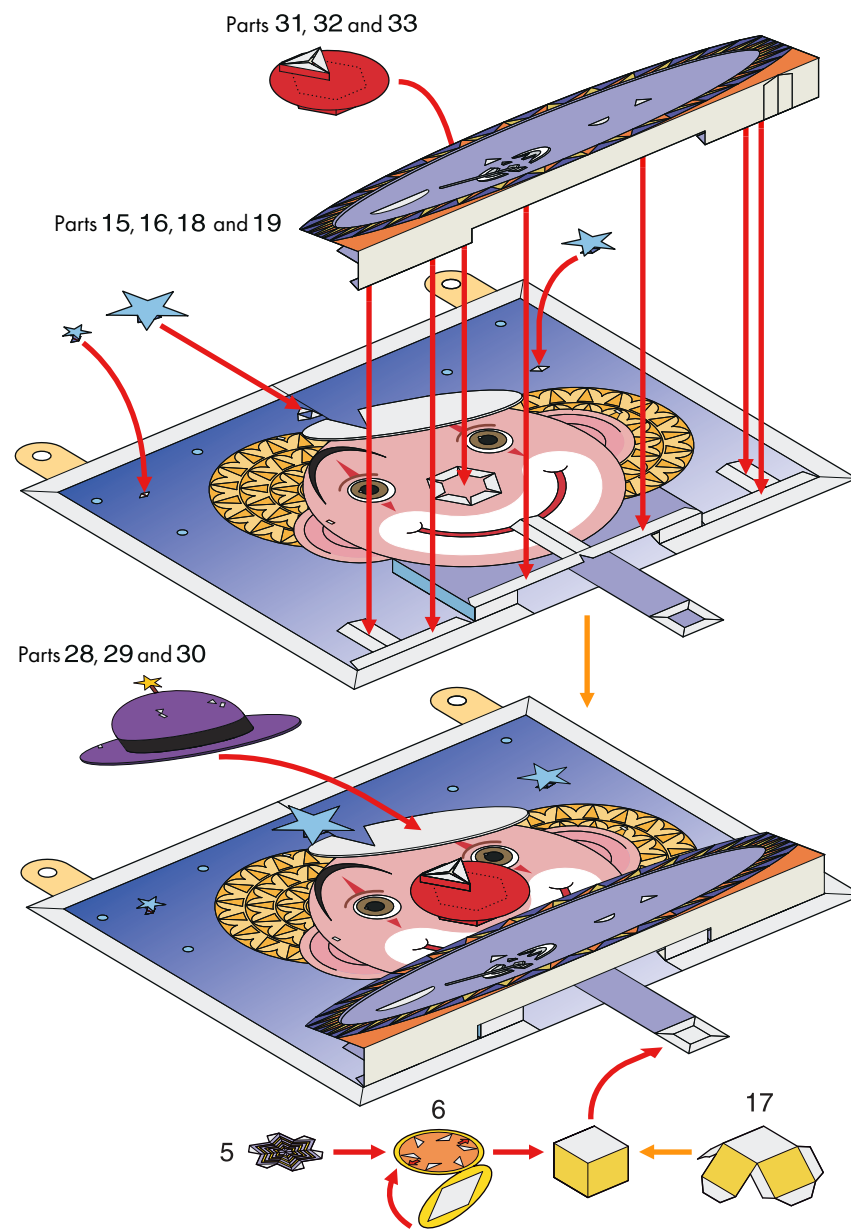
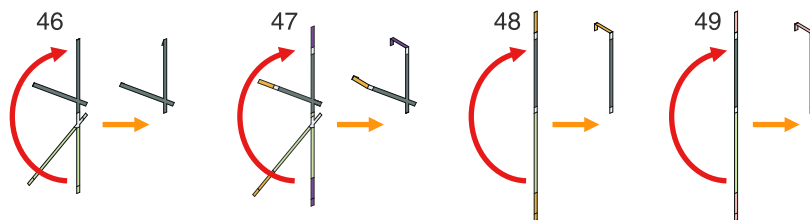
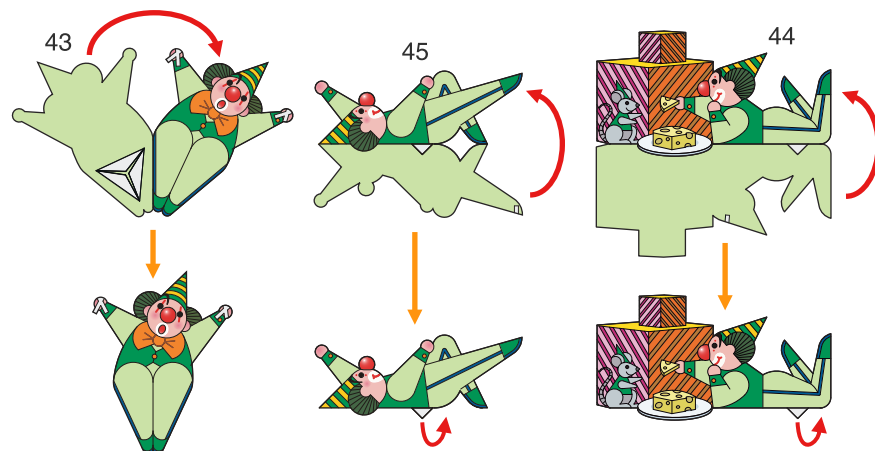
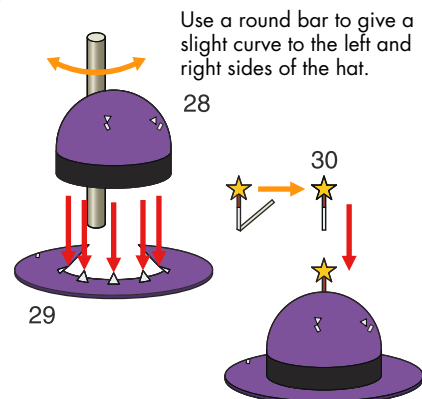
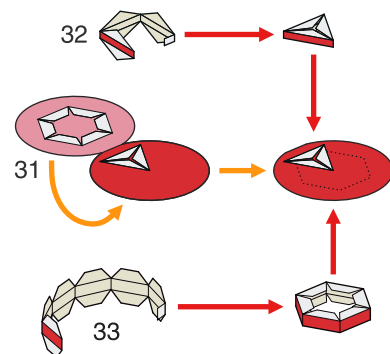



(Moving) Clowns spinning dishes : Assembly Instructions

© Canon Inc. © Hideharu Naitoh & F design

Canon

5

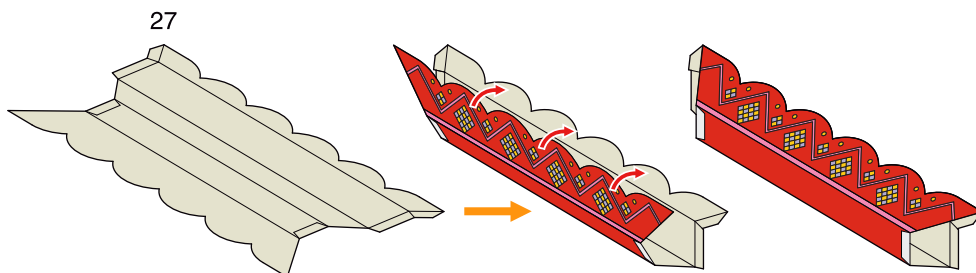

Build two identical parts, using these as the left and right sides of the frame.

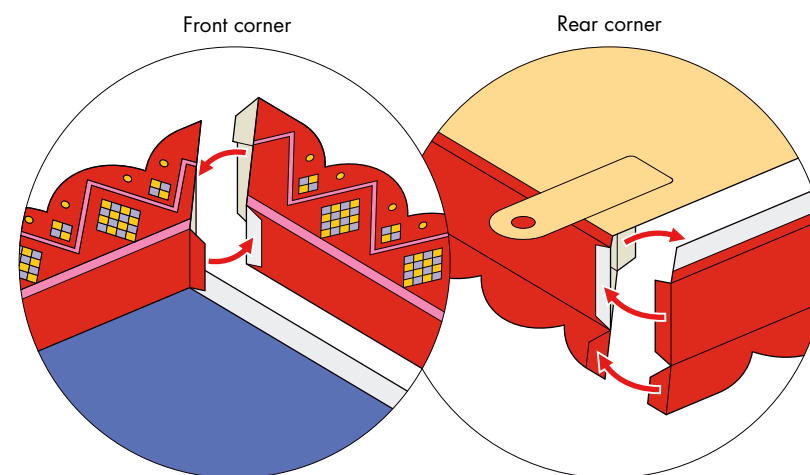
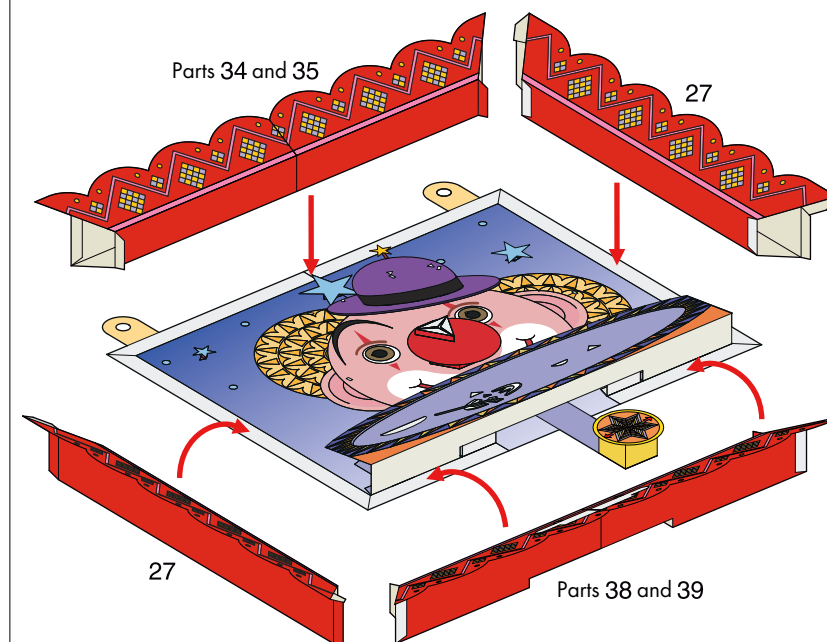
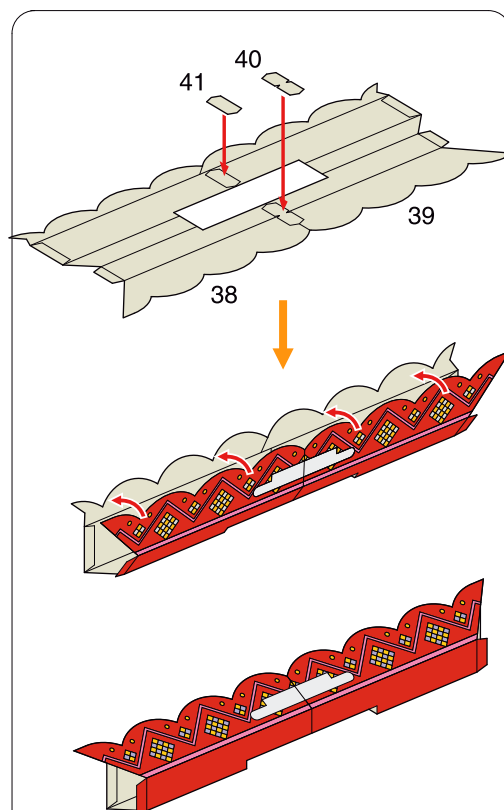
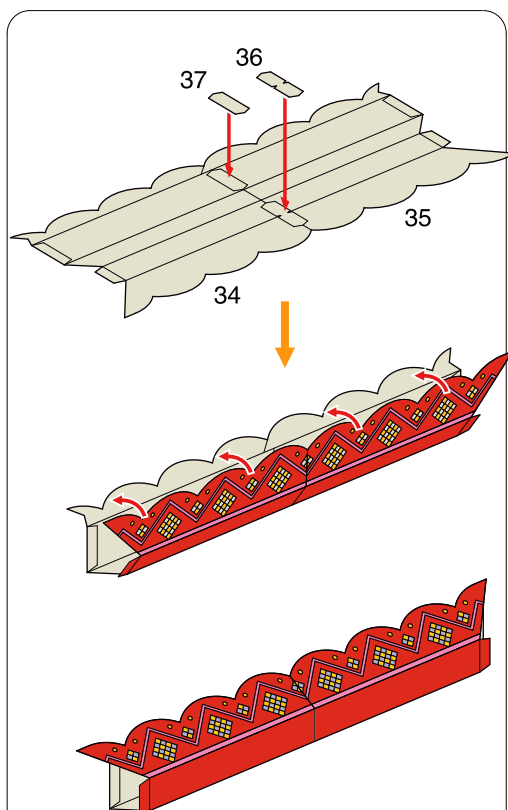



(Moving) Clowns spinning dishes : Assembly Instructions

© Canon Inc. © Hideharu Naitoh & F design

Canon

6

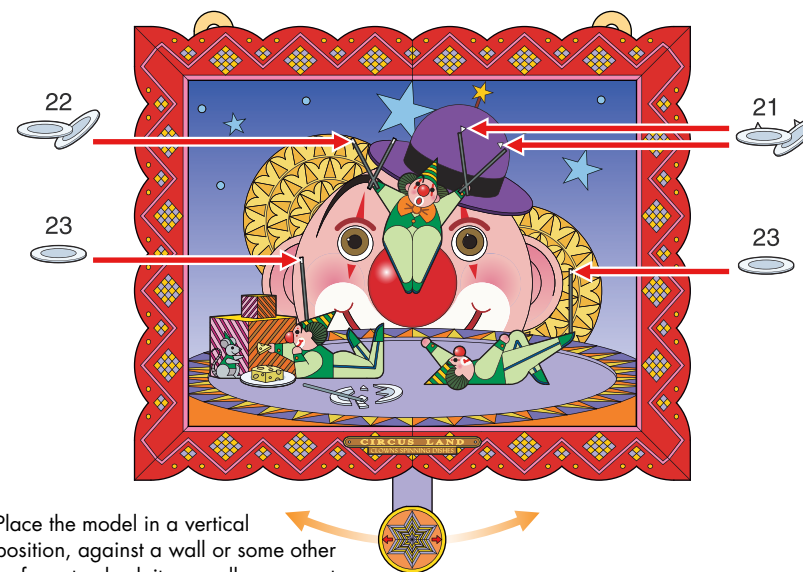
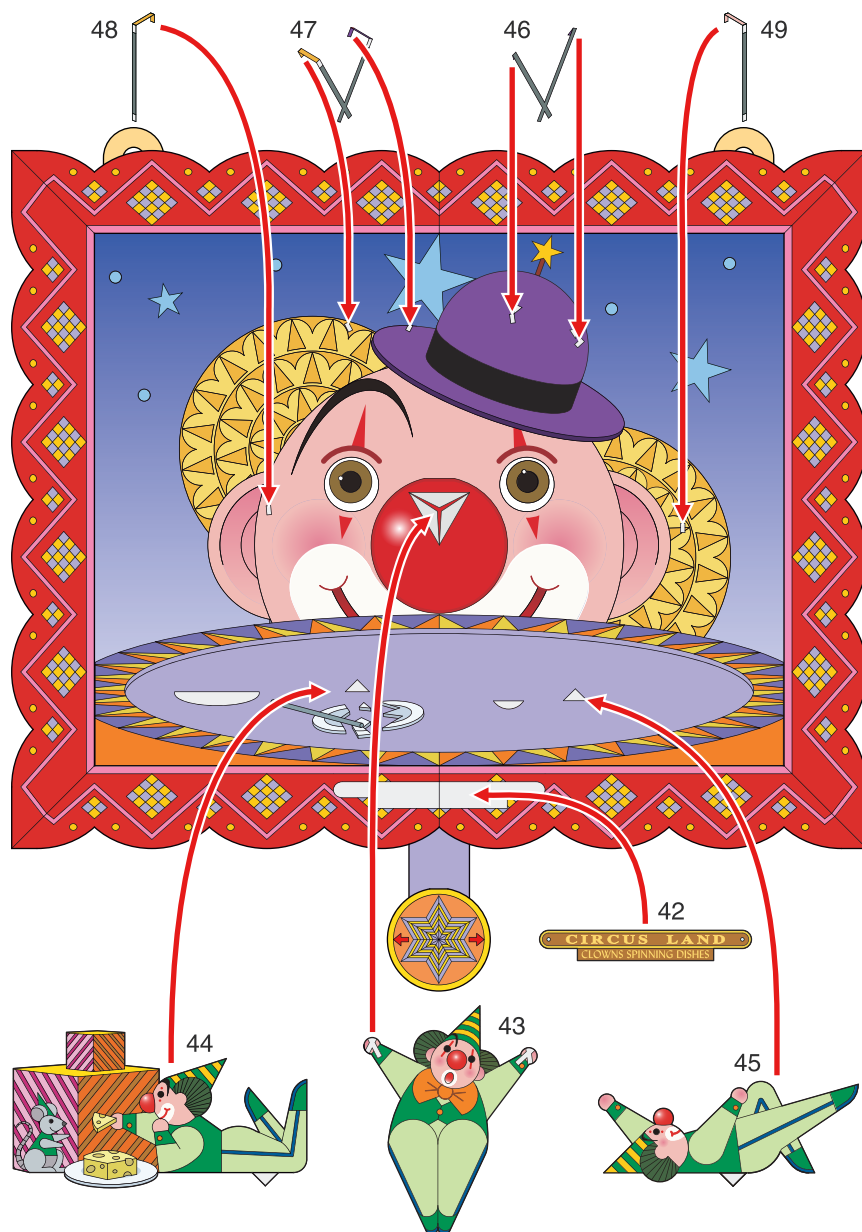

Finished!

