

## CREATIVE PARK

<http://www.canon.com/c-park/>



View of completed model

### ■ Assembly Instructions : Nine A4 sheets (No. 1 to No. 9)

#### Assembly Instructions



##### Mountain fold(dotted line)

Make a mountain fold.



##### Valley fold(dashed and dotted line)

Make a valley fold.



##### Scissors line(solid line)

Cut along the line.



##### Cut in line(solid line)

Cut along the line.

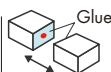

Glue

The glue spot(colored dot) shows where to apply the glue.

##### ● Glue spot(Red dot)

Glue parts with the same number together.

##### ● Glue spot(Green dot)

Glue within the same part.

##### ● Glue spot(Blue dot)

Glue to the rear of the other part.

#### Tools and materials



Scissors, set square, glue(We recommend stick glue), pencil, used ballpoint pen, toothpicks, tweezers, (useful for handling small parts)

#### Assembly tip



Before gluing, crease the paper along mountain fold and valley fold lines and make sure rounded sections are nice and stiff.

#### Caution



Glue, scissors and other tools may be dangerous to young children so be sure to keep them out of the reach of young children.



\* Build the model by carefully reading the Assembly Instructions , in the parts sheet page order.

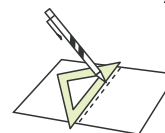

\*Hint: Trace along the folds with a ruler and an exhausted pen (no ink) to get a sharper, easier fold.

Before starting assembly :  
Writing the number of each section on its back side before cutting out the sections is highly recommended.  
(\* This way, you can be sure which section is which even after cutting out the sections.)

→ Indicates where sections should be glued together.

→ Indicates where to insert sections. Do not glue the sections together.

## 【1】 Base assembly 1

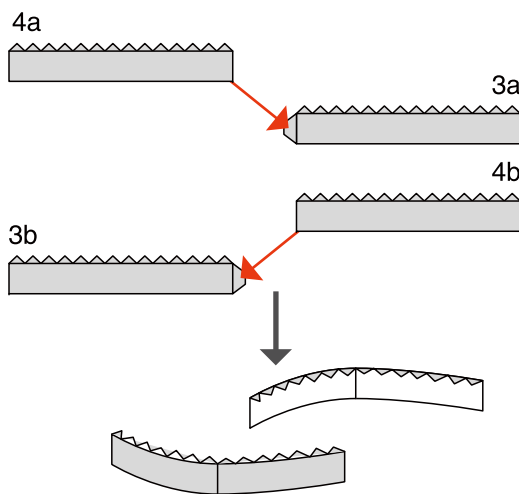

\*Gently shape the curve.

## 【2】 Base assembly 2

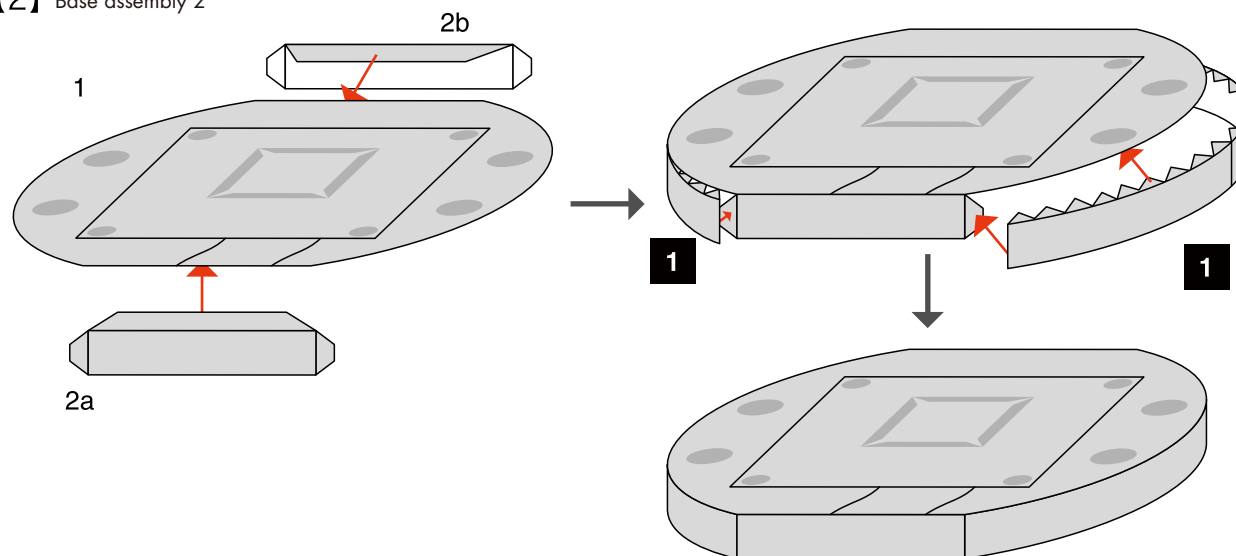

## 【3】 Base reinforcement

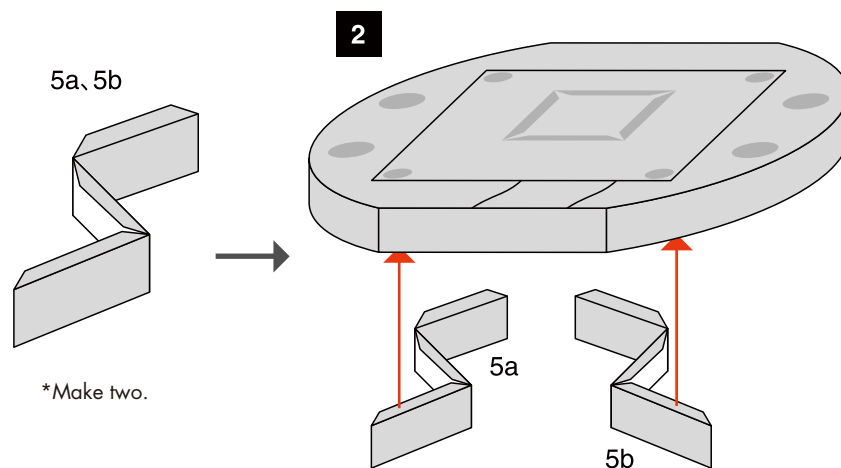

\*Make two.

\*Attach in an appropriate position.

## 【4】 Supporting pillar assembly

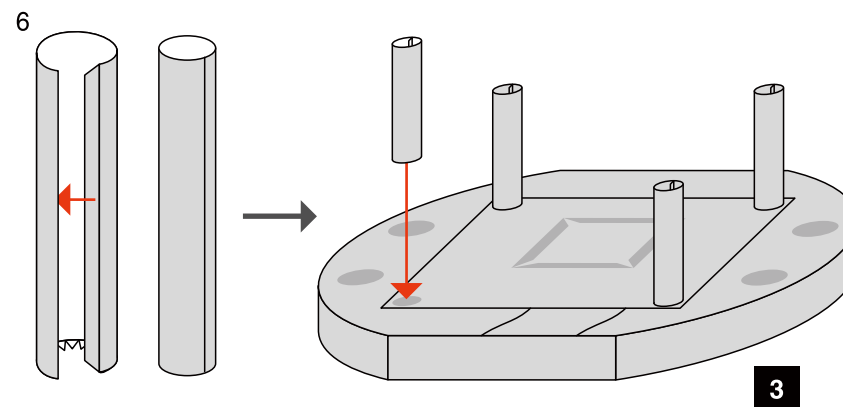

\*Make four.

## 【5】 Front door assembly

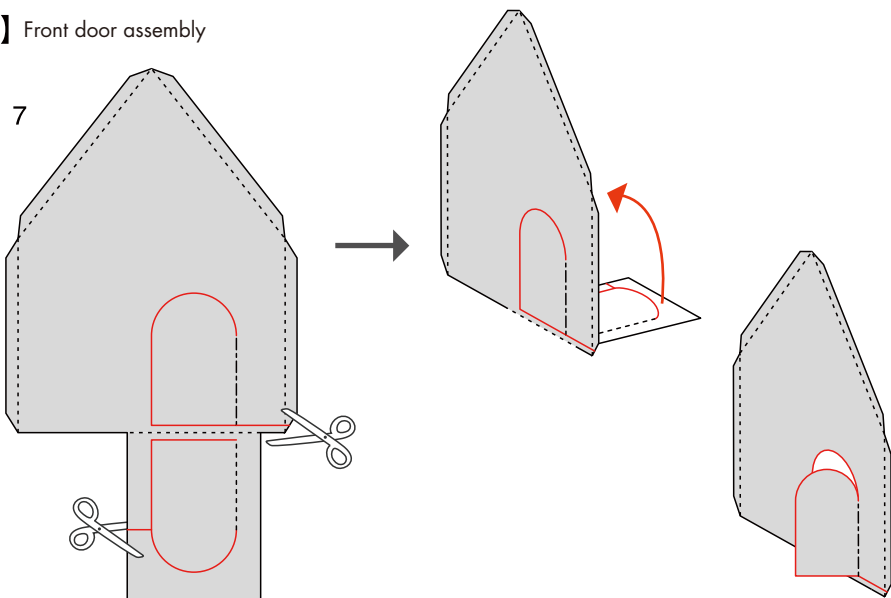

## 【6】 Window assembly

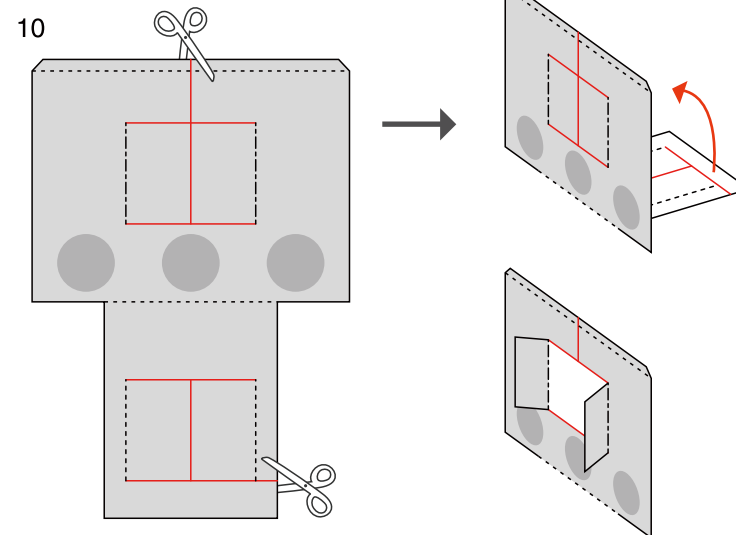

## 【7】 Outer wall assembly

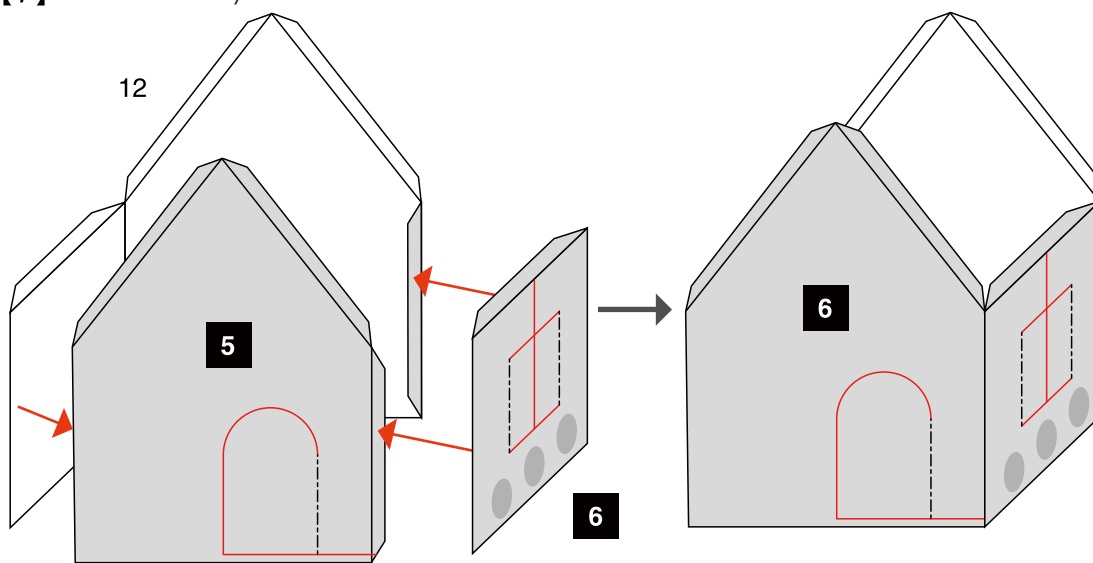

## 【8】 Mushroom assembly

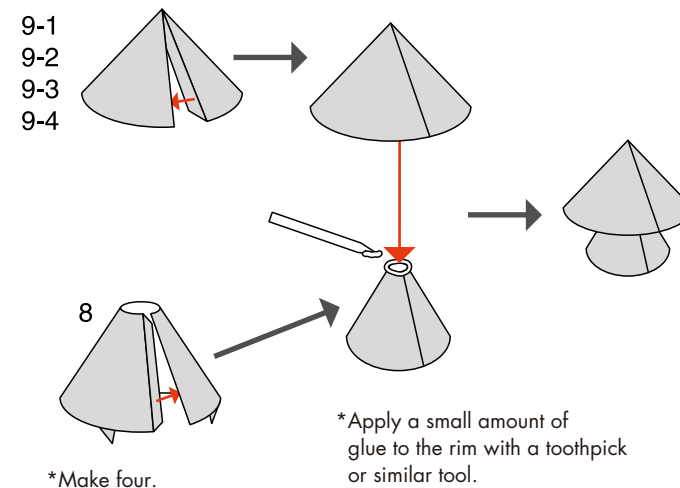

## 【9】 Second floor assembly

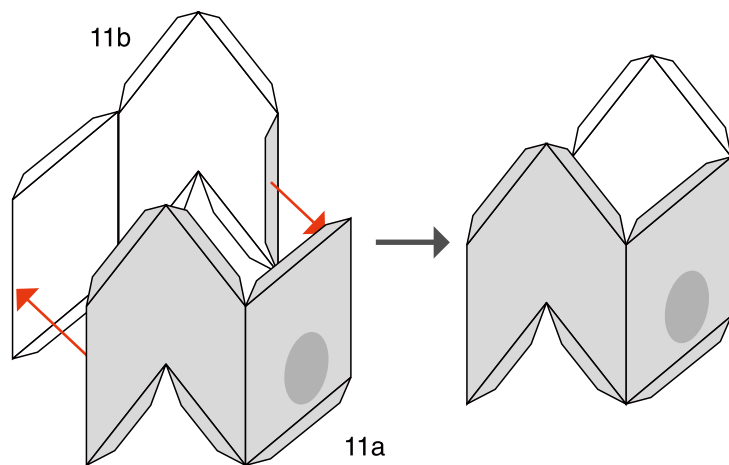

## 【10】 Roof assembly 1

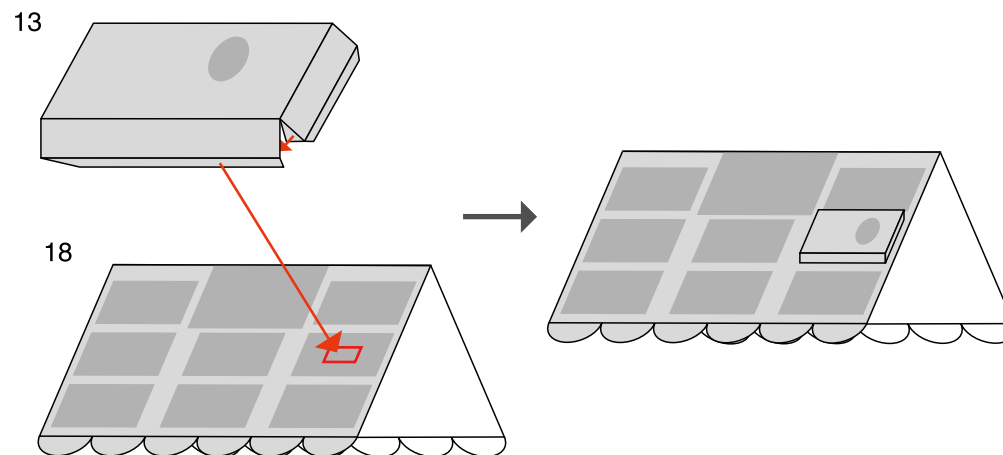

## 【11】 Roof assembly 2

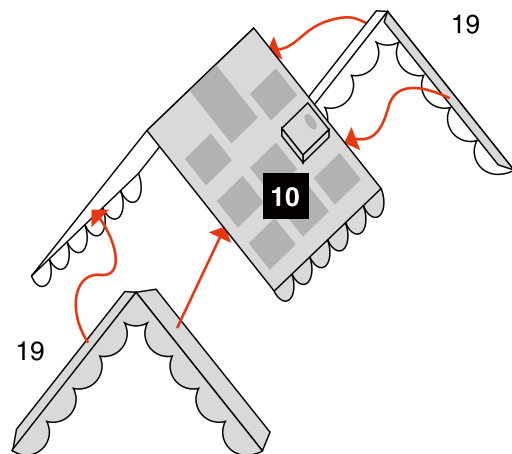

## 【12】

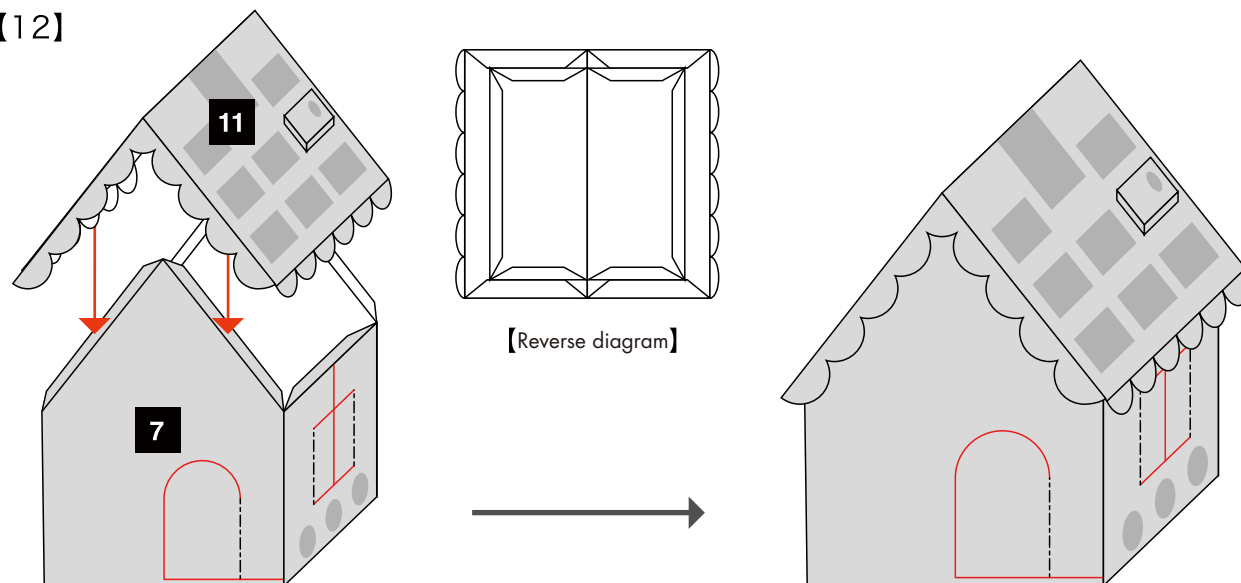

【13】

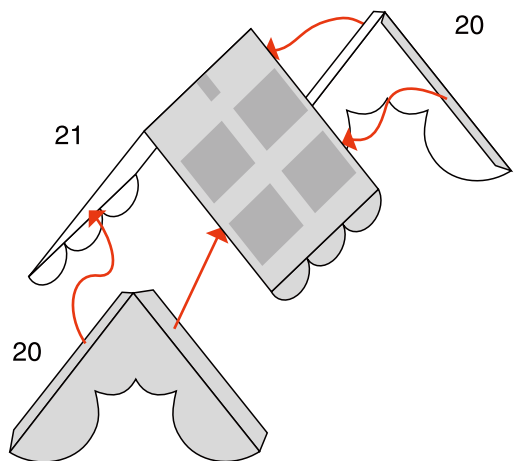

【14】

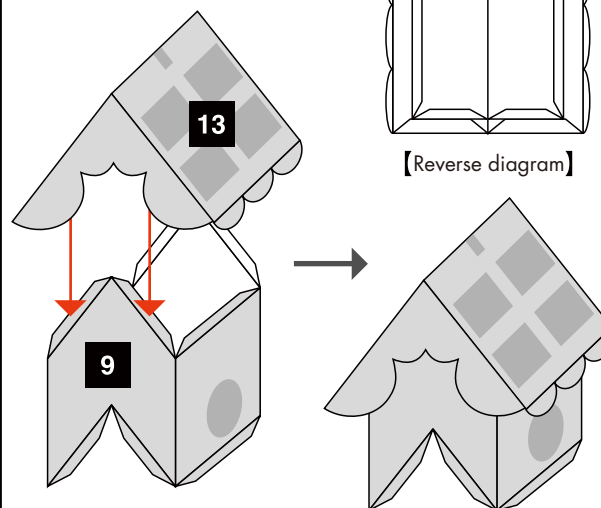

【15】

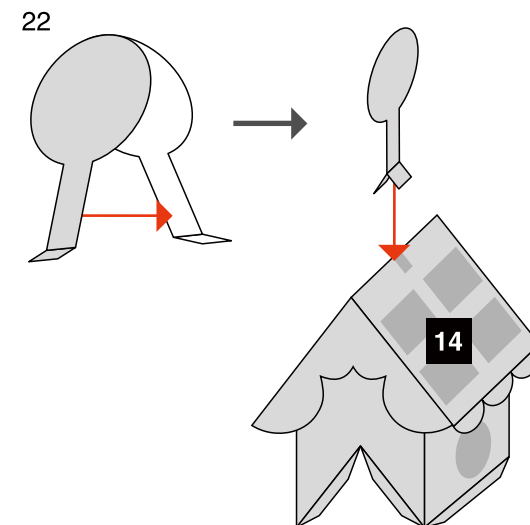

【16】 Chimney assembly

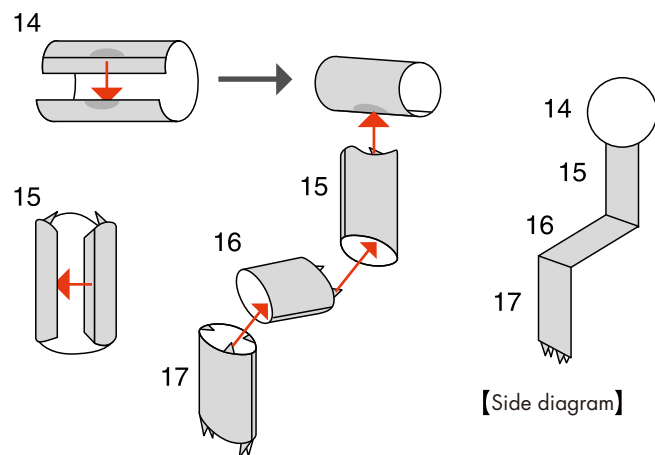

【17】

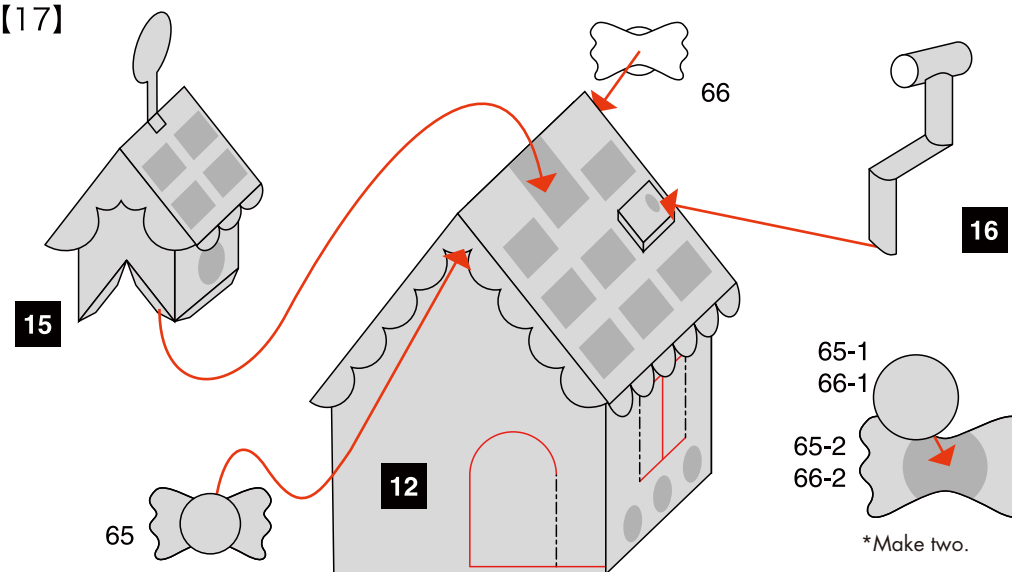

# DREAM HOUSE Cookie house : Assembly Instructions

© Canon Inc. © Ohkuma Mitsuo

Canon

## 【18】 Roof decoration (cookie) assembly

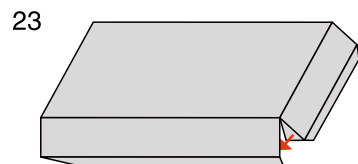

\*Assemble 15 large cookies.

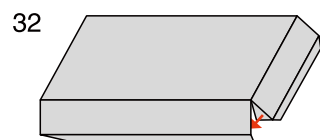

\*Assemble 8 small cookies.

## 【19】 Outdoor decoration (doughnuts) assembly

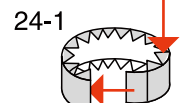
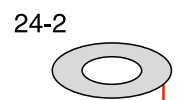

\*Assemble 8 doughnuts  
(parts 25-1 to 31-2)

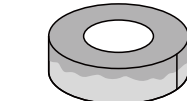

\*Confirm the direction of the illustration  
as you assemble the parts.

## 【20】

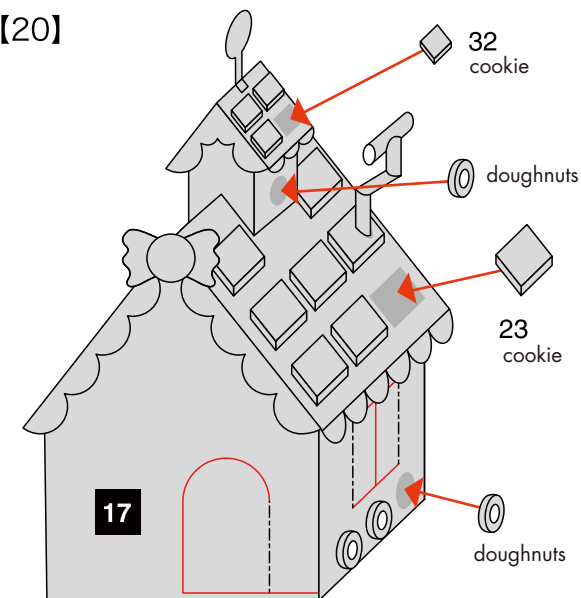

## 【21】 Face assembly

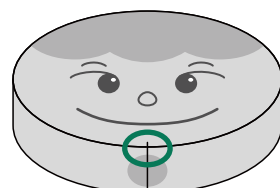
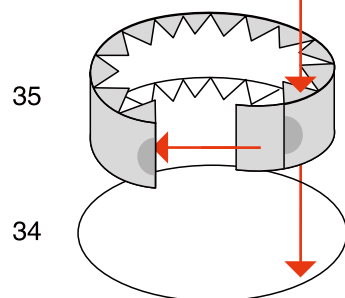

\*Align with guidelines.

## 【22】 Neck assembly

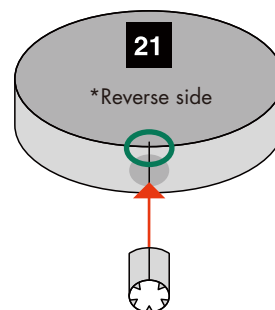
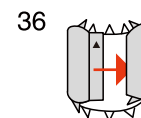

\*Reverse side

## 【23】 Hair assembly 1

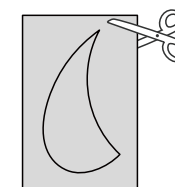
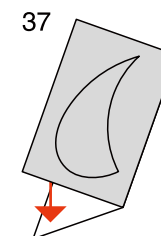

\*Glue together and  
then cut out shapes.



## 【24】 Hair assembly 2

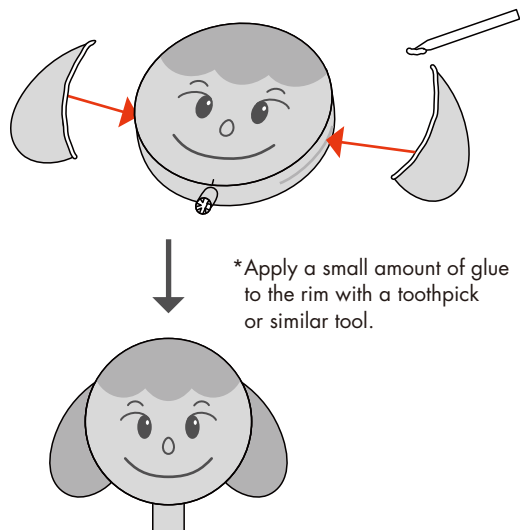

## 【25】 Left arm assembly

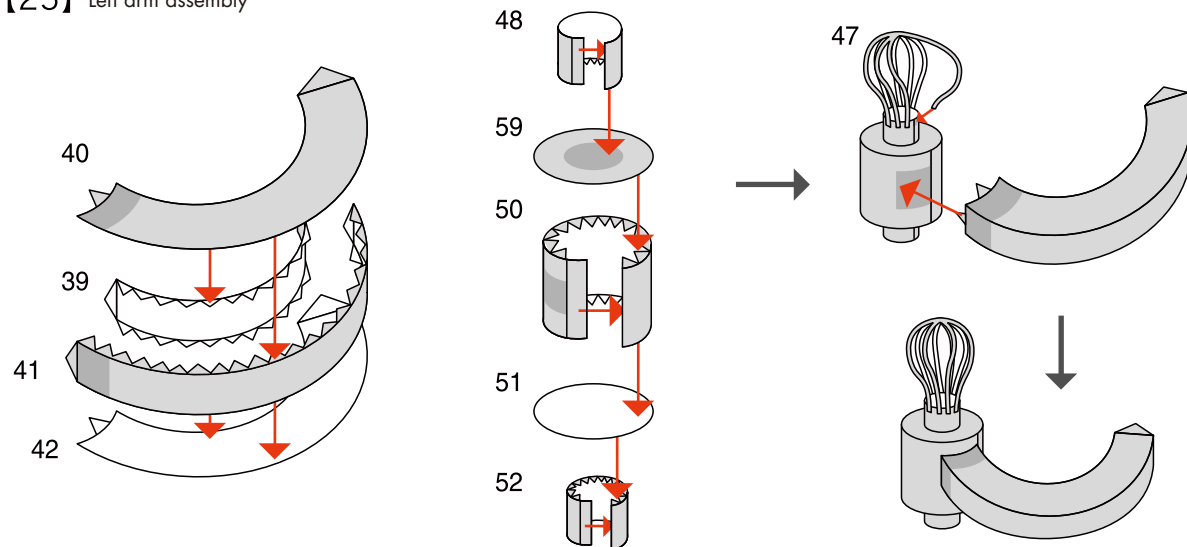

## 【26】 Right arm assembly

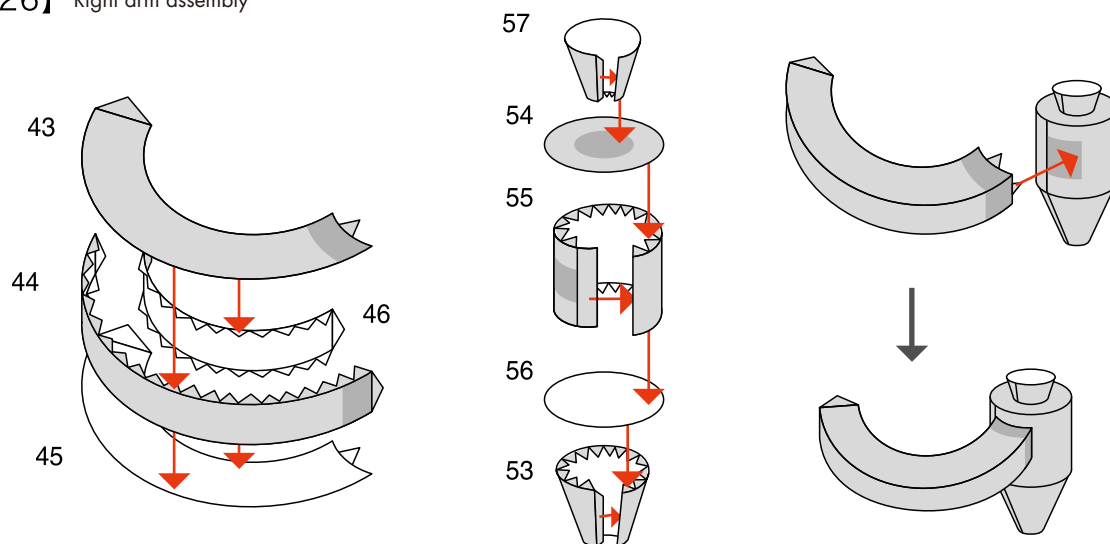

## 【27】 Oven and cake assembly

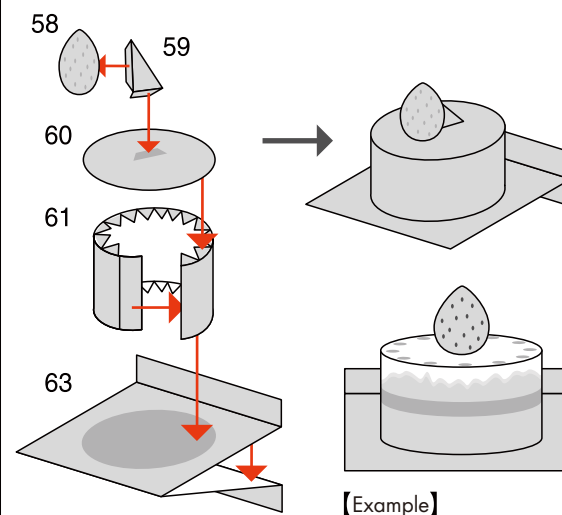

## [28] Body assembly

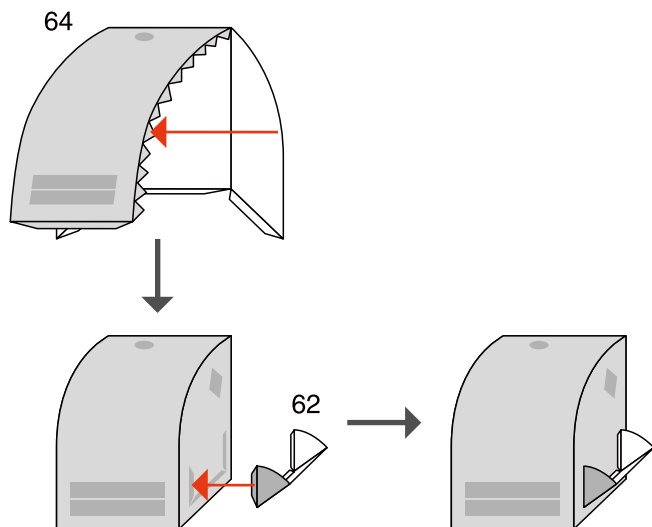

## [29]

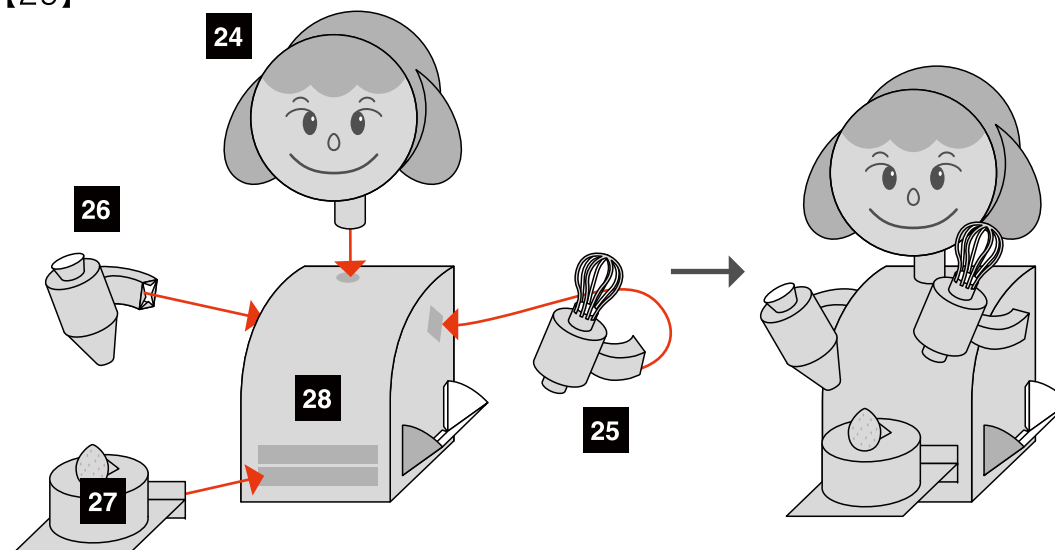

## [30]

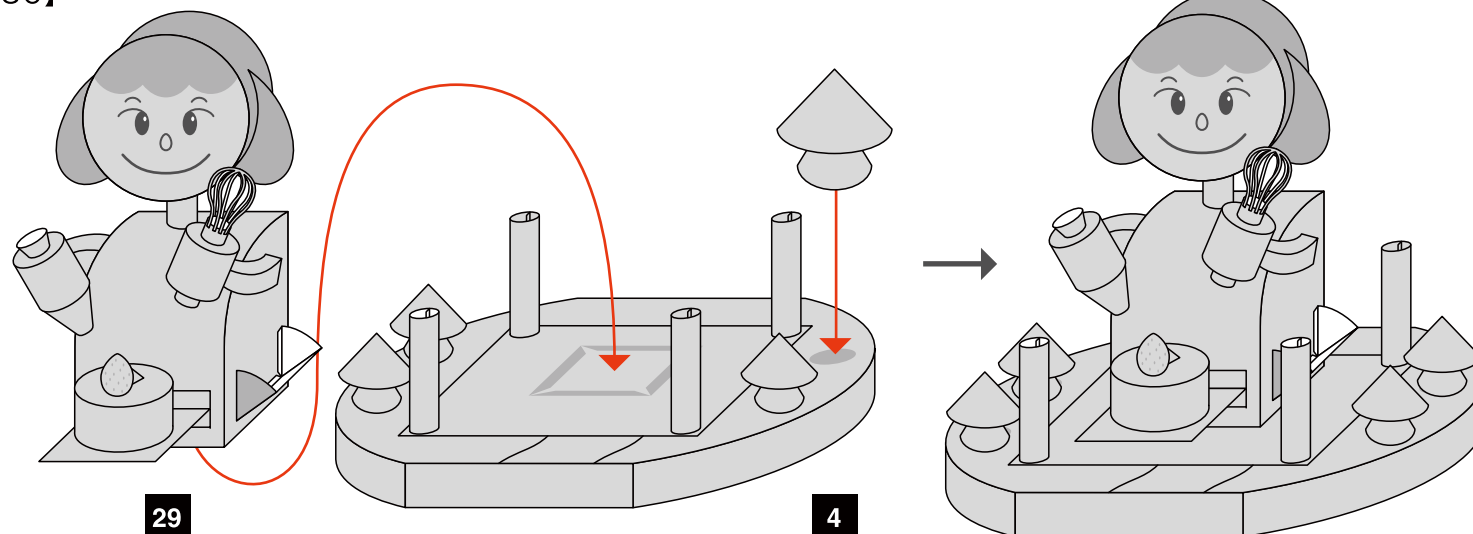

## [31]

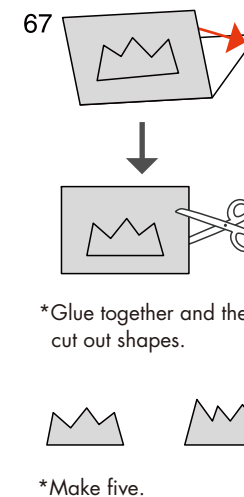



【32】 Example of decorative parts assembly.

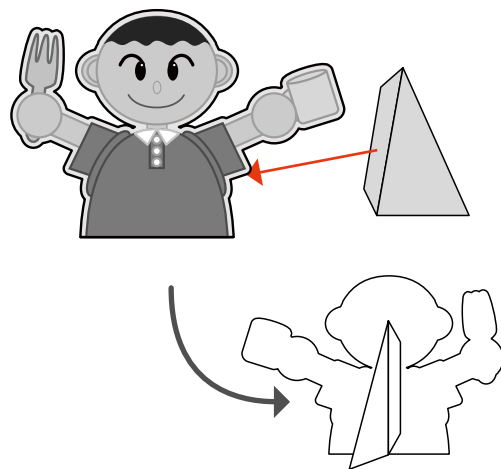

【33】 Place decorative parts as you like.

【Example】



\*Apply a small amount of glue to the rim with a toothpick or similar tool.

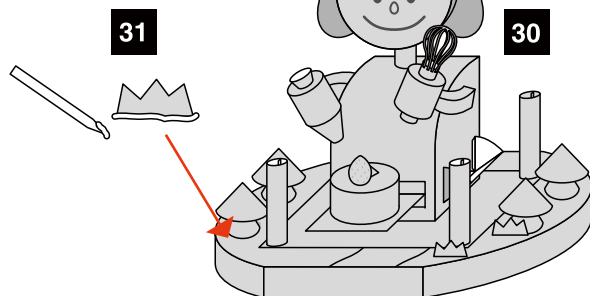

\*Place to permit easy removal.

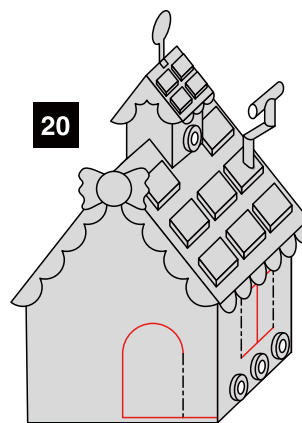

【Example】