



Assembly Instructions

● **Pattern:** 10 sheets ● **Assembly Instructions:** 2 sheets ● **No. of parts:** 37

● **Tools and materials:**

Scissors, glue, ruler, a used ball-point pen

● **Assembly tip:**

Trace along the folds with a ruler and a used pen (no ink) to get a sharpe, easier fold.

- Mountain fold - - - - - Valley fold ● Glue spot
- Scissors line ——— Cut in line

Caution: Glue, scissors and other tools may be dangerous to young children so be sure to keep them out of the reach of young children.

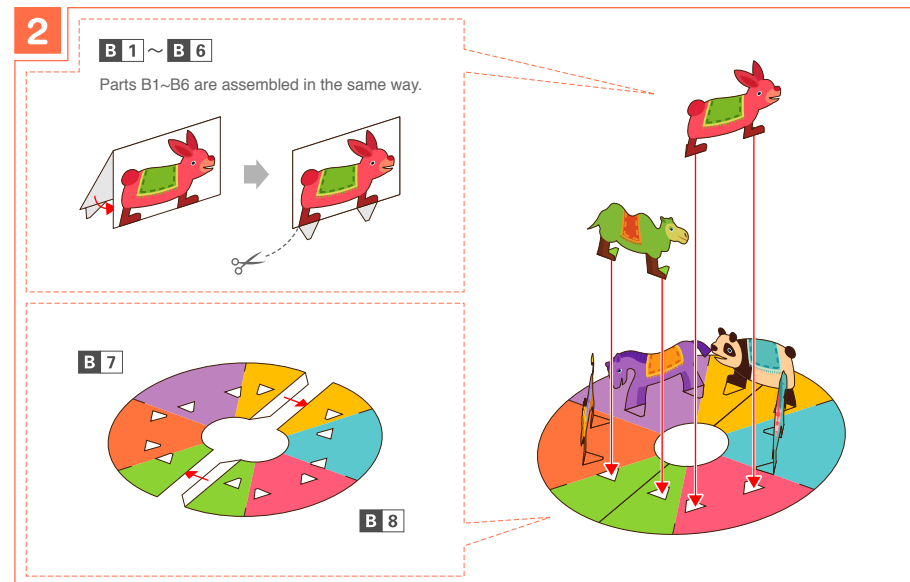
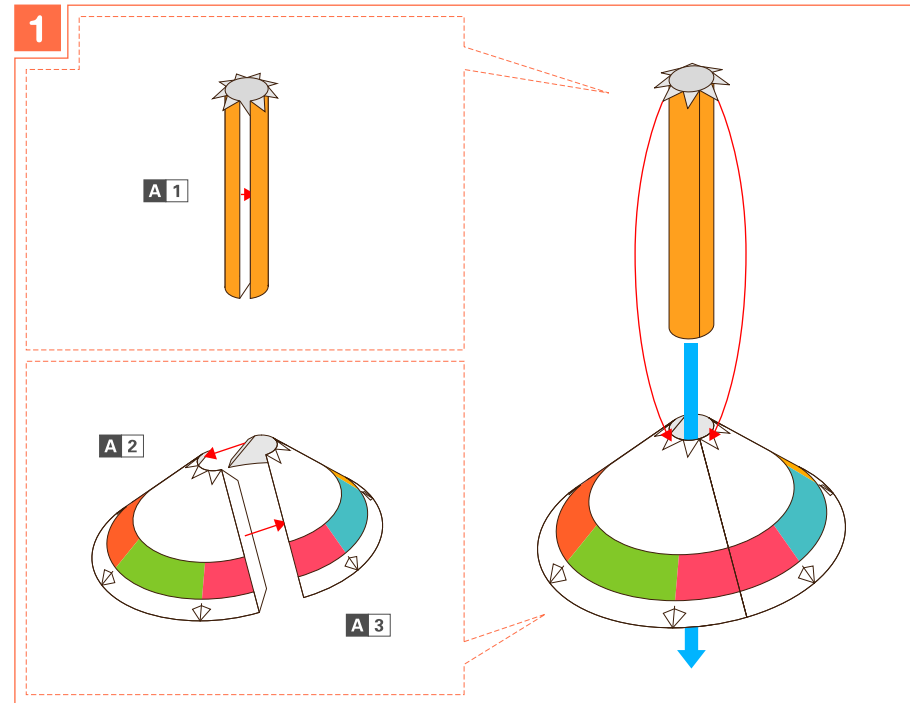

3

C 1 ~ C 6
Parts C1~C6 are assembled in the same way.

4

D 1 ~ D 6
Attach parts D1~D6 to each other, matching the color of the triangle marks on the glue tabs.

D 7

D 8

E 1

E 2

5

F 1

F 2

F 3

F 4

F 5

F 6

G 1

G 2

G 3

G 4

(Bottom)

Insert.

6

If you blow on the wings on the roof, or the pillars, in the direction of the arrows, the merry-go-round will spin!