

Canon Pop-up Card (Christmas-tree) : Assembly Instructions

Canon® is a registered trademark of Canon Inc. © HIROKO

PAPER CRAFT

<http://www.canon.com/c-park/en/>



1 Cut out the parts and crease them along the fold lines indicated.

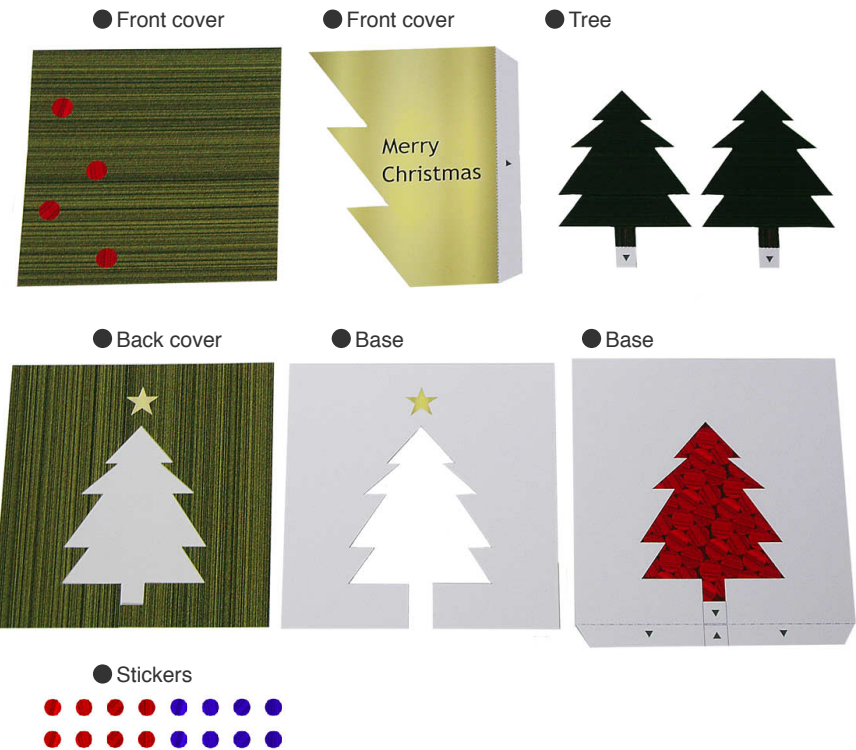

2 Stick the base cards together.

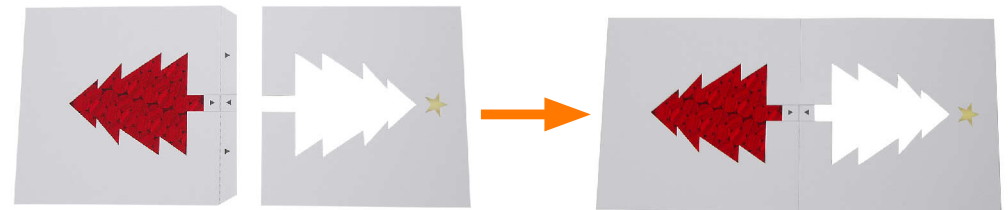

Assembly Instructions

..... **Mountain fold** (dotted line) ——— **Scissors line** (solid line)
*Make a mountain fold. *Cut along the line.

- - - - - **Valley fold** (dashed and dotted line) ——— **Cut in line** (solid line)
*Make a valley fold. *Make a cut.

▲ **Black triangle**
Glue here

△ **White triangle**
Glue the back



You will need scissors, paste, a used ballpoint pen (tracing along the fold lines makes them easier to fold)



Caution: Glue, scissors, and other tools may be dangerous to young children so be sure to keep them out of the reach of young children.

Canon Pop-up Card (Christmas-tree) : Assembly Instructions

Canon® is a registered trademark of Canon Inc. © HIROKO

3 Turn assembly 2 over and stick on the back cover.
*Stick on from the inside in order to match up properly with the tree-shaped cutaway.

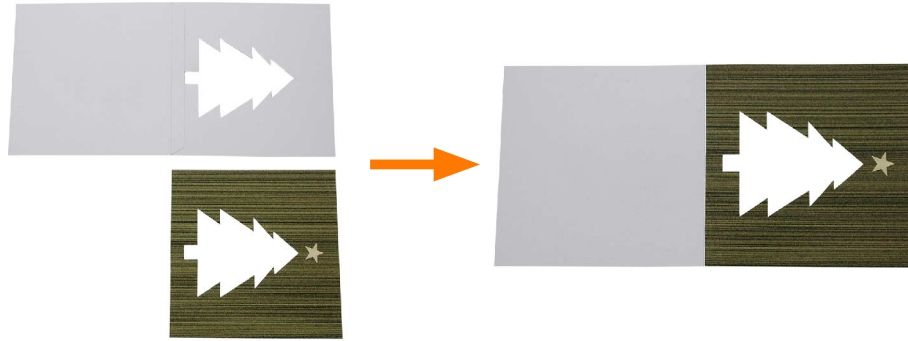

4 Line up the tree with the back sheet and add glue to the point circled in red only.

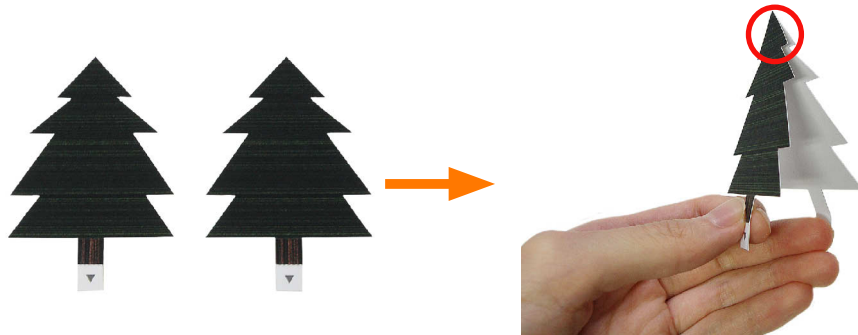

5 Use a paper punch to make holes in the tree assembly 4 at any spot you like.
If you don't have a paper punch, stick on the attached stickers.

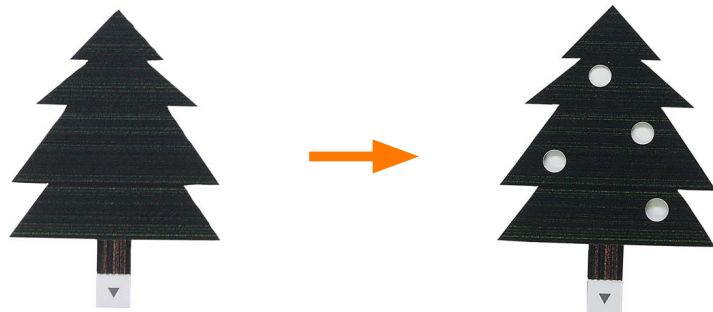

6 Turn assembly 3 over, match up the tree assembly 5 with the tree shape on the base card and add glue to the glue spot. Add glue to the other glue spot while folding.

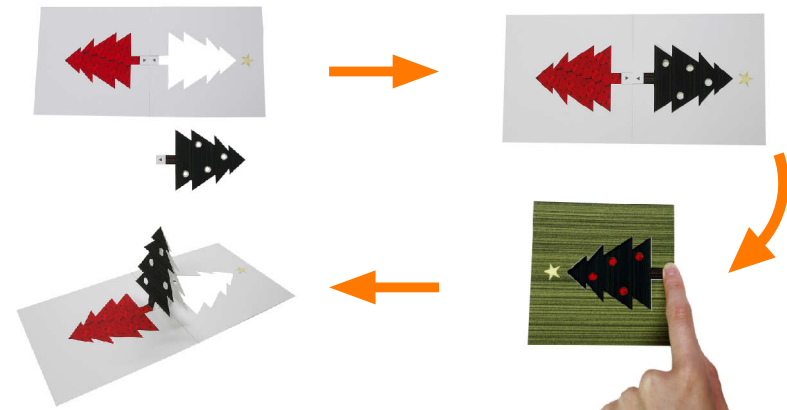

7 Line up the corners of the two cover sheets and glue the sheets together so that they are pinched between the glue spots.

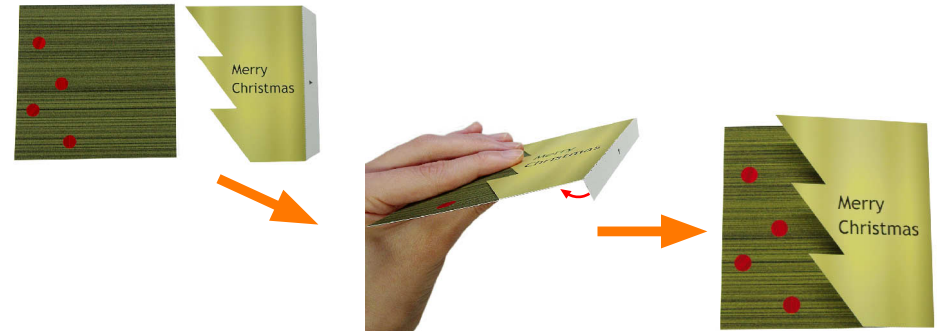

8 Glue assembly 7 to the back of the left hand side of assembly 6, and you're done!
* Be careful to stick on the assembly facing the right way!

