



An accordion is a musical instrument which is played by compressing or expanding a bellows in a horizontal direction. When the central bellows are compressed and expanded, air flows to the instrument's reeds. Music can be made by simultaneously pressing the keys on the right hand side. Some accordions have buttons rather than keys. The right hand part is mainly responsible for creating the melody. The left hand side has buttons called bass buttons, which are used to create bass sounds or chords. This paper craft model is based on a piano accordion, with a keyboard on the right hand side. It is constructed so that the bellows can be slightly compressed and expanded. Move it and play with it, or just use it as an ornament!

*This model was designed for Papercraft and may differ from the original in some respects.

■ Parts sheet (Pattern) : Fourteen A4 sheets

■ Assembly Instructions : Nine A4 sheets

■ No. of Parts : 60 parts

* Build the model by carefully reading the Assembly Instructions.

Handy Hint

- ☆ Write down the number on the back of each part as you cut them out.
- ☆ Since many of the parts are complicated and very small, do a trial assembly before actually attaching them together.
- ☆ The finished piece will look more realistic if you paint the edges of the parts with colors similar to the parts.

Assembly Instructions

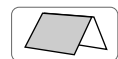

----- Mountain fold(dotted line)
● Make a mountain fold.

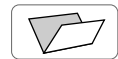

- - - - - Valley fold
(dashed and dotted line)
● Make a valley fold.



— Scissors line (solid line)
● Cut along the line.



— Cut in line (solid line)
● Cut a slot.

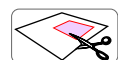

□ Cut out (Pink area)
● Cut out the area marked.



● Glue spot (Red dot)
Attach the parts with the same part numbers.

● Glue spot (Green dot)
Glue within the same part.

● Glue spot (Blue dot)
Glue to the rear of the other part.

Tools and materials



Scissors, set square, glue (We recommend stick glue), pencil, used ballpoint pen, toothpicks, tweezers (useful for handling small parts)

Assembly tip



Before gluing, crease the paper along mountain fold and valley fold lines and make sure rounded sections are nice and stiff.

Caution



Glue, scissors and other tools may be dangerous to young children so be sure to keep them out of the reach of young children.

1 Assemble 2A and 3A, and glue them together.

*Curve the parts marked with blue dotted circles before attaching. Be careful that the paper is not crooked when you attach it.

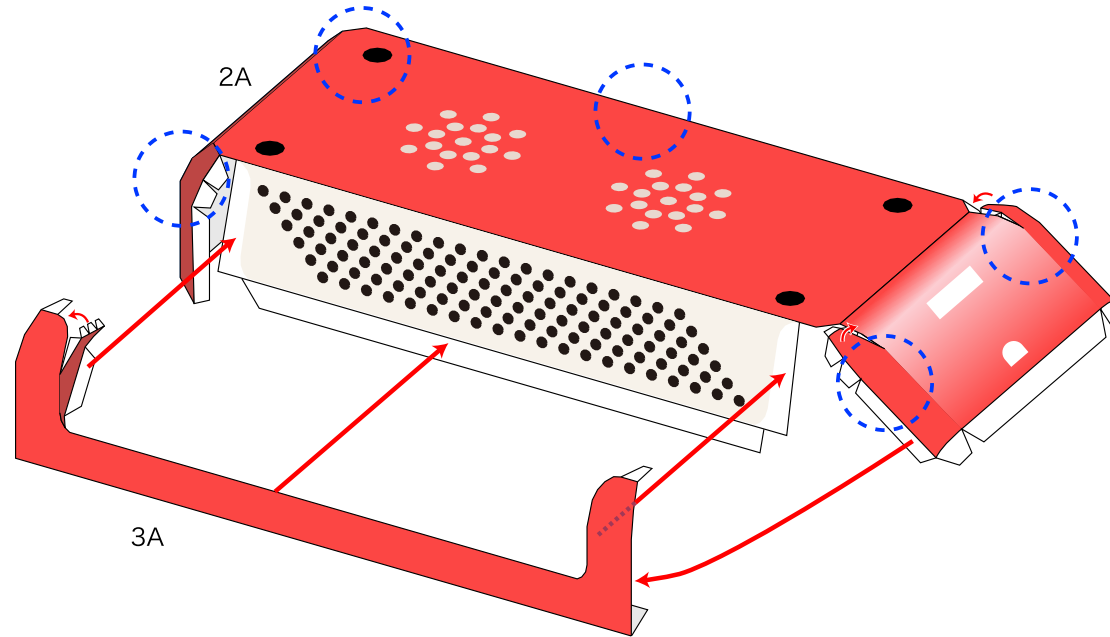

2 Assemble 3B.

Make mountain and valley folds in turn on the entire piece.

Fold the opposite way each end of the mountain folds.

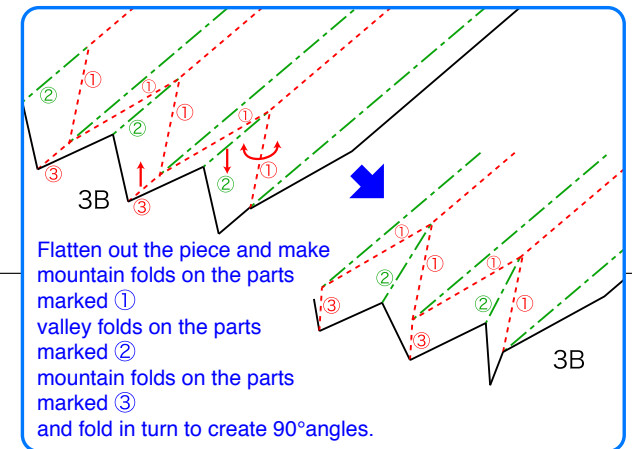
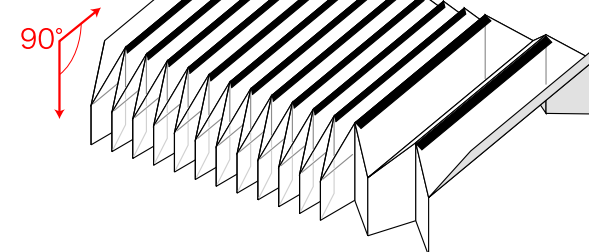
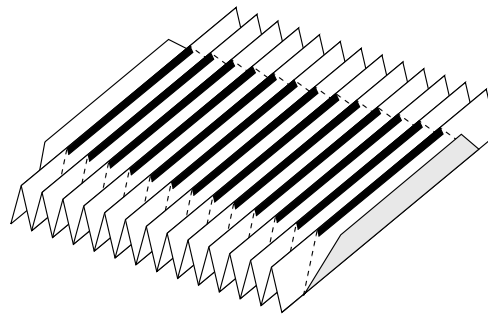
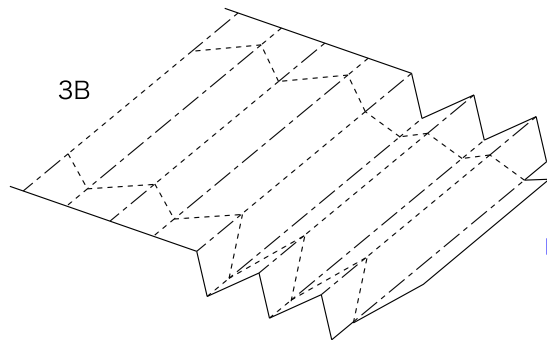

3 Assemble 4A and 5A in the same way as 3B (fold up one edge only), and attach them to 3B.

*When gluing, make sure that the pieces are fitted together right to the bottom, so that the corners are 90° when attached.

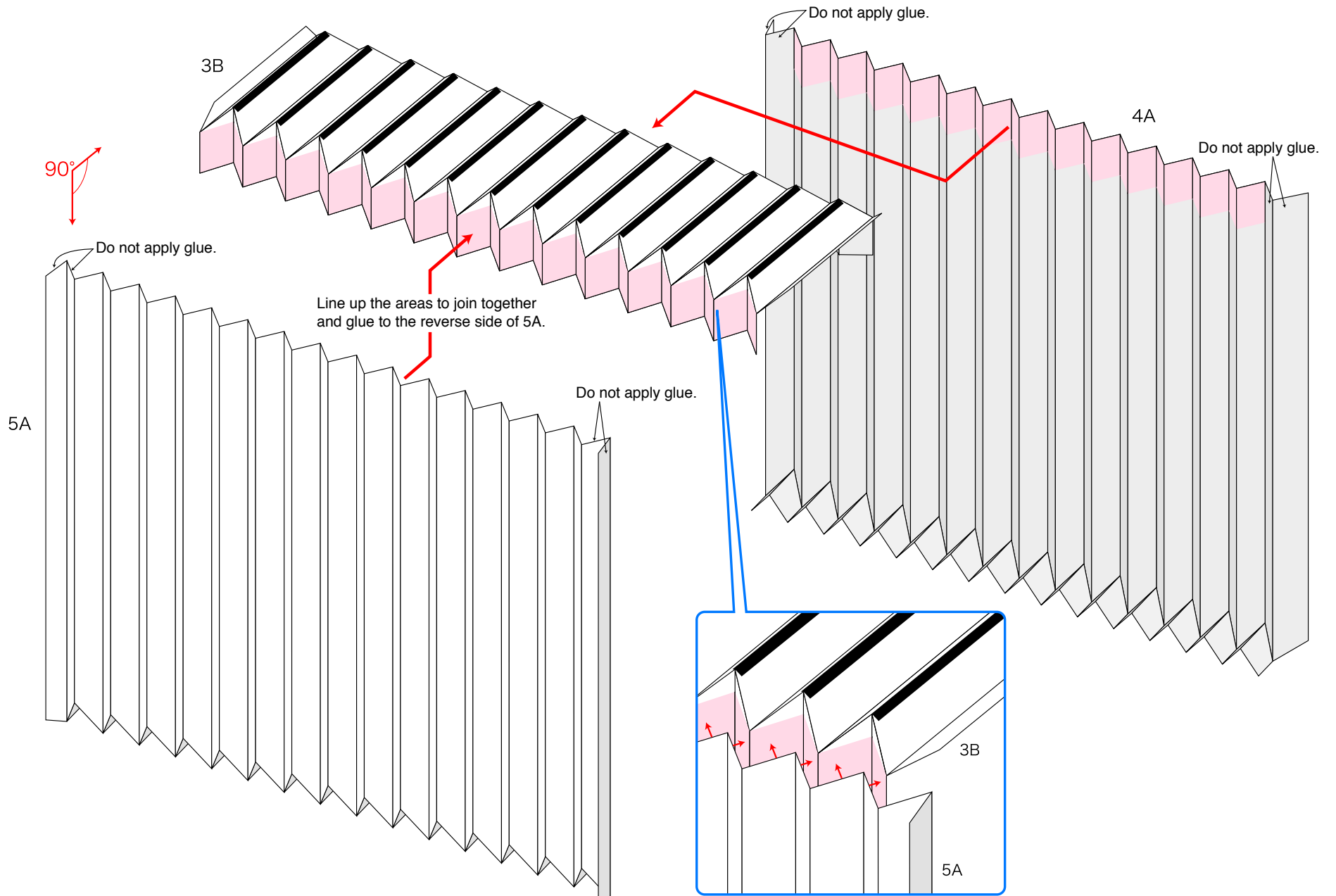

4 Assemble 6B, and attach it to 4A and 5A.

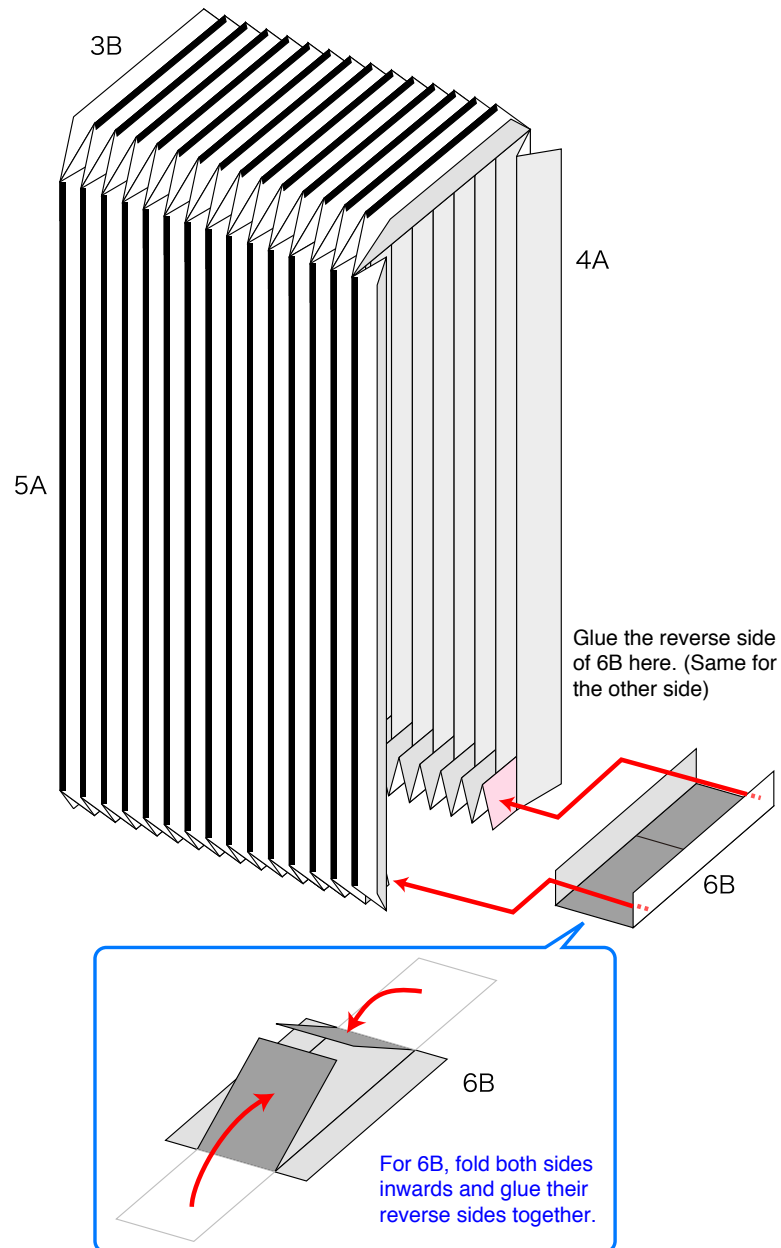

5 Assemble the 7A reinforcing parts and glue them, equally spaced, to the reverse side of 2A. Next, attach the assembled bellows to 2A.

*When attaching the bellows to 2A, start by gluing the 6B glue tabs (marked ③), being careful that the rest is not crooked.

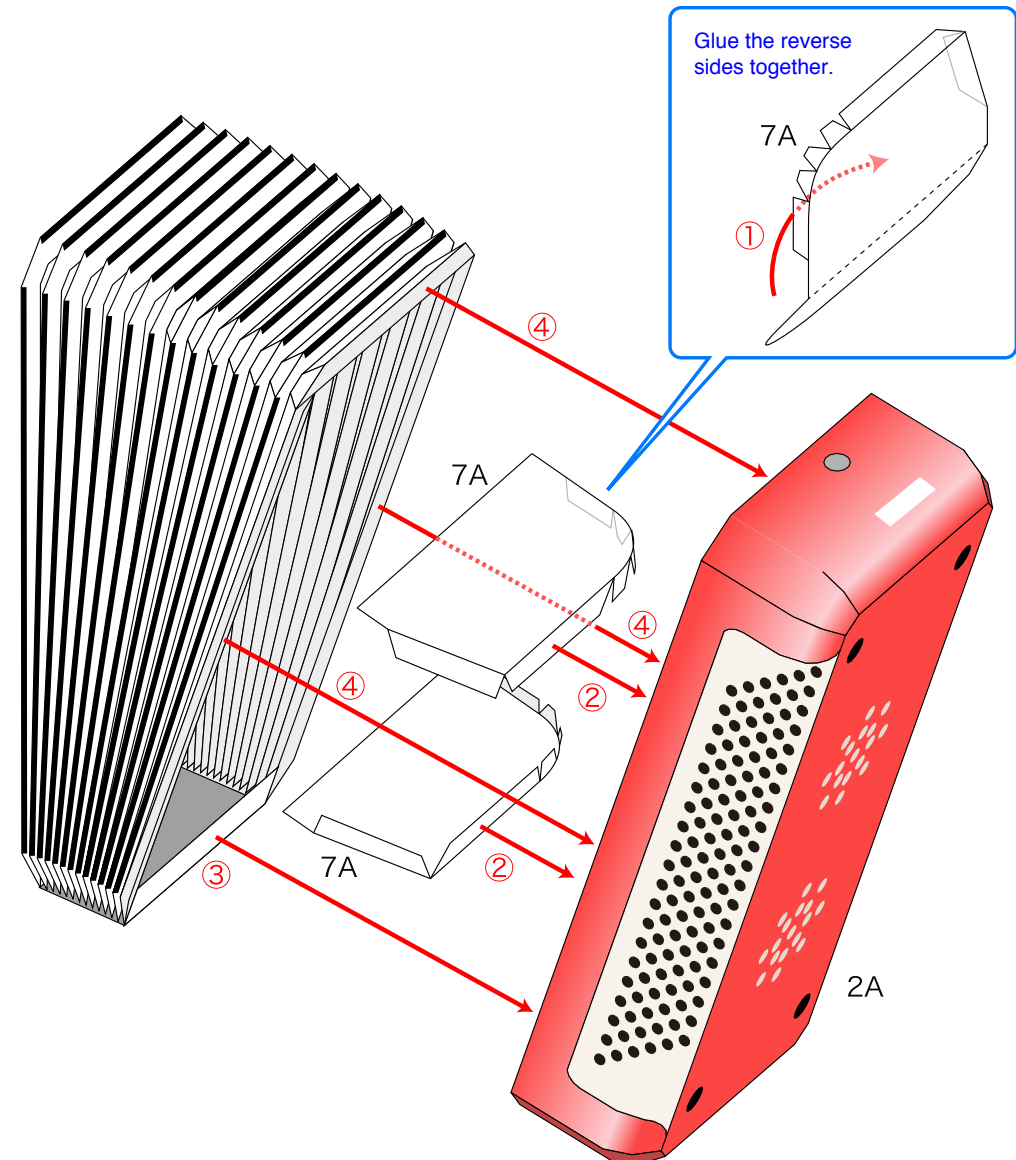

- 6** Curve the parts marked with blue dotted circles. Next, glue together in order starting from ①.

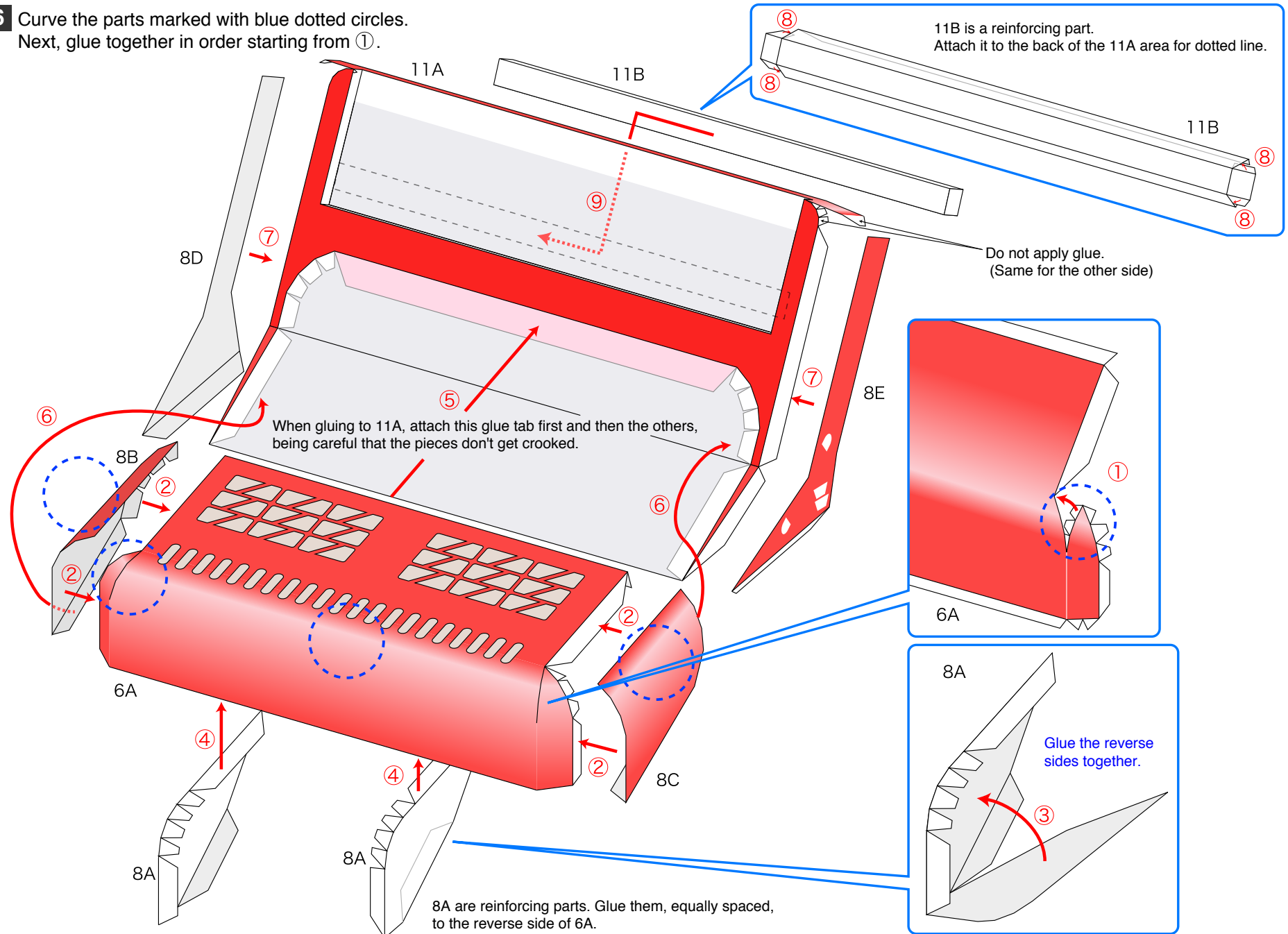

7 Glue 10C to the assembled 10B, glue all of the 9B parts (the black keys) and then attach the parts to 11A.

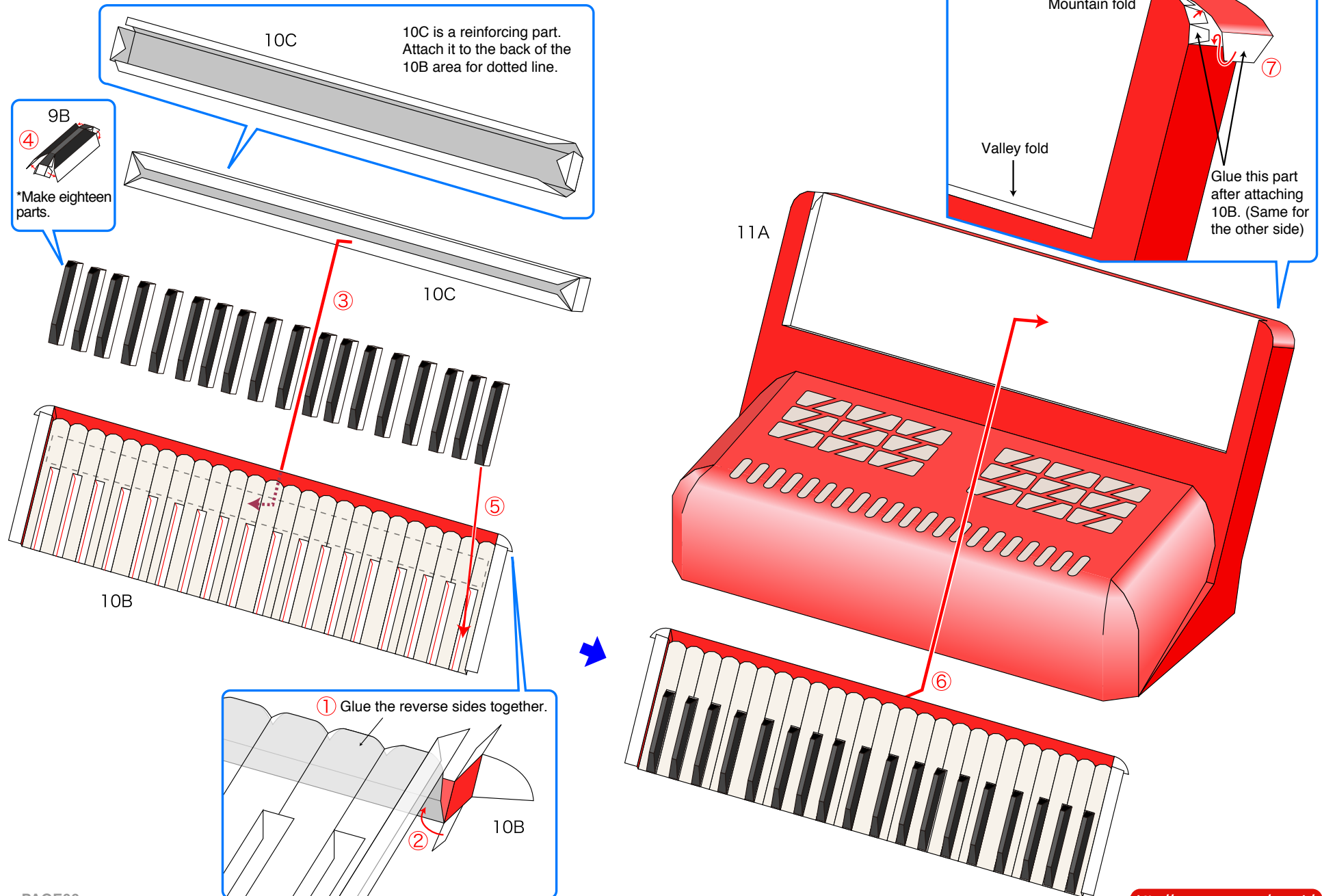

8 Glue the assembled 9A to 10A, and attach it to the parts you assembled on page 6.

*Gluing in turn starting from ① will result in a neater finish.

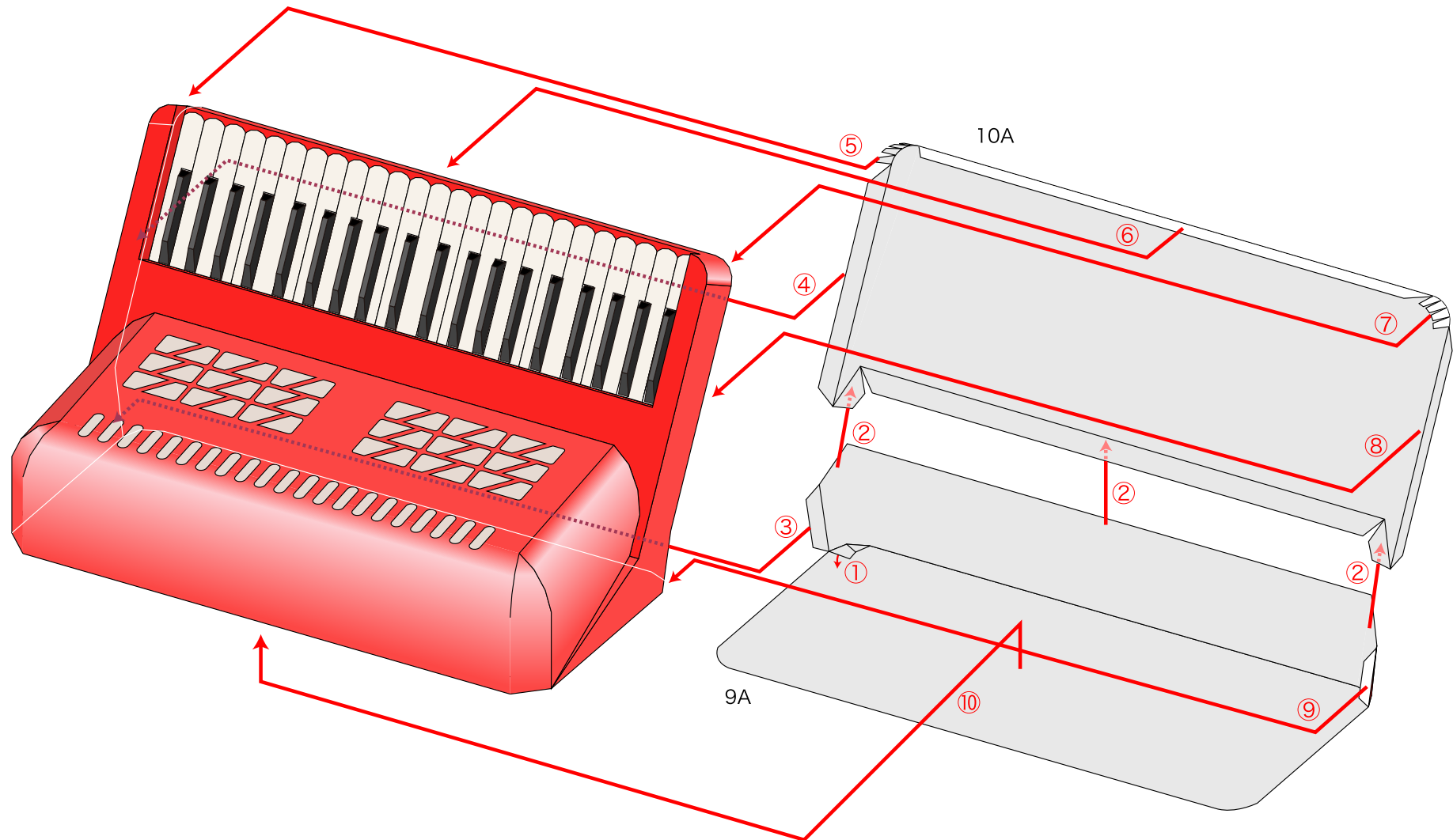

- 9** Attach the parts you assembled on page 4 to the parts you assembled on page 7.
Next, glue the remaining parts.

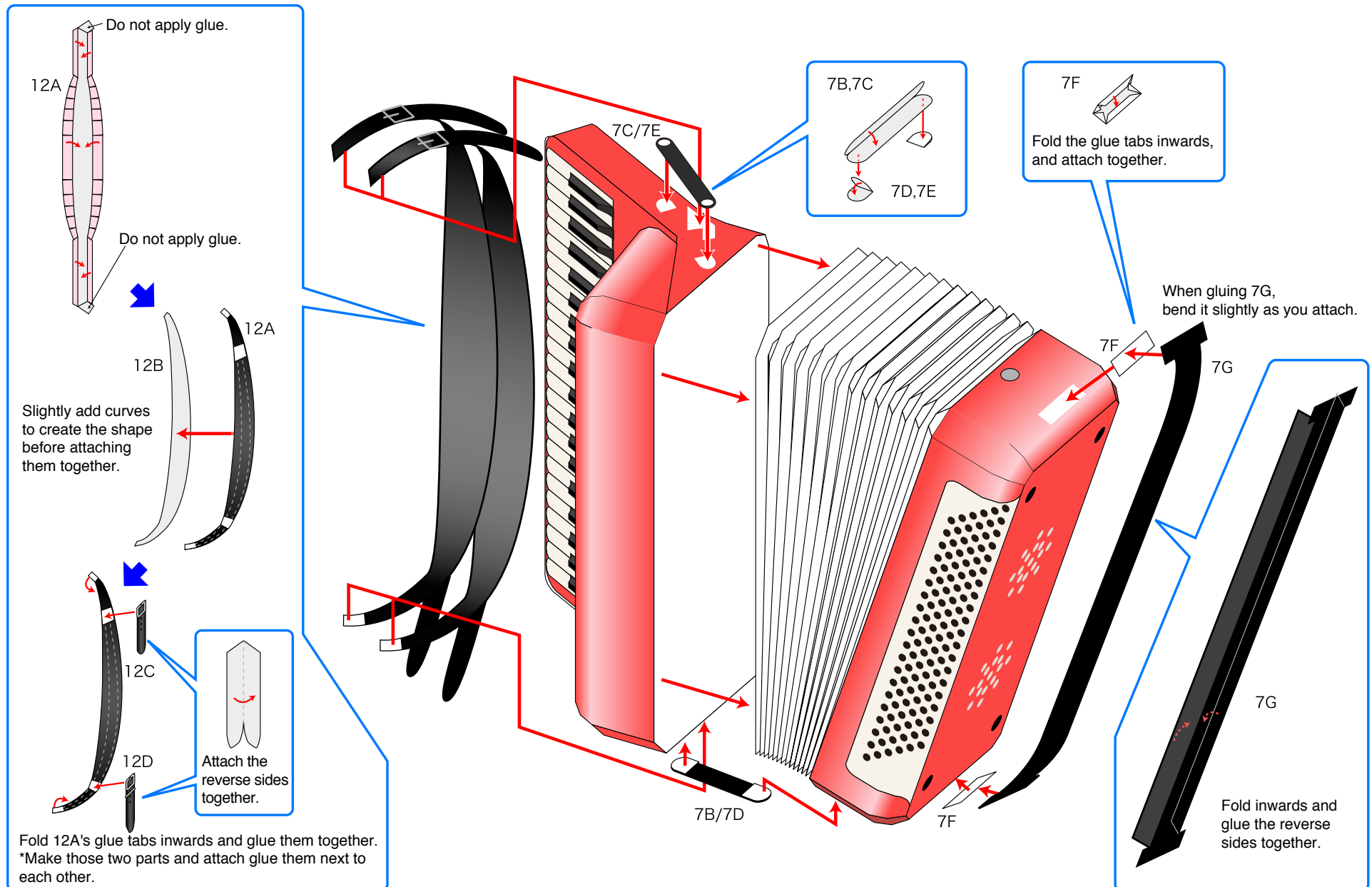

10 Make the stand and complete your accordion.

