

***Motor Sports World***

# **Rally**

**Assembly  
Instructions**

## **B BLOCK YZ450F**

Please follow these assembly instructions, cross-checking the part numbers on the parts sheet.



We recommend to print out the parts data on A4 inkjet printer paper for paper-craft, sturdy paper or card.

This file provides assembly instructions. Please download the parts data separately.

## 1 To begin

### ■ Tools and materials needed

-Ruler - scissors - blade cutter or "Exacto-knife" - awl or other pointed tool - Embosspen - Transer (for making a folding crease) - Felt pen - Pin set - Glue - Hand towel (for cleaning your fingers) - dictionary or other heavy book (to press the papers flat).

### ■ Items of Caution

\*Take care when using sharp or pointed objects or when using bladed cutting tools. Place a heavy sheet of paper under the paper you want to cut.

\*Use glue and other adhesives only in well-ventilated areas.

\*When printing, use a slightly reduced font size. There may be differences in dimensions, depending on the type of printer used.

## 2 How to assemble

\*Follow the working method and markings carefully.

\*Cut carefully along the outer line with cutting blade, Exacto-knife or scissors.

### One-point Advise

\*Cut carefully with cutting blade, Exacto-knife or scissors.

\*For folding parts, first use an awl or other pointed tool to make a light crease along the dotted or solid line. This will make the folds straight. Avoid making strong creases, as this will cause the paper to tear.

\*As an adhesive, white wood glue is recommended. Avoid over application as this may cause the paper to wrinkle.

\*Before beginning assembly, test adhesive amounts on extra paper.

\*Occasionally, white spots will be apparent on folds and cuts. Use a marker or pencil to fill in these spots. It is recommended that this be done after each stage of assembly because coloring becomes more difficult once parts are assembled.

## Basic working method and markings

### ———— Solid lines

Fold along these lines.

The printed surface should be on the outside of the folded shape.

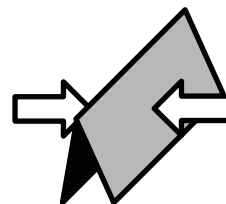

### ----- Broken lines

Fold along these lines.

The printed surface should be on the inside of the folded shape.

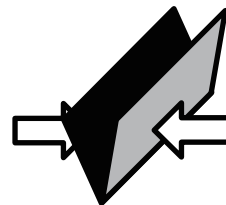

### ----- Dotted lines

Cut along these lines.

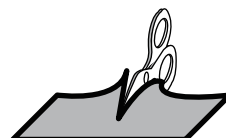

Do not fold or cut the parts marked X.



Cut out parts marked with an asterisk(\*).

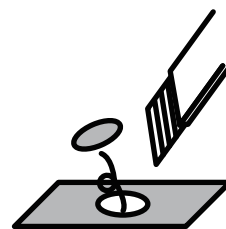

Red circles are the reference positions for gluing surfaces.

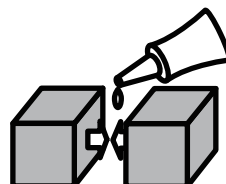

Please refer to the "Basic working method and markings" symbol chart on Page 2 to assemble each part.

--->  
Fold or Curve

→  
Glue

↔  
Insert

●  
Gluing surfaces

## Front cowl A

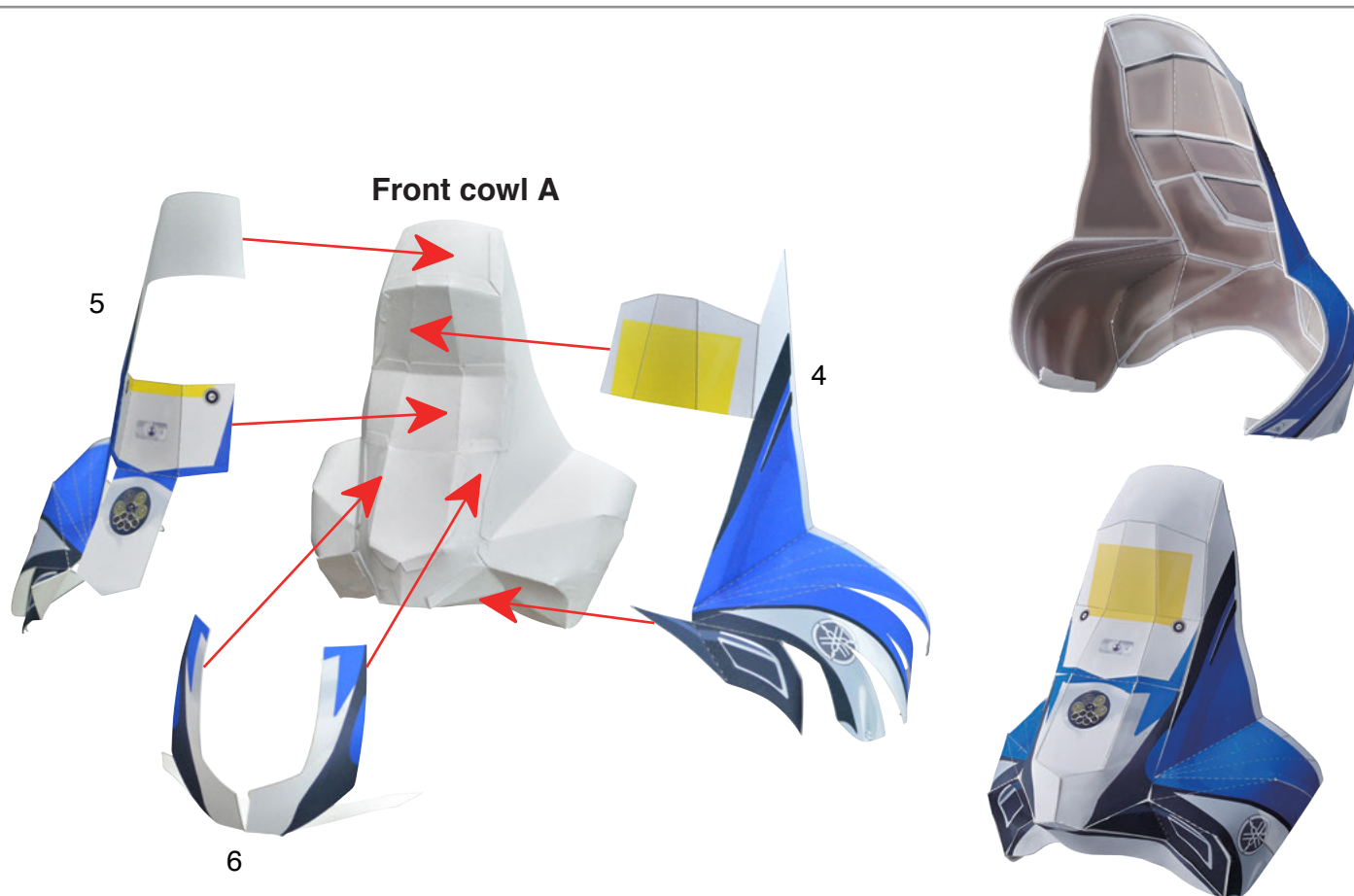
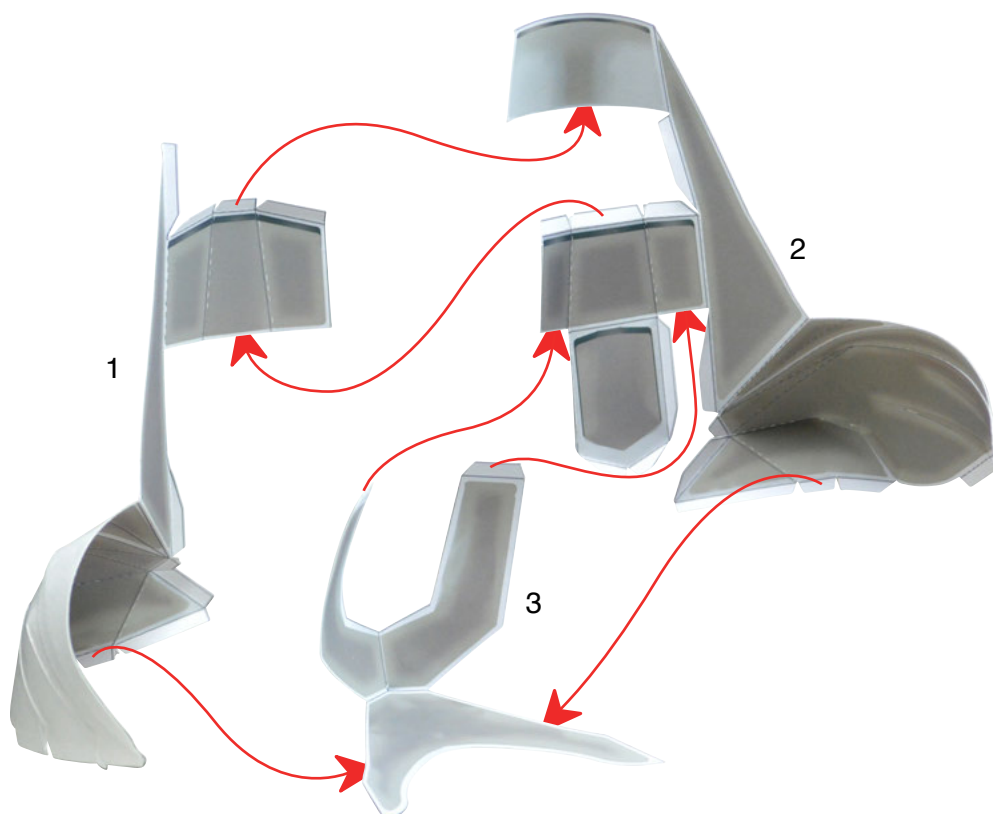

Please refer to the "Basic working method and markings" symbol chart on Page 2 to assemble each part.

 Fold or Curve

 Glue

 Insert

 Gluing surfaces

## Side cowl

Assemble both sides. The diagram show the left side.  
The numbers inside the ( ) are for the right side.



## Steering A

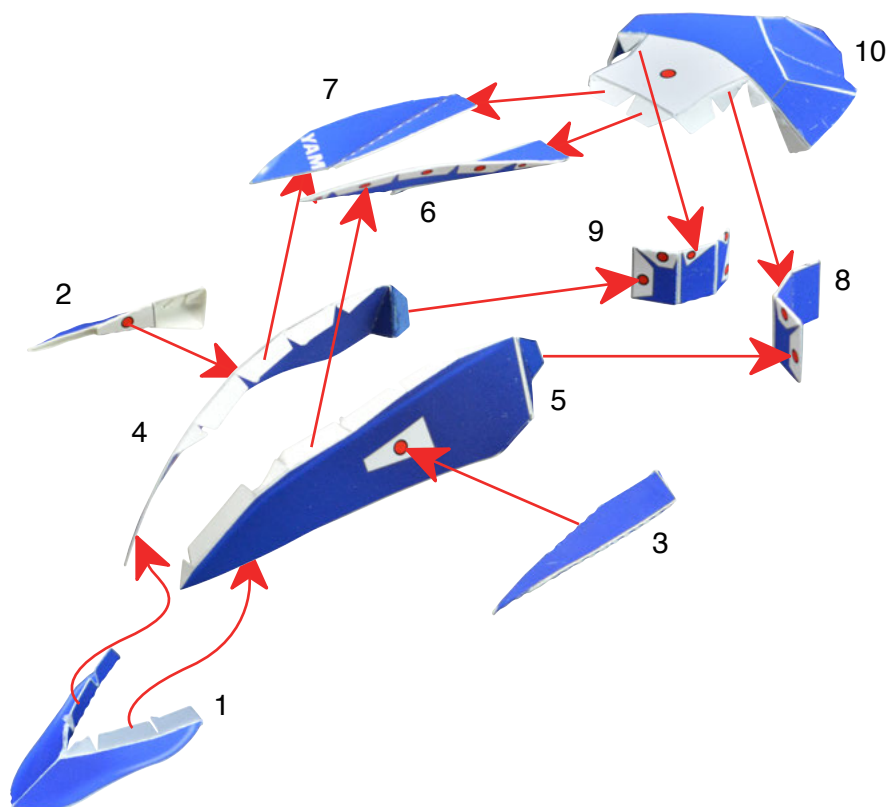



Please refer to the "Basic working method and markings" symbol chart on Page 2 to assemble each part.

--->  
Fold or Curve

→  
Glue

↔  
Insert

●  
Gluing surfaces

### Steering B

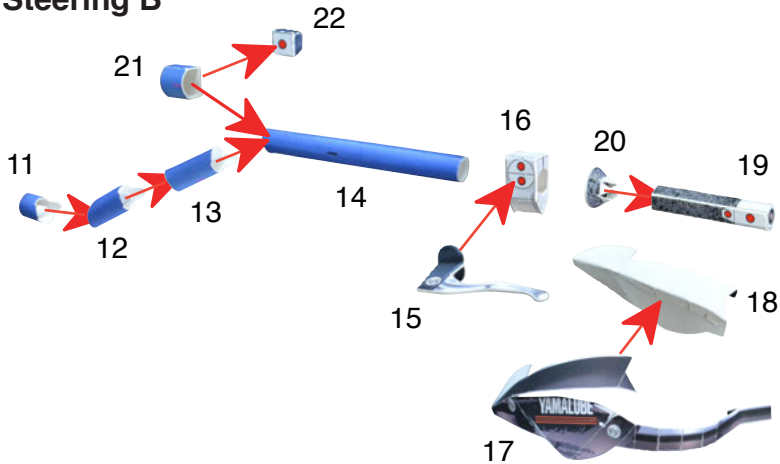

### Steering D

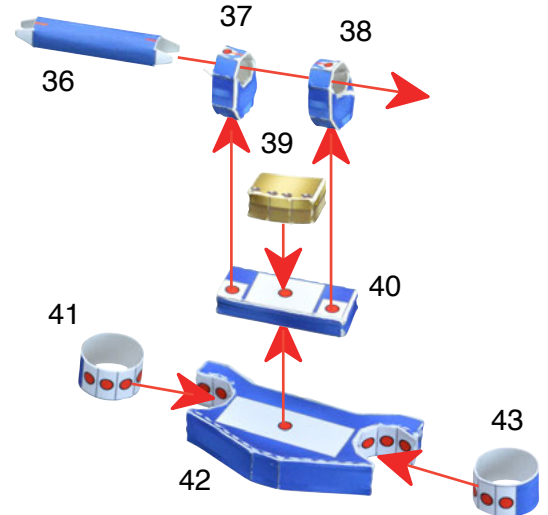

### Steering C

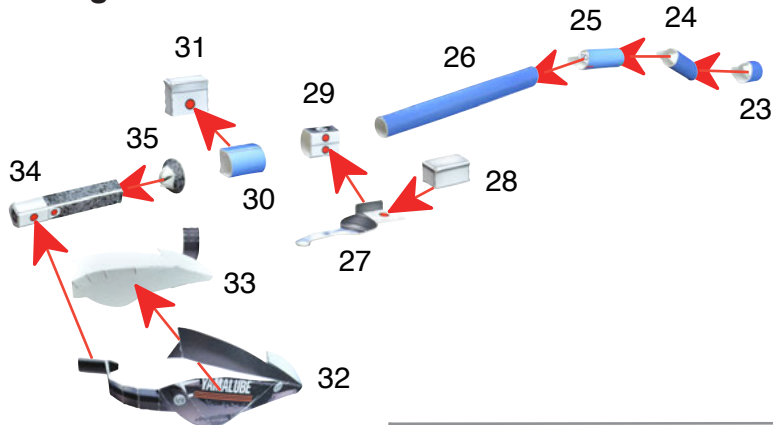

### Steering H, I

Assemble both sides.  
The diagram show the left side.  
The numbers inside the ( ) are for the right side.

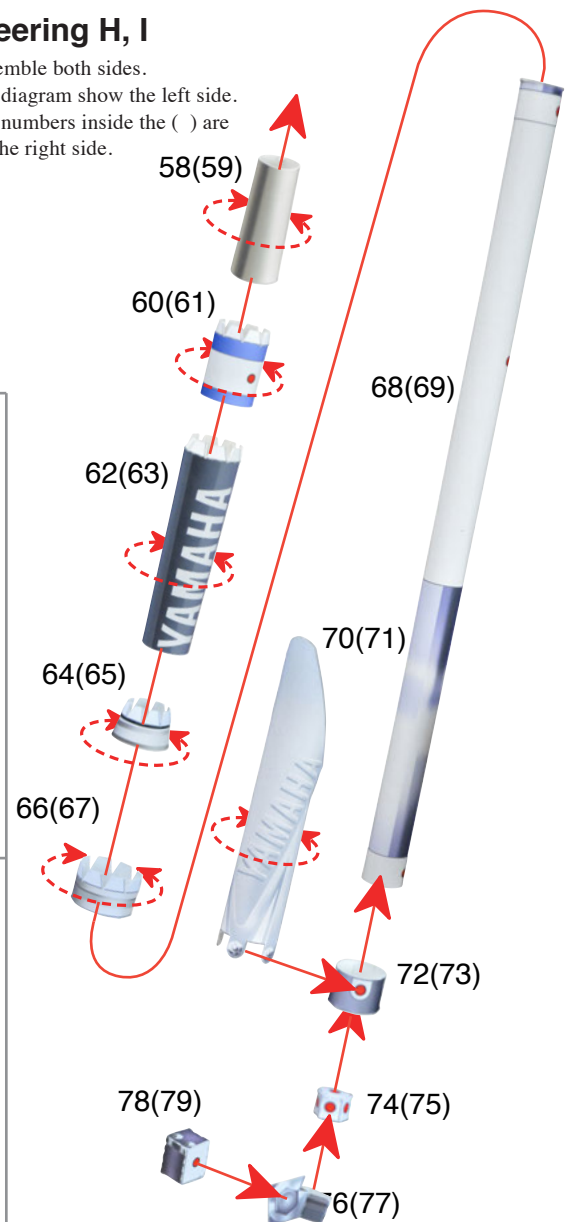

### Steering E

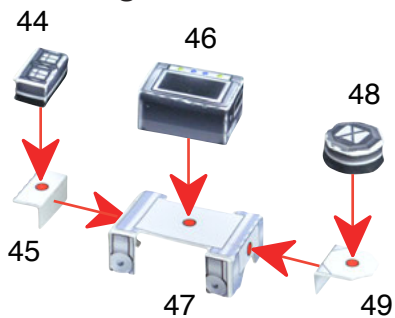

### Steering F

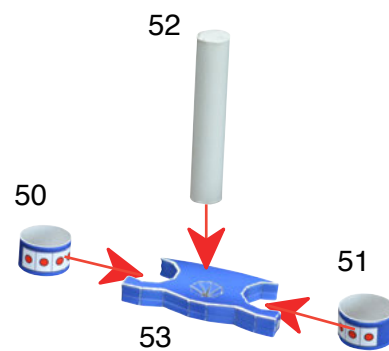

### Steering G

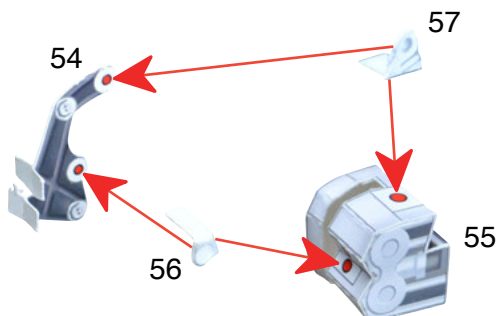

Please refer to the “Basic working method and markings” symbol chart on Page 2 to assemble each part.

--->  
Fold or Curve

→  
Glue

↔  
Insert

●  
Gluing surfaces

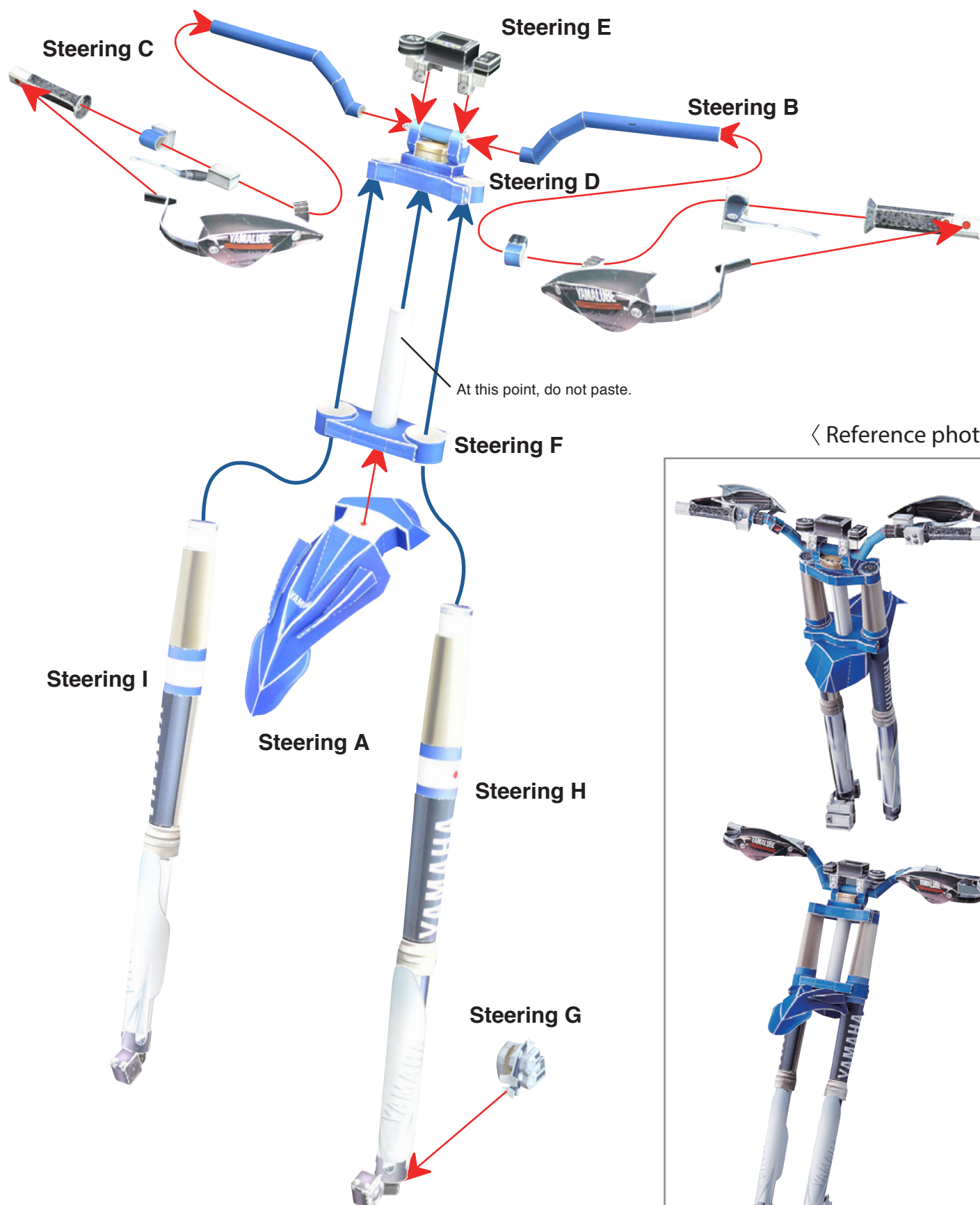

Please refer to the "Basic working method and markings" symbol chart on Page 2 to assemble each part.

--->  
Fold or Curve

→  
Glue

↔  
Insert

●  
Gluing surfaces

## Map

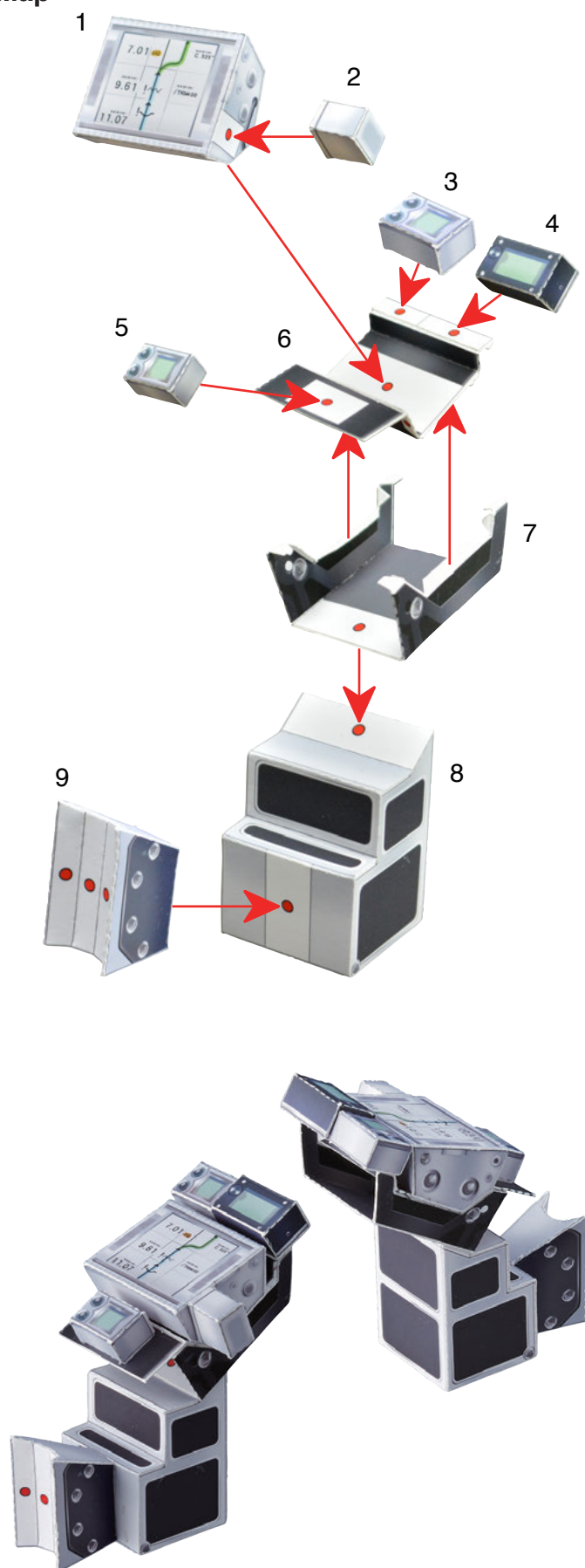

## Tank1, 2

Assemble both sides. The diagram show the right side.  
The numbers inside the ( ) are for the left side.

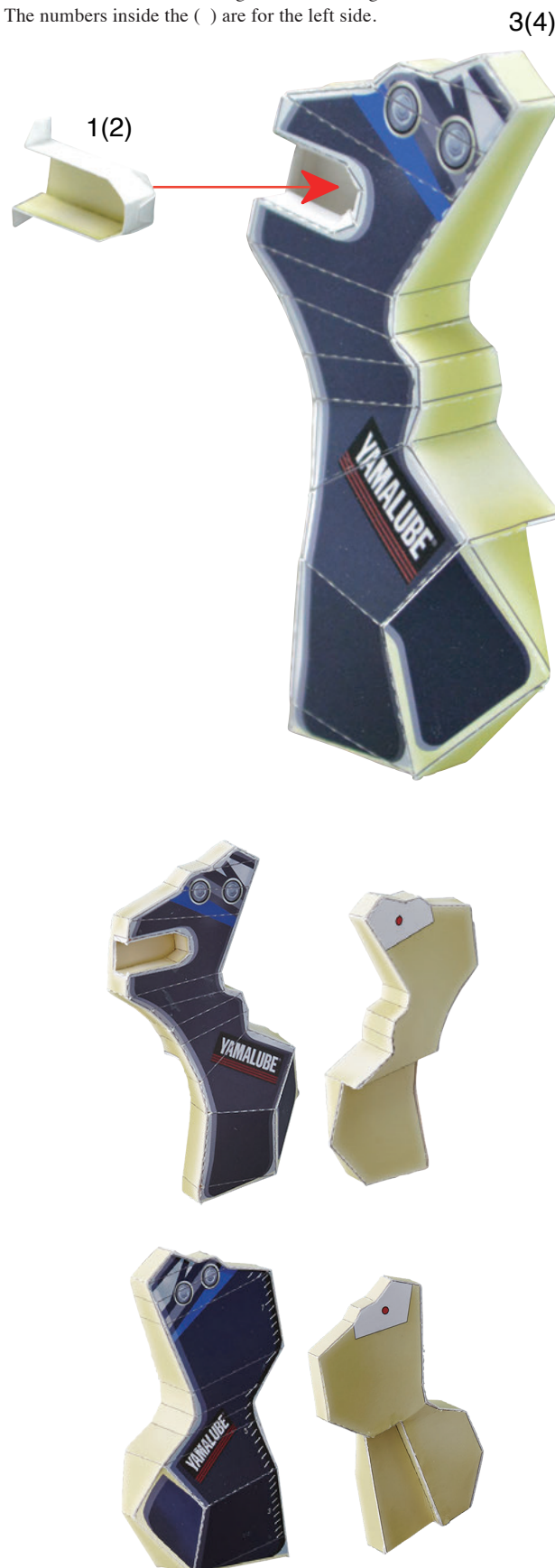

Please refer to the "Basic working method and markings" symbol chart on Page 2 to assemble each part.

--->  
Fold or Curve

→  
Glue

↔  
Insert

●  
Gluing surfaces

### Radiator A

Assemble both sides. The diagram show the right side. The numbers inside the ( ) are for the left side.

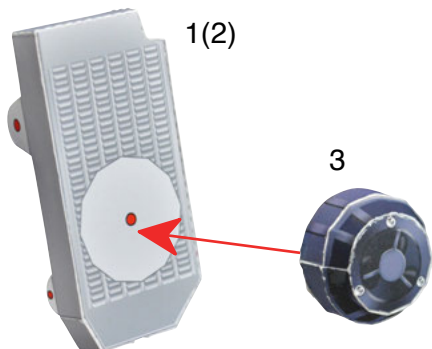

### Radiator B

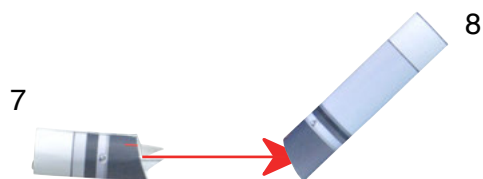

### Radiator C

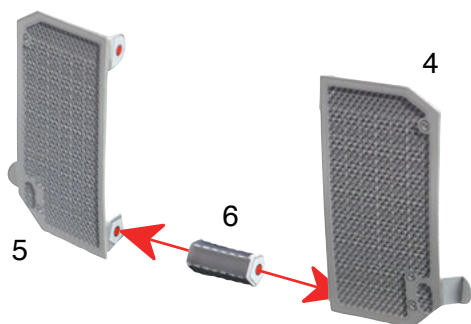

### Under cowl

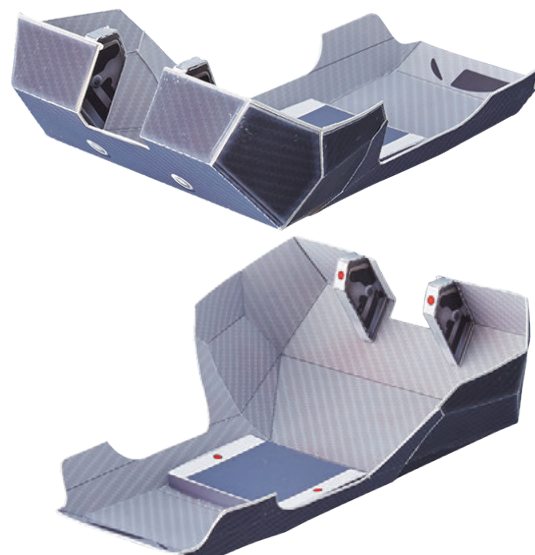
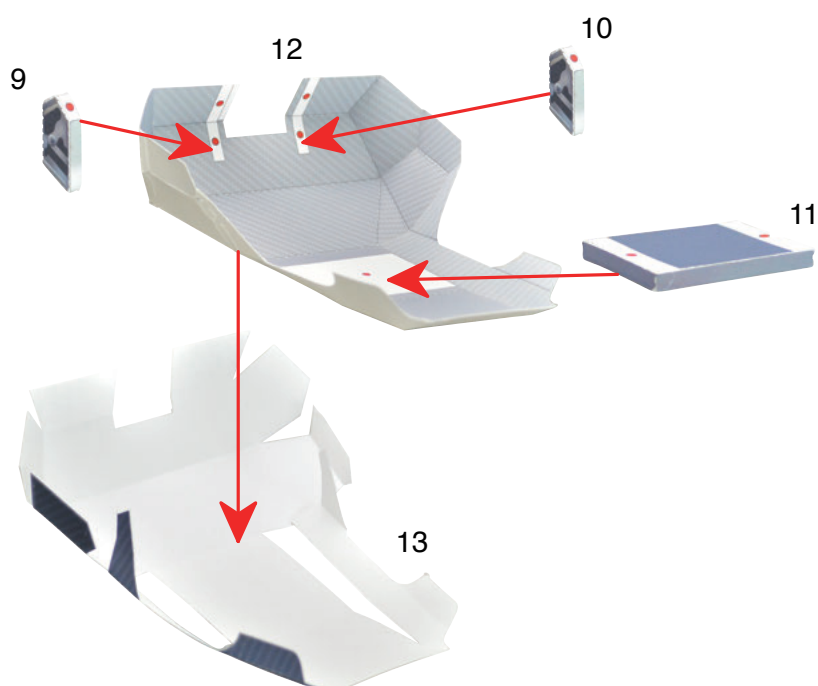



Please refer to the "Basic working method and markings" symbol chart on Page 2 to assemble each part.

--->  
Fold or Curve

→  
Glue

↔  
Insert

●  
Gluing surfaces

### Tank C

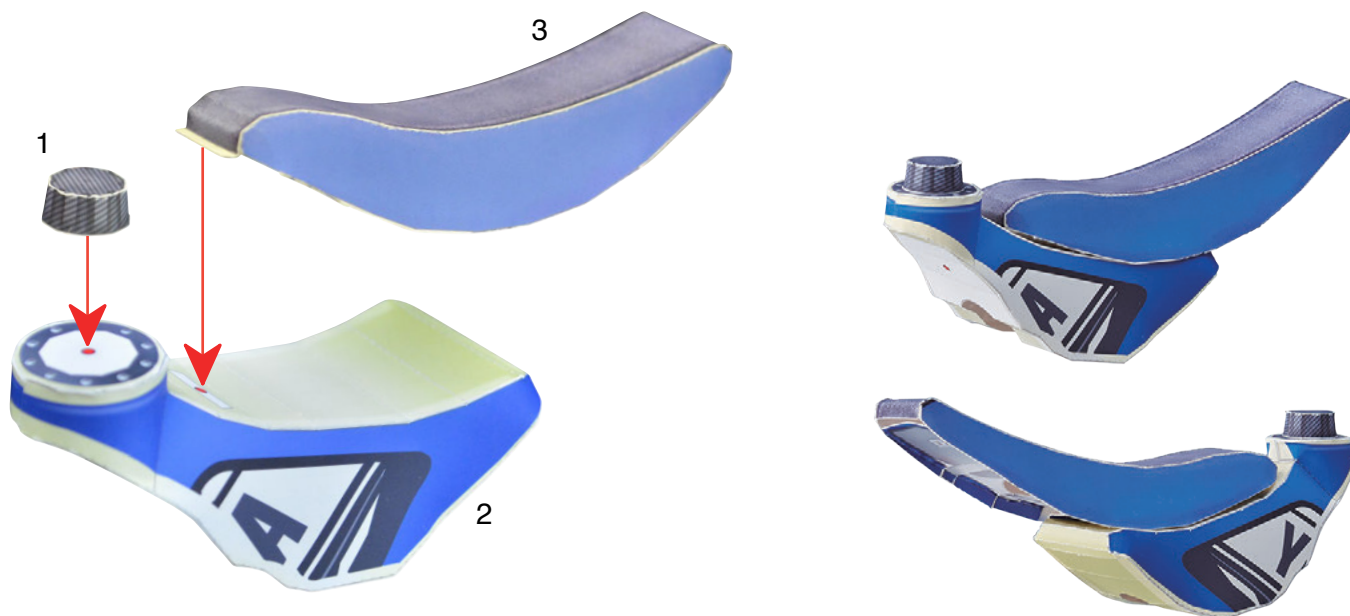

### Suspension A



### Suspension B

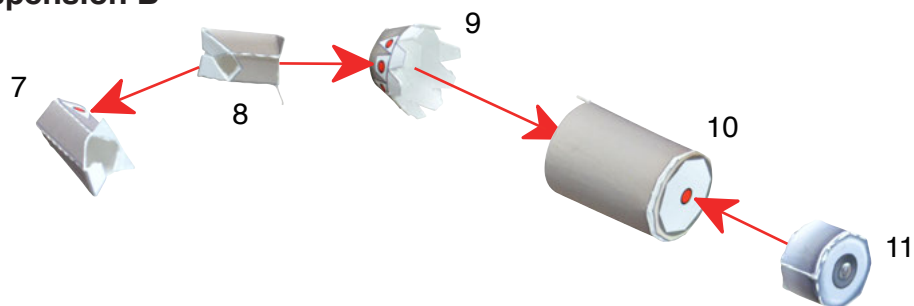

### Suspension B

#### Suspension A



Please refer to the "Basic working method and markings" symbol chart on Page 2 to assemble each part.

--->  
Fold or Curve

→  
Glue

↔  
Insert

●  
Gluing surfaces

## Engine A

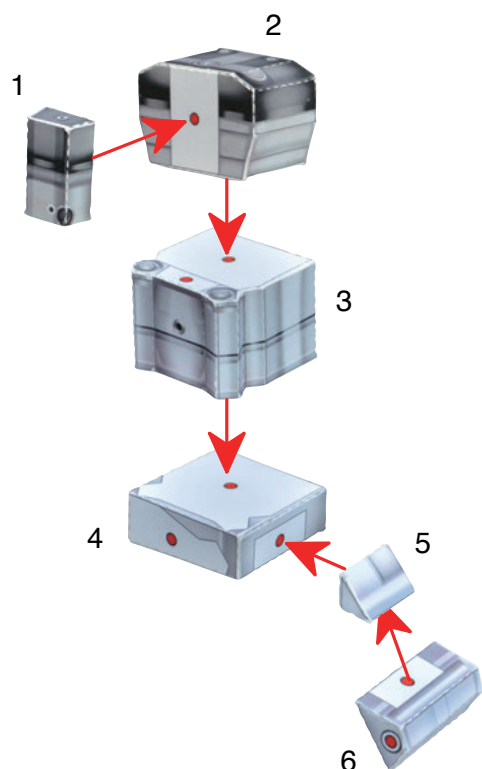

## Engine B

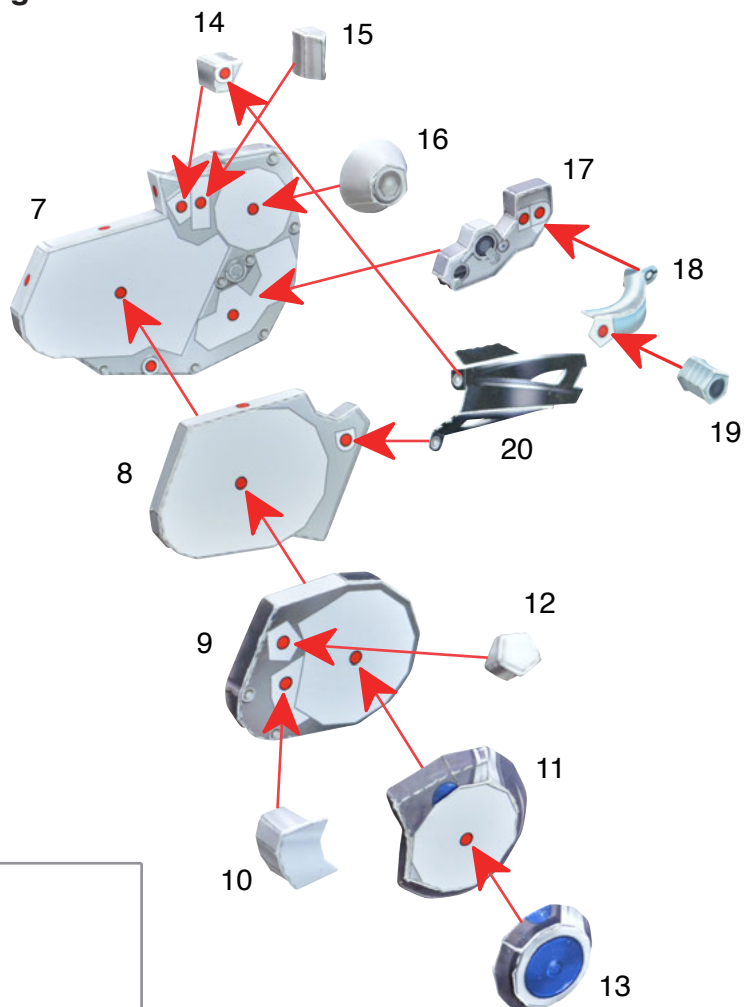

## Engine C

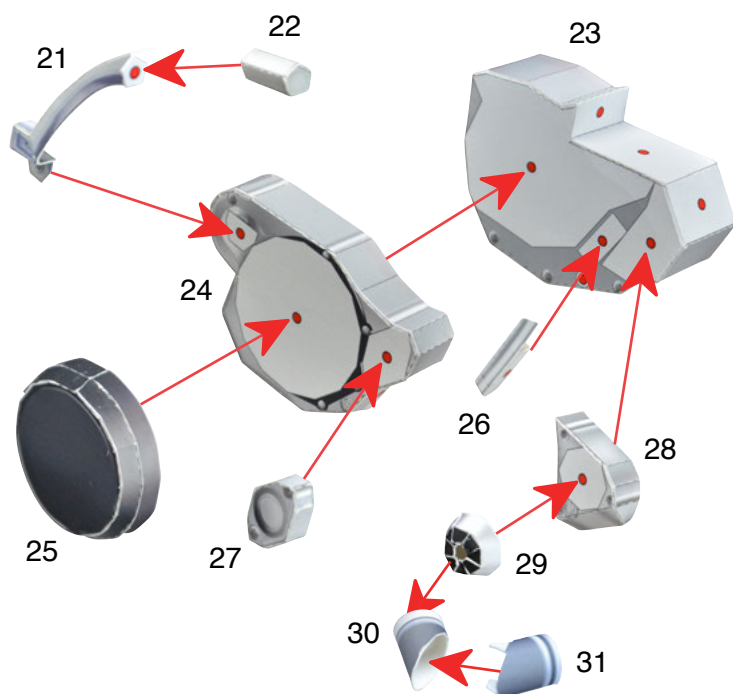

## Engine D

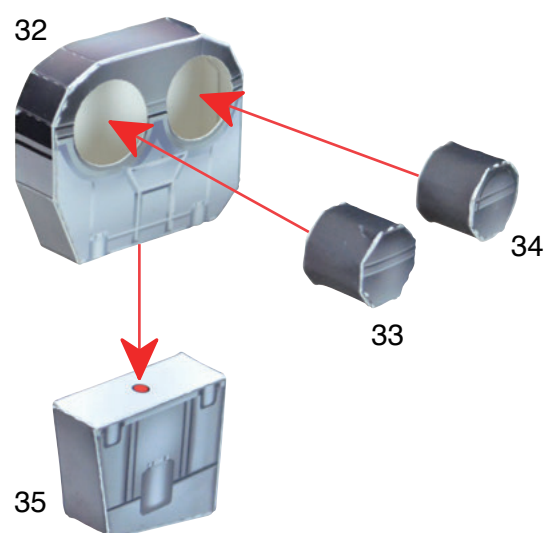

Please refer to the “Basic working method and markings” symbol chart on Page 2 to assemble each part.

 Fold or Curve

 Glue

 Insert

 Gluing surfaces

Engine A



Engine D



Engine C



Engine B

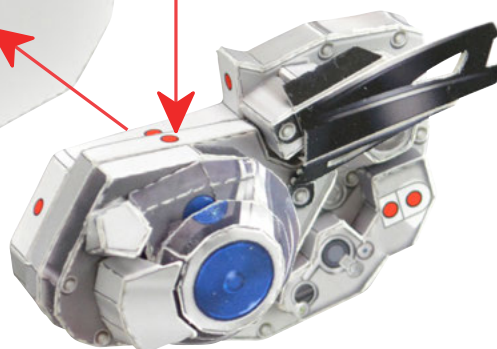

〈 Reference photo 〉

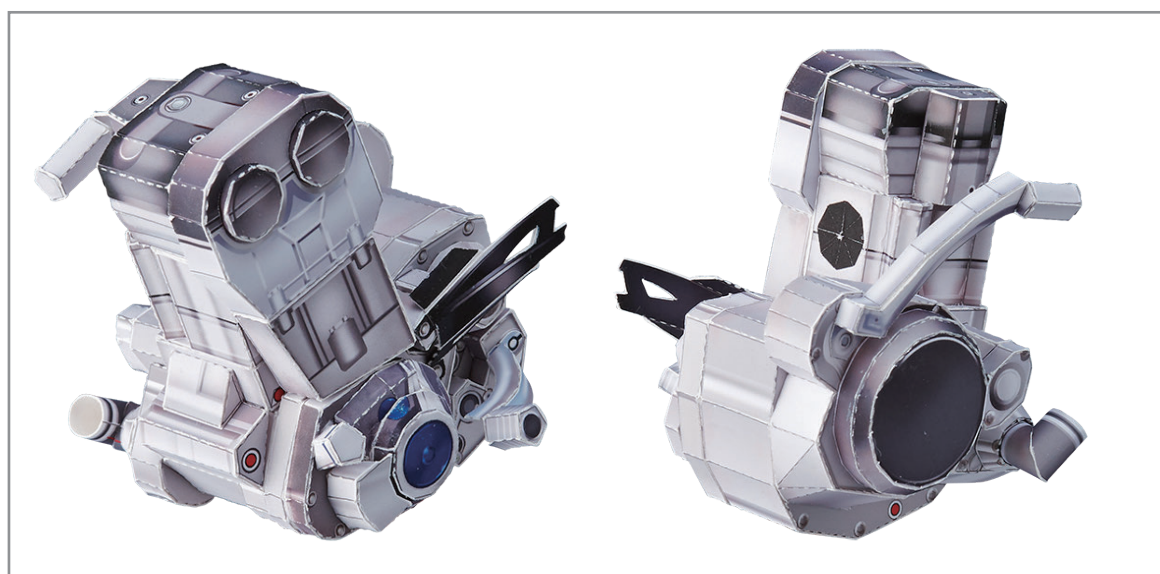

Please refer to the "Basic working method and markings" symbol chart on Page 2 to assemble each part.

--->  
Fold or Curve

→  
Glue

↔  
Insert

●  
Gluing surfaces

### Frame A

Assemble both sides. The diagram show the left side.  
The numbers inside the ( ) are for the right side.

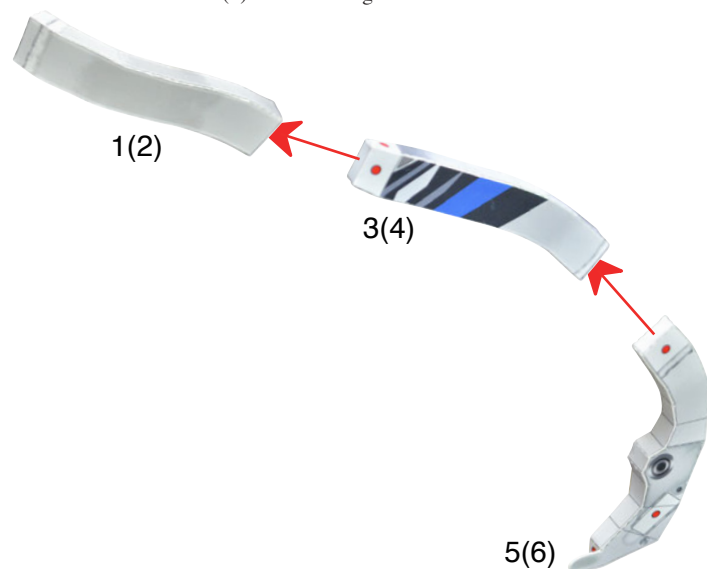

### Frame B

Assemble both sides. The diagram show the left side.  
The numbers inside the ( ) are for the right side.

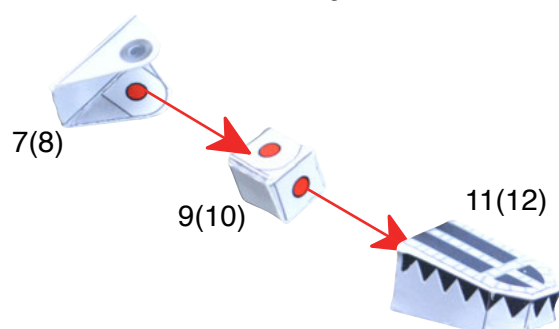

### Frame C

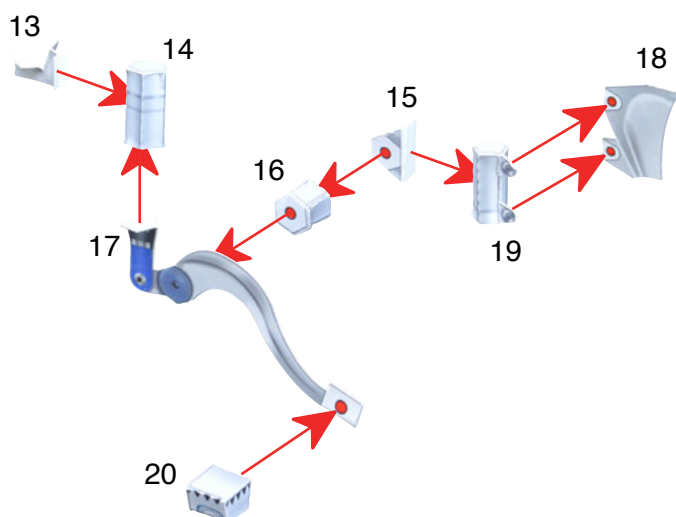

### Frame D

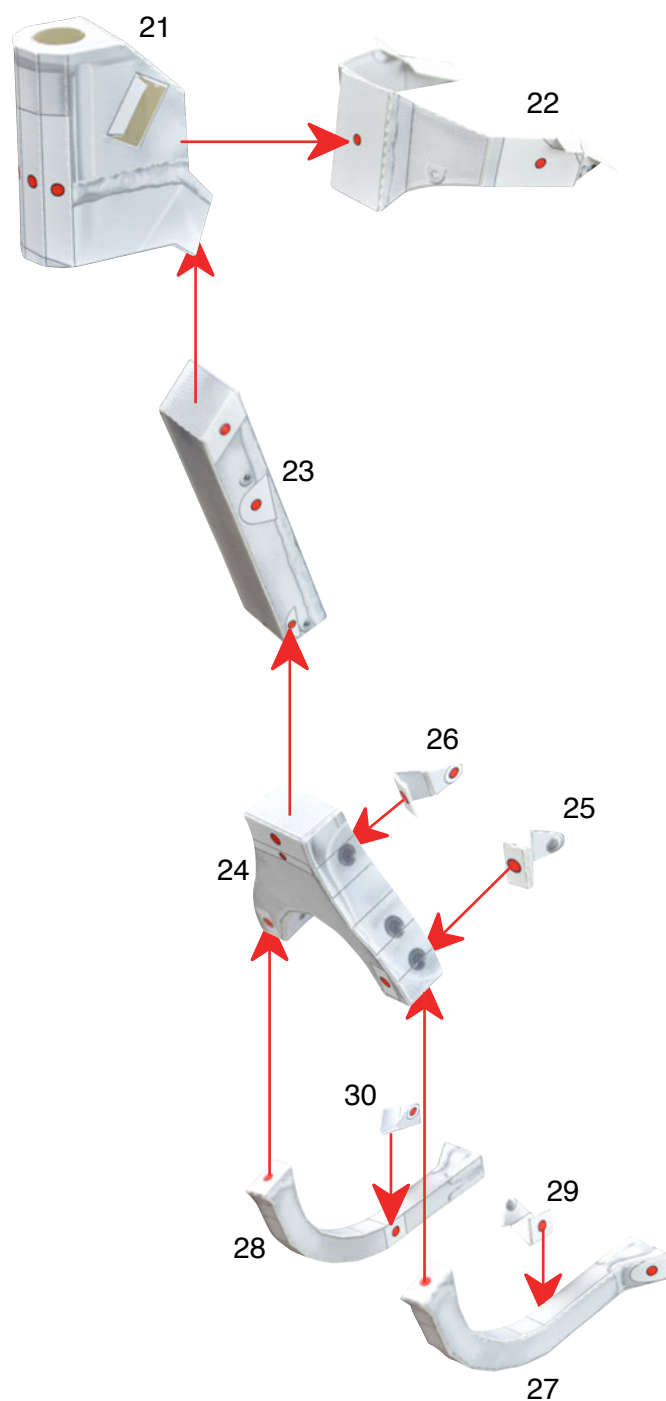



Please refer to the “Basic working method and markings” symbol chart on Page 2 to assemble each part.

 Fold or Curve

 Glue

 Insert

 Gluing surfaces

## Frame E

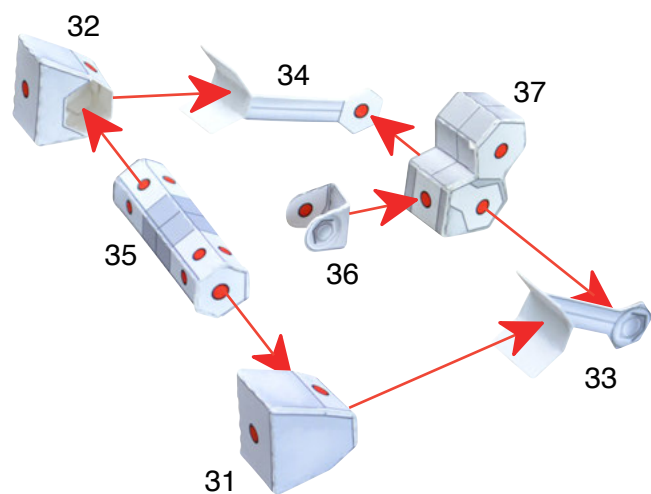

## Frame F

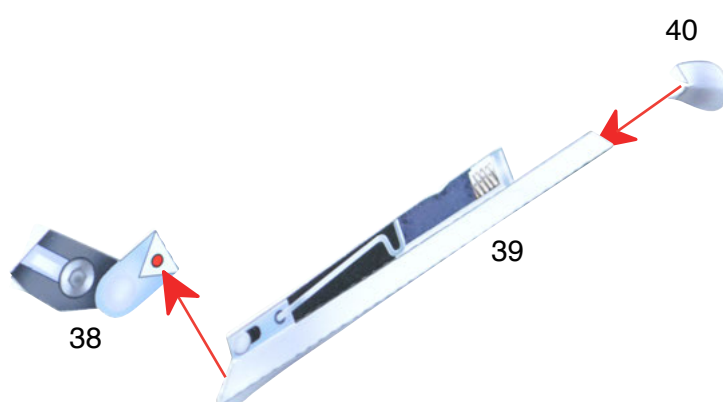

## Frame G

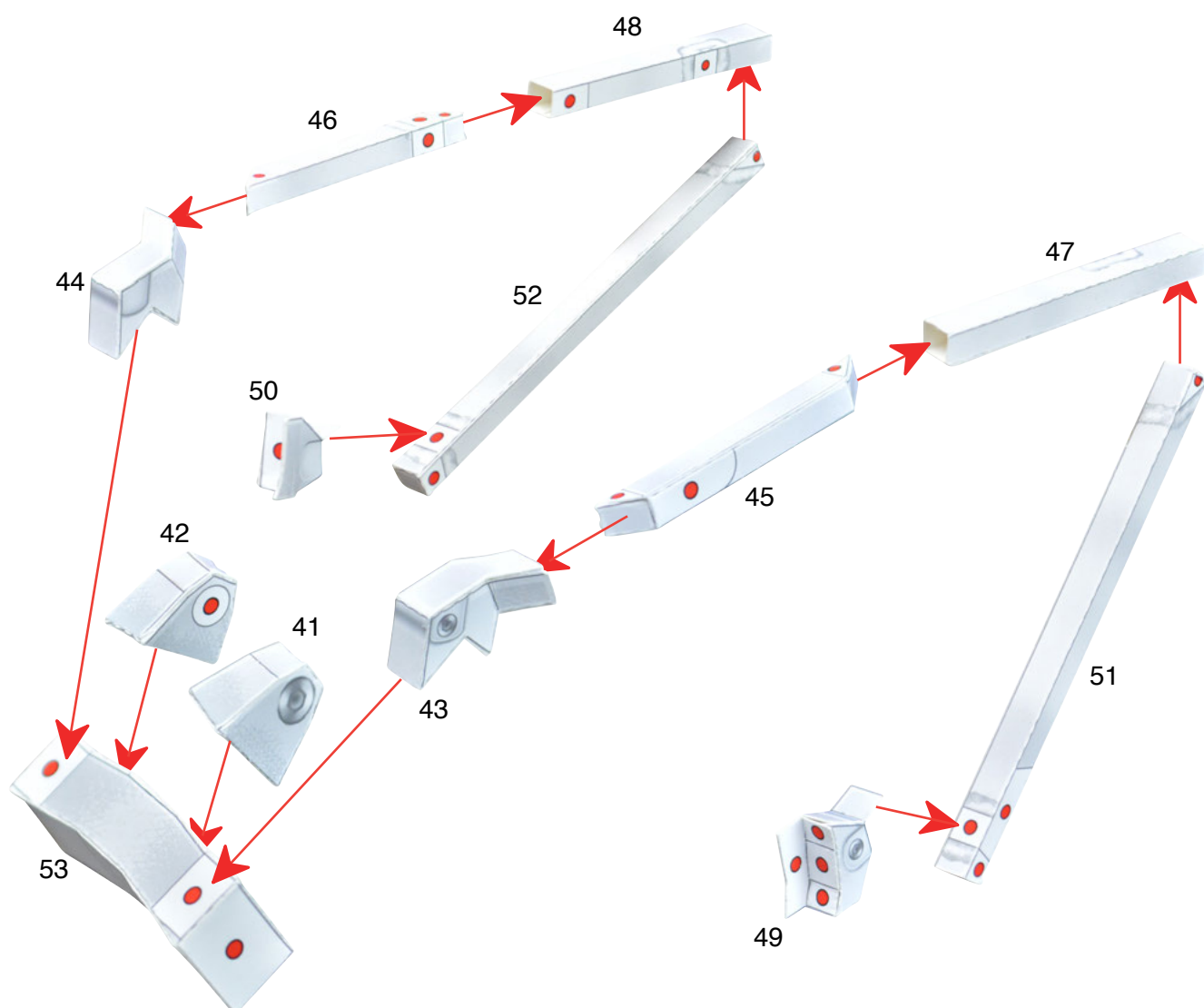

Please refer to the “Basic working method and markings” symbol chart on Page 2 to assemble each part.

 Fold or Curve

 Glue

 Insert

 Gluing surfaces

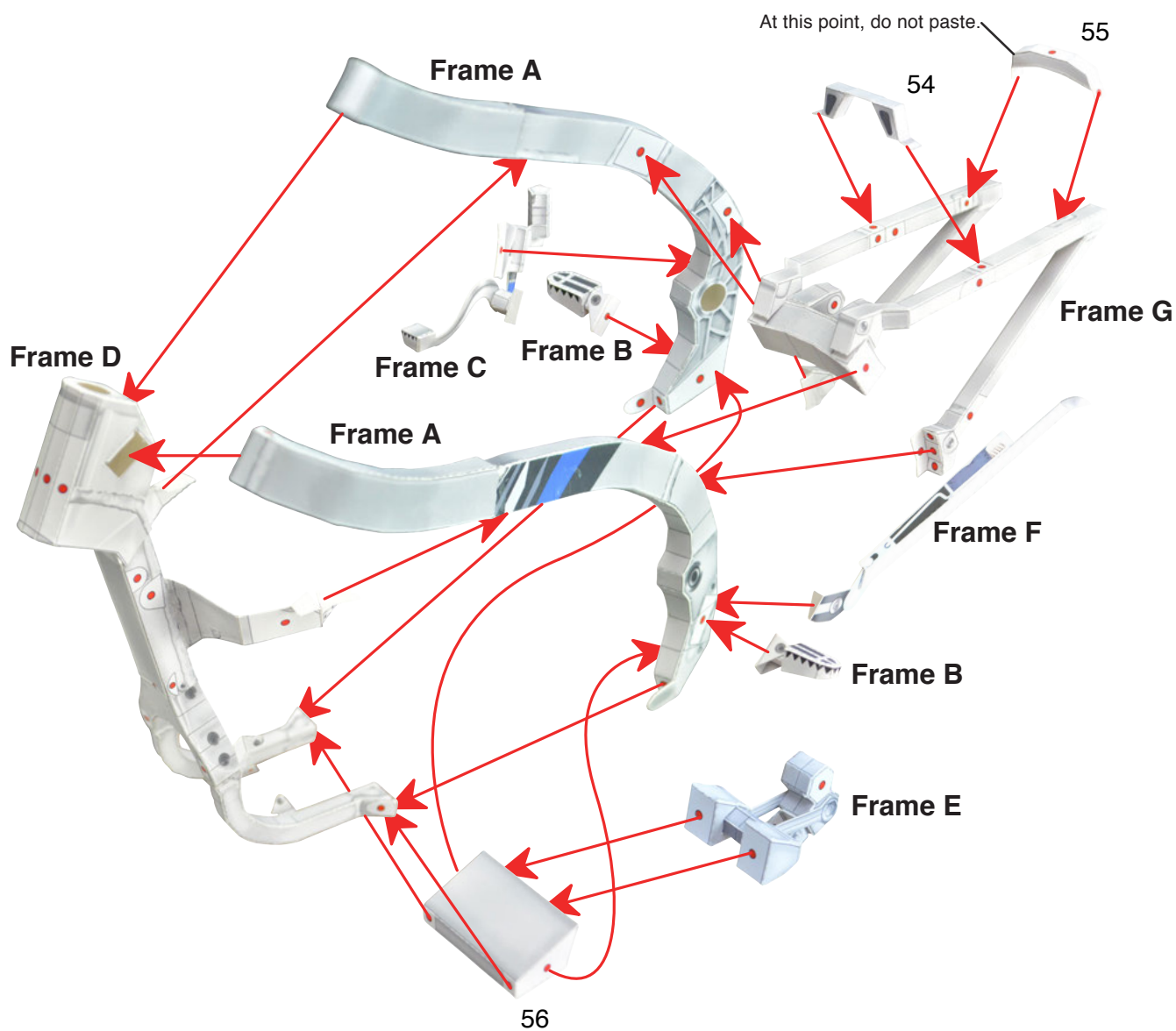

〈 Reference photo 〉



Please refer to the "Basic working method and markings" symbol chart on Page 2 to assemble each part.

--->  
Fold or Curve

→  
Glue

↔  
Insert

●  
Gluing surfaces

### Rear arm A

Assemble both sides. The diagram show the left side.  
The numbers inside the ( ) are for the right side.



### Rear arm B

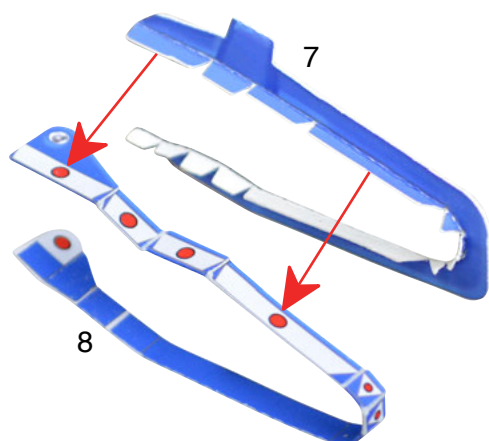

### Rear arm C

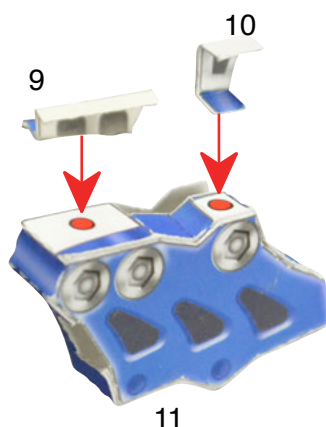

### Rear arm D

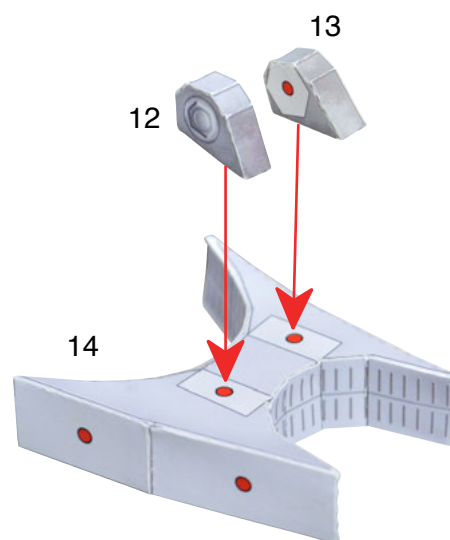

### Rear arm E

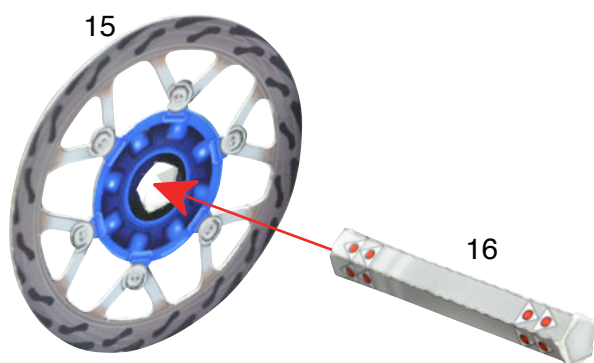

### Rear arm F

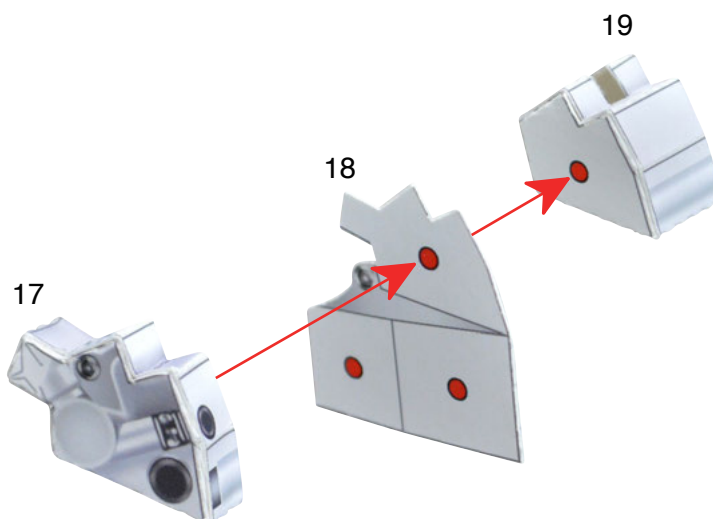

Please refer to the “Basic working method and markings” symbol chart on Page 2 to assemble each part.

 Fold or Curve

 Glue

 Insert

 Gluing surfaces

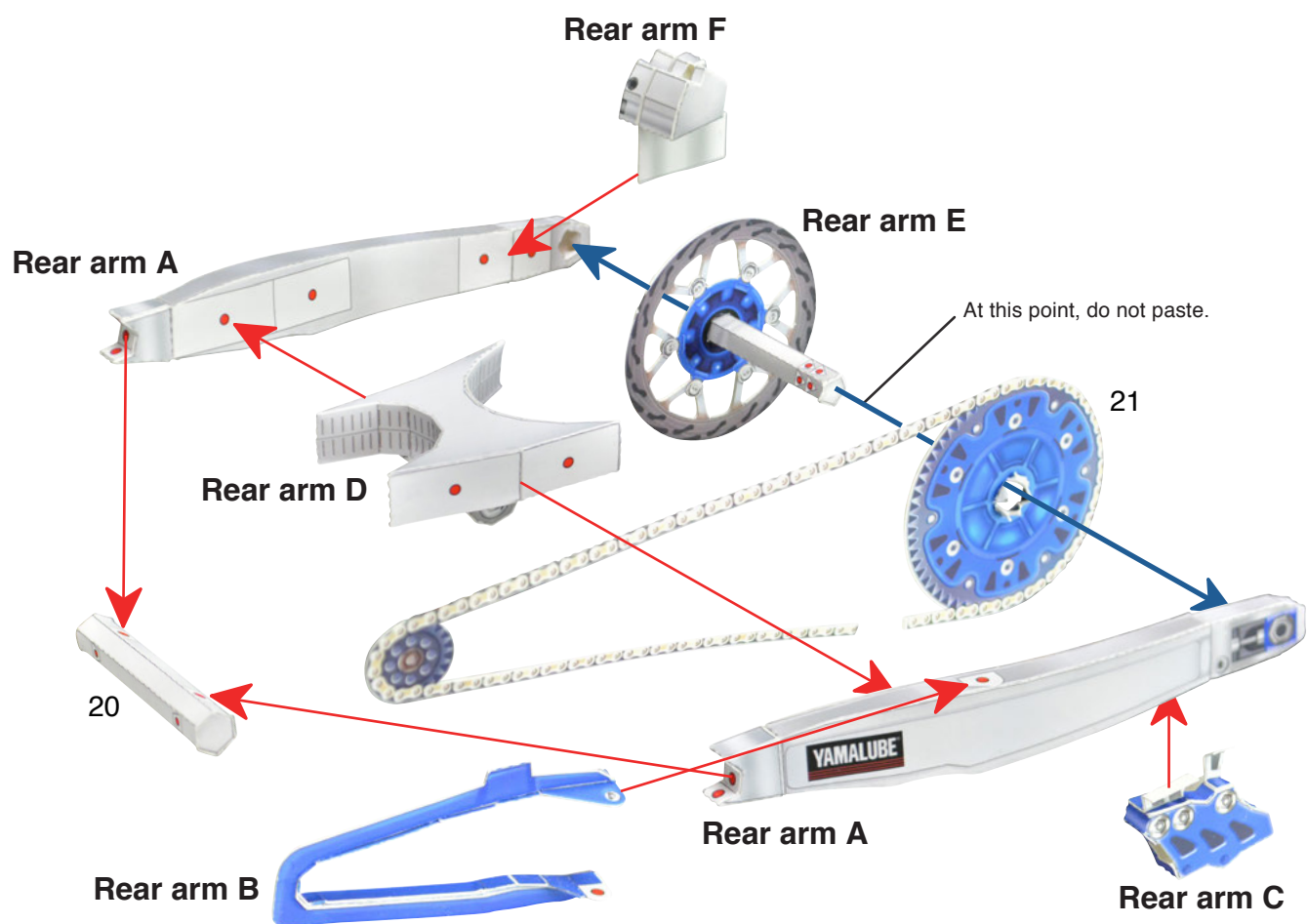

〈 Reference photo 〉

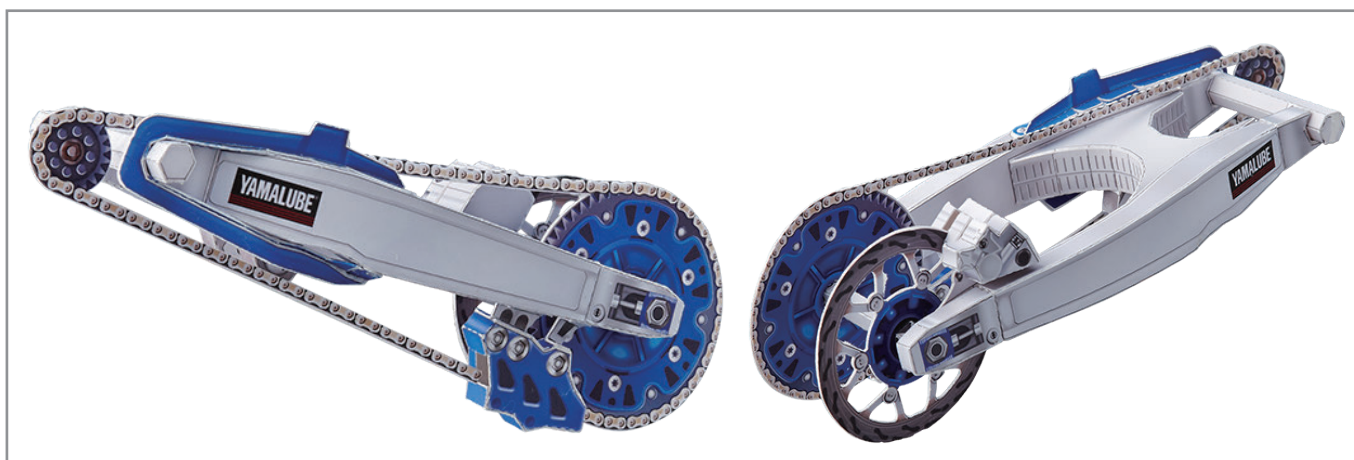



Please refer to the "Basic working method and markings" symbol chart on Page 2 to assemble each part.

 Fold or Curve

 Glue

 Insert

 Gluing surfaces

### Exhaust pipes A

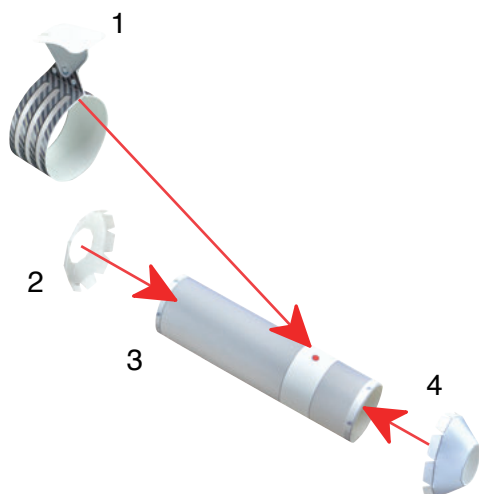

### Exhaust pipes B

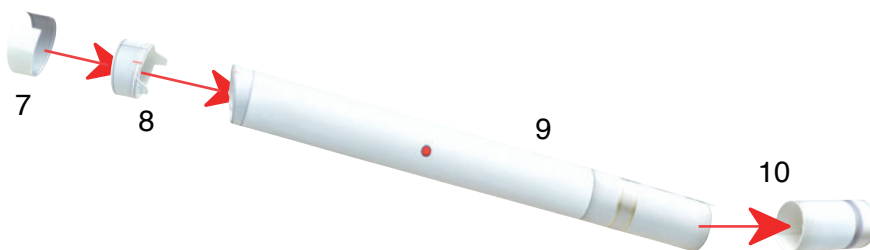

### Exhaust pipes C

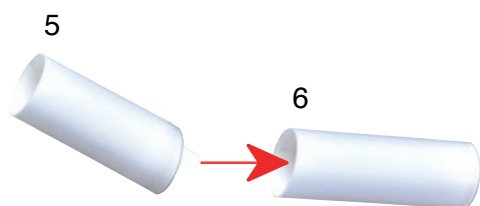

### Exhaust pipes D

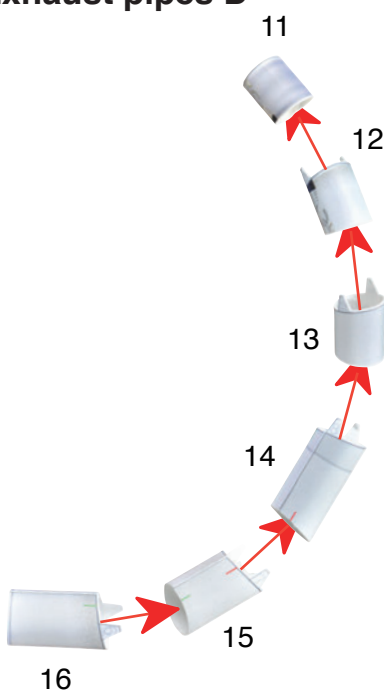

### Exhaust pipes E

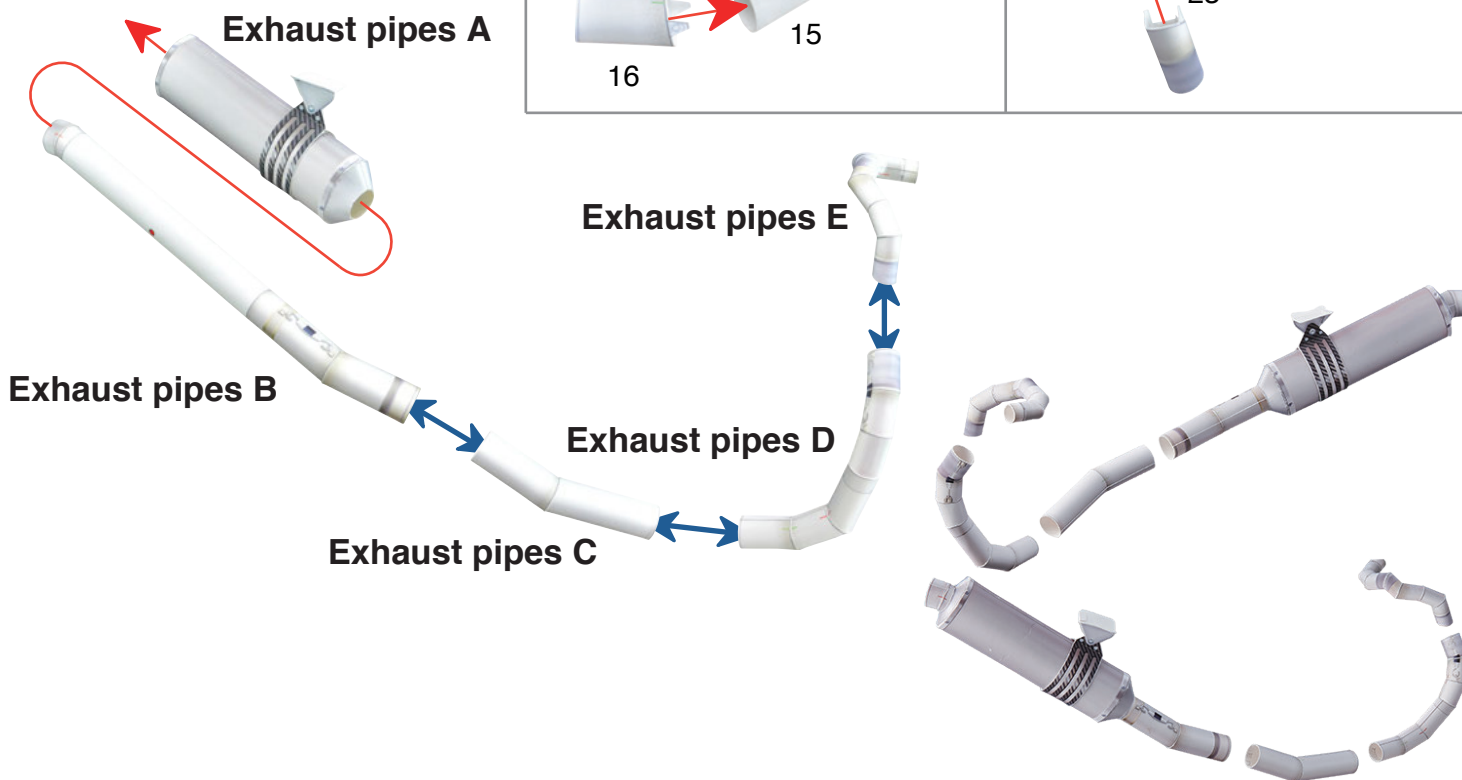
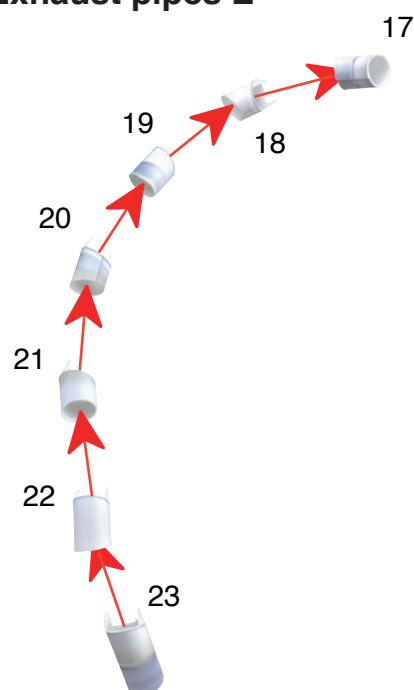

Please refer to the "Basic working method and markings" symbol chart on Page 2 to assemble each part.

 Fold or Curve

 Glue

 Insert

 Gluing surfaces

### Rear fender A

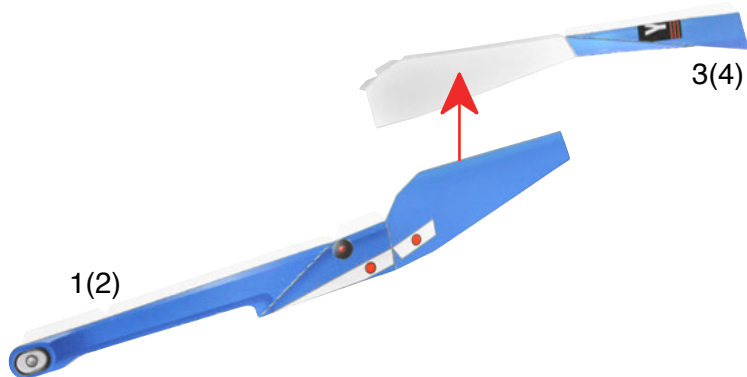

### Rear fender B

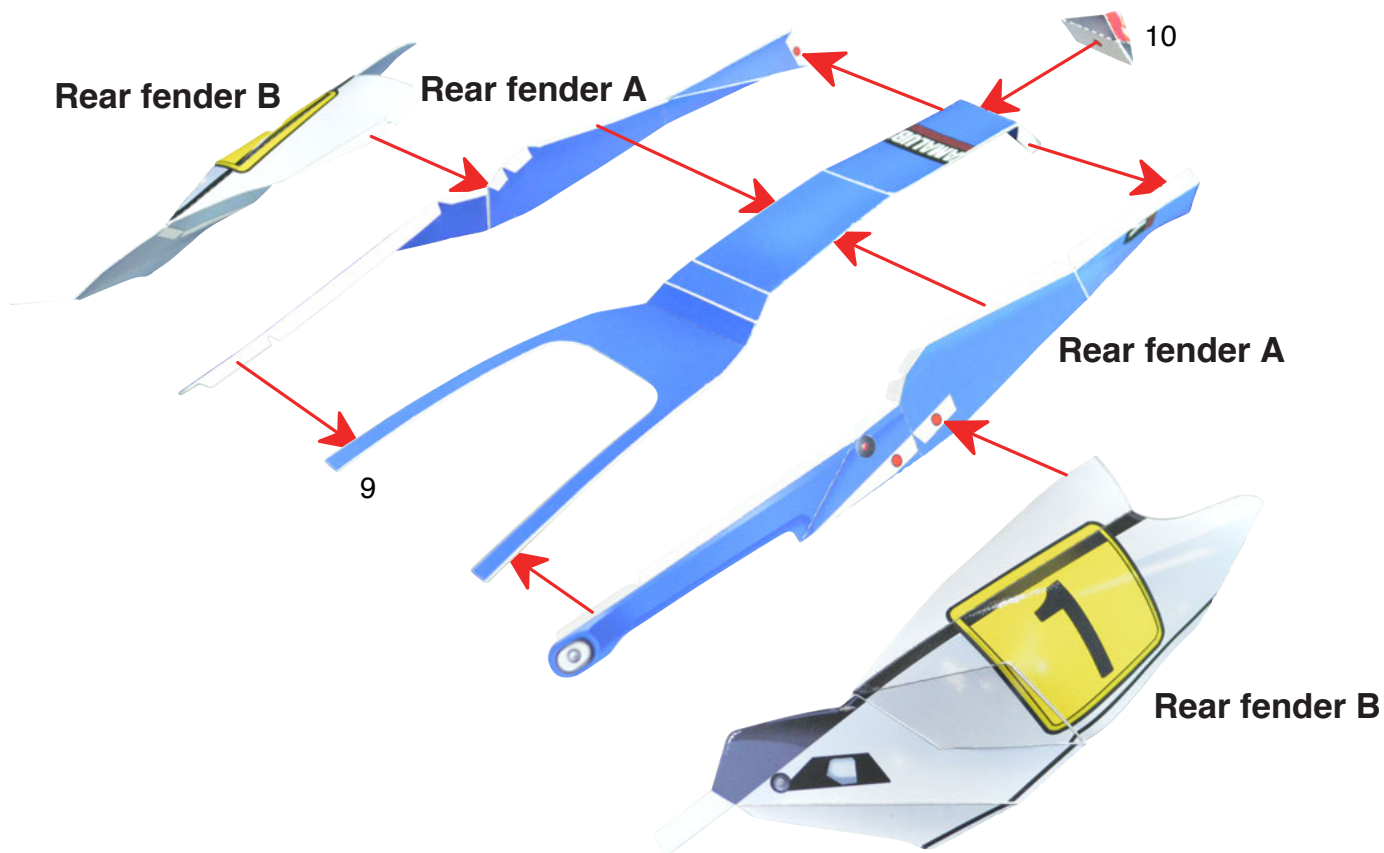
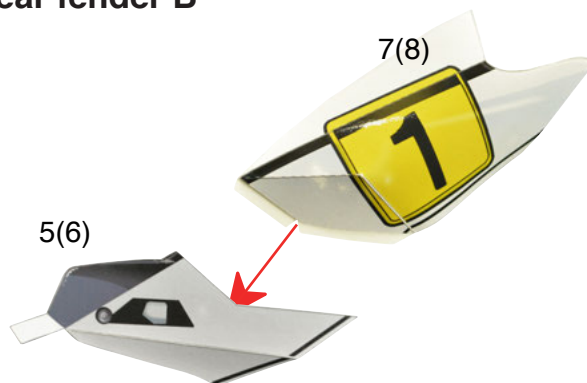

〈 Reference photo 〉



Please refer to the "Basic working method and markings" symbol chart on Page 2 to assemble each part.

 Fold or Curve

 Glue

 Insert

 Gluing surfaces

## Rear fender 2

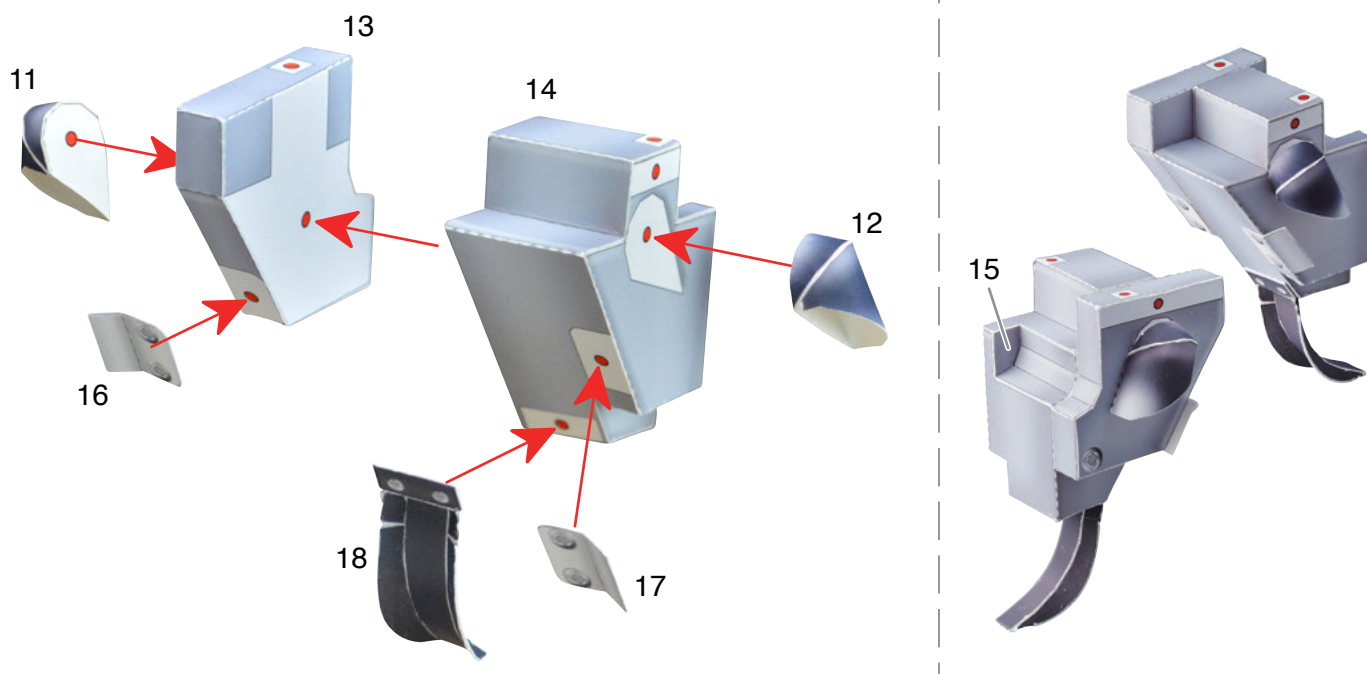

## Tank 4,5

Assemble both sides. The diagram show the left side.  
The numbers inside the ( ) are for the right side.

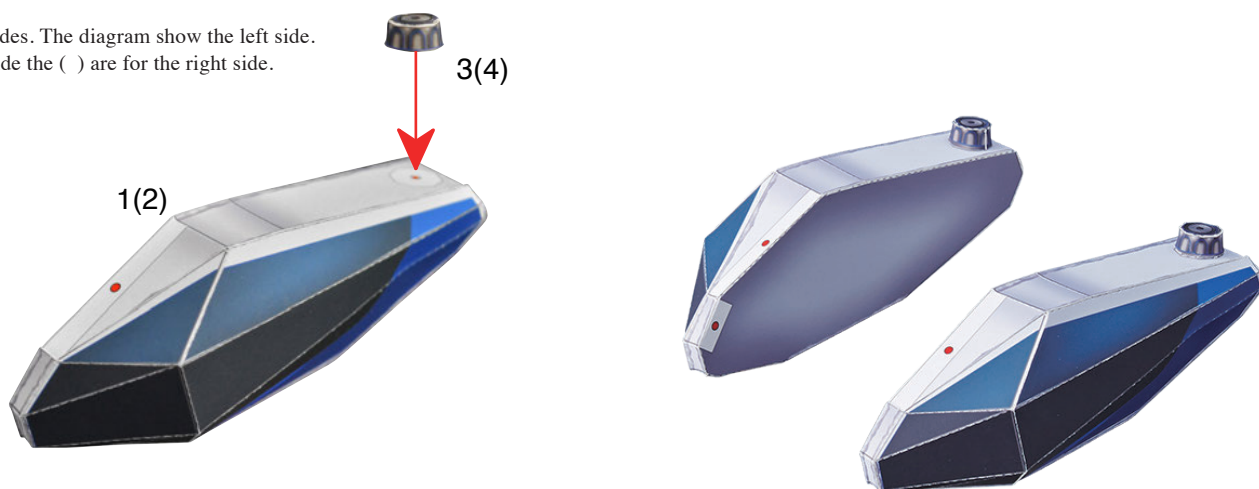

## Stand

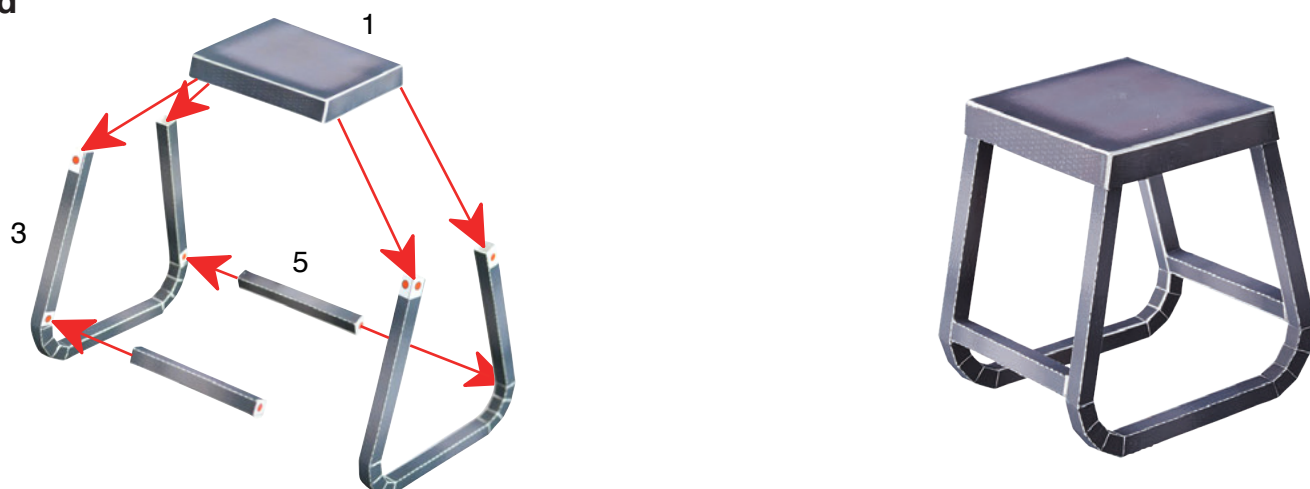

Please refer to the "Basic working method and markings" symbol chart on Page 2 to assemble each part.

 Fold or Curve

 Glue

 Insert

 Gluing surfaces

## Front spoke

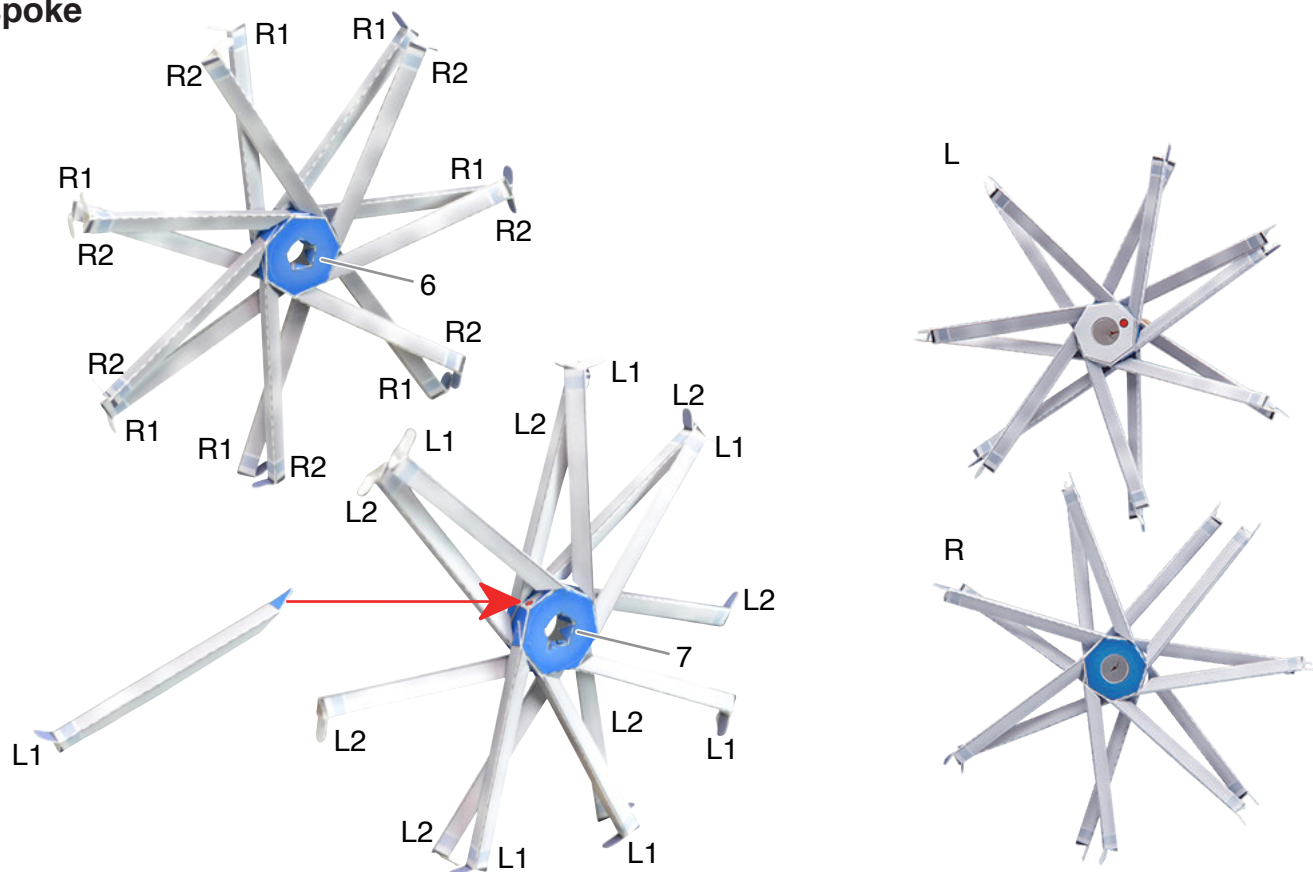

## Rear spoke

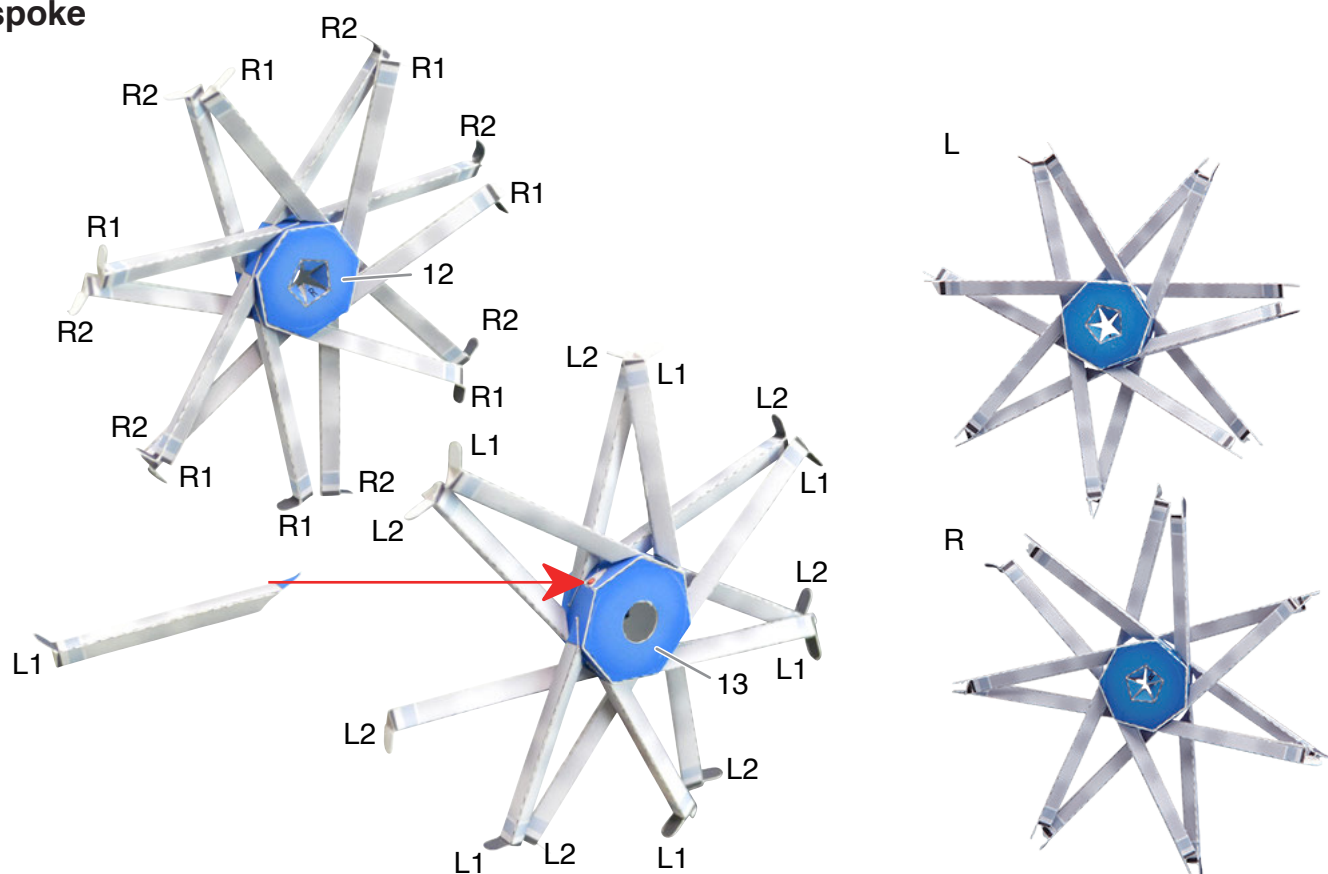



Please refer to the "Basic working method and markings" symbol chart on Page 2 to assemble each part.

  
Fold or Curve

  
Glue

  
Insert

  
Gluing surfaces

## Front tire A

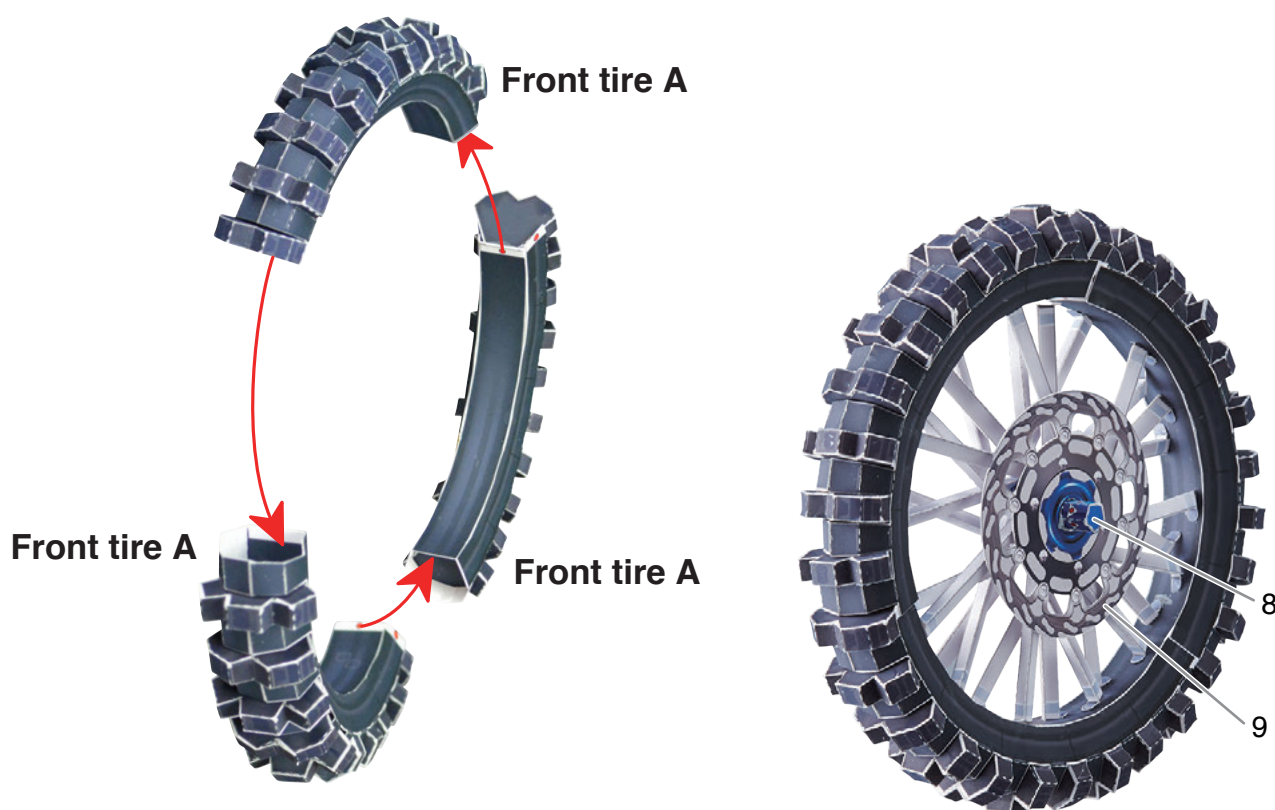
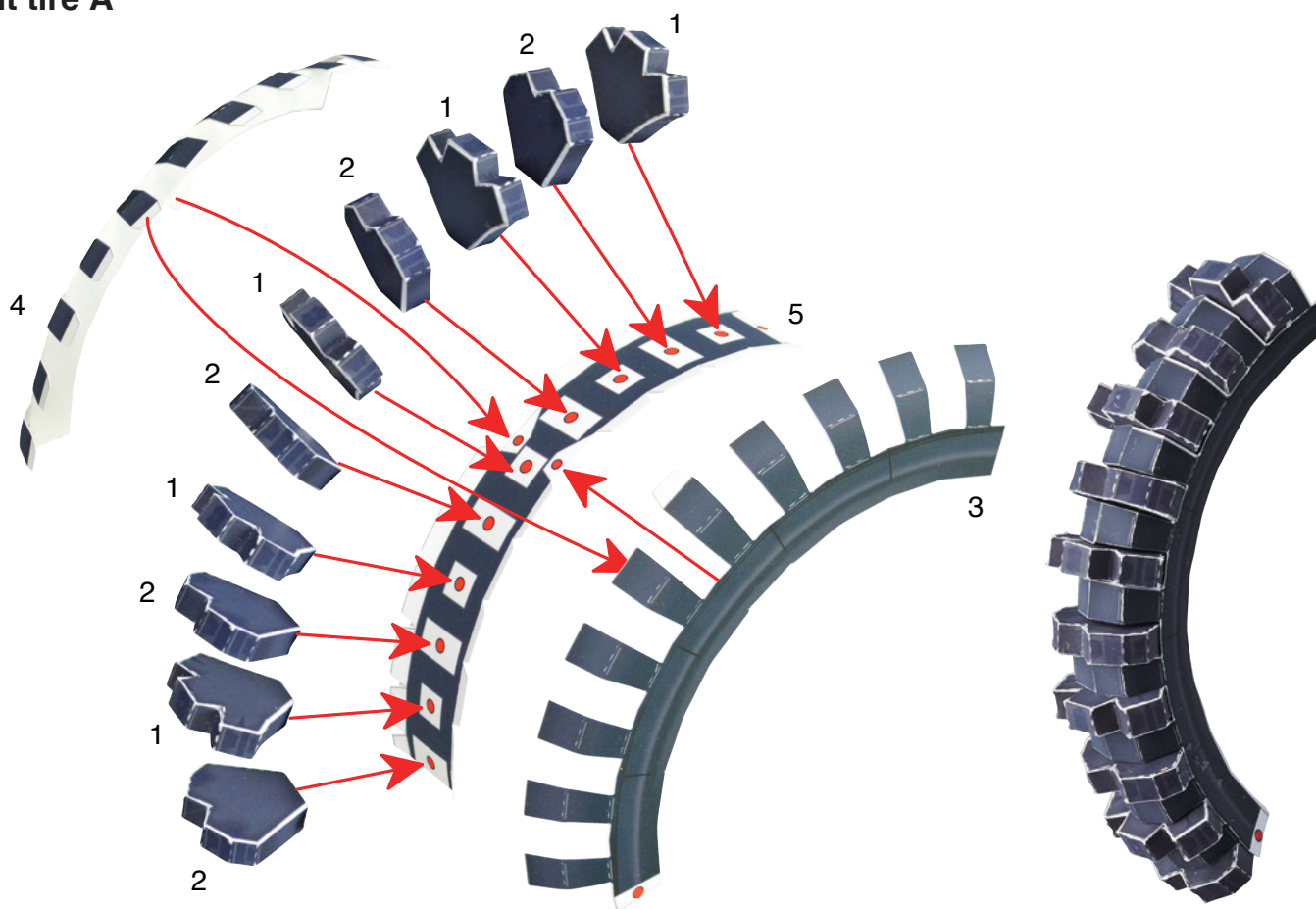

Please refer to the “Basic working method and markings” symbol chart on Page 2 to assemble each part.

 **Fold or Curve**

 **Glue**

  
**Insert**

 **Gluing surfaces**

### Rear tire A

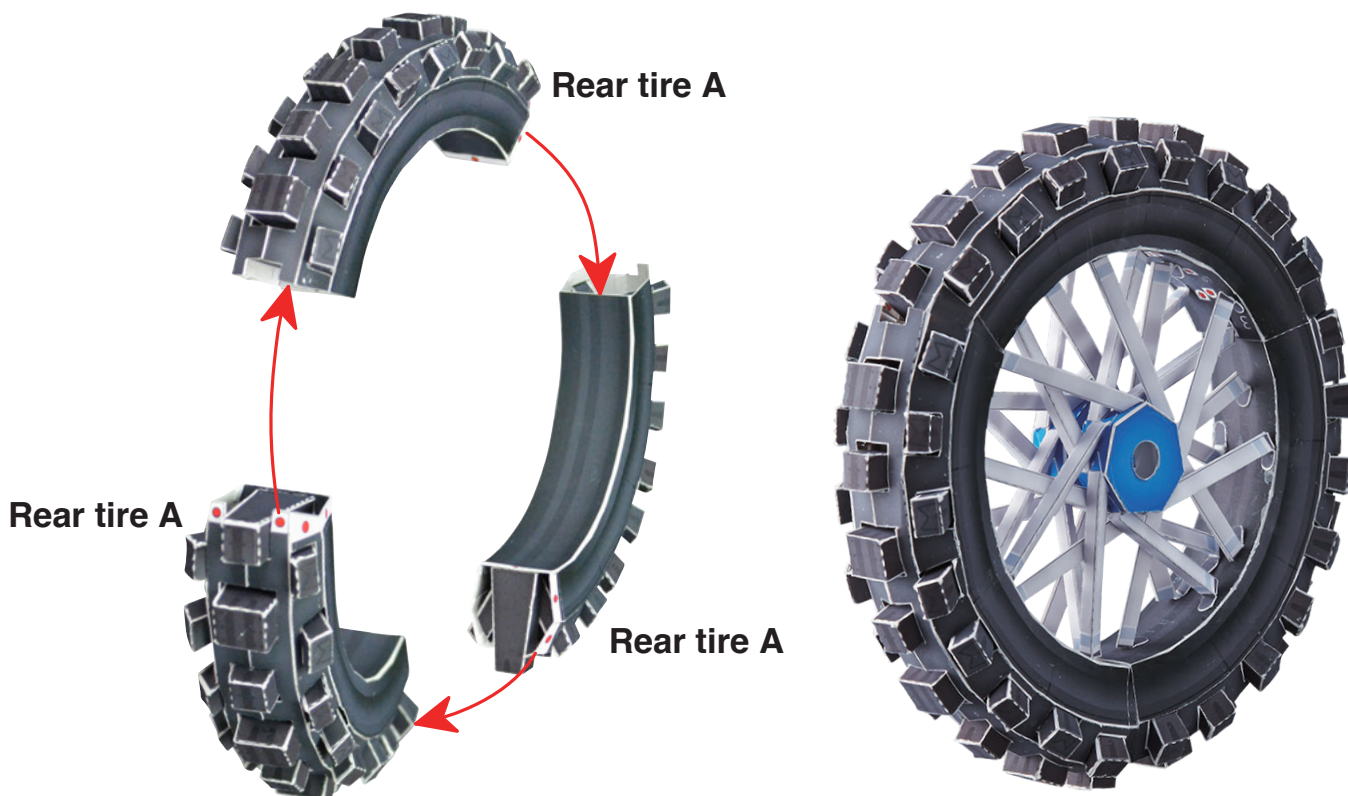
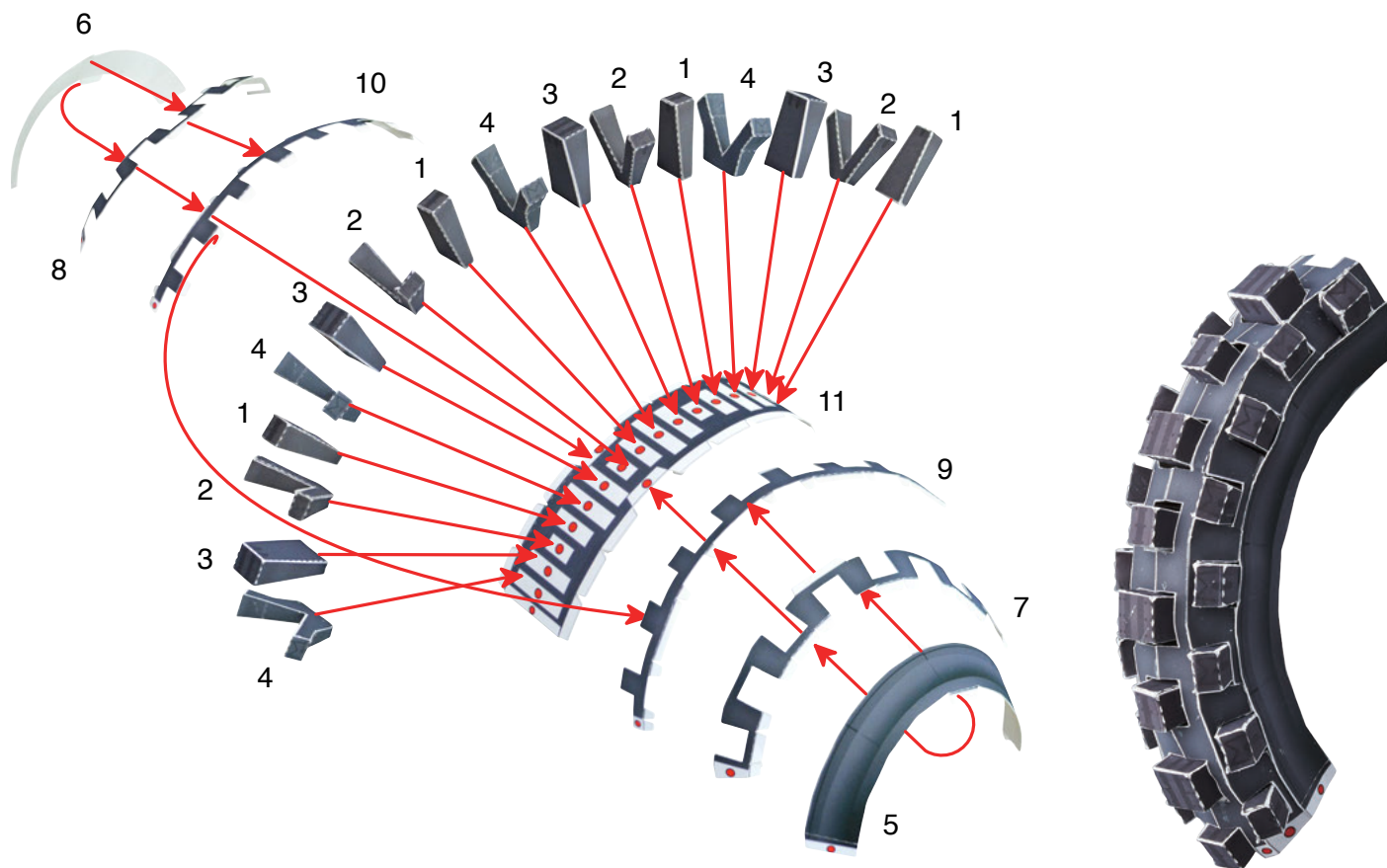

Please refer to the “Basic working method and markings” symbol chart on Page 2 to assemble each part.

 Fold or Curve

 Glue

 Insert

 Gluing surfaces

**1** Glue the engine to the frame

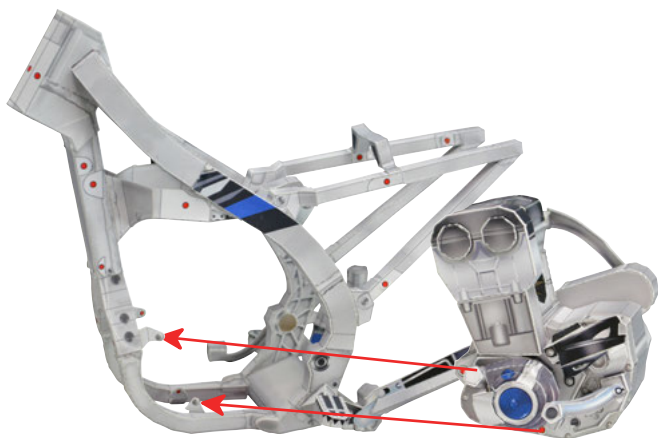

**2** Glue the rear tire to the rear arm

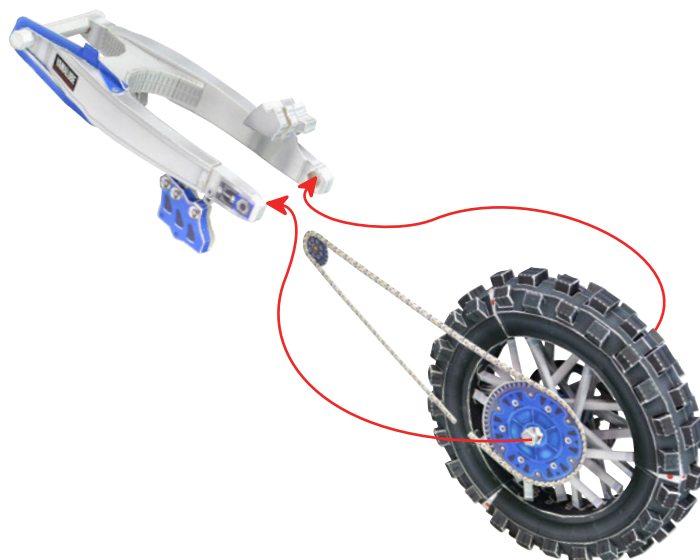

**3** Glue the rear arm to the frame



**4** Glue the rear suspension to the frame

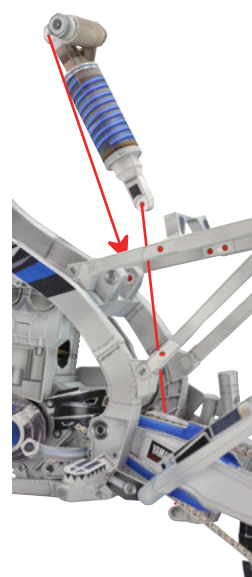

**5** Glue the radiator to the frame

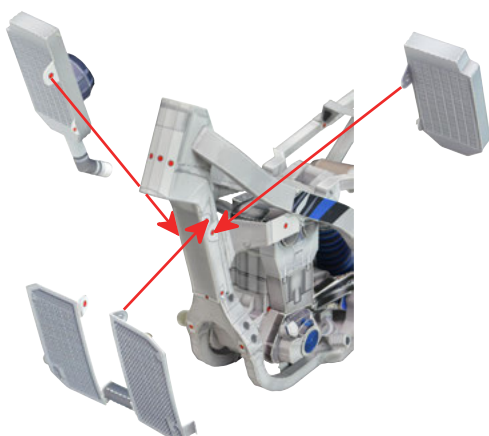

**6** Glue the rear fender-2 to the frame

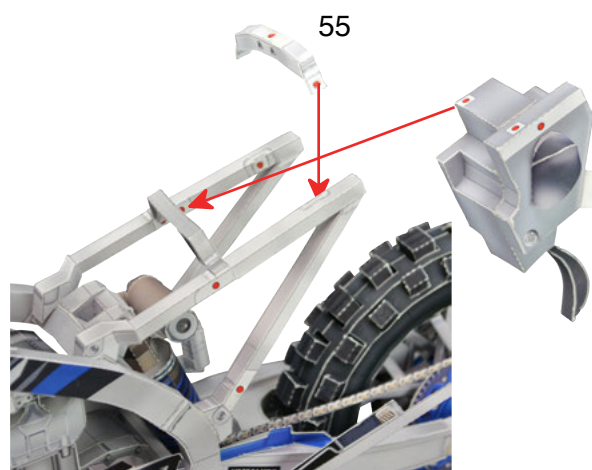



Please refer to the “Basic working method and markings” symbol chart on Page 2 to assemble each part.

 Fold or Curve

 Glue

 Insert

 Gluing surfaces

**7** Glue the tank-4, 5 to the frame

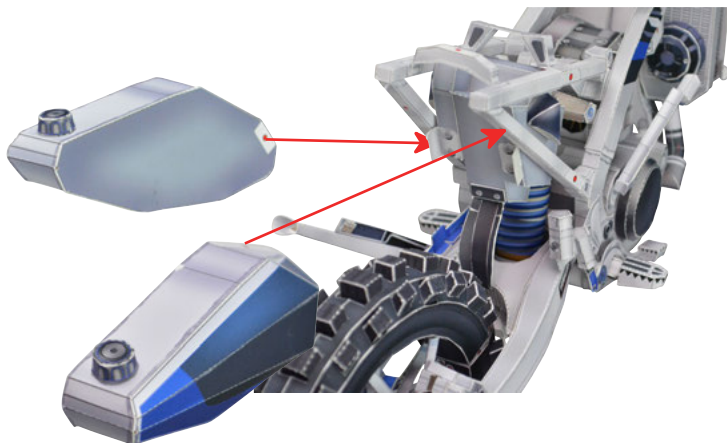

**8** Glue the exhaust to the engine, the tank-5

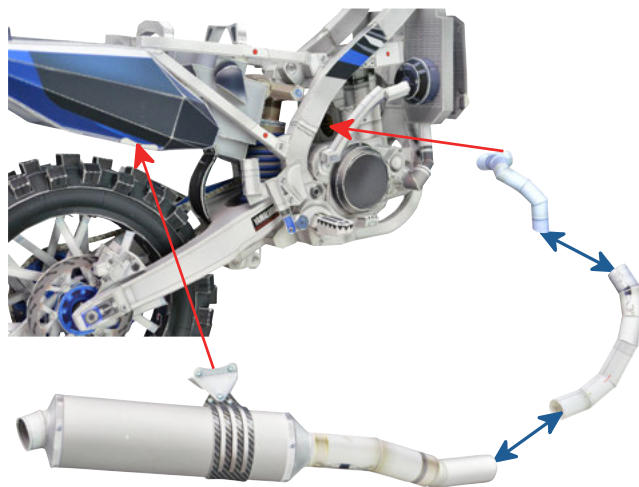

**9** Glue the tank-1, 2 to the frame

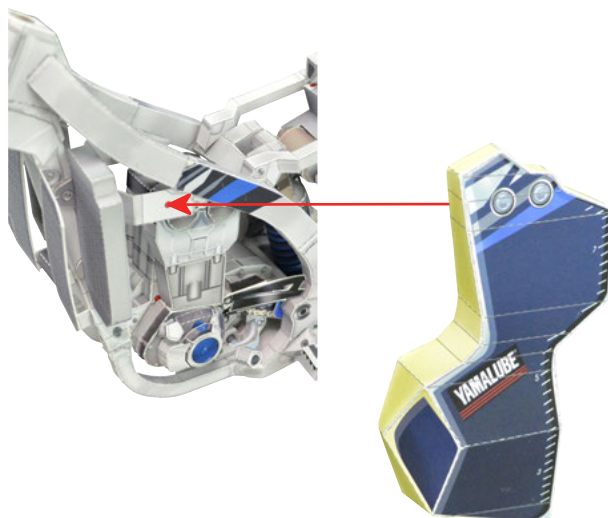
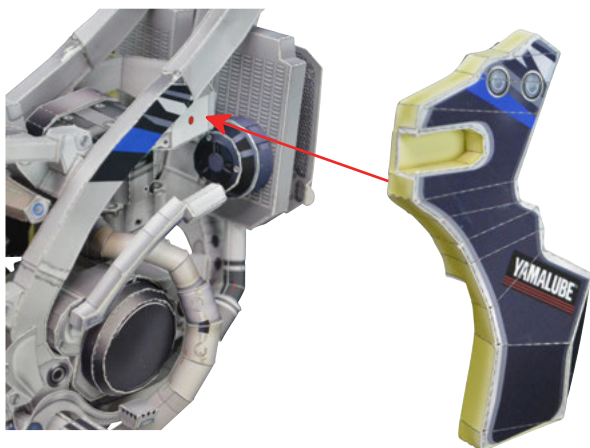

**10** Glue the under cowl to the frame

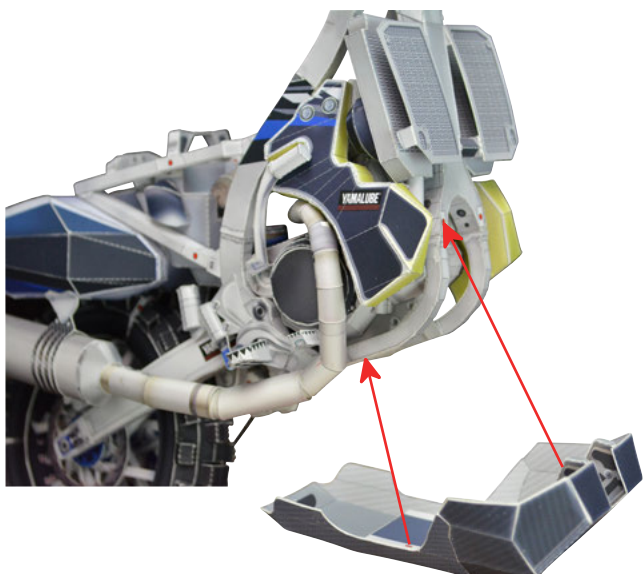

**11** Glue the rear fender-1 to the frame

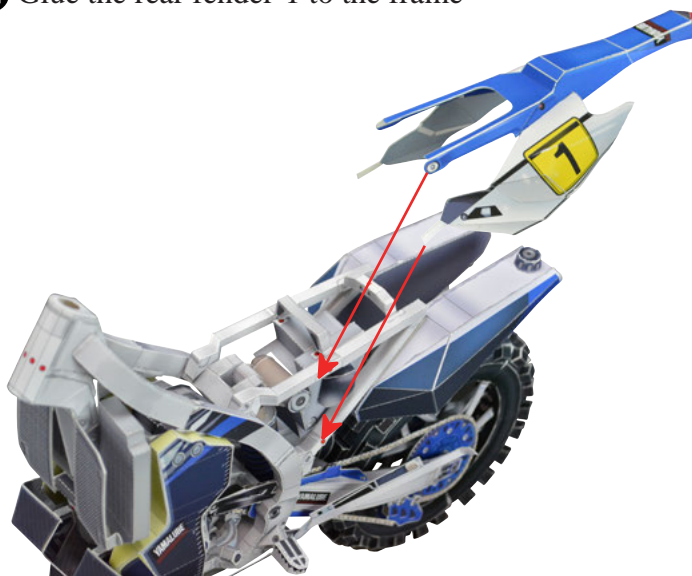



Please refer to the “Basic working method and markings” symbol chart on Page 2 to assemble each part.

--->  
Fold or Curve

→  
Glue

↔  
Insert

●  
Gluing surfaces

**12** Glue the side cowl to the tank-3



**13** Glue the tank-3 to the frame

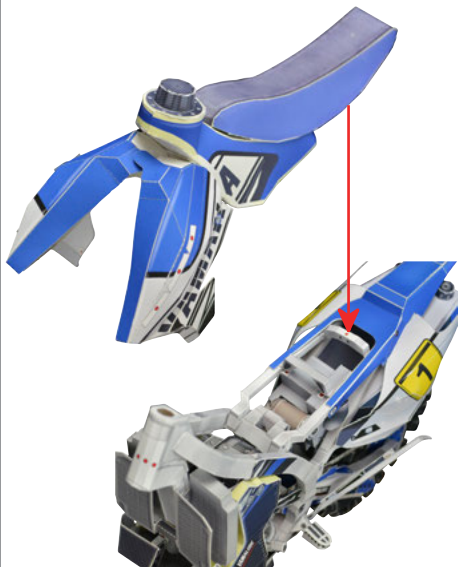

**14** Glue the map to the frame



**15** Glue the front tire to the steering

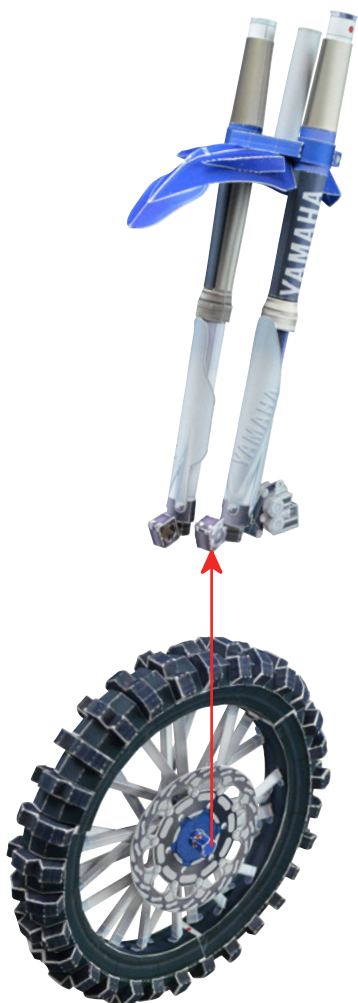

**16** Put the steering-F through the frame and glue it to the steering-D

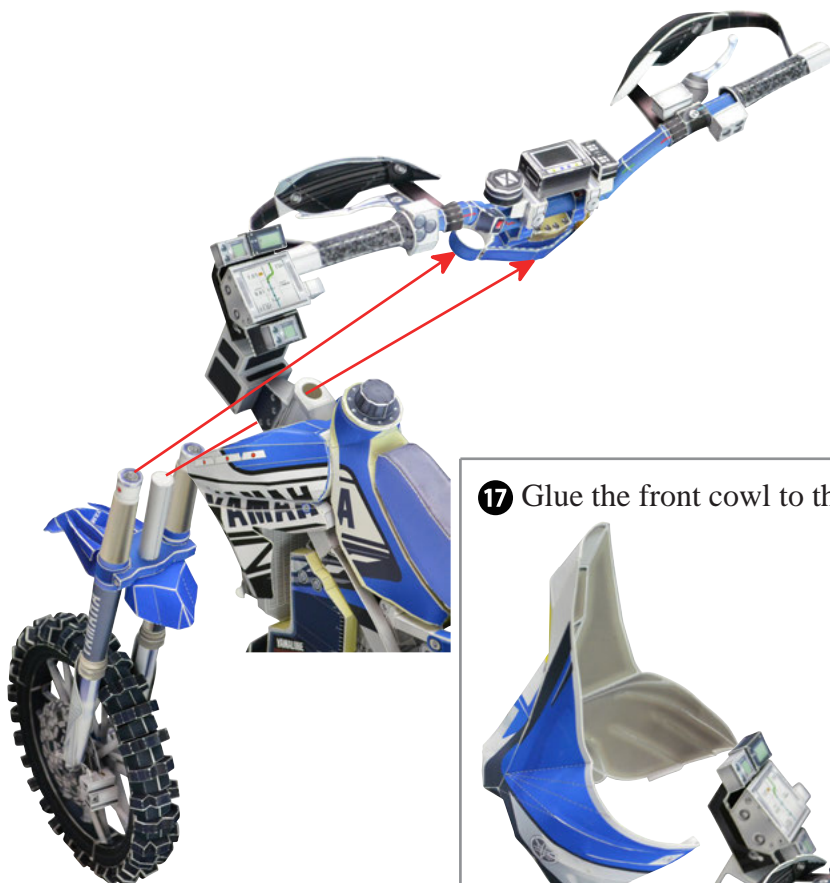

**17** Glue the front cowl to the side cowl



Here are pictures of completed models. Please refer to them when assembling.





Here are pictures of completed models. Please refer to them when assembling.



Here are pictures of completed models. Please refer to them when assembling.

