

MOC "Indy" minifig instructions



Print the parts on thicker paper (I always use 200 gsm paper) and get out your papercrafting tools! ;o)



step 8



Glue together part T1, after cutting out the 2 holes on the sides and the 3 slits on the top.

step 9

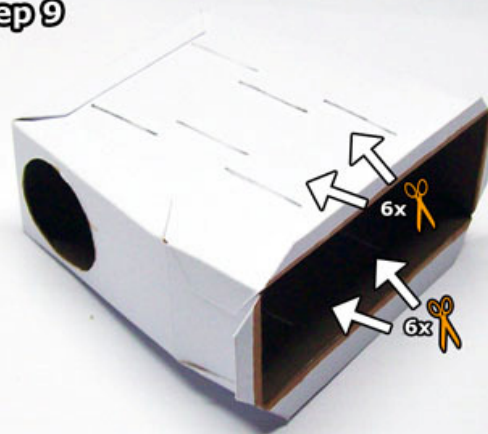

T2 is another part that needs to be glued together with the coloured side in, after cutting out the 2 holes on the sides and the 12 slits on the front and back.

step 10

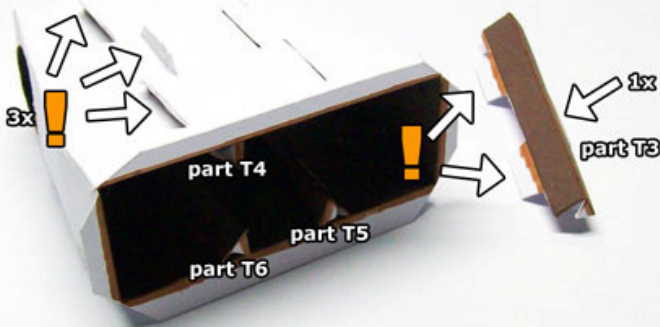

parts T3-T6 each have 3 larger glueing flaps, that you need to push through the slits on part T2 to glue the parts together in the right position.

step 11

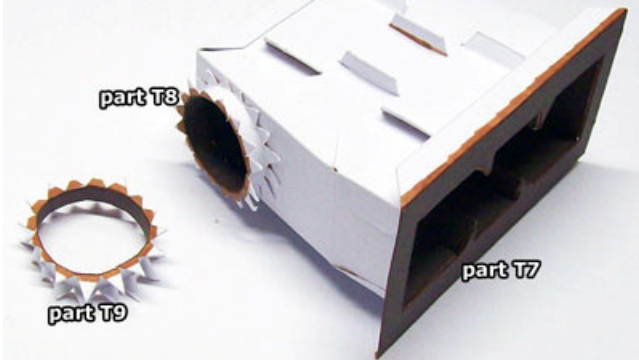

Now glue part T7 underneath the inside of the torso, and parts T8 and T9 (with the coloured side in!) around the holes on the sides.

step 12

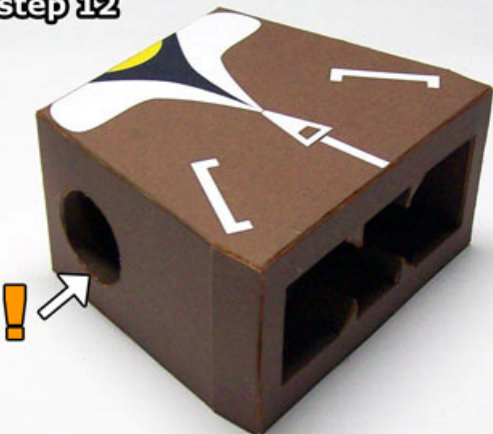

Glue parts T2-T9 inside part T1, taking special care to align the holes on the sides

step 13



Glue together part 10, but again, don't fold the 6 bigger flaps on the bottom!

step 14

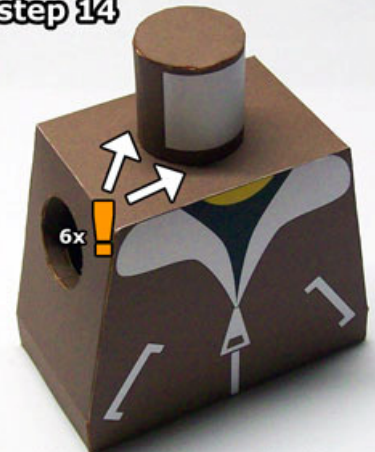

Push those 6 bigger glueing flaps through the slits on top of the torso to secure the neck in place.

step 15

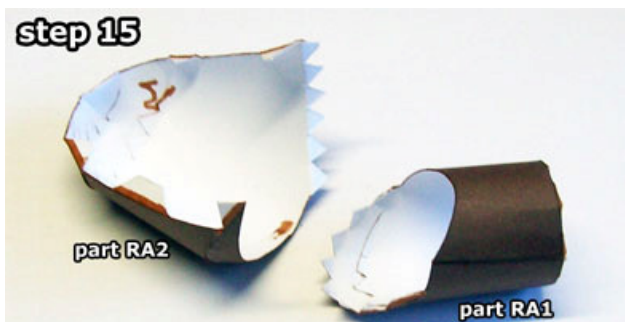

Glueing together round/curved parts like RA1 and RA2, will be easier when you "pre-shape" them (curve them before glueing them together).

step 16



Take your time glueing the two parts together!

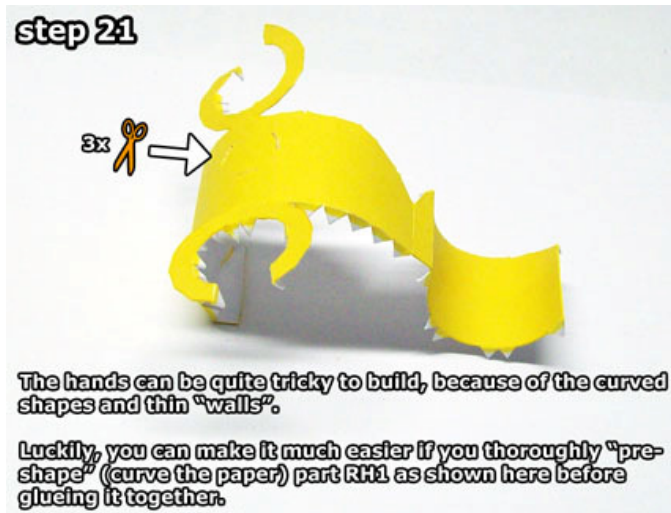
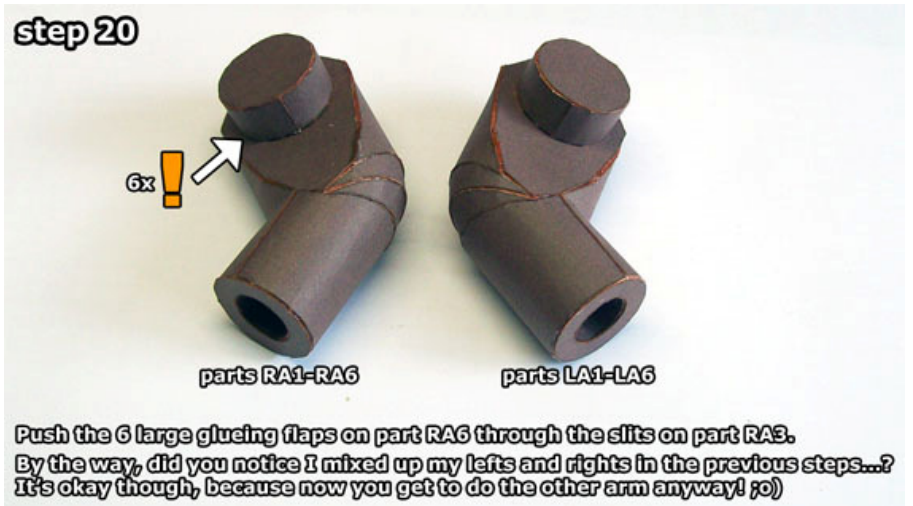
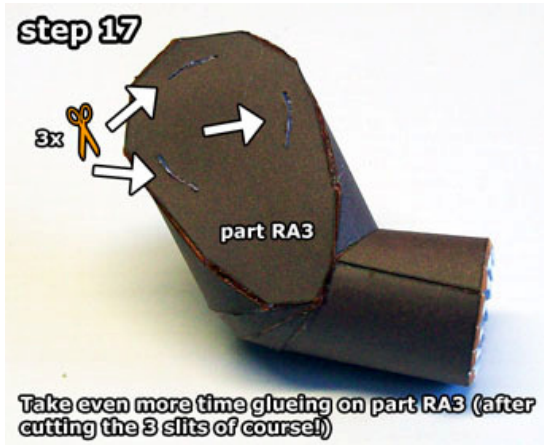

step 26

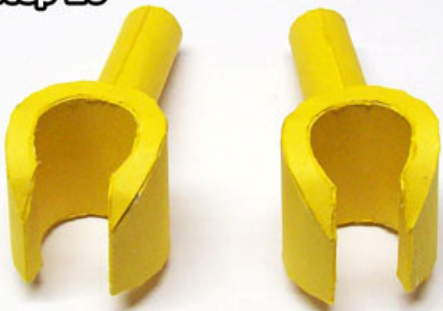

parts RH1+RH2

parts LH1+LH2

Assemble the left hand (parts LH1+LH2) the same way.

step 27

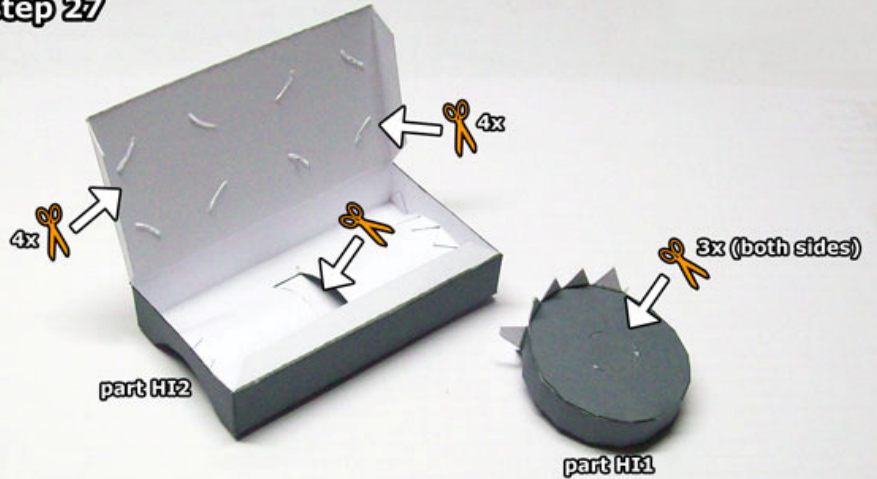

part HI2

part HI1

Cut the slits (and square hole) on parts HI1 and HI2, but DON'T CLOSE part HI2 yet...

step 28

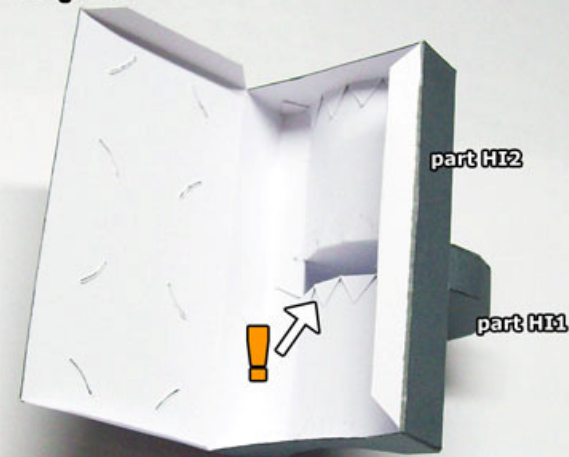

part HI2

part HI1

...so you can glue part HI1 to the rectangular hole on part HI2 as shown here.

step 29



part HI3

After that, you can close the top of the hip piece so far and glue together part HI3, not folding the 6 bigger glueing flaps on that part.

step 30

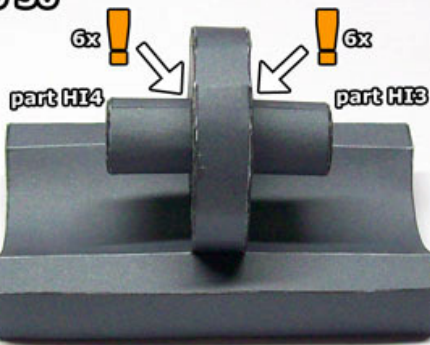

part HI4

part HI3

Push the 6 larger glueing flaps through the slits on part HI1 to glue part HI3 (and HI4 in the same way) to the rest of the hips.

step 31

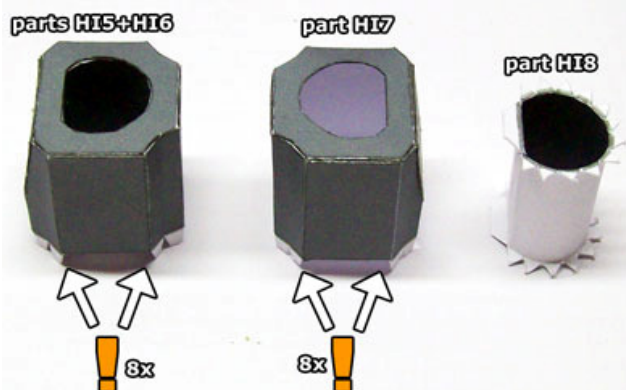

parts HI5+HI6

part HI7

part HI8

The "knobs" on top of the hips are each made from two parts glued together: HI5+HI6 and HI7+HI8

Parts HI5 and HI7 both have 8 larger glueing flaps that shouldn't be folded over, and parts HI6 and HI8 need to have the coloured side in.

step 32

parts HI5+HI6

parts HI7+HI8

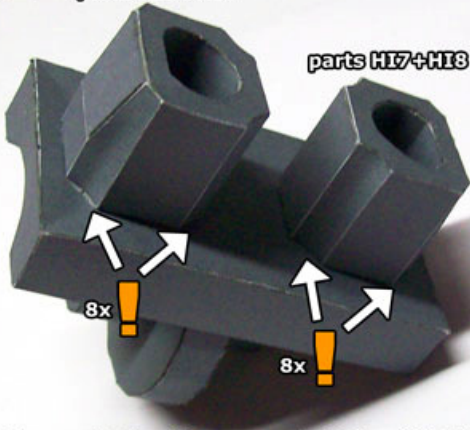

Push the larger gluing flaps on parts HI5 and HI7 through the slits on top of the hips to glue them on in the right place.

step 33

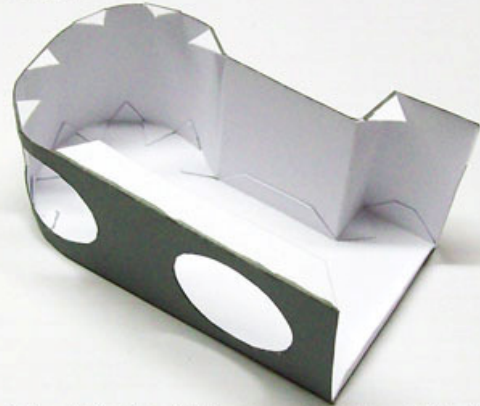

Cut out the two holes on part RL1 and glue it together as shown here.

step 34



Take your time to pre-shape and assemble part RL2: start with the gluing flap marked "A" to glue together the side with the hole...

step 35



part RL3

part RL2

When you glue together the other side (with the edge marked "B") part RL2 should look as shown here.

Next, cut out and assemble part RL3 as well.

step 36

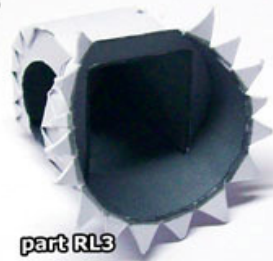

part RL3

Glue part RL3 over the square opening, and then glue together the curved front connecting the edges marked "C" and "D" on the template.

step 37

part RL4

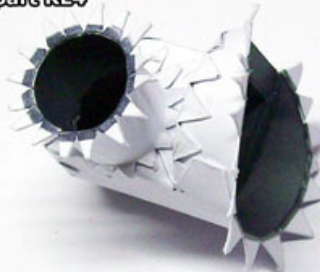

Glue part RL4 into a cylinder, and glue it over the hole on the side of part RL2.

step 38

parts RL2
+RL3

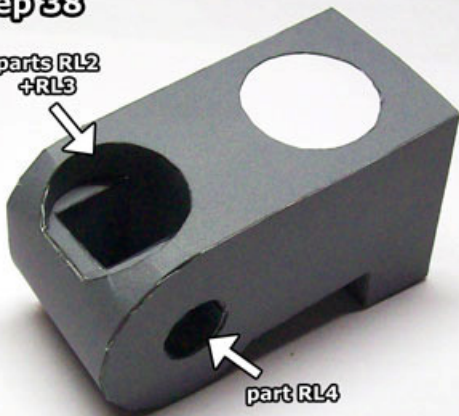

part RL4

Take your time aligning and glue the whole piece underneath the two wholes on the top part of the leg.

step 39

part RL7

part RL5

part RL6

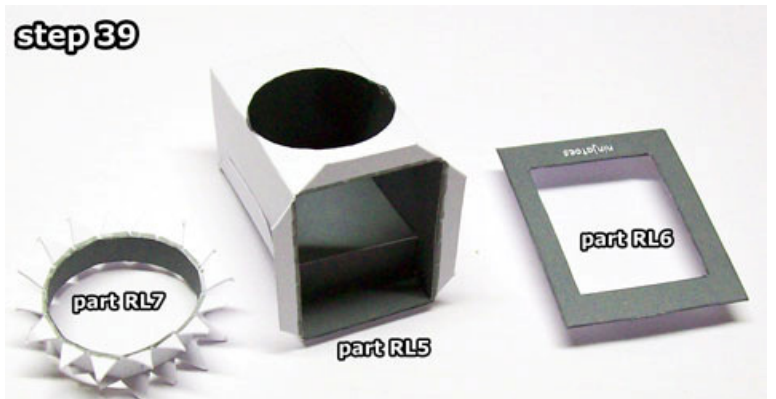

Cut out and assemble parts RL5 through RL7...

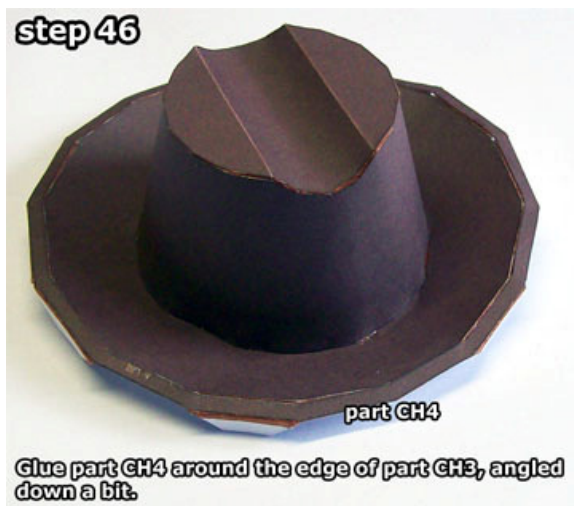
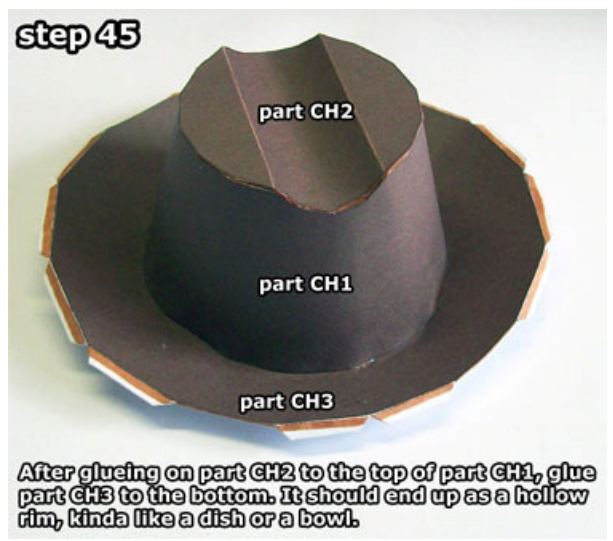
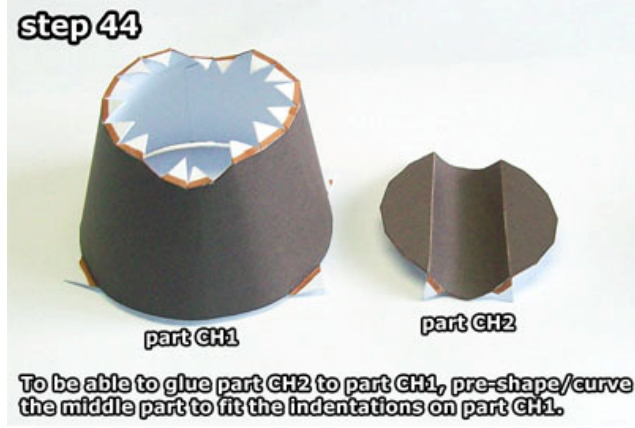
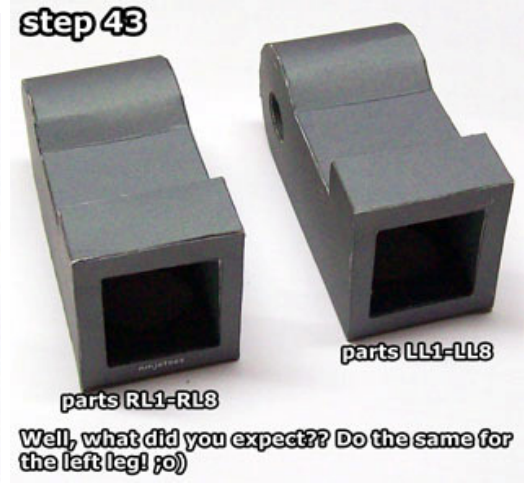

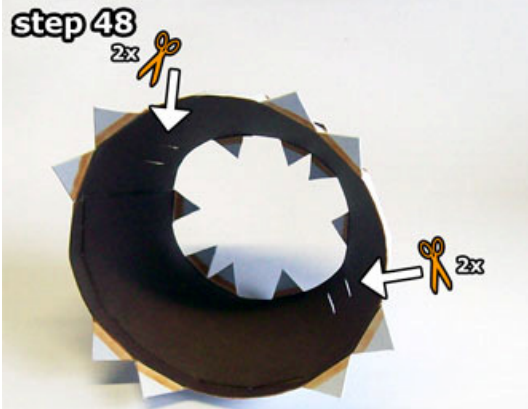

Part CH6 on the other hand, should be concave again, like a dish/bowl: don't forget to cut the four slits!

step 49

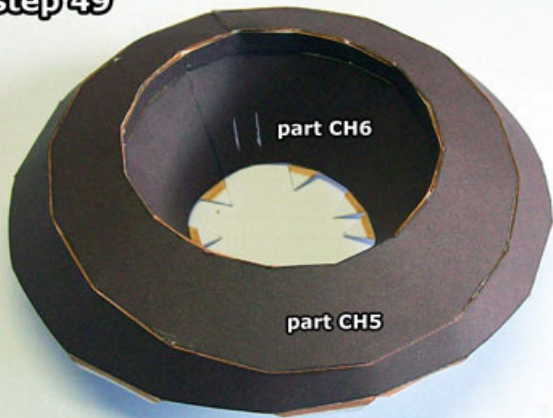

Glue part CH6 inside part CH5, aligning the slits next to the seam on part CH6 with the seam on part CH5. (don't worry, it's easy because of the way the glueing flaps are positioned :o)



Cut out the hole on part CH7 and glue it together, but DON'T fold the 4 (slightly) bigger glueing flaps!

step 51

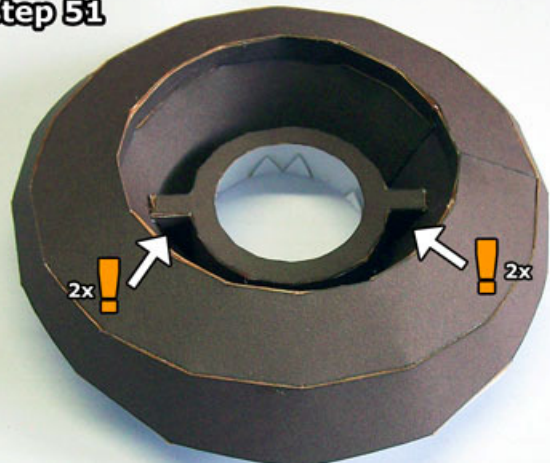

Push those 4 glueing flaps through the slits on part CH6 to glue it in the correct position.

step 52

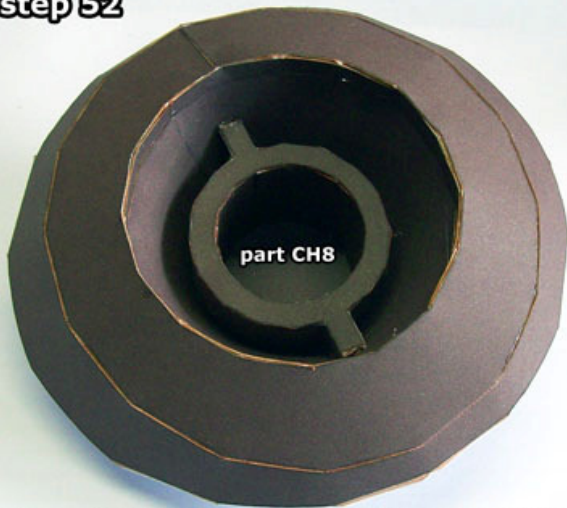

Glue part CH8 into a cylinder (with the coloured side in) and glue it over the hole on part CH7.

step 53

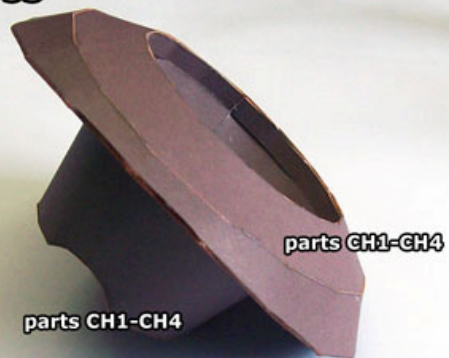

Take your time glueing the bottom half of the cowboy hat (parts CH5-CH8) to the rim of the half! (parts CH1-CH4)

step 54



Cut out and glue together part EP1 as shown here.

step 55



To glue together parts EP2 and EP3, make sure you fold them the right way: valley fold (up) for and mountain fold (down) for - - - - -

Refer to the PDF file if you're having trouble seeing the lines on the printed sheets!

step 56

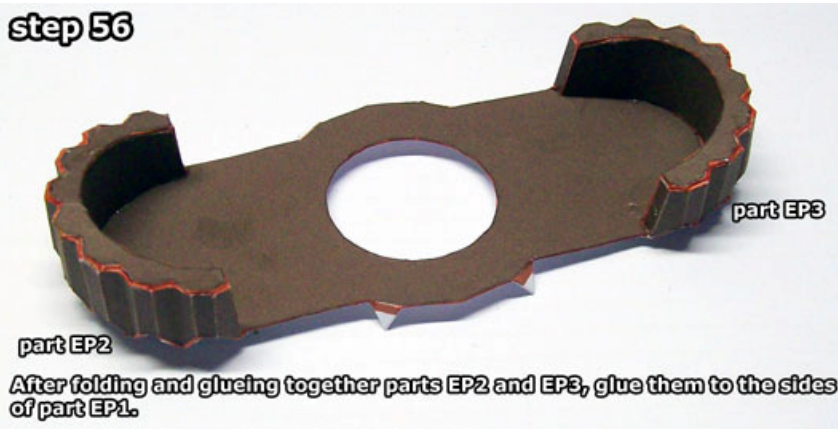

part EP2

part EP3

After folding and gluing together parts EP2 and EP3, glue them to the sides of part EP1.

step 57

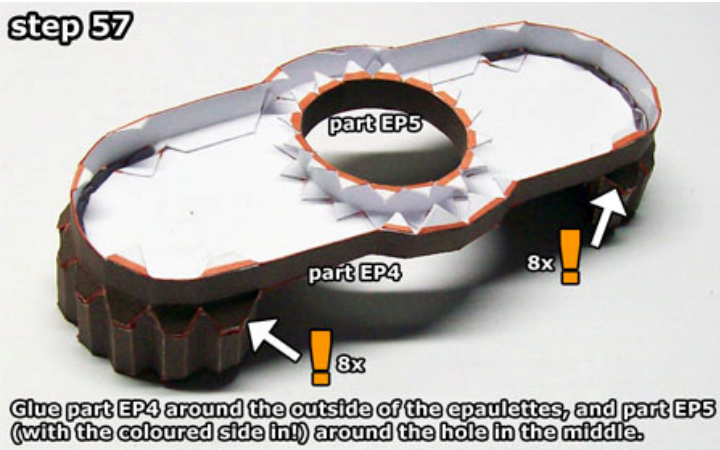

part EP5

part EP4

8x

8x

Glue part EP4 around the outside of the epaulettes, and part EP5 (with the coloured side in!) around the hole in the middle.

step 58

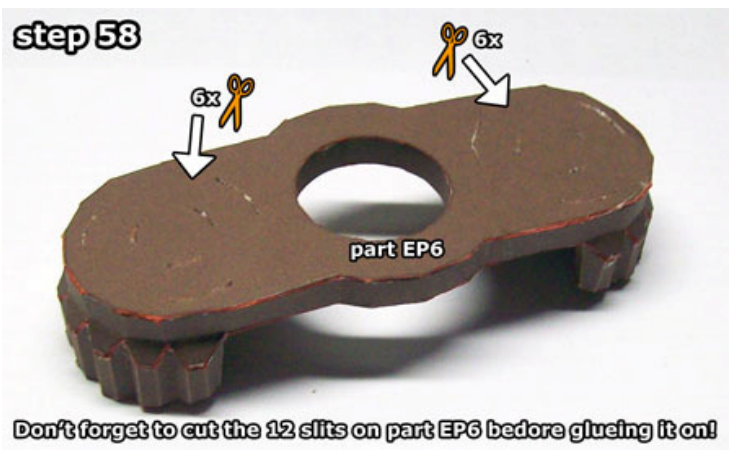

6x

6x

6x

part EP6

Don't forget to cut the 12 slits on part EP6 before gluing it on!

step 59

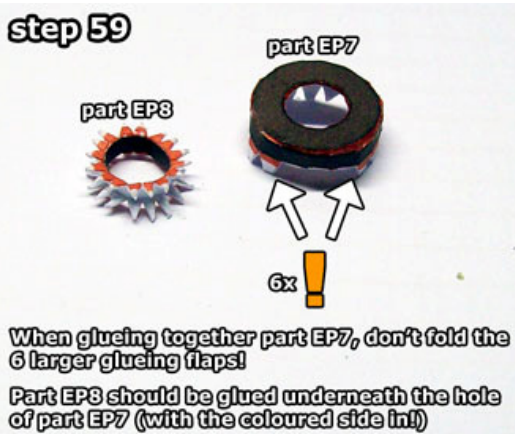

part EP7

part EP8

6x

When gluing together part EP7, don't fold the 6 larger glueing flaps!

Part EP8 should be glued underneath the hole of part EP7 (with the coloured side in!)

step 60



part EP11+EP12

part EP13+EP14

part EP7+EP8

part EP9+EP10

Glue together parts EP9+EP10, EP11+EP12 and EP13+EP14 the same way, and push the unfolded glueing flaps through the slits on part EP6 to glue them in the correct positions.

step 61

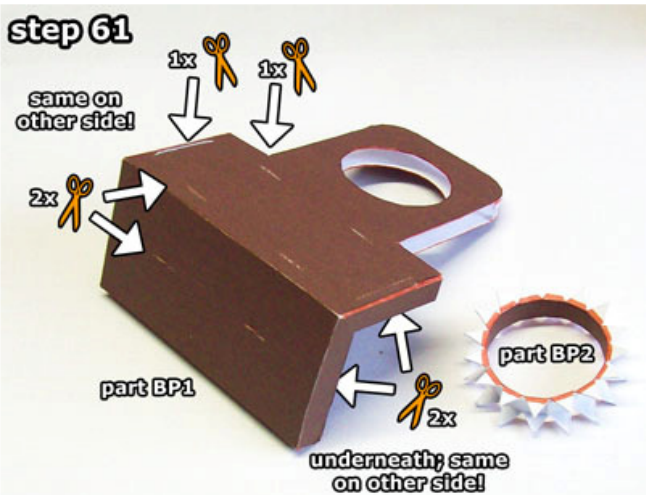

same on other side!

1x

1x

2x

part BP1

part BP2

underneath; same on other side!

There are quite a few slits to cut out on part BP1, so make sure you don't forget any before glueing it together!
Glue part BP2 into a ring with the coloured side in.

step 62

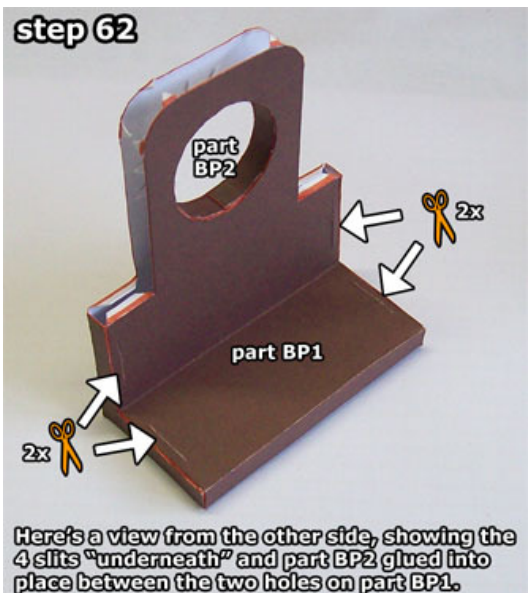

part BP2

part BP1

2x

Here's a view from the other side, showing the 4 slits "underneath" and part BP2 glued into place between the two holes on part BP1.

step 63

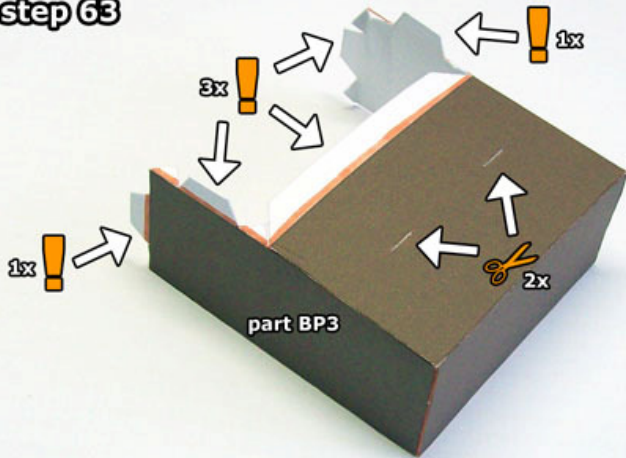

Part BP3 is not so difficult for a change, but you do need to remember to cut 2 slits, and NOT to fold the 5 larger glueing flaps!

step 64

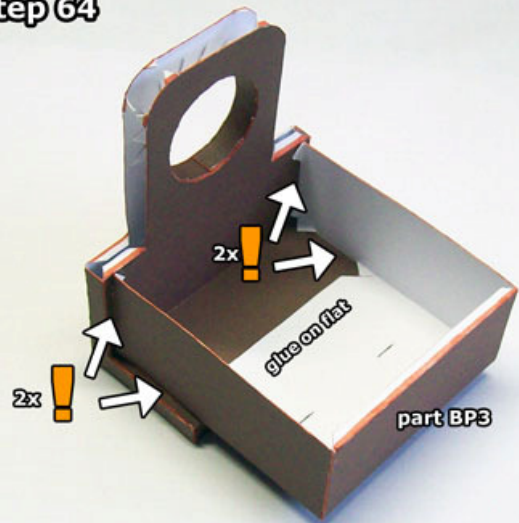

Push the 4 larger glueing flaps of part BP3 through the slits on the bottom of part BP1, and use the largest glueing flap to glue on flat.

step 65

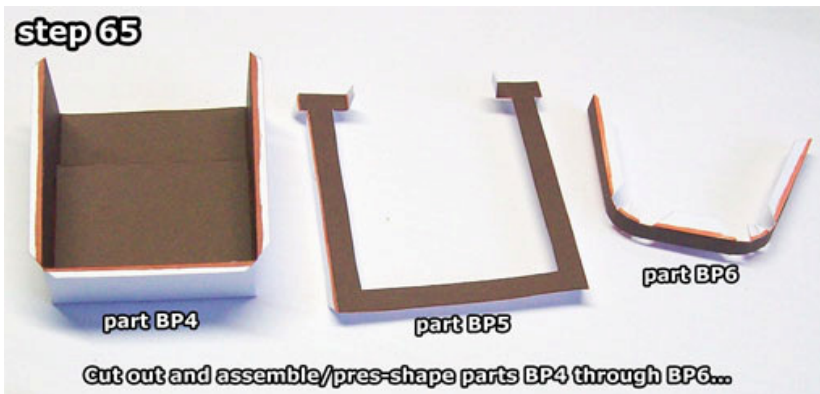

Cut out and assemble/pres-shape parts BP4 through BP6...

step 66



...so you can glue them together to form the "backside" of the backpack.

step 67

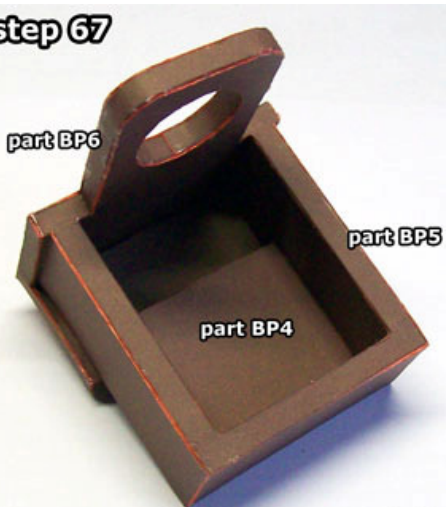

If you took care pre-shaping part BP6, glueing them to the backpack will be much easier, :o)

step 68

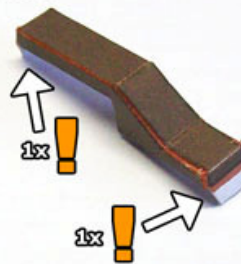

Glue together part BP7, NOT folding the 2 larger glueing flaps on the ends.

step 69

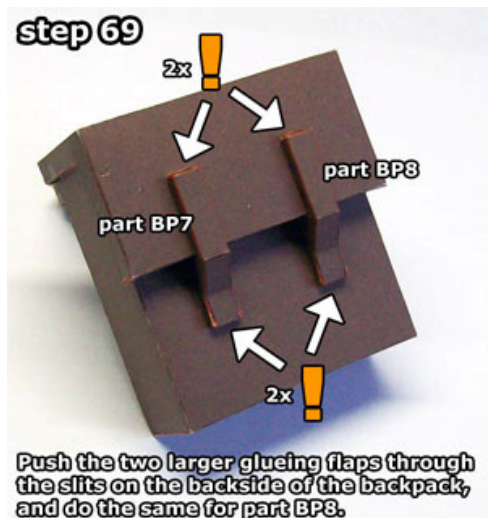

Push the two larger glueing flaps through the slits on the backside of the backpack, and do the same for part BP8.

step 70



On part BP9, there are 3 larger gluing flaps you shouldn't fold!

On part BP9, there are 2 gluing flaps you shouldn't fold, and 4 slits to cut!

step 71

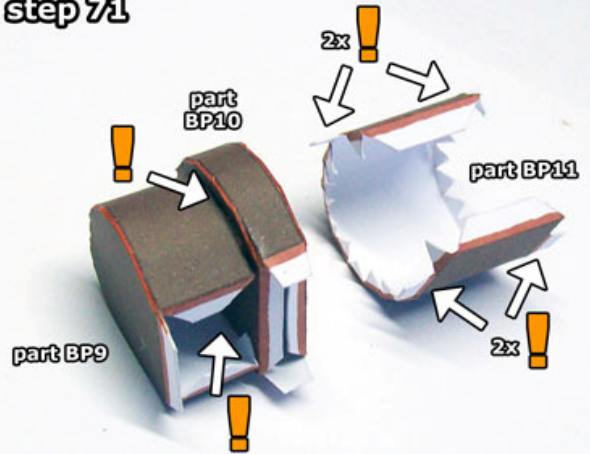

Push the 2 larger gluing flaps on the side of part BP9 through the slits on part BP10.

Pre-shape part BP11, which has 2 gluing flaps on each side that mustn't be folded.

step 72

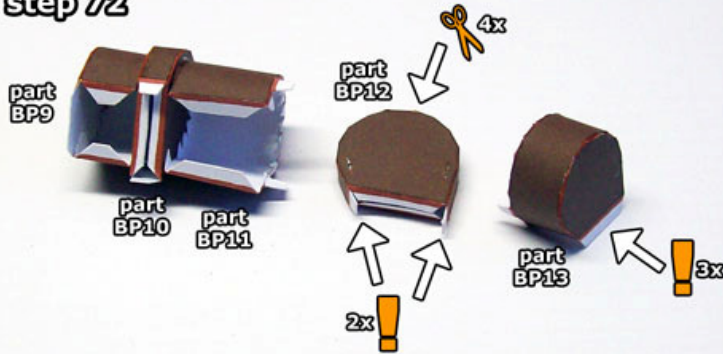

Use the gluing flaps on the side of part BP11 to glue it onto the side of part BP10 (giving it the right shape).

Parts BP12 and BP13 are the mirror images of parts BP9 and BP10 (don't forget to cut all the slits and refrain from folding the larger gluing flaps!)

step 73

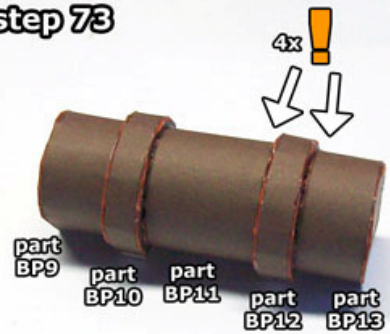

Glue on parts BP12 and BP13 by pushing the larger gluing flaps through the slits again.

step 74

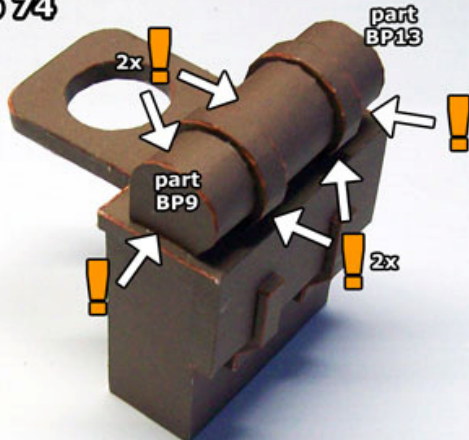

Push the larger gluing flaps on the bottom of parts BP9-BP13 through the slits on top of the backpack.

Make sure the "flat" side is to the back of the backpack! (the side with the hole)

step 75

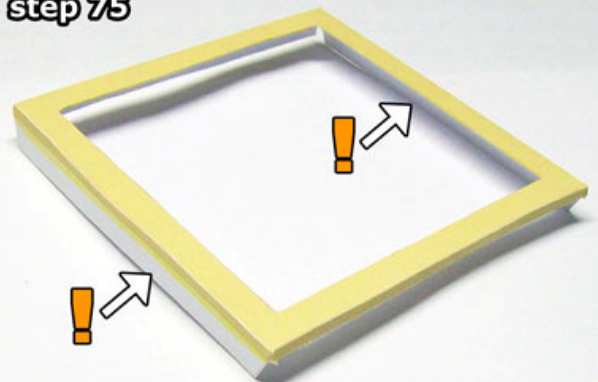

Cut out and glue together part T01; don't fold the two larger gluing flaps!

step 76

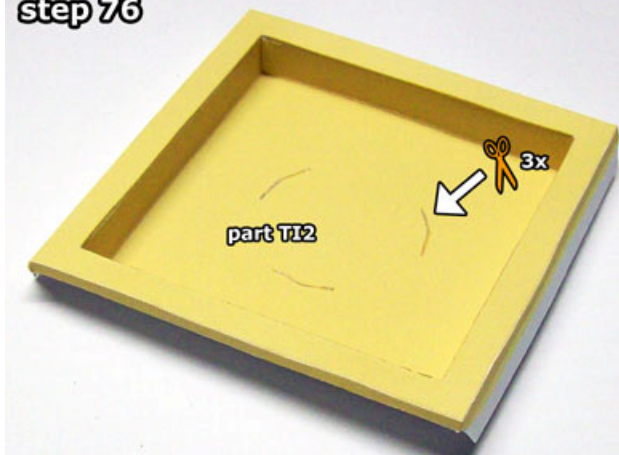

Cut the 3 slits on part T12 and glue it together with the coloured side in, then glue it underneath part T11

step 77

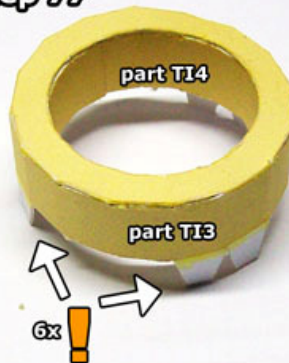

Cut out and glue together part T13, but don't fold the 6 larger gluing flaps.

Then glue part T14 into a ring and underneath part T13.

step 78

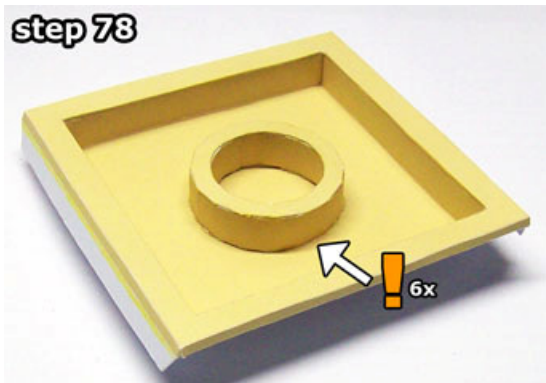

Push the larger gluing flaps through the slits on part T12 to glue the pieces together.

step 79

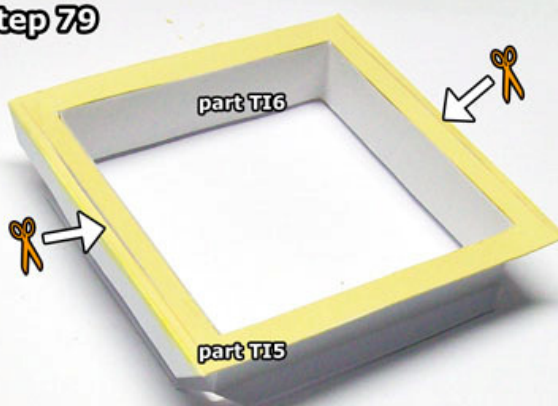

Cut out the 2 long slits on part T15, and glue part T16 underneath.

Part T16 is just for strength, but make sure the gluing flaps won't block the slits on part T15!

step 80

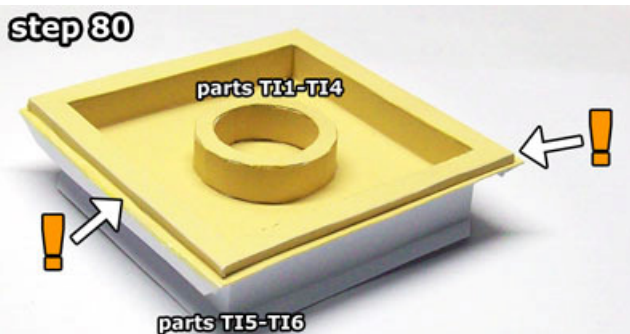

Push the big gluing flaps on part T11 through the long slits on part T15 so the hollow part fits through the hole.

step 81



Turn the treasure map over, and glue part T17 over the bottom part.

Take your time to align the edges to make it as square as you can! ;o)

step 82



Because part WH1 is quite long, maybe you'll want to use a pencil or metal rod to apply pressure from the inside when gluing the gluing flap together.

step 83



Parts WH2 through WH13 are all basically the same, only in different sizes. Glue them together in the way they are numbered.

step 84



Because the top and bottom of the parts are curved, the whip will be curved like this when you glue them together.

step 85



Part WH14 looks complicated, but it really isn't if you just take it one part at a time.

Part WH15 looks easy and it is, it's just a ring with the coloured side in again. ;o)

step 86

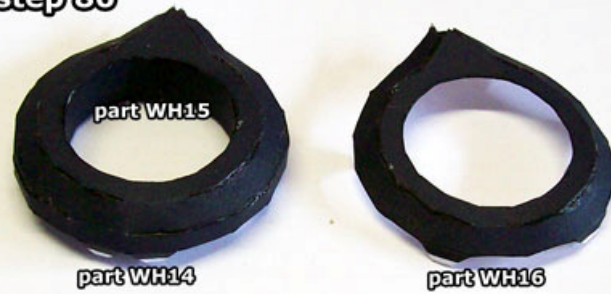

Glue part WH14 underneath part WH15, and glue together part WH16.

step 87



Now glue parts WH14 through WH16 to the tip of the whip.

Remember that the whip is made from a lot of separate parts, so it won't be very strong unless you used very good glue and paper and took your time glueing it together...!

step 88



Dont use glue when you put your papercraft minifig together! That way, you can move the parts and take him apart again if you want to. ;o)

Thank you for building a ninjatoes' papercraft model!
www.kickme.to/ninjatoes